

Lake Data:
 Area of WS = 38 acres
 Total DA = 148 acres
 100-yr Rainfall Volume = 96 ac-ft
 Increase in WS due to 100-yr rainfall = 2.5 ft
 100-yr WS Elev. = 92.5

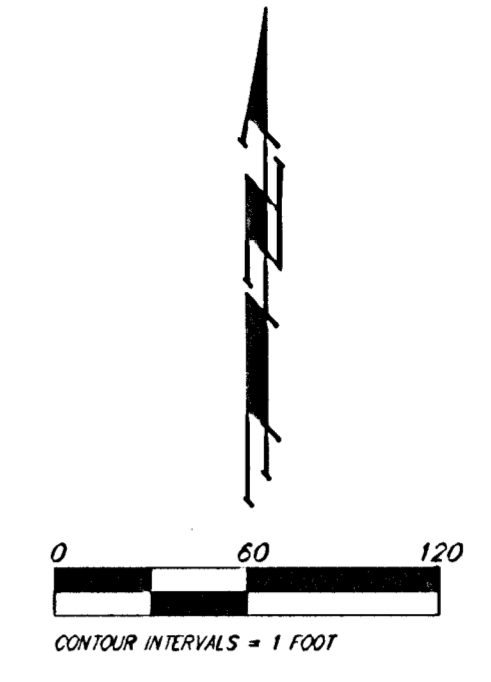

- Area to be graded
- - 144 - - Existing Grade
- 144 - Proposed Grade

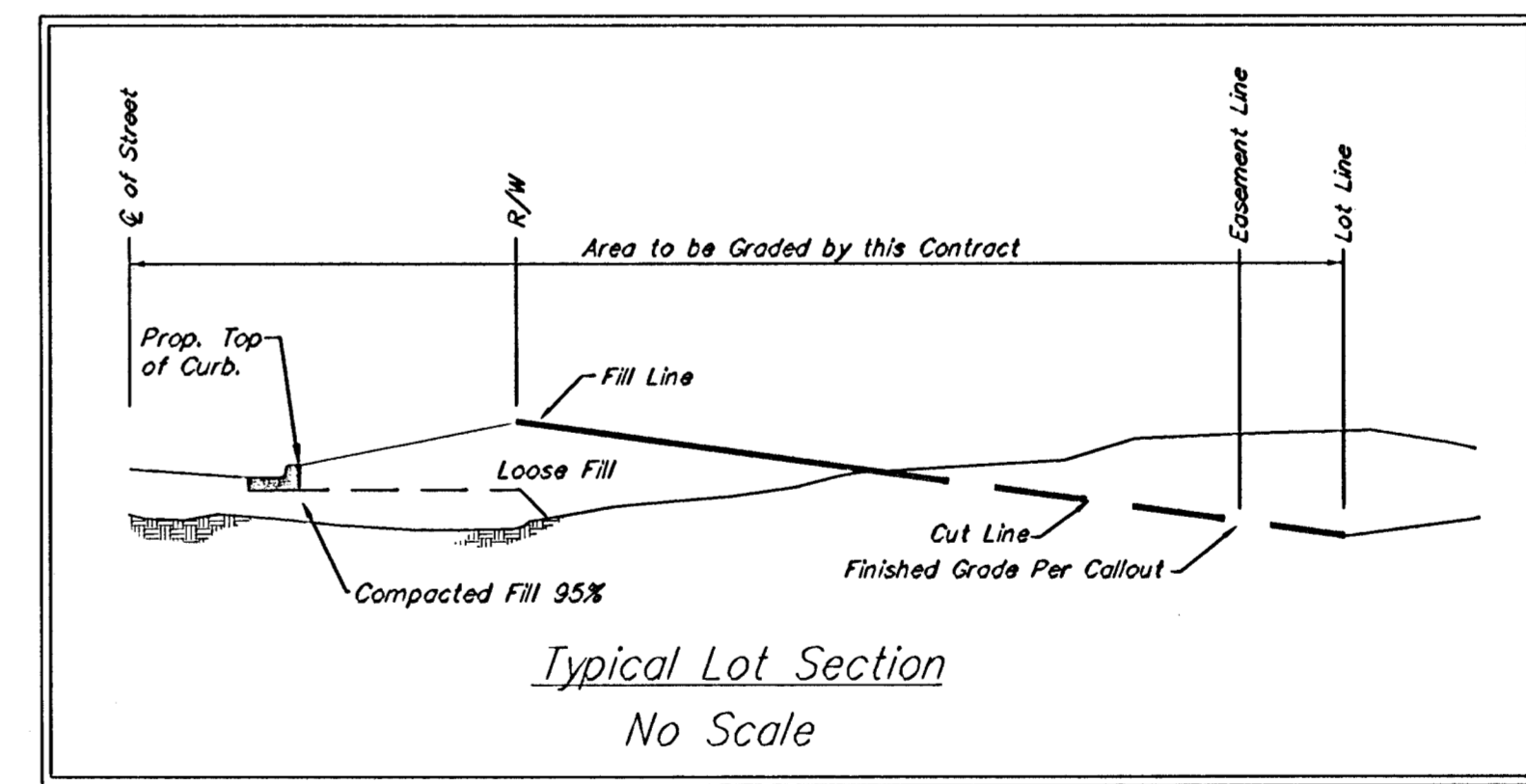

Benchmarks:
 Hoover and MacArthur (39th St. South)
 COW Bench Mark. NE corner of intersection.
 41.60 ft North of center line.
 69.00 ft East of center line.
 20.00 ft East of guy pole.
 79.80 ft NE of Section corner iron.

City 121.22 ft
 MSL 1308.62 ft

Big Ditch and MacArthur
 COW Bench Mark. West bound lane,
 east end of bridge.
 East of Hoover.

City 116.52 ft
 MSL 1303.92 ft

BLUE LAKE ADDITION
MASS GRADING
 WICHITA, KANSAS

BAUGHMAN COMPANY P.A.
 ENGINEERING, SURVEYING, & PLANNING
 318-202-7271 • 315 ELLIS • WICHITA, KANSAS 67211

PROJECT NUMBER				SHEET
DESIGN	DRAWN	APPROVED	DATE	SCALE
BLG	BLG	BLG	5-03-04	noted
PROJECT NUMBER				41
PROJECT NUMBER				75

pre-grading