

Benchmark
 BM #1 - City Disc Located @ 12.89m South
 and 10.91m West of the Centerline of both
 Meridian and Central.
 Elev. = 397.376 SI Units
 (1303.71 MSL Datum)

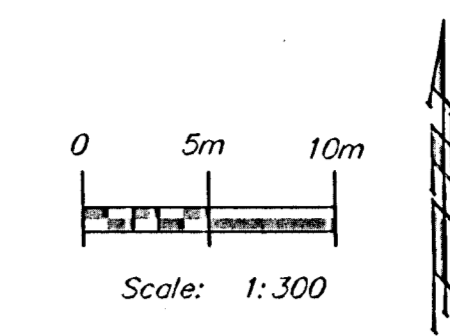

ADD ALTERNATE ARTWORK CENTRAL & McLEAN INTERSECTION LIGHT COLUMNS

GENERAL NOTES

1. New Light Column Conduit may be Installed During Signal Conduit Installation at Contractor's Option. New Light Column Conduit Shall Comply with Std. City of Wichita Specifications for Signal Installation.
2. Quantities Shown Reflect New Conduit Runs Between Light Columns. Contractor Will Not be Allowed to use Street Signal Conduit for Power Cable to Serve the Light Columns. Contractor may, with City's Approval, Use Signal Boxes as a Terminus Point for Conduit Runs.
3. Light Column Controls Shall be Located in a NEMA-Rated Rainproof Enclosure with a Locking Cover.
4. A UL-Listed Lightning Arrestor Shall be Installed Between the Disconnect Switch and the Control Panel for Voltage Surge Protection of all Secondary Wiring.
5. All Conductors to be type "THWN" copper - Minimum #12 AWG.
6. All circuits to be provided with a full-length "green" grounded/bonding conductor. Connect to ground lug inside each light column/fixture assembly.
7. Contractor to verify all service requirements with KG&E prior to bidding.
8. Schematic shown is for bidding purposes ONLY. Contractor to verify actual wiring and electrical service requirements with manufacturer prior to bidding and construction.
9. Paving Contractor shall be responsible for conduit runs, wiring, electrical service requirements, and ornamental concrete bases. Light Column manufacturer shall be responsible for fabrication, installation, and start-up.
10. The Lump Sum Price Bid for Installing the Light Columns Complete in Place and Operational Shall INCLUDE but not be Limited to: Concrete Base, Reinforcement, Ground Rods, Conduit, Wiring, Neon Light Columns, Control Panel, Electrical Disconnect, Installation, and all Other Incidentals Necessary.

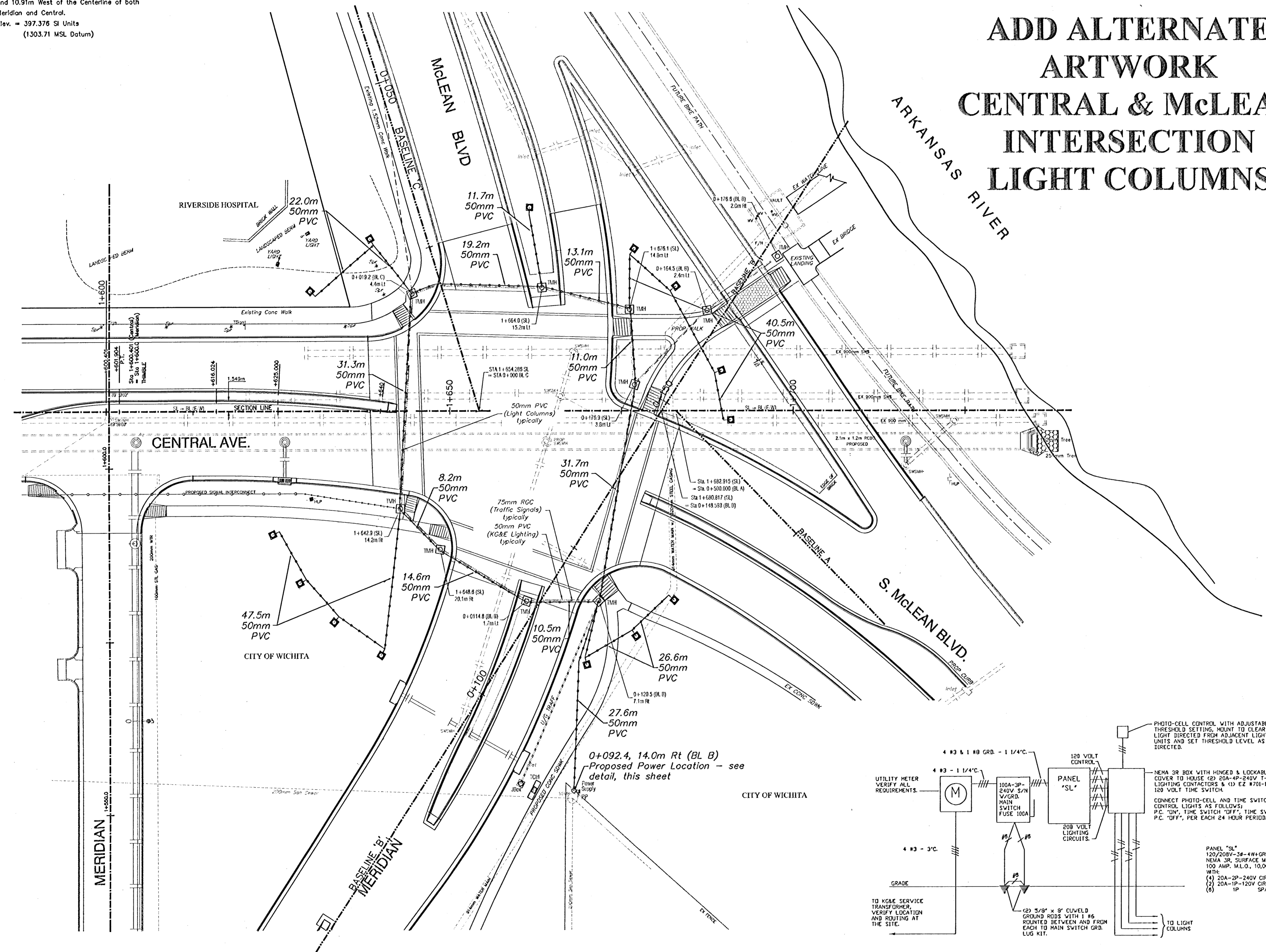

LEGEND

- ◆ PROPOSED LIGHT COLUMN
- 50mm PVC CONDUIT

LIGHT COLUMN QUANTITIES (FOR INFO. ONLY)

ITEM	QTY.	UNIT	REMARKS
LIGHT COLUMN	14	EA.	Mfcd by Luminous Neon.
2" (50mm) ELECTRICAL CONDUIT	316	meters	Measured to Center of Column.
ORNAMENTAL CONCRETE BASE	14	EA.	
GROUND ROD & CLAMP	16	EA.	
WIRING	XX	meters	As Necessary (See note #10)
METER BOX	1	EA.	As Necessary (See note #9)
ELECTRICAL DISCONNECT	1	EA.	As Necessary (See note #9)
ELECTRICAL BREAKER PANEL	1	EA.	As Necessary (See note #9)
PHOTO CELL CONTROL	1	EA.	As Necessary (See note #9)
LIGHTING CONTROLS	1	EA.	As Necessary (See note #9)

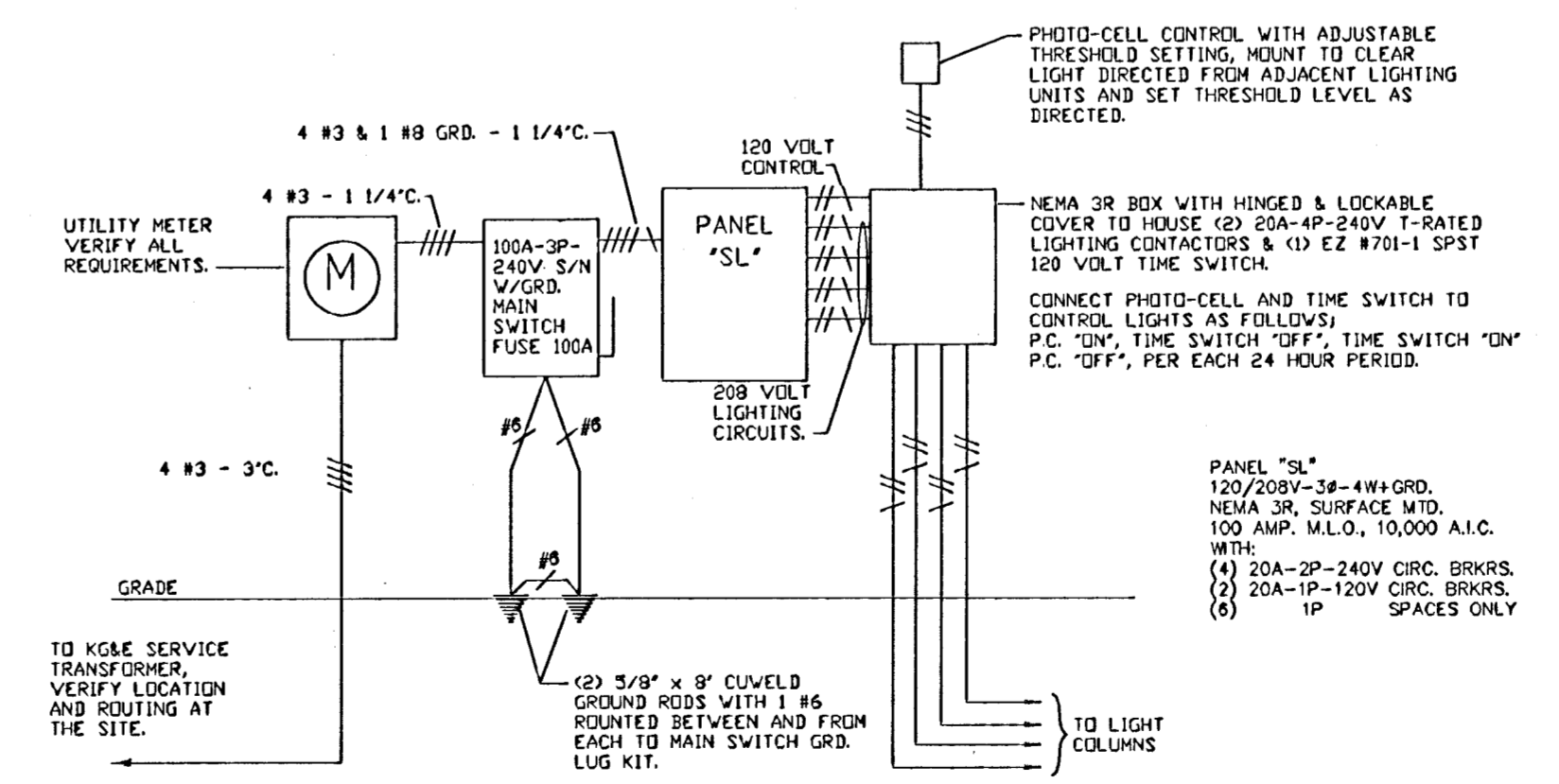

Electrical Riser Diagram (*)
 NO SCALE

QUANTITIES SHOWN ARE FOR INFORMATION ONLY. ALL LABOR, MATERIALS, EQUIPMENT, AND ETC. NECESSARY TO INSTALL THE LIGHT COLUMNS COMPLETE IN PLACE AND FUNCTIONAL SHALL BE SUBSIDIARY TO THE ALTERNATE BID ITEM: "LIGHT COLUMN INSTALLATION - 1 LUMP SUM."

DESIGN	DATE	CITY PROJECT NUMBER	BAUGHMAN PROJECT NUMBER
JFB/JUL	DEC 99	472-76-245-82910	98-01-E965
DRAWN	SCALE	APPROVED	DIRECTOR
STAFF	NOTED	JFB	F:\mclm\details
			LITETUBE.DWG

CAPITAL IMPROVEMENT PROJECT
 LIGHT COLUMNS
 SITE PLAN
 CENTRAL & McLEAN INTERSECTION IMPROVEMENTS

BAUGHMAN COMPANY P. A.
 ENGINEERING, SURVEYING, & PLANNING
 316-262-7271 • 315 ELLIS • WICHITA, KANSAS 67211