

P.T. Sta. 42+05.75  
1. N=1681168.58, E=1637730.78

P.C. Sta. 42+35.24  
1. N=1681142.02, E=1637743.60

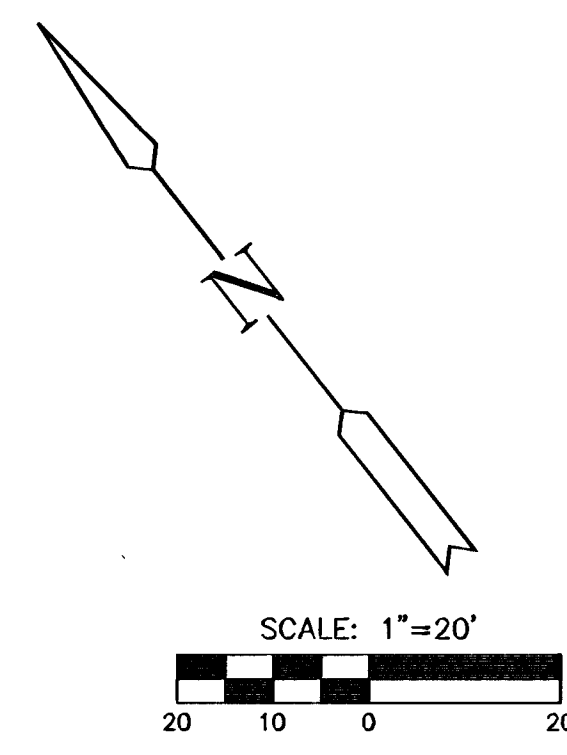

Sta. 39+09.00 McCormick Const.  
Std. Manhole (Precast), 37.79' Lt.  
Manhole Dia.=4'-0"  
Manhole Top = 112.00  
See Sht. No. 14 & 33

Sta. 40+58.40 McCormick Const.  
Std. Manhole (Precast), 31.69' Lt.  
Manhole Dia.=4'-0"  
Manhole Top = 115.20  
See Sht. No. 14 & 33

Sta. 43+00 McCormick Install  
18" RCP End Section, 38.52' Lt.  
Const. RCP Outfall  
See Sht. No. 15 & 37

P.I. Sta. 44+27.74 (Bk.)=  
P.I. Sta. 43+85.04 (Ahead)  
 $\Delta = 65^{\circ}22'25''$   
T = 192.50'  
R = 300.00'  
L = 342.30'  
E = 56.45'  
N. C.

Sta. 39+08 McCormick,  
25.25' Lt. Existing sign  
to be relocated by  
Newman University

Sta. 42+31.1 McCormick Install  
18" RCP End Section, 38.52' Lt.  
Const. RCP Outfall  
See Sht. No. 14 & 37

Sta. 43+00 McCormick Const.  
Curb Inlet (Type 1A), 25.67' Lt.  
L=6'-4", W=4'-4"  
Inlet Top = 111.09  
See Sht. No. 15 & 27

Sta. 43+13.17 to Sta. 44+66.44  
Const. Retaining Wall, 35.39' Lt.  
Install Pedestrian Handrail  
See Sht. No. 38 & 39

Sta. 43+65.22 McCormick =  
Sta. 10+00.00 Dondlinger

P.V.I.  
Elev.=109.66  
100' V.C.

Transition 8' walk to  
5' walk in 10'

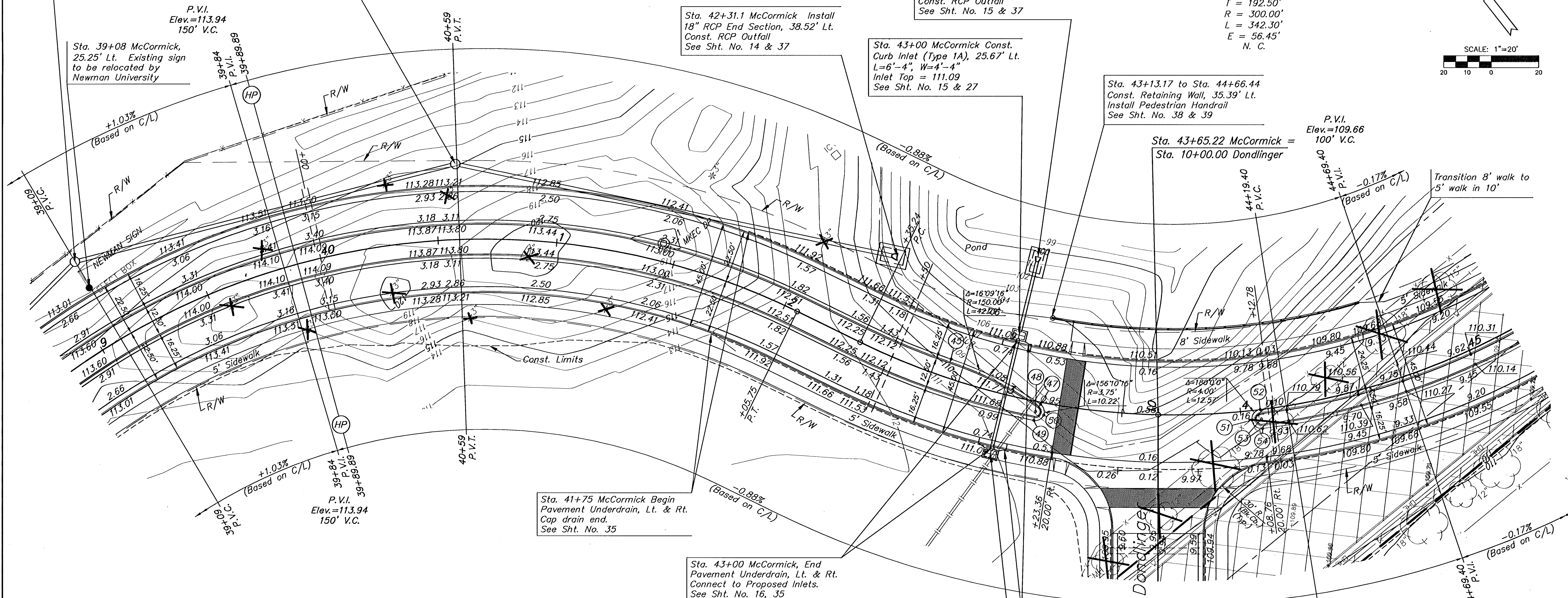

Sta. 41+75 McCormick Begin  
Pavement Underdrain, Lt. & Rt.  
Cap drain end.  
See Sht. No. 35

Sta. 43+00 McCormick, End  
Pavement Underdrain, Lt. & Rt.  
Connect to Proposed Inlets.  
See Sht. No. 16, 35

Sta. 43+00 McCormick Const.  
Curb Inlet (Type 1A), 25.67' Rt.  
L=6'-4", W=4'-4"  
Inlet Top = 111.09  
Connect Exist. 12" RCP to Inlet  
Abandon exist. 12" RCP (E)  
See Sht. No. 15 & 27

Sta. 43+05 McCormick Begin  
Pavement Underdrain, Lt. & Rt.  
Cap drain end.  
See Sht. No. 35

P.V.I.  
Elev.=109.66  
100' V.C.

**UTILITIES**

- CATV - Cox Communications (Cable) 262-0661
- E - Westar Energy (Electric) 261-6512
- SWS - City of Wichita Stormwater Utility 268-4071
- SS & W - City of Wichita Water Dept. 262-6000
- T - SBC (Telephone) 800-870-8390

Point No.	Station	Offset	Elevation	
			High Edge	Top Curb
45	42+73.79	8.00' Lt.	111.23	111.92
46	42+73.81	142.00' Rt.	Radius Point	
47	43+15.54	0.82' Rt.	111.00	111.69
48	43+14.03	4.25' Rt.	Radius Point	
49	43+14.03	8.00' Rt.	111.03	111.72
50	43+17.84	5.05' Rt.	110.90	111.58
51	44+04.39	4.00' Rt.	110.16	110.81
52	44+08.33	0.00' Rt.	110.20	110.89
53	44+08.33	4.00' Rt.	Radius Point	
54	44+08.33	8.00' Rt.	110.03	110.72

C.P. #1 Sta. 41+43.86, 7.57 Lt.  
1. N=1681225.78, E=1637704.38  
2. 5/8" Bar w/red MKEC Cap

**LEGEND**

- Drive, Pavement and/or Sidewalk Removal
- Install 2-6" PVC (Sch. 40) Irrigation Sleeves, 2.5' apart extending 2' beyond Back of Curb



**MCCORMICK AVENUE STREET IMPROVEMENTS**  
PROJECT NAME

**MCCORMICK - STA 39+00 TO STA 45+00**  
SHEET TITLE

JIRA DESIGN BY:	WNJ DRAWN BY:	JIRA CHECKED BY:
AUGUST 2005 DATE	03245 JOB NO.	7 / 111 SHEET/OF