

STATION	OFFSET	DESCRIPTION
321	19+22.94	12.00' Lt. Begin 7" Concrete Pavement (Reinforced)
322	19+22.94	14.50' Lt. Begin 2.5' Radius (BOC)
323	19+25.10	18.25' Lt. End 2.5' Radius (BOC)
324	19+75.51	14.50' Rt. End 7" Concrete Pavement (Reinforced)
325	19+77.34	24.50' Rt. Corner Point (BOC)
326	19+77.34	17.00' Rt. Begin 2.5' Radius (BOC)
327	19+79.84	14.50' Rt. End 2.5' Radius (BOC)
328	19+82.51	14.50' Rt. Begin 9.5' Radius (BOC)
329	20+90.16	14.50' Rt. End 9.5' Radius (BOC)
330	20+92.18	14.50' Rt. Begin 2.5' Radius (BOC)
331	20+94.68	24.50' Rt. Corner Point (BOC)
332	20+94.68	17.00' Rt. End 2.5' Radius (BOC)
333	20+96.51	14.50' Rt. Begin 7" Concrete Pavement (Reinforced)
334	21+33.77	32.33' Lt. Corner Point (BOC)
335	21+37.52	14.50' Rt. End 7" Concrete Pavement (Reinforced)
336	21+39.35	24.50' Rt. Corner Point (BOC)
337	21+39.35	17.00' Rt. Begin 2.5' Radius (BOC)
338	21+41.85	14.50' Rt. End 2.5' Radius (BOC)
339	21+42.62	12.00' Lt. End 7" Concrete Pavement (Reinforced)
340	21+43.34	15.75' Lt. Begin 2.5' Radius (BOC)
341	21+45.51	14.50' Lt. End 2.5' Radius (BOC)
342	21+43.90	13.88' Rt. Begin 9.5' Radius (BOC)
343	21+47.50	14.50' Lt. Begin 12.5' Radius (BOC)
344	21+89.99	14.50' Rt. End 9.5' Radius (BOC)
345	21+98.50	14.50' Lt. End 12.5' Radius (BOC)
346	21+98.03	32.33' Lt. Corner Point (BOC)
347	22+02.43	14.50' Rt. Begin 2.5' Radius (BOC)
348	22+04.00	14.50' Lt. Begin 2.5' Radius (BOC)
349	22+04.93	24.50' Rt. Corner Point (BOC)
350	22+04.93	17.00' Rt. End 2.5' Radius (BOC)
351	22+04.00	12.00' Lt. Begin 7" Concrete Pavement (Reinforced)
352	22+07.43	12.00' Rt. Begin 7" Concrete Pavement (Reinforced)

STATION	OFFSET	DESCRIPTION
353	22+06.16	18.25' Lt. End 2.5' Radius (BOC)
354	22+61.16	32.33' Lt. Corner Point (BOC)
355	22+69.10	12.00' Rt. End 7" Concrete Pavement (Reinforced)
356	22+70.01	12.00' Lt. End 7" Concrete Pavement (Reinforced)
357	22+70.73	15.75' Lt. Begin 2.5' Radius (BOC)
358	22+71.60	24.50' Rt. Corner Point (BOC)
359	22+71.60	17.00' Rt. Begin 2.5' Radius (BOC)
360	22+72.89	14.50' Lt. End 2.5' Radius (BOC)
361	22+74.10	14.50' Rt. End 2.5' Radius (BOC)
362	23+02.19	14.50' Rt. End Type I Curb & Gutter (6"); Begin 19.5' Radius; Begin Mono Edge Curb (6")
363	23+02.19	- End Brick Pavers on 7" Concrete Pavement; Begin 7" Valley Gutter on 5" Crushed Rock
364	23+02.19	14.50' Lt. End Type I Curb & Gutter (6"); Begin 19.5' Radius; Begin Mono Edge Curb (6")
365	23+05.34	14.76' Rt. Begin Curb Ramp Transition
366	23+05.34	17.74' Lt. Begin Curb Ramp Transition
367	23+11.34	16.78' Rt. End Curb Transition
368	23+11.34	16.71' Lt. End Curb Transition
369	23+14.34	27.72' Rt. Const. Sidewalk Ramp (6.0')
370	23+14.34	27.56' Lt. Const. Sidewalk Ramp (6.0')
371	23+17.34	21.72' Rt. Begin Curb Ramp Transition
372	23+17.34	21.56' Lt. Begin Curb Ramp Transition
373	23+20.35	26.89' Rt. End Curb Transition
374	23+20.40	26.70' Lt. End Curb Transition
375	23+21.75	40.45' Rt. End Type I Curb & Gutter; Match Existing
377	23+21.69	33.84' Rt. End 19.5' Radius (BOC); End Mono Edge Curb (6"); Begin Type I Curb & Gutter (6")
378	23+21.82	34.03' Lt. End 19.5' Radius (BOC); End Mono Edge Curb (6"); Begin Type I Curb & Gutter (6")
380	23+21.80	49.03' Lt. End Type I Curb & Gutter; Match Existing
381	23+24.25	40.43' Rt. End 7" Valley Gutter on 5" Crushed Rock Base; Match Existing

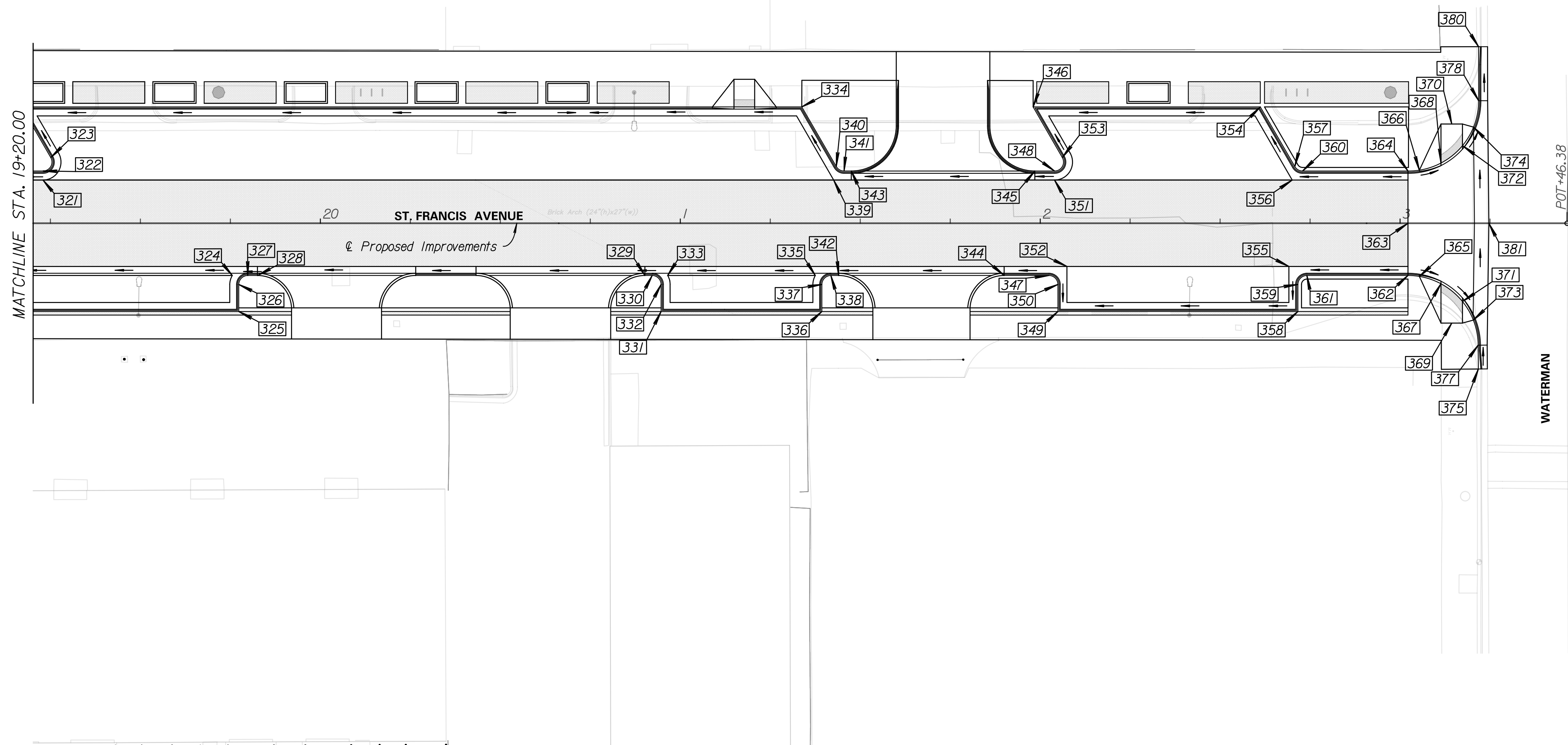
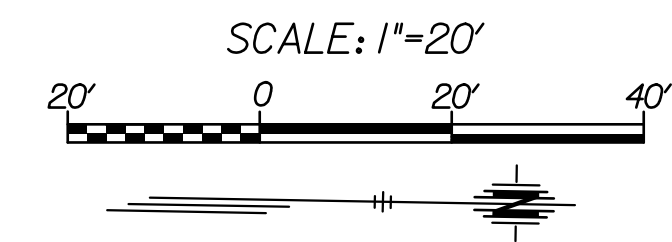

TRANSYSTEMS
 245 N. WACO
 SUITE 222
 WICHITA, KANSAS 67202
 MAIN: 316-303-3000
 FAX: 316-462-5629

CONSULTANTS:

COMMERCE STREET & ST. FRANCIS AVENUE IMPROVEMENTS FROM WATERMAN TO KELLOGG
 WICHITA, KANSAS

REVISIONS:	MARK	DATE	DESCRIPTION

PROJ NO: 472-2021
 SCALE: 1"=20'
 DATE: 2/21/2024
 DESIGNED BY: MLC
 DRAWN BY: LCV
 CHECKED BY: MDB

SHEET TITLE:
ST. FRANCIS AVENUE GEOMETRIC LAYOUT DETAILS

SHEET NO.
67