

FHWA REGION NO.	STATE	PROJECT NO.	YEAR	SHEET NO.	TOTAL SHEETS
7	KANSAS	87 N-0137-01	99	53	94

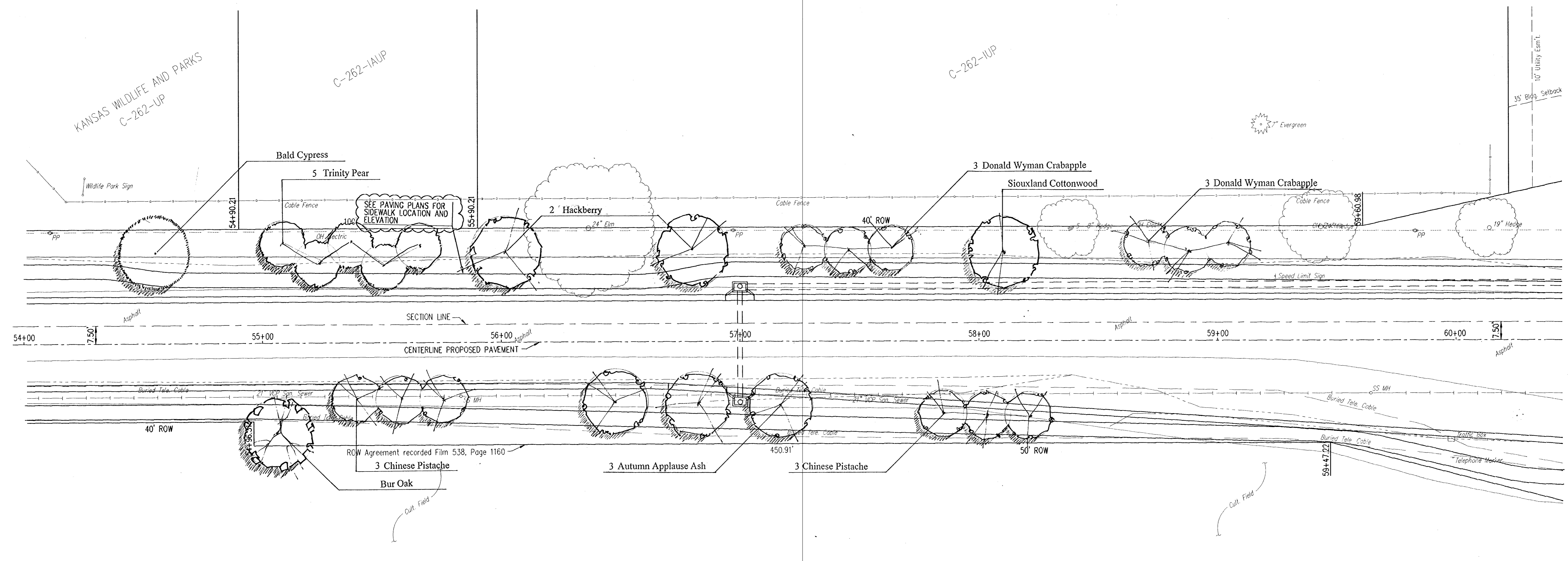
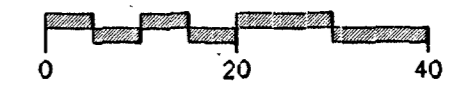
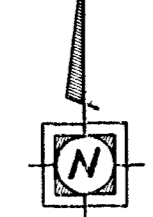

**Bid Items (per sheet)**

Qty	Botanical Name	Common Name	Size
3	Fraxinus americana	'Autumn Applause' Ash	2.5
1	Quercus macrocarpa	Bur Oak	2.5
3	Celtis occidentalis	Hackberry	2.0
1	Taxodium distichum	Bald Cypress	3.0
6	Malus spp	'Donald Wyman' Crabapple	1.5
6	Pistache chinensis	Chinese Pistache	1.5
5	Pyrus calleryana	'Trinity' Pear	1.5
Seeding	Turf type tall fescue		0.37 acres

**YOUNG & ASSOCIATES, P.A.**  
 Civil and Environmental Engineers  
 100 South George  
 City, Kansas 67133  
 Tel: (316) 788-2552  
 Fax: (316) 788-4408

City of Wichita  
 Sedgwick County, Kansas

**CL STA. 54+50 TO 60+00  
 LANDSCAPE PLAN**

29th Street North from Oliver Street to Woodlawn Avenue  
 Street, Decal Lane, and Storm Drainage Improvements

Project No.: 96-035-002  
 Date: January 1998

Design:  
 Tech.:  
 Sheet No. 53 of 94

FILE: I:\cadd\98\87 N-0137-01.dwg  
 DATE: 1-12-98  
 AUTHOR: J.L. SCALE: 1"=20'