

WATER VALVE BOX ELEVATIONS			
STREET	STATION	OFFSET	PROPOSED ELEVATION
19TH STREET NORTH	10+54.5	24.0' Rt.	196.5
19TH STREET NORTH	14+99.0	23.0' Rt.	206.0
19TH STREET NORTH	15+02.0	26.0' Rt.	206.1

PROJECT NO.	SHEET NO.	TOTAL SHEETS
472-76-245-83375-000-000-001	6	58

SCALE: 1"=20'

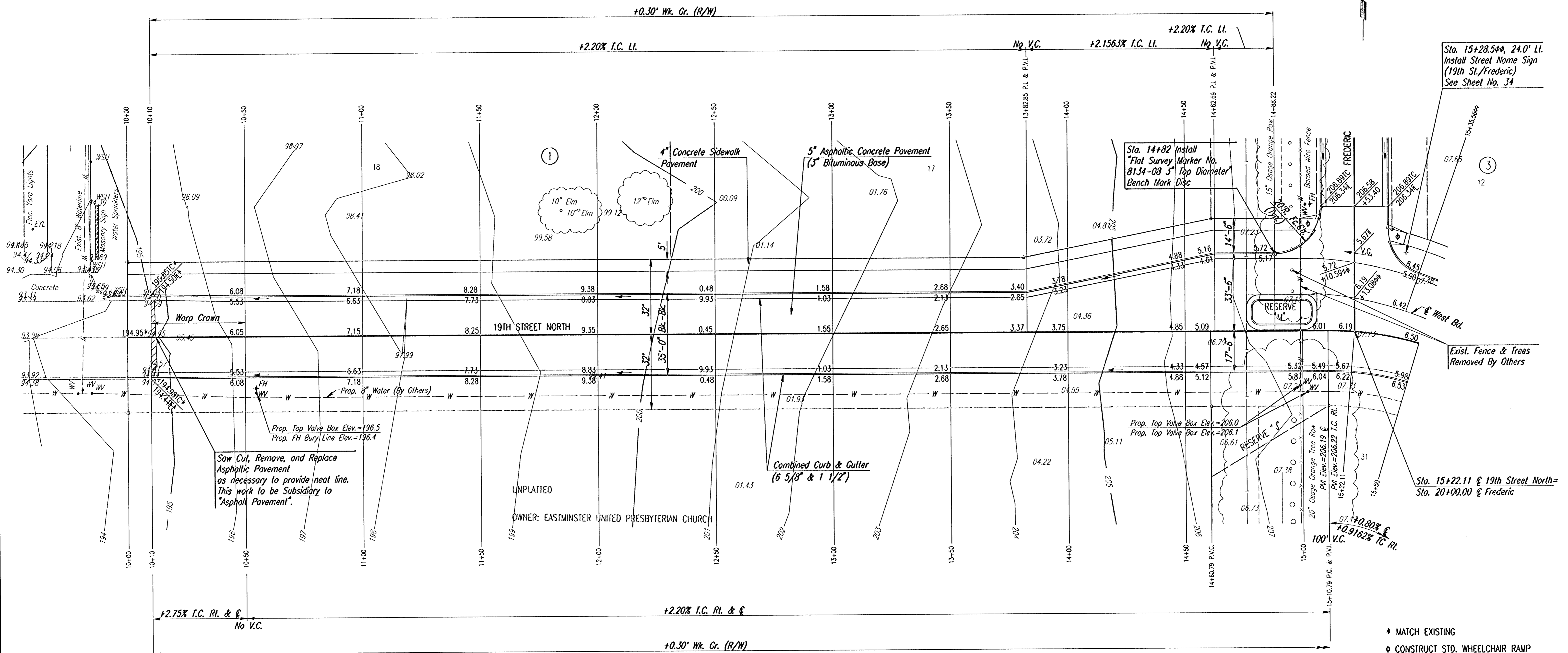

Sta. 15+28.50±, 24.0' Lt.
Install Street Name Sign
(19th St./Frederic)
See Sheet No. 34

Sta. 14+82 Install
"Flat Survey Marker No.
8134-03 3" Top Diameter
Bench Mark Disc

Saw Cut, Remove, and Replace
Asphaltic Pavement
as necessary to provide neat line.
This work to be Subsidiary to
"Asphalt Pavement".

Combined Curb & Cutter
(6 5/8" & 1 1/2")

Sta. 15+22.11 @ 19th Street North=
Sta. 20+00.00 @ Frederic

- * MATCH EXISTING
- ◆ CONSTRUCT STD. WHEELCHAIR RAMP
- ◆◆ WEST BOUND @ STATION

No.	Revisions	By	Date

**REMINGTON PLACE-PHASE I
CITY OF WICHITA, KANSAS**

**19TH STREET NORTH
STA. 10+00.00 TO STA. 15+50**

Professional Engineering Consultants, P.A.
300 S. TOPKA • WICHITA, KANSAS 67202
316-262-2691 • FAX 316-262-3003

Designed by	BER	Checked by	
Drawn by	BJS	Date	JUNE 2001
		Job No.	0158

DSNR: BER OPER: BUS SCALE: 1"=20'
 I:/2001/01158/S1R10-14.DGN Plot Date: 10-23-2001