

SCALE: 1"=20'

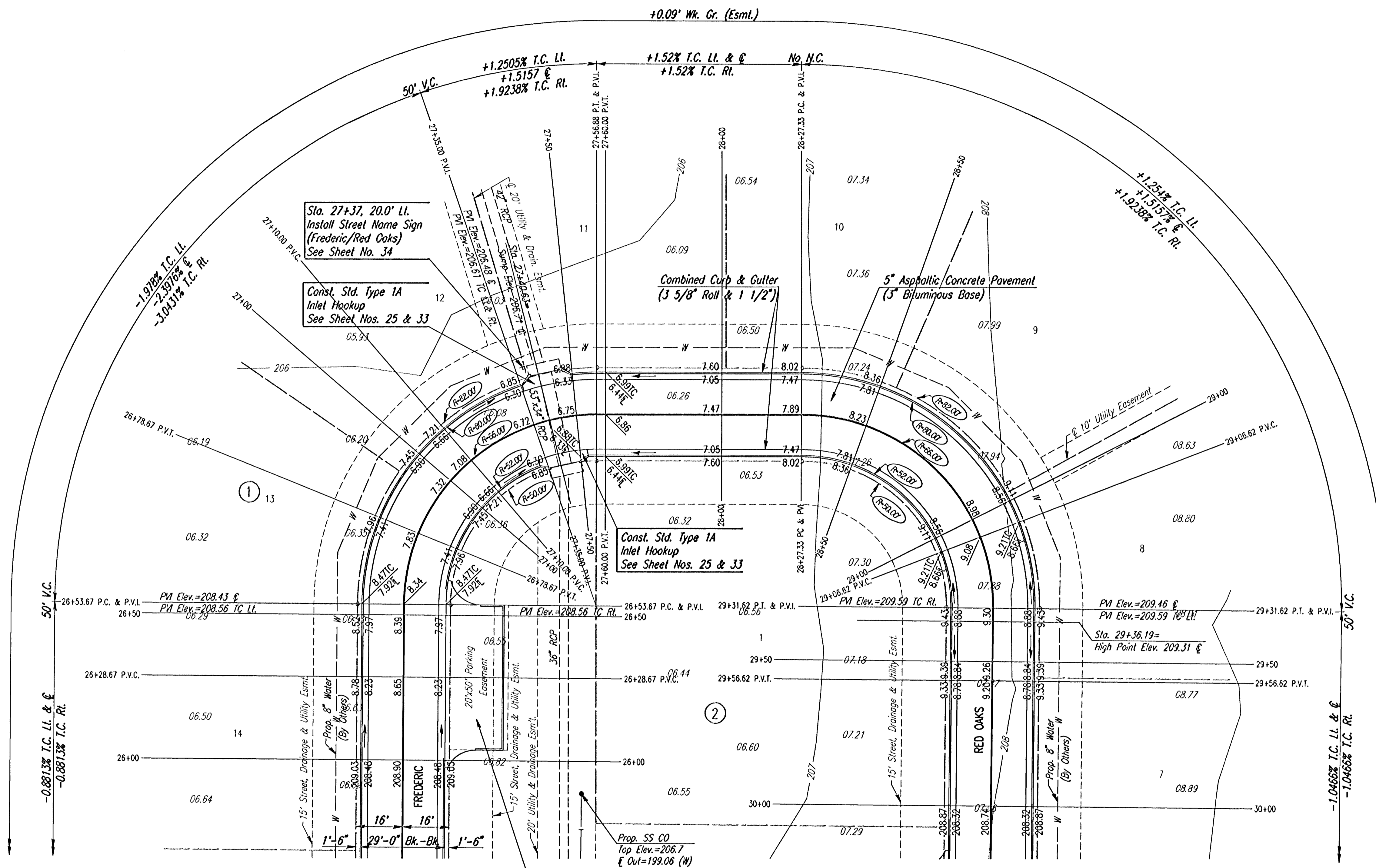

Q CURVE DATA
 $\Delta=89^{\circ}35'52''$ $D=86^{\circ}48'42''$ $R=68.00'$ $L=103.21'$ $T=65.54'$ $E=27.01'$
 CURVE DATA BASED ON Q RADIUS $\Delta/2=44^{\circ}47'56''$

Q STATION	Q ARC LENGTH	FACE CURB LENGTH		CHORD LENGTH		DEFLECTION ANGLE	Q TOTAL DEFLECTION
		LEFT CURB	RIGHT CURB	8' OFF LEFT FACE CURB	8' OFF RIGHT		
26+53.67						00°00'00"	00°00'00"
27+00	46.33'	56.16'	36.50'	60.51'	30.26'	20°06'35"	20°06'35"
27+50	50.00'	60.61'	39.39'	65.08'	32.54'	21°42'11"	41°48'47"
27+56.88	6.88'	8.34'	5.42'	9.17'	4.58'	2°59'10"	44°47'56"
TOTAL							

Defl./ft.=26.043342 min.

Construct 6" Reinforced Concrete Drive.
 W=50'
 See Sheet No. 15

NOTE: THIS STREET TO BE CONSTRUCTED WITH ROLL-TYPE CURB. TOP OF CURB ELEVATIONS GIVEN ARE FOR FULL HEIGHT CURB.

Q CURVE DATA
 $\Delta=90^{\circ}32'15''$ $D=85^{\circ}48'42''$ $R=68.00'$ $L=104.29'$ $T=66.62'$ $E=27.78'$
 CURVE DATA BASED ON Q RADIUS $\Delta/2=45^{\circ}16'07.5''$

Q STATION	Q ARC LENGTH	FACE CURB LENGTH		CHORD LENGTH		DEFLECTION ANGLE	Q TOTAL DEFLECTION
		LEFT CURB	RIGHT CURB	8' OFF LEFT FACE CURB	8' OFF RIGHT		
28+27.33						00°00'00"	00°00'00"
28+50	22.67'	27.48'	17.86'	30.08'	15.04'	9°50'24"	9°50'24"
29+00	50.00'	60.61'	39.39'	65.08'	32.54'	21°42'12"	31°32'35"
29+31.62	31.62'	38.33'	24.91'	41.76'	20.88'	13°43'31.5"	45°16'07.5"
TOTAL	104.29'	126.41'	82.17'				

Defl./ft.=26.043964 min.

1	REVISED STREET GRADES—STA. 26+00 TO 26+53.67	By	12-18-01
No.	Revisions	By	Date
REMINGTON PLACE-PHASE I CITY OF WICHITA, KANSAS FREDERIC STA. 26+00 TO STA. 30+00			
Professional Engineering Consultants, P.A. 303 S. TOPEKA • WICHITA, KANSAS 67202 316-262-2691 • FAX 316-262-3003			
Designed by	BER	Checked by	
Drawn by	BJS	Date	DEC. 2001
		Job No.	0158

DSNR: BER OPER: BJS SCALE: 1"=20'
 i:/2001/01158/ST26-30R.DGN Plot Date: 1-9-2002