

CURVE DATA						
Δ=54°32'20"		D=50'23'00"		R=113.72'	L=108.25'	T=58.62'
CURVE DATA BASED ON Δ/RADIUS Δ/2=27°16'10"						
STATION	ARC LENGTH	FACE CURB LENGTH	CHORD LENGTH	DEFLECTION ANGLE	TOTAL DEFLECTION	
		LEFT CURB	RIGHT CURB		BOFF LEFT FACE CURB	BOFF RIGHT
22+11.57				00°00'00"	00°00'00"	00°00'00"
22+25	13.43'	11.96'	15.08'	10.83'	16.02'	3°23'00"
22+50	25.00'	22.26'	28.08'	20.12'	29.78'	6°40'52"
22+75	25.00'	22.26'	28.08'	20.12'	29.78'	6°17'52"
23+00	25.00'	22.26'	28.08'	20.12'	29.78'	6°17'52"
23+19.82	19.82'	17.65'	22.26'	15.96'	23.62'	4°59'35"
TOTAL	108.25'	96.38'	121.57'			Defl./ft.=15.114703 min.

PROJECT NO.	SHEET NO.	TOTAL SHEETS
472-76-245-83375-000-000-001	9	58

WATER VALVE BOX ELEVATIONS			
STREET	STATION	OFFSET	PROPOSED ELEVATION
FREDERIC	20+53.40	21'0" LL	207.0
FREDERIC	23+69.7	20'0" LL	209.6
FREDERIC	23+72.7	23'0" LL	209.7

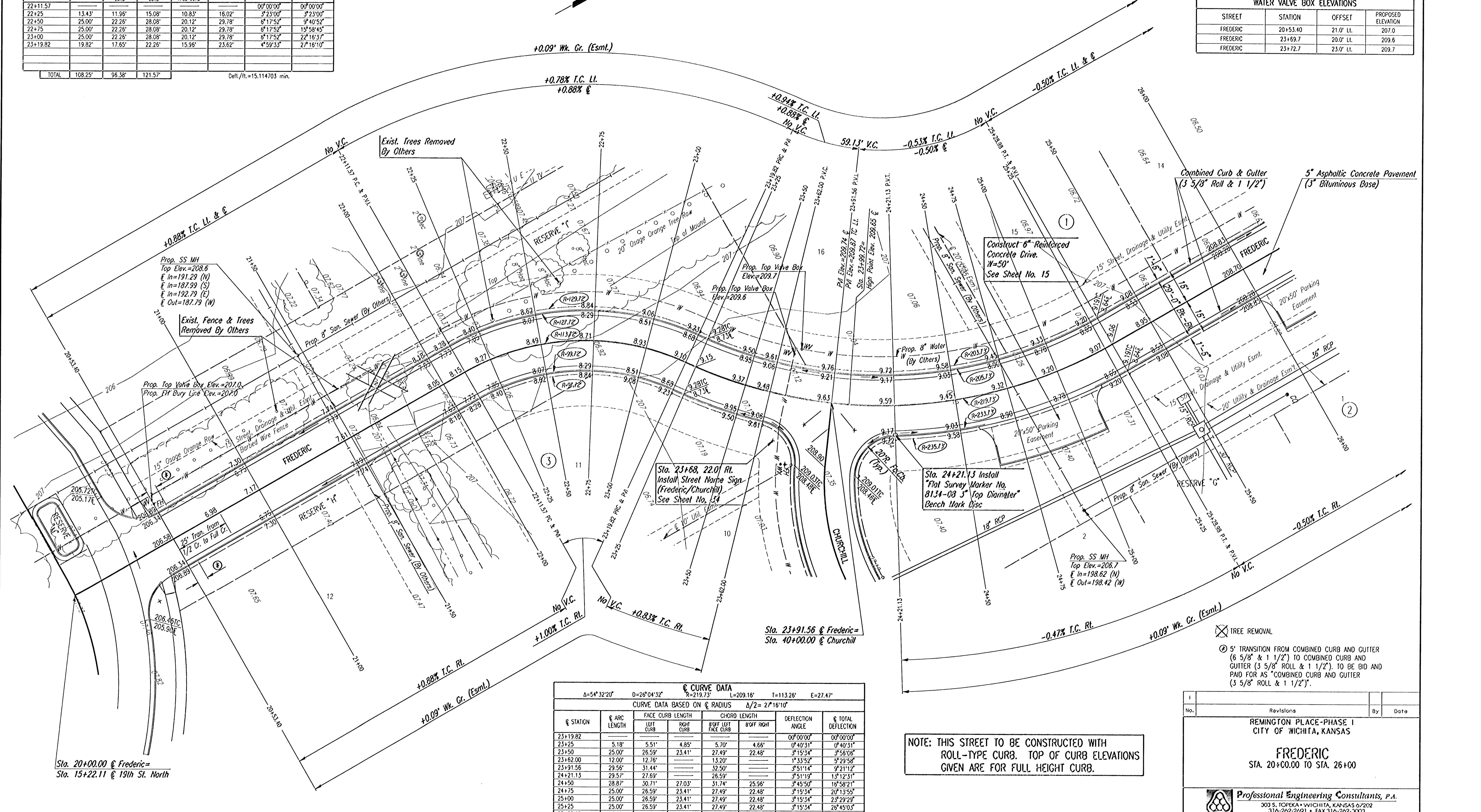

CURVE DATA						
Δ=54°32'20"		D=26°04'32"		R=219.73'	L=209.16'	T=113.26'
CURVE DATA BASED ON Δ/RADIUS Δ/2=27°16'10"						
STATION	ARC LENGTH	FACE CURB LENGTH	CHORD LENGTH	DEFLECTION ANGLE	TOTAL DEFLECTION	
		LEFT CURB	RIGHT CURB		BOFF LEFT FACE CURB	BOFF RIGHT
23+19.82				00°00'00"	00°00'00"	00°00'00"
23+25	5.18'	5.51'	4.85'	5.70'	4.66'	0°40'31"
23+50	25.00'	26.59'	23.41'	27.49'	22.48'	3°15'34"
23+62.00	12.00'	12.76'		13.20'		1°33'52"
23+91.56	29.56'	31.44'		32.50'		3°51'14"
24+21.13	29.57'	27.69'		26.59'		3°51'19"
24+50	28.87'	30.71'	27.03'	31.74'	25.96'	3°45'50"
24+75	25.00'	26.59'	23.41'	27.49'	22.48'	3°15'34"
25+00	25.00'	26.59'	23.41'	27.49'	22.48'	3°15'34"
25+25	25.00'	26.59'	23.41'	27.49'	22.48'	3°15'34"
25+28.98	3.98'	4.23'	3.72'	4.38'	3.58'	0°31'07"
TOTAL	209.16'	222.48'	195.83'			Defl./ft.=7.679129 min.

NOTE: THIS STREET TO BE CONSTRUCTED WITH ROLL-TYPE CURB. TOP OF CURB ELEVATIONS GIVEN ARE FOR FULL HEIGHT CURB.

- ⊗ TREE REMOVAL
- ⊙ 5' TRANSITION FROM COMBINED CURB AND GUTTER (6 5/8" & 1 1/2") TO COMBINED CURB AND GUTTER (3 5/8" ROLL & 1 1/2"). TO BE BID AND PAID FOR AS "COMBINED CURB AND GUTTER (3 5/8" ROLL & 1 1/2)".

Revisions		By	Date
No.			
REMINGTON PLACE-PHASE I CITY OF WICHITA, KANSAS  <b>FREDERIC</b> STA. 20+00.00 TO STA. 26+00			
<b>Professional Engineering Consultants, P.A.</b> 303 S. TOPICKA • WICHITA, KANSAS 67202 316-262-2291 • FAX 316-262-3003			
Designed by	BER	Checked by	
Drawn by	BJS	Date	JUNE 2001
		Job No.	01158

DSNR: BER OPER: BJS SCALE: 1"=20'  
 I:2001/01158/STR20-26.DGN Plot Date: 10-23-2001