

CURVE DATA							
Δ=33°44'18"		D=54°34'03"		R=105.00'	E=4.72'		
CURVE DATA BASED ON Δ RADIUS Δ/2=16°52'09"							
STATION	ARC LENGTH	FACE CURB LENGTH	CHORD LENGTH	DEFLECTION ANGLE	Δ TOTAL DEFLECTION		
		LEFT CURB	RIGHT CURB	8' OFF LEFT FACE CURB	8' OFF RIGHT		
40+30.55				00°00'00"	00°00'00"		
40+33.98	3.43'						
40+50	16.02'	3.89'	4.15'	07°58'09"	07°58'09"		
40+75	25.00'	13.88'	18.16'	12.65'	19.36'	4°22'15"	5°18'24"
40+92.37	17.38'	22.06'	28.33'	19.72'	30.17'	8°49'15"	12°07'39"
		15.33'	19.70'	13.72'	21.00'	4°44'30"	16°52'09"
TOTAL	61.83'	54.55'	70.07'				

Defl./ft.=16.372533 min.

WATER VALVE BOX ELEVATIONS			
STREET	STATION	OFFSET	PROPOSED ELEVATION
CHURCHILL	40+30.55	21.0' RL	210.0
CHURCHILL	42+75.72	20.0' RL	210.0
CHURCHILL	43+90.72	23.0' RL	210.8
CHURCHILL	44+00.72	23.0' RL	211.0

PROJECT NO.	SHEET NO.	TOTAL SHEETS
472-76-245-83375-000-000-001	12R	58

SCALE: 1"=20'

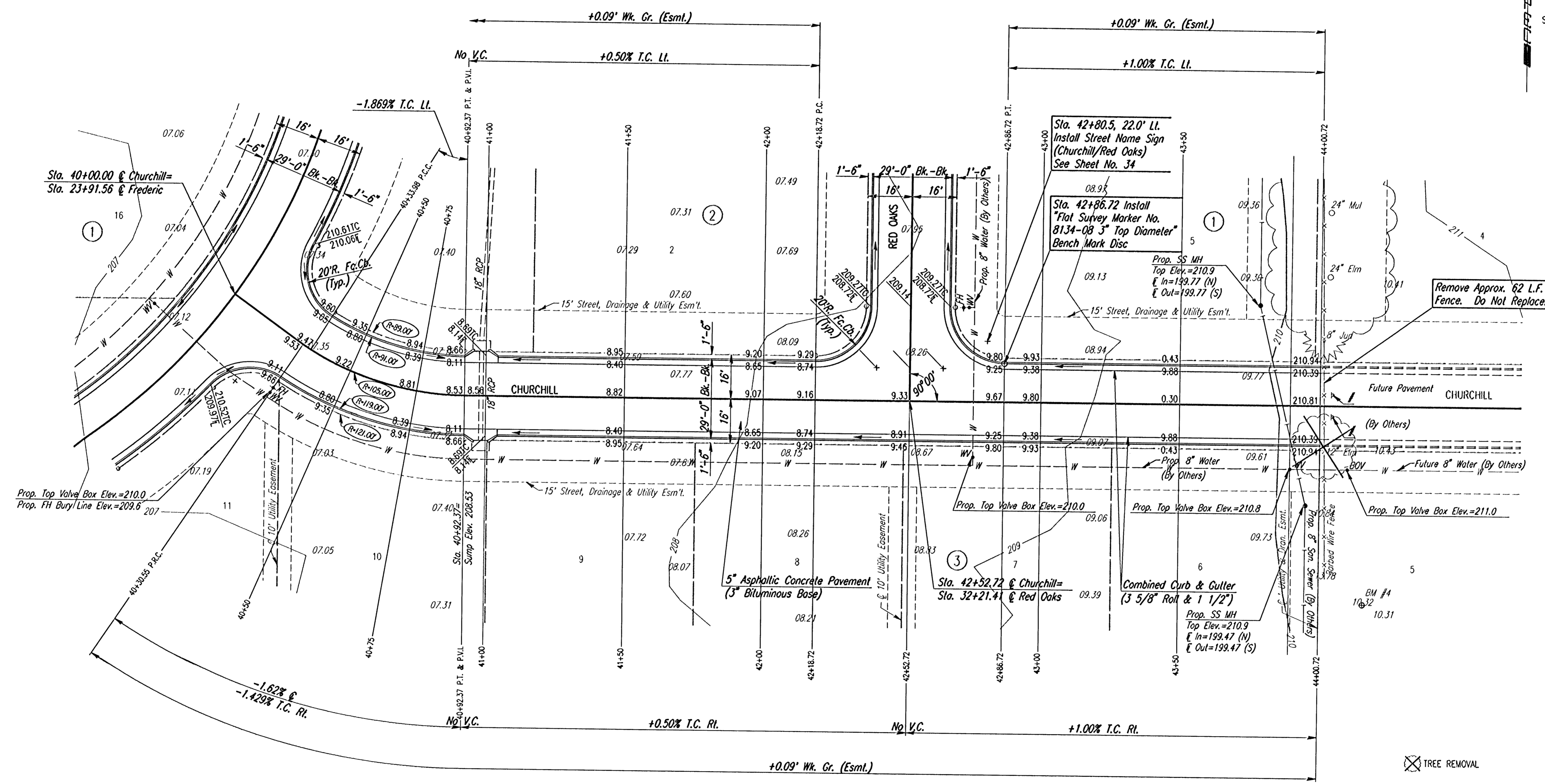

NOTE: THIS STREET TO BE CONSTRUCTED WITH ROLL-TYPE CURB. TOP OF CURB ELEVATIONS GIVEN ARE FOR FULL HEIGHT CURB.

DSNR: BER OPER: BJS SCALE: 1"=20'
 i:/2001/01158/ST40-45R.DGN Plot Date: 1-9-2002

⊗ TREE REMOVAL

SEE SHEET NO. 34 FOR SIGNING NOTES & DETAILS.

1	REVISED STREET GRADES—STA. 40+30 TO 40+92	BJS	12-18-01
No.	Revisions	By	Date

REMINGTON PLACE-PHASE I
CITY OF WICHITA, KANSAS

CHURCHILL
STA. 40+00 TO STA. 44+00.72

Professional Engineering Consultants, P.A.
300 S. TOPEKA • WICHITA, KANSAS 67202
316-262-2691 • FAX 316-262-3003

Designed by	BER	Checked by	
Drawn by	BJS	Date	DEC. 2001
		Job No.	0158