

Sta. 20+00.0 SWS Line No. 2=
Sta. 62+60.45, 20.67° Rt. @ 19th St. N.
Construct Std. Type 1A Curb Inlet
L=5'-0", W=3'-0"
Top Elev.=207.23
Install 51.3 L.F. 30" RCP (NW)
See Sheet Nos. 24 & 33

Sta. 20+51.3 SWS Line No. 2=
Sta. 62+30.00, 20.67° Lt. @ 19th St. N.
Construct Std. Type 1A Curb Inlet
L=10'-0", W=3'-0"
Top Elev.=207.33
Install 116.3 L.F. 24" RCP (N)
See Sheet Nos. 23, 25 & 33

Sta. 21+67.6 SWS Line No. 2=
Sta. 40+00.0 SWS Line No. 2A
Construct Std. Area Inlet
L=5'-4", W=3'-10"
Top Elev.=205.30
Install 176.0 L.F. 15" RCP (W)
Install 166.0 L.F. 24" RCP (E)
See Sheet Nos. 26, 31 & 32

Sta. 18+30.0 SWS Line No. 2
Install 170.0 L.F. 36" RCP (N)
(Including End Section)

Install 35 S.Y.
Light Stone Riprap
See Sheet No. 23

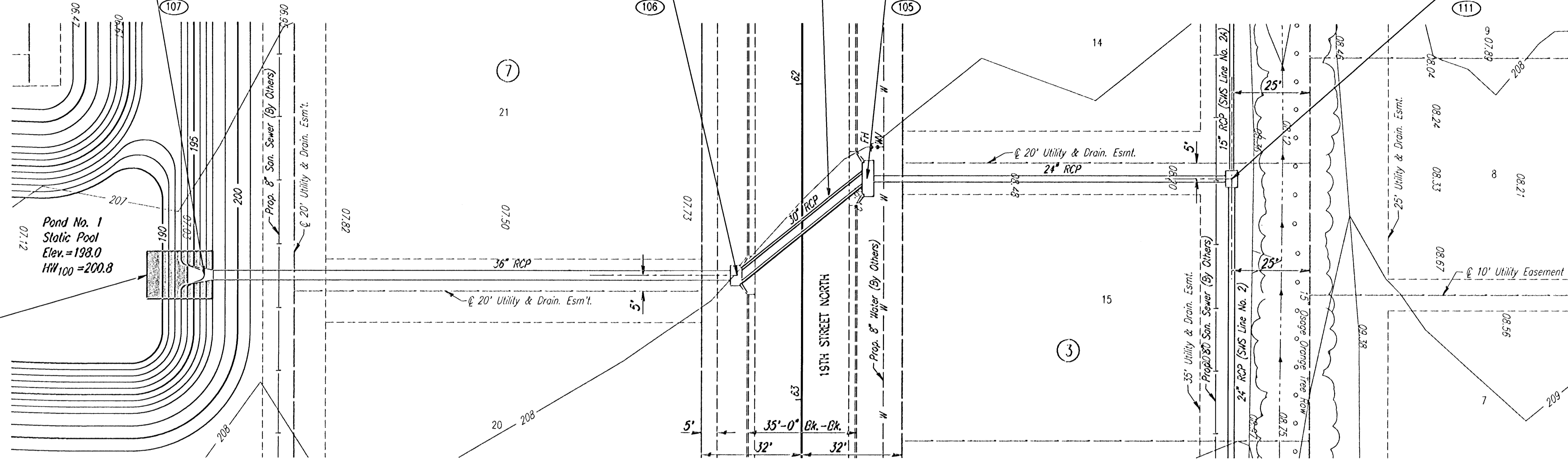

SWS LINE NO. 2 COORDINATE LIST		
POINT	NORTH	EAST
105	385777.2793	2370492.6725
106	385736.2753	2370523.4765
107	385566.2863	2370525.3445
111	385893.6033	2370491.3945

⊙ Curb Center Wall.
See Reinf. Lid Detail,
Sheet No. 23

I: 2001/0158:swsin2-1.dgn
Date Plotted: Oct. 23, 2001
Deliver to: Brent Remsberg

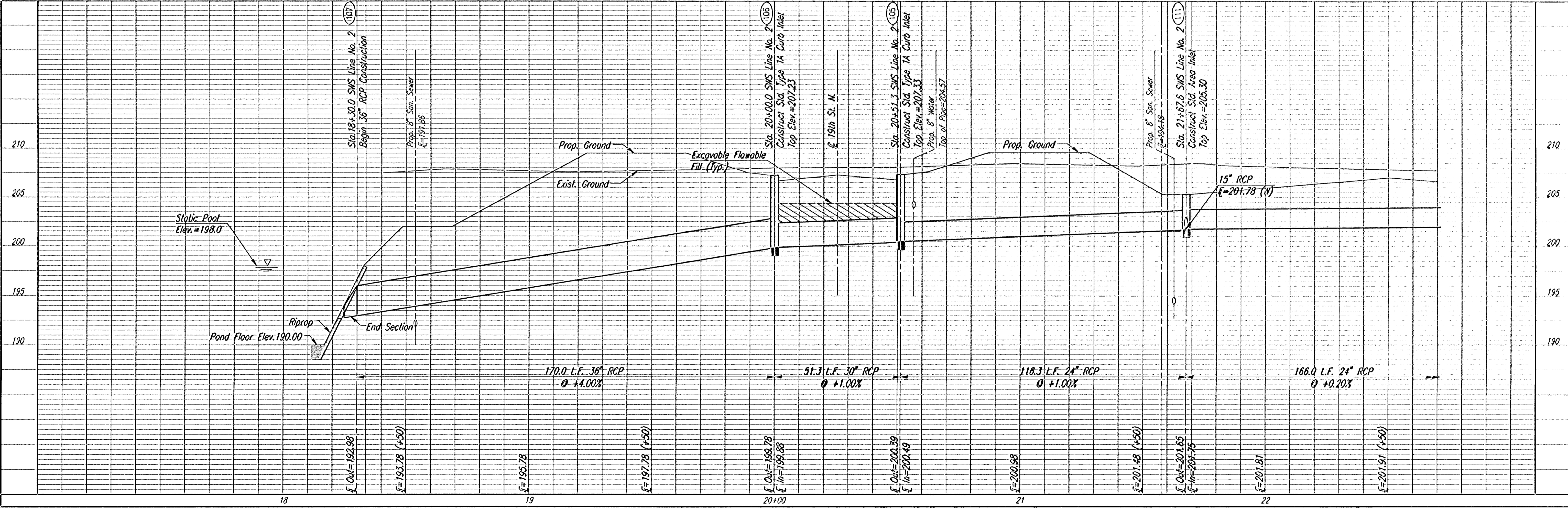

Professional Engineering Consultants, P.A.
303 S. TOPERA • WICHITA, KANSAS 67202
316-262-2991 • FAX 316-262-3003

Job No. 01135 Date: JUNE 2001

Drawn by: BCR
Checked by: BCS

REMINGTON PLACE - PHASE 1
SWS LINE NO. 2
STA. 18+30.0 TO STA. 21+67.6

C.O.W. PROJ. NO. 472-76-245-63375-000-000-001