

$\Delta = 63^\circ 46' 53''$ $L = 178.07'$ $R = 160.00'$ $T = 99.53'$

STATION	CL ARC	CHORD LENGTH			TOTAL DEFLECTION	
		8' LT.	CL	8' RT.	DEFLECTION	DEFLECTION
15+50.09 P.C.						
15+75.00	24.91'	20.92'	24.88'	28.85'	4'27"36"	4'27"36"
16+00.00	25.00'	20.99'	24.97'	28.95'	4'28"34"	8'56"11"
16+10.76	10.76'	9.04'	10.76'	12.47'	1'55"36"	10'51"47"
16+25.00	14.24'	11.97'	14.24'	16.50'	2'32"59"	13'24"45"
16+50.00	25.00'	20.99'	24.97'	28.95'	4'28"34"	17'53"20"
16+75.00	25.00'	20.99'	24.97'	28.95'	4'28"34"	22'21"54"
17+00.00	25.00'	20.99'	24.97'	28.95'	4'28"34"	26'50"29"
17+25.00	25.00'	20.99'	24.97'	28.95'	4'28"34"	31'19"3"
17+28.16 P.T.	3.16'	2.66'	3.16'	3.67'	0'33"59"	31'53"2"

DEFLECTION/FOOT = 1.79049311 DEGREES 10.742958659 MINUTES

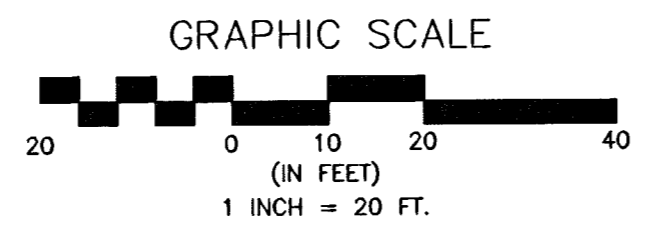

$\Delta = 23^\circ 16' 28''$ $L = 81.24'$ $R = 200.00'$ $T = 41.19'$

STATION	CL ARC	CHORD LENGTH			TOTAL DEFLECTION	
		8' LT.	CL	8' RT.	DEFLECTION	DEFLECTION
19+75.20 P.C.						
20+00.00	24.80'	27.94'	24.78'	21.62'	3'33"8"	3'33"8"
20+25.00	25.00'	28.17'	24.98'	21.80'	3'34"52"	7'8"0"
20+50.00	25.00'	28.17'	24.98'	21.80'	3'34"52"	10'42"52"
20+56.44 P.T.	6.44'	7.26'	6.44'	5.62'	0'55"22"	11'38"14"

DEFLECTION/FOOT = 1.43239449 DEGREES 8.594366927 MINUTES

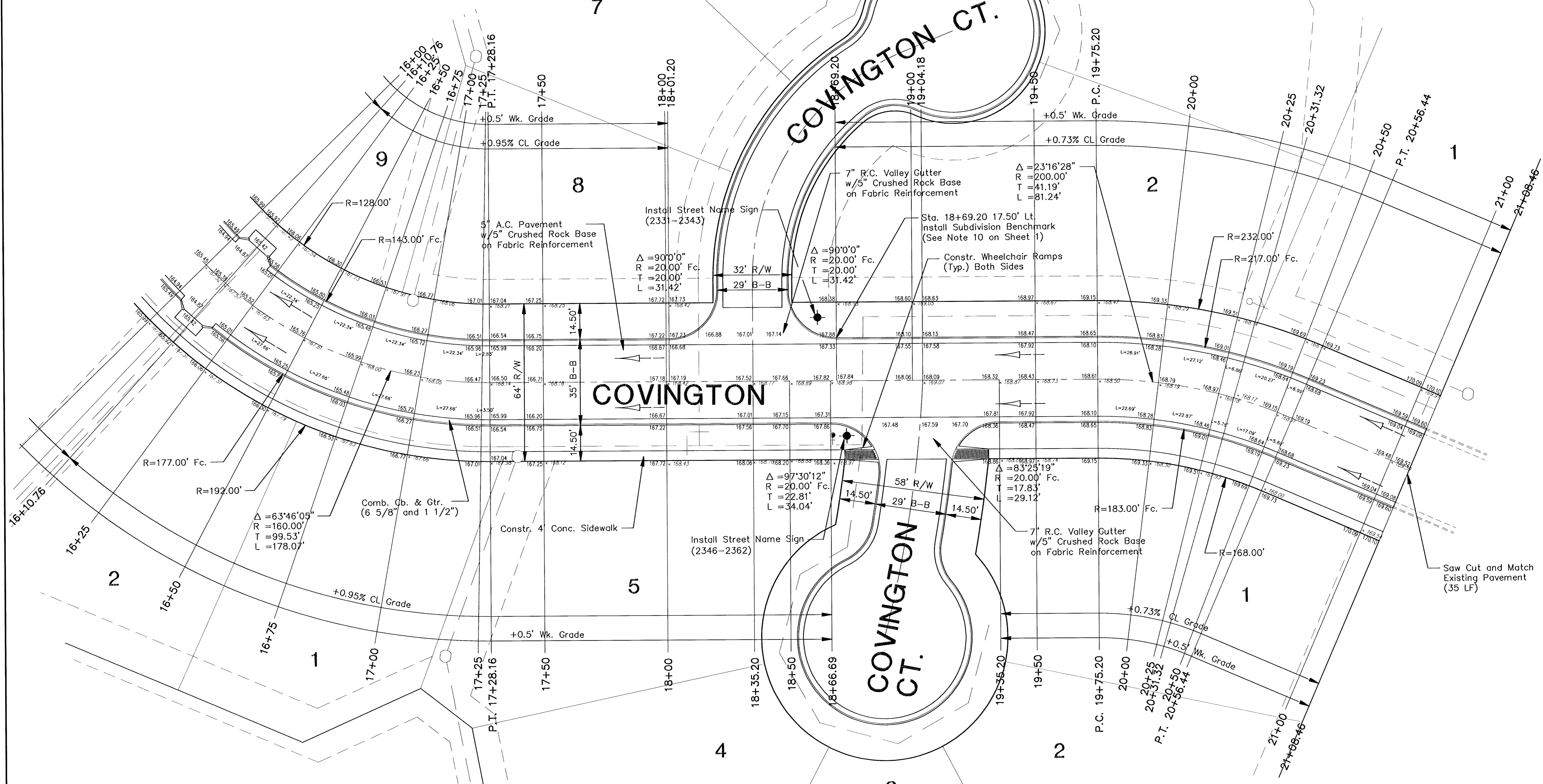

No.	Street and Station	From CL	Description	Elevation
1	Covington, 18+69.20	17.50' NW	Top of Curb (NW) Return (NW) of Covington Ct.	167.88

FINAL

Engineer: J. Ubert
 Drawn By: B. Kullig
 Pce Job No.: 1656B
 Date: May 2001

POE & ASSOCIATES OF KANSAS, INC.
 CONSULTING ENGINEERS
 5940 E. Central, Suite 200 ■ Wichita, KS 67208-1242
 Phone 316/685-4114 ■ FAX 316/685-4444

THE LOCHS AT ABERDEEN
 STREET IMPROVEMENTS
 COVINGTON
 CITY OF WICHITA, KANSAS
 MICHAEL E. LINDEBAK, P.E. - CITY ENGINEER
 Proj# 472-83359 O.C.# 765881

No. _____ Date _____
 By: _____ Approved: _____
 JMU 10/7/01 JMU JMU
 Revised Curve Tables

G:\APPS\DCAP\6660\base.dwg Tue Oct 02 11:02:23 2001 James Ubert - Poe & Associates of Kansas, Inc.