

PROJECT NO.	SHEET NO.	TOTAL SHEETS
472-83468	12	55

WATER VALVE BOX ELEVATIONS			
STREET	STATION	OFFSET	PROPOSED ELEVATION
BRACKEN CIRCLE	45+33.46	22.0' RL	1362.2
BRACKEN CIRCLE	49+24.83	60.75' LT.	1372.7

SCALE: 1"=20'

Sta. 49+24.82 @ Bracken Circle, 21' Lt. =
Ctr. Cul-de-sac

Sta. 45+00.00 @ Bracken Circle =
Sta. 24+97.07 @ Bracken

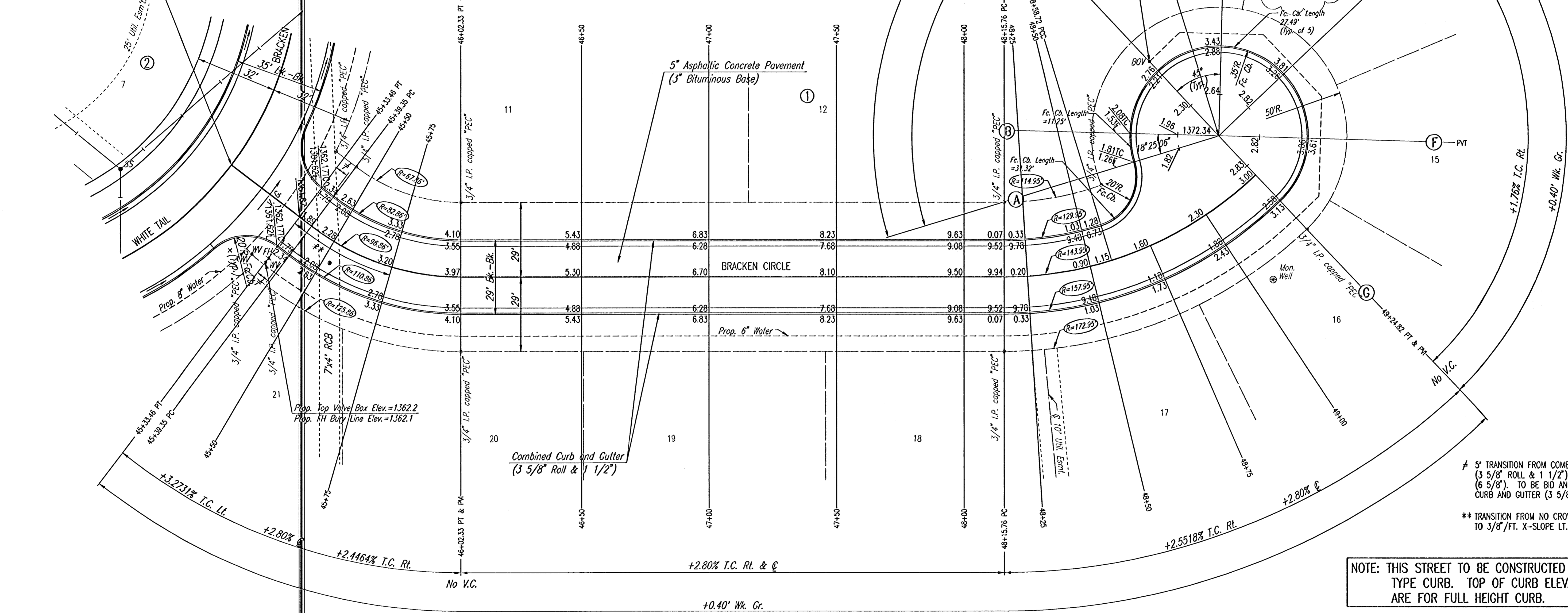

5' TRANSITION FROM COMBINED CURB AND GUTTER (3 5/8\"/>

** TRANSITION FROM NO CROWN LT. AND RT. TO 3/8\"/>

NOTE: THIS STREET TO BE CONSTRUCTED WITH ROLL-TYPE CURB. TOP OF CURB ELEVATIONS GIVEN ARE FOR FULL HEIGHT CURB.

@ CURVE DATA						
$\Delta=37^{\circ}15'10''$		$D=59^{\circ}09'11''$		$R=96.86'$		$E=5.35'$
CURVE DATA BASED ON @ RADIUS $\Delta/2=18^{\circ}37'35''$						
@ STATION	@ ARC LENGTH	FACE CURB LENGTH	CHORD LENGTH	DEFLECTION ANGLE	@ TOTAL DEFLECTION	
		LEFT CURB	RIGHT CURB		8' OFF LEFT FACE CURB	8' OFF RIGHT FACE CURB
45+39.35				0°00'00"	0°00'00"	0°00'00"
45+50	10.65'	9.31'	12.19'	8.23'	13.06'	3°09'00"
45+75	25.00'	21.84'	28.61'	19.27'	30.59'	7°23'39"
46+100	25.00'	21.84'	28.61'	19.27'	30.59'	7°23'39"
46+102.33	2.33'	2.03'	2.66'	1.80'	2.86'	0°41'17"
TOTAL	62.98'	55.02'	72.08'			18°37'35"

Defl./ft. = 17.444218 min.

@ CURVE DATA						
$\Delta=43^{\circ}24'35''$		$D=39^{\circ}48'09''$		$R=143.95'$		$E=10.98'$
CURVE DATA BASED ON @ RADIUS $\Delta/2=21^{\circ}42'17.5''$						
@ STATION	@ ARC LENGTH	FACE CURB LENGTH	CHORD LENGTH	DEFLECTION ANGLE	@ TOTAL DEFLECTION	
		LEFT CURB	RIGHT CURB		8' OFF LEFT FACE CURB	8' OFF RIGHT FACE CURB
48+15.76				0°00'00"	0°00'00"	0°00'00"
48+25	9.24'	8.42'	10.14'	7.83'	10.65'	1°50'20"
48+50	25.00'	22.78'	27.43'	21.15'	28.78'	4°58'31"
48+58.72	8.72'	7.95'	9.57'	7.39'	10.05'	1°44'07"
48+75	16.28'	14.84'	17.86'	13.78'	18.76'	3°14'24"
49+00	25.00'	22.78'	27.43'	21.15'	28.78'	4°58'31"
49+24.82	24.82'	22.62'	27.24'	21.00'	28.58'	4°56'24"
TOTAL	109.05'	99.40'	119.67'			21°42'17.5"

Defl./ft. = 11.562780 min.

DSNR: DEP OPER: SAD SCALE: 1"=20.00
 C:\2001\01645\000\BRACKENCIR 03-13-2002 04:02:26 pm

BALTHROP 4TH ADDITION

BRACKEN CIRCLE

STA. 45+00.00 TO STA. 49+24.82

Professional Engineering Consultants, P.A.

303 S. TOPEKA - WICHITA, KANSAS 67202
316-262-2691 • FAX 316-262-3003

Designed by BER	Checked by
Drawn by DEP	Date FEB. 2002
	Job No. 01545