

LINWOOD ACRES

CJJ 2ND ADDITION

KELLOGG AVE. (U.S. HWY 54)

KELLOGG DRIVE

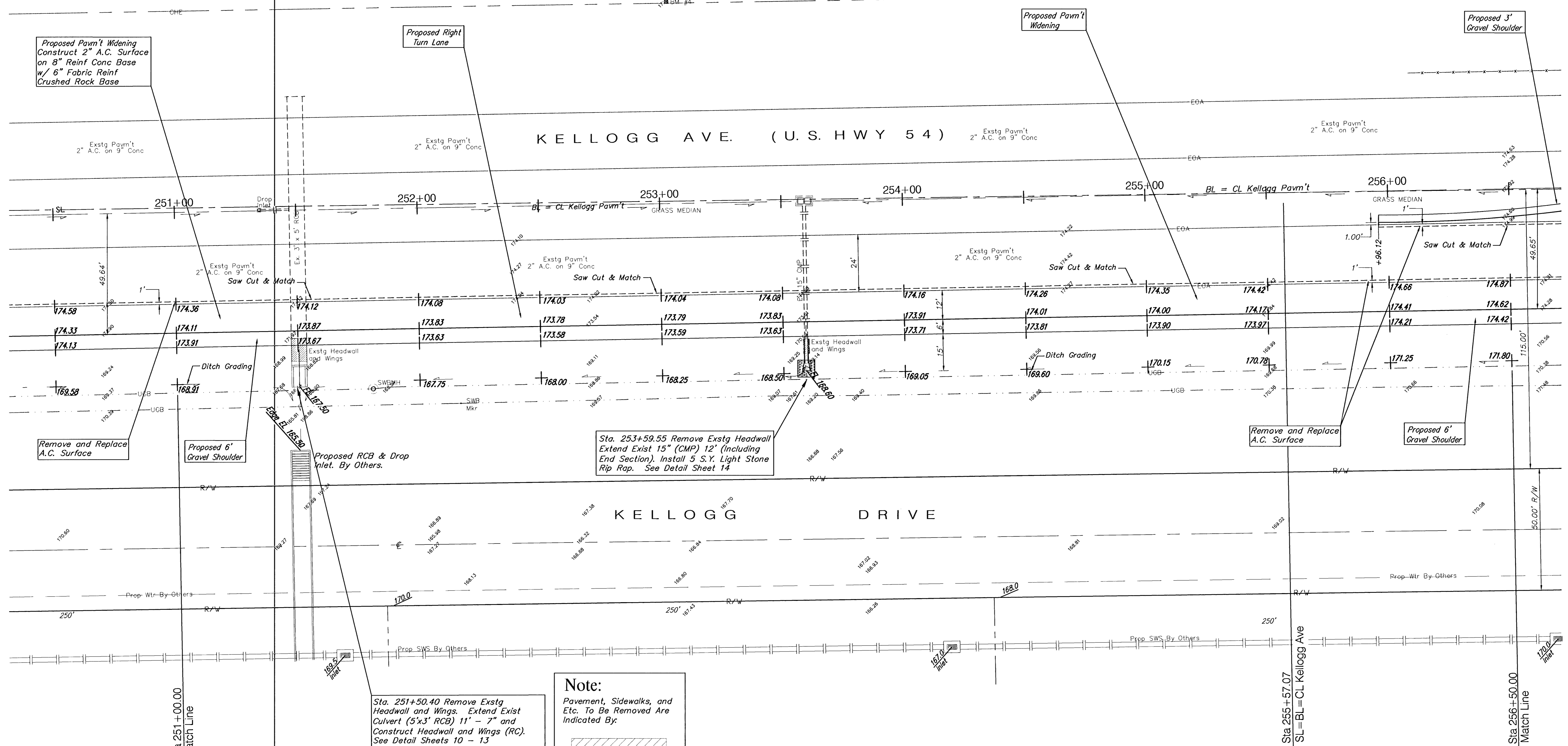

Proposed Pavm't Widening  
Construct 2" A.C. Surface  
on 8" Reinf Conc Base  
w/ 6" Fabric Reinf  
Crushed Rock Base

Proposed Right  
Turn Lane

Proposed Pavm't  
Widening

Proposed 3'  
Gravel Shoulder

Remove and Replace  
A.C. Surface

Proposed 6'  
Gravel Shoulder

Proposed RCB & Drop  
Inlet. By Others.

Sta. 253+59.55 Remove Exstg Headwall  
Extend Exist 15" (CMP) 12' (Including  
End Section). Install 5 S.Y. Light Stone  
Rip Rap. See Detail Sheet 14

Remove and Replace  
A.C. Surface

Proposed 6'  
Gravel Shoulder

Sta. 251+50.40 Remove Exstg  
Headwall and Wings. Extend Exist  
Culvert (5'x3' RCB) 11' - 7" and  
Construct Headwall and Wings (RC).  
See Detail Sheets 10 - 13

**Note:**  
Pavement, Sidewalks, and  
Etc. To Be Removed Are  
Indicated By:

PROJECT NUMBER 472-83372		SHEET NAME Pav03		ENGINEERING DIRECTORY F:\Kellog_gr\Pav	
DESIGN JFB	DRAWN STAFF	APPROVED JFB	DATE May 01	SCALE NOTED	BAUGHMAN NO 01 01 E914

ONE KELLOGG PLACE 2ND ADDITION  
**PAVING PLAN**  
KELLOGG AVE FROM DOWEL TO BRUNDIGE ROAD

**BAUGHMAN COMPANY, P.A.**  
ENGINEERING, SURVEYING, & PLANNING  
318-282-7271 • 315 ELLIS • WICHITA, KANSAS 67211

SHEET  
7  
OF  
46