

PART OF WICHITA MUNICIPAL
AIRPORT ADDITION

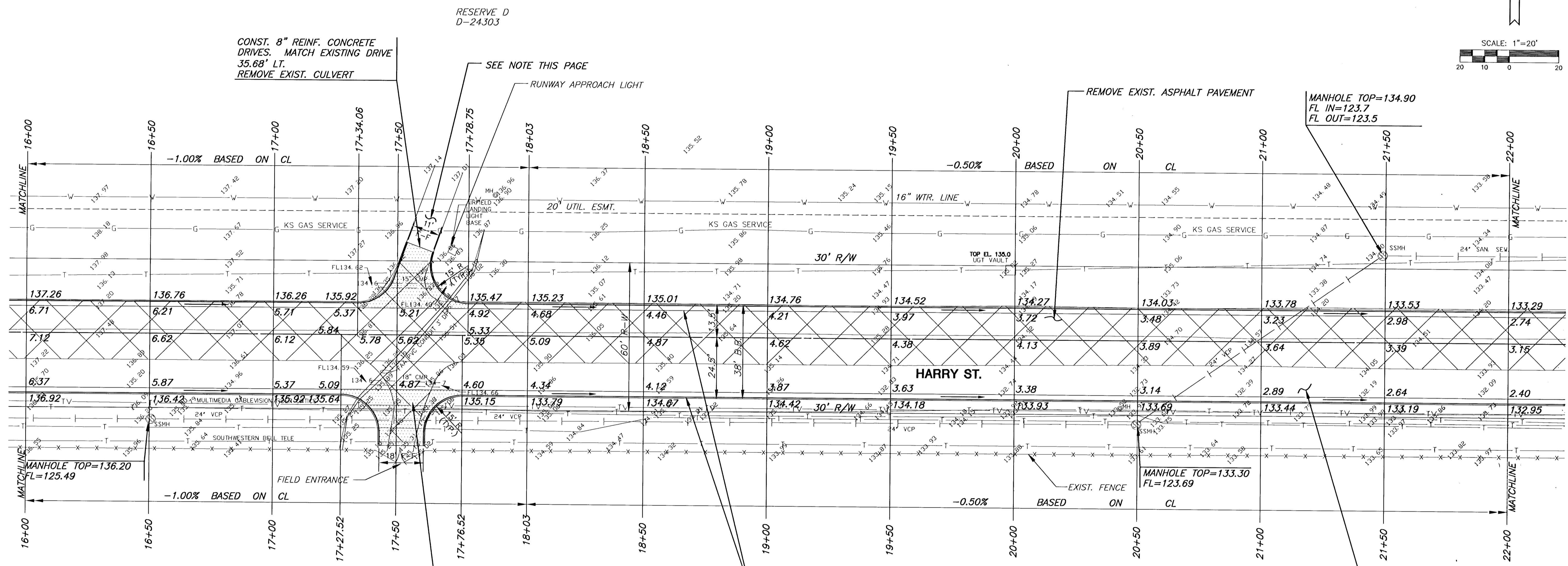
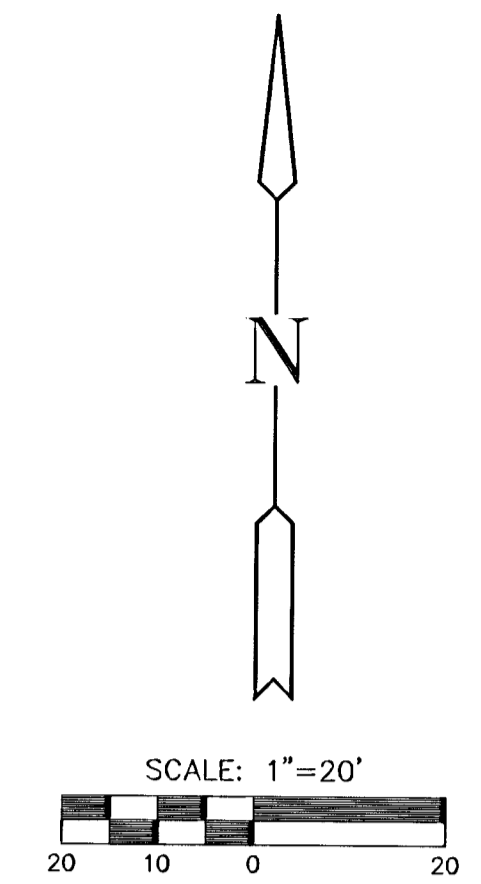

CONST. 8" REINF. CONCRETE
DRIVES. MATCH EXISTING DRIVE
35.68' LT.
REMOVE EXIST. CULVERT

RESERVE D
D-24303

SEE NOTE THIS PAGE
RUNWAY APPROACH LIGHT

REMOVE EXIST. ASPHALT PAVEMENT

MANHOLE TOP=134.90
FL IN=123.7
FL OUT=123.5

MANHOLE TOP=136.20
FL=125.49

MANHOLE TOP=133.30
FL=123.69

CONST. 8" REINF. CONCRETE
DRIVES. MATCH EXISTING DRIVE
AT 2' NORTH OF FENCE.
REMOVE EXIST. CULVERT

CONST. COMBINATION CURB AND
GUTTER (FULL 6 5/8")

CONST. 7" A.C. PAVEMENT
ON 6" CRUSHED ROCK BASE
W/GEOGRID REINF.

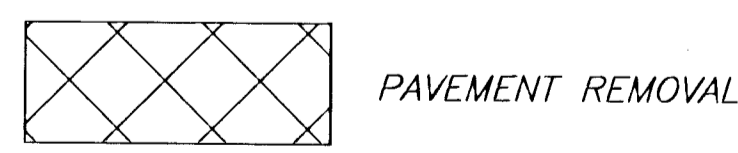

PART OF WICHITA MUNICIPAL
AIRPORT ADDITION

PART OF RESERVE F
D-24305

NOTE: CONTRACTOR TO PROVIDE AND MAINTAIN ACCESS FOR
FLIGHT SAFETY CREWS TO RUNWAY APPROACH LIGHTS AT ALL
TIMES THROUGHOUT CONSTRUCTION. THE COST OF THIS
WORK WILL BE SUBSIDIARY TO ASPHALT PAVING.

<p>411 N. WEBB ROAD WICHITA, KS. 67206 316-684-9600</p>	LEARJET WAY IMPROVEMENTS		
	PROJECT NAME		
	PAVING PLANS		
	SHEET TITLE		
JTC/GJA	TLT/BSH	JTC/GJA	
DESIGN BY:	DRAWN BY:	CHECKED BY:	
OCTOBER 2000	99034_E2	6 / 14	
DATE	DRAWING NAME	SHEET / OF	

H:\CIVIL\99034\PAVE\99034_E2.DWG Tue Nov 28 12:04:42 2000