

PARTIAL SECOND FLOOR FRAMING PLAN

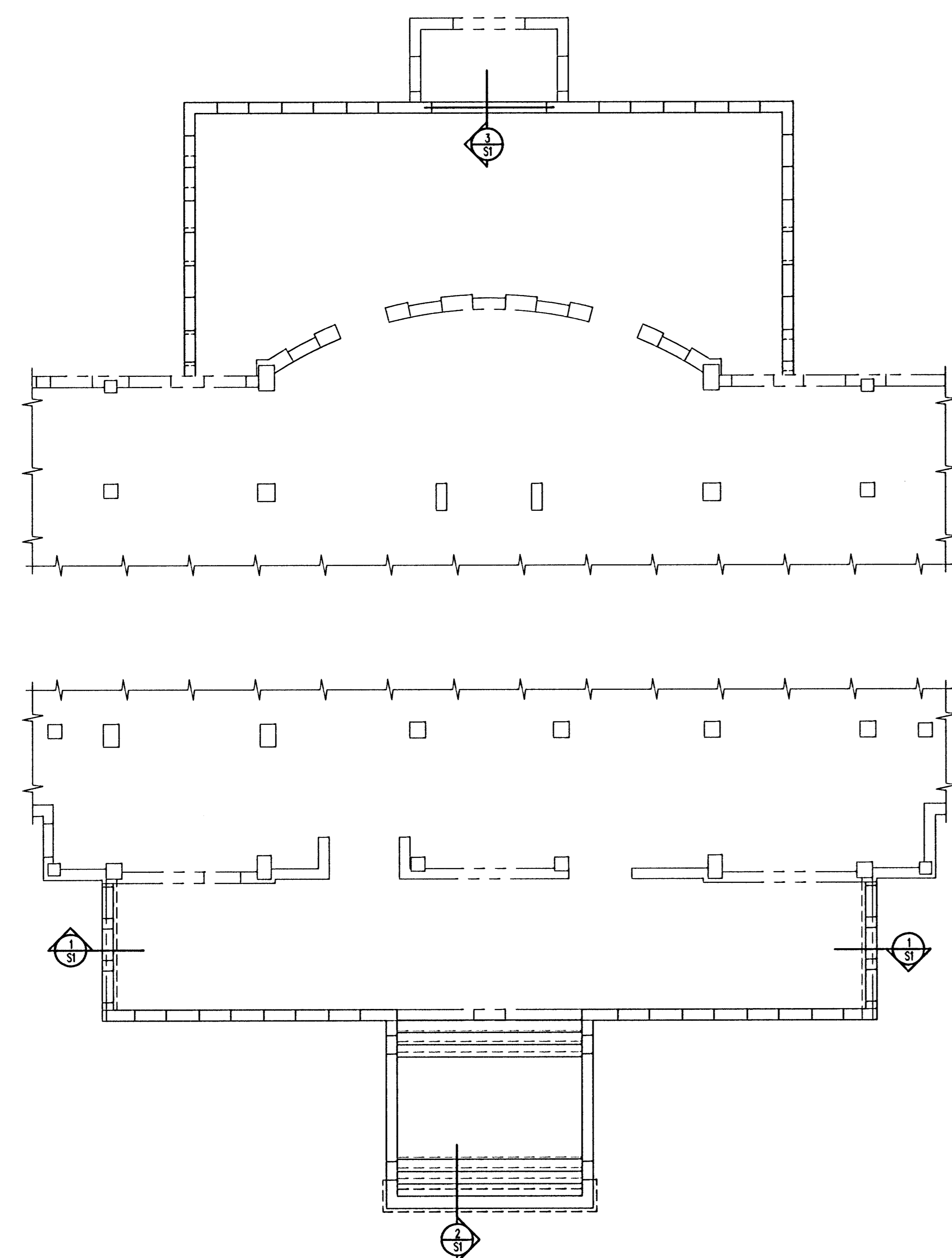

PARTIAL FIRST FLOOR FRAMING PLAN

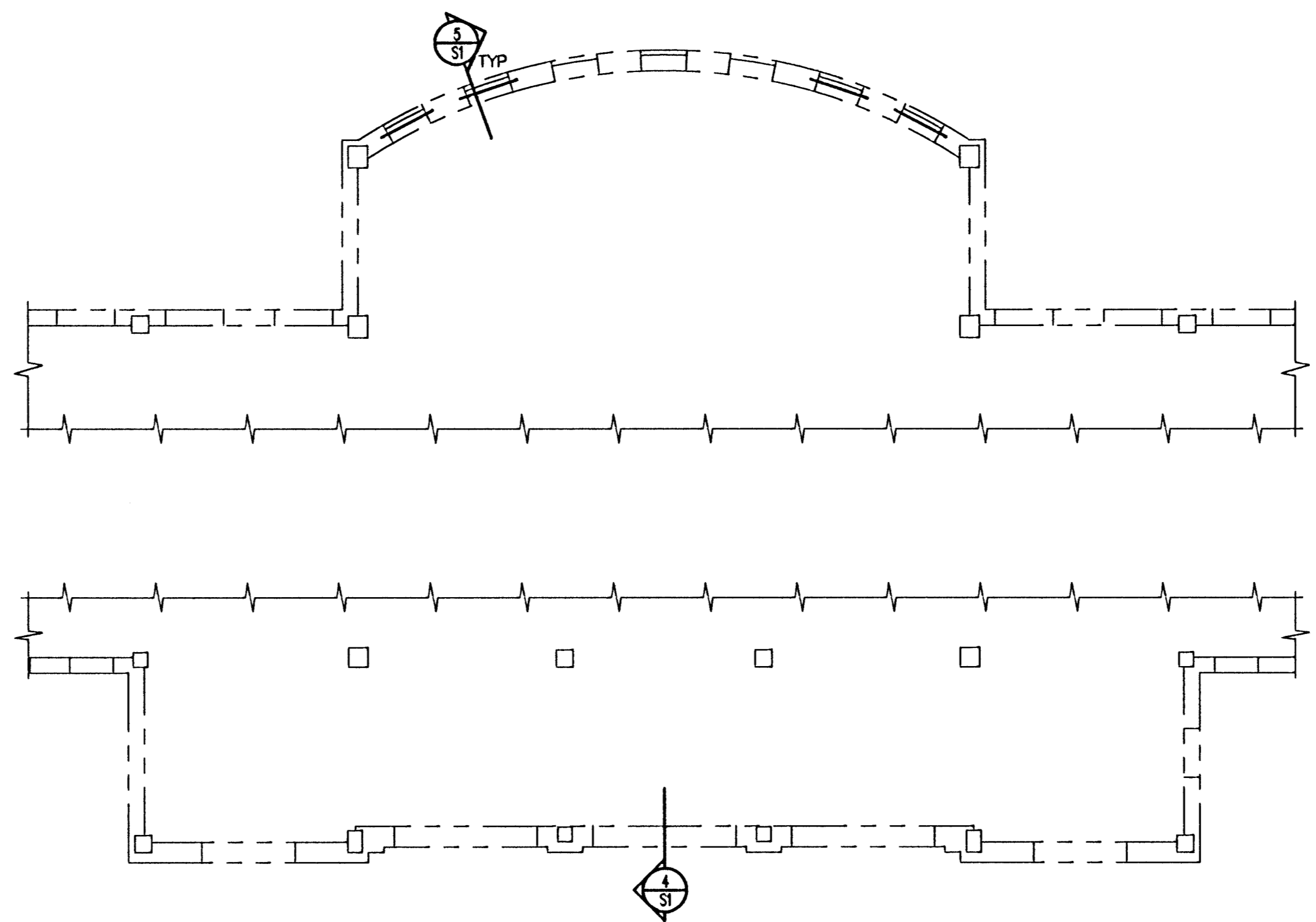

PARTIAL ROOF FRAMING PLAN

Contractor Shall Field Verify All Existing Dimensions, Elevations, and Conditions. Notify Architect for Direction if the Actual Conditions Differ From the Conditions Shown or Implied on the Drawings.

GENERAL STRUCTURAL NOTES
 Verify all dimensions and elevations with Architect's plans. See Architect's plans for exact dimensions for openings in walls, roof and floor systems. Contractor shall design, provide, and maintain temporary bracing, shoring, gaging, etc. and other methods as required to prevent excessive loading and to stabilize structural elements during construction. These methods shall remain in place until all members and final connections have been completed.

CAST-IN-PLACE CONCRETE
 All concrete shall have a minimum compressive strength of 4000 psi at 28 days. All aggregates for normal weight concrete shall meet ASTM C33. Aggregates shall be proportioned such that mix design shall contain a minimum of 50% coarse aggregates by gradation requirements set forth in ASTM C33. Coarse aggregate shall meet No. 61 grading requirements. Exterior exposed concrete shall have from 4 to 7% entrained air. Concrete shall be in strict conformance with the current "ACI Manual of Concrete Practice". No admixts shall be placed in concrete. Chamer at exposed edges of concrete 3". Walls shall be 4" thick with 6x6-1/2x1/2 HUP.

CONCRETE OVERLAY
 Verify condition of existing slab prior to starting work. Review findings with Architect. Sandblast the exposed slab surface to remove all deleterious materials such as oil, dirt, dust, and grease. Wet the prepared surface to a saturated surface dry condition, no water should be standing on the surface. Immediately prior to placing the overlay, the existing slab shall be treated with an 1/4" thick layer of grout paste consisting of one part cement, one part sand and just enough water to make a creamy paint-like consistency. The grout paste should be applied in a manner that allows the concrete overlay to be placed with the grout paste is still wet. The grout paste must not be allowed to dry prior to the placement of the concrete overlay. Concrete overlay shall contain a maximum aggregate size of 3/4". Concrete overlay shall contain 15 lbs. of 3/4" polypropylene fibers (Fibermesh or approved equal) per cubic yard.

REINFORCING STEEL
 All mesh shall meet ASTM A-185. Lap a minimum of 6". Finish mesh for slabs of concrete joist systems and slabs on metal deck in flat sheets. All reinforcing shall meet ASTM A615-60000. Reinforcing shall be continuous and lapped a minimum of 24" or 30 bar diameters whichever is greater, unless otherwise noted. Provide corner lap bars to match in size and spacing of all horizontal bars. Field bend stair slab bars. Provide 3" slab bolter with continuous bottom plate at 4'-0" maximum centers for positioning all grade beam bottom bars and all footing bars. Mark each bundle of reinforcing with weatherproof tags.

STRUCTURAL STEEL
 All structural steel shall meet ASTM A36. Welding shall conform to AWS D11, "Structural Welding Code". No unauthorized welds will be accepted. E70xx electrodes shall be used for all welding.

DRILL-IN ANCHORS
 All drill-in anchors shall be installed per manufacturer's recommendations. Adhesive anchors or reinforcing bars installed into concrete shall use Hilti HIT HY-150 System or equal. Adhesive anchors installed into brick masonry shall use Hilti HIT HY-20 System or equal. Holes shall be drilled with the recommended bit size, the minimum embedment length specified, and thoroughly cleaned out with a brush and compressed air prior to installing anchor. Hilti HIT HY-20/HY-150 and Rammed/Red Head EPOX Concrete 6 are approved equal adhesives.

- CONCRETE REPAIR NOTES:**
- Remove all deteriorated, spalled or soft concrete. Use small chipping equipment and use care and caution when performing work. Remove concrete around all corroded reinforcing steel to expose the corroded portions of the bar. Score cut the perimeter edges of the areas where concrete has been removed and remove concrete to allow for a minimum 3/4" thickness of the patching mortar. Around all deteriorated reinforcing bars, remove concrete for a minimum of 3/4" around the bar for the full length of the deteriorated section of the bar.
 - Supplement reinforcing which has lost more than 15% of its original cross-sectional area with new reinforcement of equal diameter to the original reinforcement.
 - Sandblast clean all surfaces of the corroded reinforcing steel to remove all loose and deteriorated portions of the bar. Sandblast clean the concrete surfaces to remove all loose concrete and dust.
 - Notify the architect to allow for a visual review of the prepared surfaces to ensure that all deteriorated material has been removed and the surfaces are adequately prepared to start the repairing process.
 - Wet the concrete surface to a saturated surface dry condition and apply Sika Armatec 110 EpoCem to all surfaces to be repaired. Apply one coat to the concrete surfaces and two coats to the surfaces of the reinforcing steel. Allow 2 to 3 hours between coatings and apply the patching mortar within 24 hours of applying the initial coating of Armatec 110. Follow all product recommendations and directions.
 - Wet the surfaces to a saturated surface dry condition and apply Sika Top 123 Plus patching mortar to fill all removed areas of concrete as required to return the profile of concrete to its original shape. Initially apply a scrub coat of the product to the substrate, following the application recommendations. Follow all product recommendations and directions during preparation, application and curing.

