

BENCHMARKS:
 "□" Cut in middle of N headwall of RCBC on 21st St. North. 1004.3' W & 22.1' N of SE Cor., SE 1/4, Sec. 2, T-27-S, R-2-E. Elev. = 173.23 City Datum

RR spike in N. face of power pole 840.0' west of C.L. of Castle Rock and 48.7' south of C.L. of 21st St. N. Elev. = 182.03 City Datum

P.V.I.
 Elev. = 178.30
 54' V.C.

Sta 3+92.00-PT
 P.V.I.
 Elev. = 182.50
 No V.C.

Scale: 1" = 20'
 • = Iron

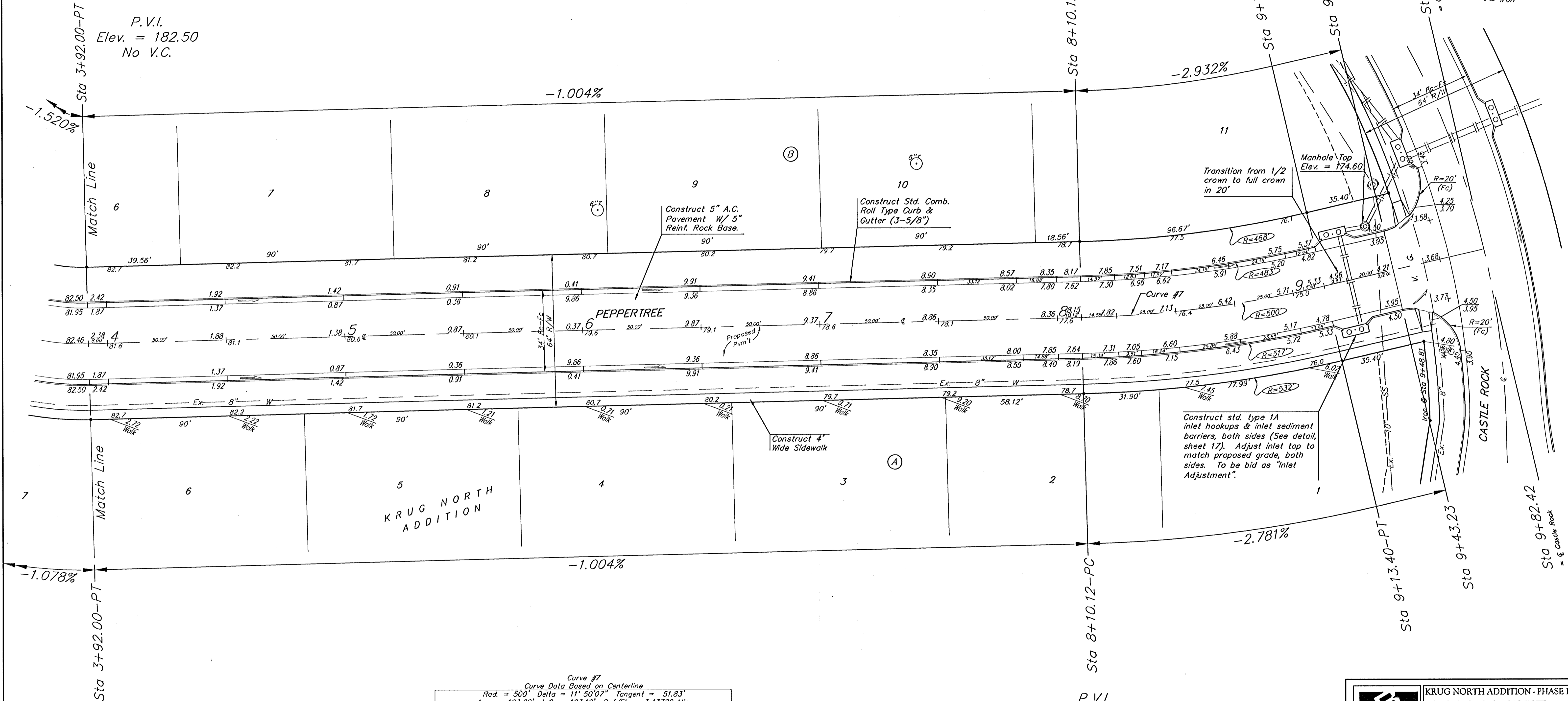

P.V.I.
 Elev. = 182.50
 No V.C.

P.V.I.
 Elev. = 178.30
 50' V.C.

Curve #7
 Curve Data Based on Centerline
 Rad. = 500' Delta = 11° 50' 07" Tangent = 51.83'
 Arc = 103.28' L.C. = 103.10' Del/Pt. = 3.43782 Min.

Station	Arc	FACE CHORD LENGTHS		Defl	T. Defl.
		B' Lt.	B' Rt.		
8+10.12	0.00'	0.00'	0.00'	0° 00' 00"	0° 00' 00"
8+25.00	14.88'	14.14'	15.62'	0° 51' 09"	0° 51' 09"
8+50.00	25.00'	23.75'	26.25'	1° 25' 57"	2° 17' 06"
8+75.00	25.00'	23.75'	26.25'	1° 25' 57"	3° 43' 03"
9+00.00	25.00'	23.75'	26.25'	1° 25' 57"	5° 08' 59"
9+13.40	13.40'	12.73'	14.07'	0° 46' 04"	5° 55' 03"

NOTE: ROLL TYPE CURB & GUTTER TO BE CONSTRUCTED ON THE PAVEMENT SHOWN ON THIS SHEET. TOP OF CURB ELEVATIONS ARE GIVEN FOR FULL HEIGHT CURB.

Baughman KRUG NORTH ADDITION - PHASE I
PEPPERTREE
 STA 3+92.00 TO STA 9+82.42

Baughman Company, P.A. 315 Ella St. White, KS 67111 P316242-7211 F316242-0149
 ENGINEERING | SURVEYING | PLANNING | LANDSCAPE ARCHITECTURE

PROJECT NUMBER: 412-83913 DRAWN: TMS
 REVISIONS: APPROVED: DATE: 05/04

SCALE: Noted
 SHEET: 10 OF 30

KrugNorth/Std 0407-E848