

DRAINAGE DEDICATION

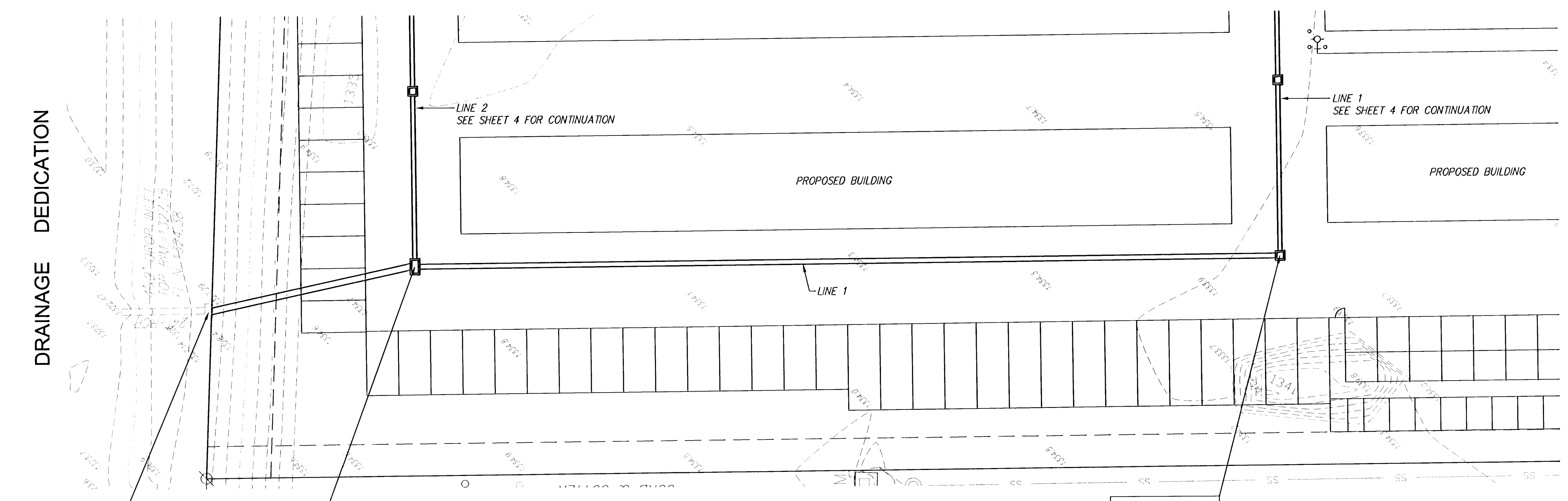

STA. 0+00.00 LINE 1
CONNECT TO EXISTING
4"x2" INLET
TOP INLET=1327.15

STA. 0+65.62 LINE 1=
STA. 0+00.00 LINE 2
2"x4" INLET
TOP ELEV.=1334.05
FL. IN=1328.27 (E)
FL. OUT=1328.02 (N)
FL. IN=1328.52 (S)

STA. 3+35.12 LINE 1
24" DRAIN BASIN
TOP ELEV.=1333.90
FL. IN=1329.49

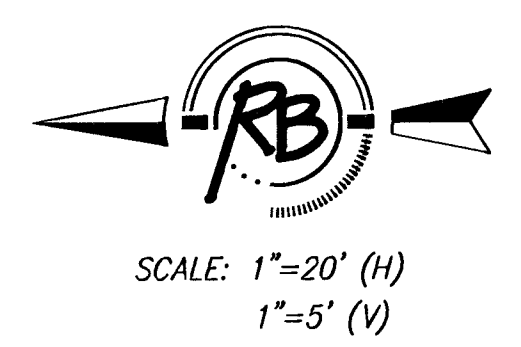

LINE 1

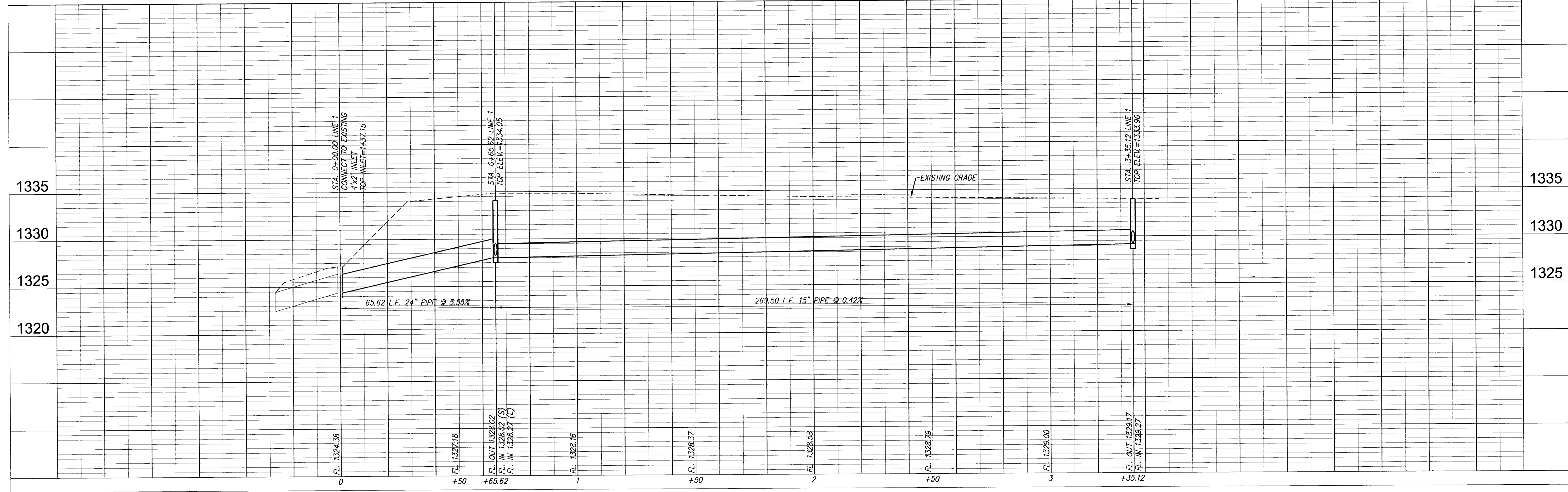

STA. 0+00.00 LINE 1
CONNECT TO EXISTING
4"x2" INLET
TOP INLET=1327.15

STA. 0+65.62 LINE 1
TOP ELEV.=1334.05

STA. 3+35.12 LINE 1
TOP ELEV.=1333.90

65.62 L.F. 24" PIPE @ 5.55%

289.50 L.F. 15" PIPE @ 0.42%

EXISTING GRADE

	Ruggles & Dohm, P.A. Engineering, Surveying, Land Planning 504 North Main Wichita, Kansas 67202 Phone: 316.264.0000 Fax: 316.264.0001 www.rugglesandohm.com
	PROJECT NUMBER 1734 DRAWING FILE ENGINEERING BASE (SWS)
DESIGN TOR UTILITY	DRAWN EJB DATE Jan. 10, 2007
REVISIONS REVIEW	REVIEW
R.D. WOOD STORAGE STORM DRAIN PLAN & PROFILE WICHITA, KANSAS	1335 1330 1325
RB JOB 2932P SHEET	1325