

POINT NUMBER	NORTHING	EASTING	ELEVATION
263	20425.4489	18794.1053	1275.50
264	20425.8097	18847.0586	1275.50
265	20425.7863	18897.0586	1275.50
266	20425.7628	18947.0586	1275.50
267	20425.7394	18997.0586	1275.50
268	20428.7160	19047.0600	1275.50
269	20425.6953	19091.1199	1275.50
270	20434.7050	19132.3210	1275.50
271	20460.1209	19165.9773	1275.50
272	20488.8945	19190.6213	1275.50
273	20505.9902	19202.3852	1275.50
274	20523.1934	19211.7203	1275.50
275	20541.1630	19217.3165	1275.50
276	20589.4542	19222.4857	1275.50
277	20594.7878	19222.7609	1275.50
278	20650.2124	19222.5650	1275.50
279	20705.6371	19222.3690	1275.50
280	20719.4718	19228.0575	1275.50
281	20725.2061	19241.8732	1275.50
282	20725.2046	19248.8109	1275.50
283	20720.2457	19261.7991	1275.50
284	20707.8955	19268.1831	1275.50
285	20647.8743	19274.7885	1275.50
286	20587.8553	19281.3937	1275.50
287	20575.8445	19281.3064	1275.50
288	20525.7894	19275.0575	1275.50
289	20510.9070	19269.1022	1275.50
290	20447.0580	19221.7531	1275.50
291	20447.0580	19221.7531	1275.50
292	20406.8938	19191.9706	1275.50
293	20376.7824	19156.2600	1275.50
294	20365.8531	19110.8454	1275.50
295	20365.5966	19046.1940	1275.50
296	20365.3965	18996.1944	1275.50
297	20365.1975	18946.1948	1275.50
298	20364.9984	18896.1952	1275.50
299	20364.7718	18844.2295	1275.50
300	20354.6971	18798.0812	1275.50
301	20351.9402	18793.1013	1275.50
302	20388.8837	18734.5688	1275.50
303	20396.3661	18742.4076	1275.50

NOTE: A soil sample is to be obtained at the bottom of the pond excavation at the time of excavation. If soil sample tested has a PI of greater than 30, then the pond bottom shall be scarified a minimum of 8 inches and compacted to 95 percent of standard proctor density (ASTM D-698) from -3% to +3% of optimum moisture. Additionally, all gypsum/caliche, sandy/clay, and clay shale encountered should be excavated a minimum of 1 foot and replaced with clay.

NOTE: A pond liner will be required on the pond indicated on this sheet. Onsite material approved by the Engineer may be used for the pond liner. Subsidiary to the bid item for "Excavation".

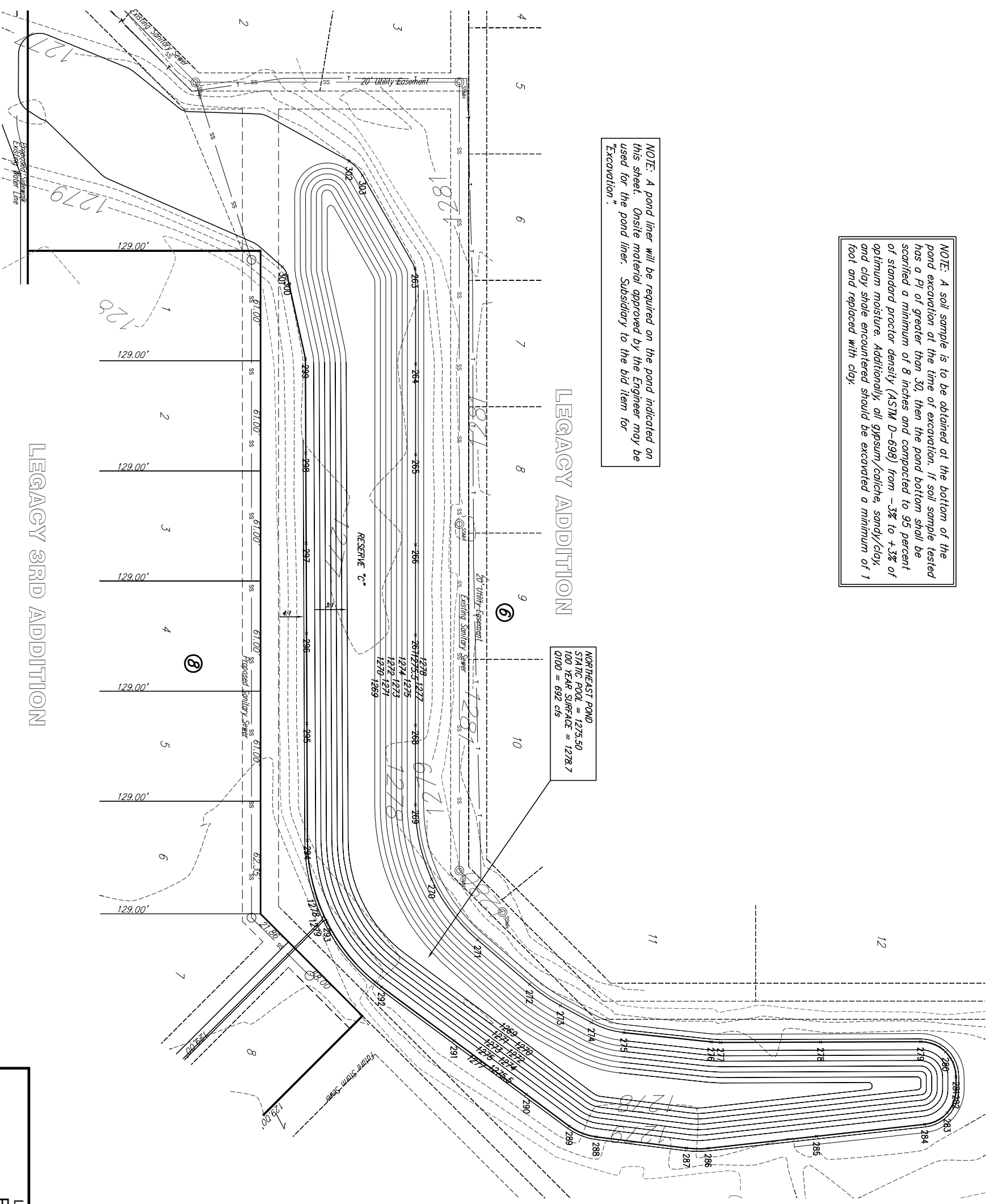

LEGACY 3RD ADDITION

Legacy 3rd Addition
Pond #5 Details
WICHITA, KANSAS

RUGGLES & BOHM
ENGINEERING SURVEYING LAND PLANNING

824 North Main
Wichita, Kansas 67203
www.rdbkansas.com

(316) 264-8008
(316) 264-4821 fax
E-mail: info@rdbkansas.com

PROJECT NUMBER: 488-84350
DATE: July 25, 2007

DESIGN: KML
DRAWN: RLS
REVIEW:
UTILITY

SHEET: 9 OF 17