

EXHIBIT

PARTIAL EASEMENT VACATION IN LOT 7, BLOCK A, FOSSIL RIM ESTATES, WICHITA, SEDGWICK COUNTY, KANSAS

VAC2016-12

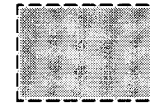
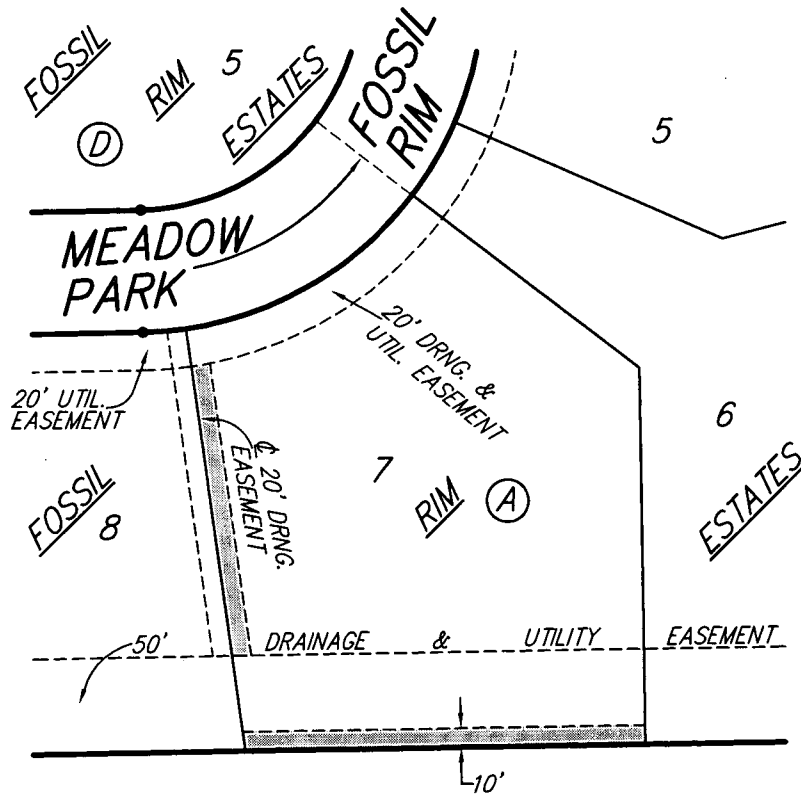

INDICATES AREA OF
LEGAL DESCRIPTION

14 MAR 2016

 **Baughman Company, P.A.**
315 Ellis St. Wichita, KS 67211 P 316-262-7271 F 316-262-0149
ENGINEERING | SURVEYING | PLANNING | LANDSCAPE ARCHITECTURE

**BEFORE THE CITY COUNCIL OF THE
CITY OF WICHITA, SEDGWICK COUNTY, KANSAS**

**IN THE MATTER OF THE VACATION OF A PORTIONS)
OF A PLATTED DRAINAGE EASEMENT & A)
PLATTED DRAINAGE AND UTILITY EASEMENT)**

**GENERALLY LOCATED SOUTHEAST OF 29TH STREET)
NORTH & TYLER ROAD ON THE SOUTH SIDE OF)
MEADOW PARK & FOSSIL RIM STREETS)**

VAC2016-00012

MORE FULLY DESCRIBED BELOW

VACATION ORDER

NOW on this 17th day of May, 2016, comes on for hearing the petition for vacation filed by Caroline M Hayes Revocable Trust, c/o Will Hayes, Trustee (owner), praying for the vacation of the following described portions of a platted drainage easement and a platted drainage and utility easement, to-wit:

The south 10.00 feet of that part of the 50.00 foot drainage and utility easement as granted in Fossil Rim Estates, Wichita, Sedgwick County, Kansas lying in Lot 7, Block A, in said Fossil Rim Estates, TOGETHER with the east 10.00 feet of that part of the 20.00 foot drainage easement as granted in said Fossil Rim Estates lying east of and abutting the west line of said Lot 7, lying north of and abutting the north line of said 50.00 foot drainage and utility easement, and lying south of and abutting the south line of the 20.00 foot drainage and utility easement as granted in said Fossil Rim Estates.

The City Council, after being duly and fully informed as to fully understand the true nature of this petition and the propriety of granting the same, makes the following findings:

1. That due and legal notice has been given by publication, as required by law, in The Wichita Eagle on March 28, 2016, which was at least 20 days prior to the public hearing.

2. No private rights will be injured or endangered by the vacation of the described portions of the platted drainage easement and the platted drainage and utility easement and the public will suffer no loss or inconvenience thereby.

3. In justice to the petitioner(s), the prayer of the petition ought to be granted.

4. No written objection to said vacation has been filed with the City Clerk by any owner or adjoining owner who would be a proper party to the petition.

5. The vacation of the described portions of the platted drainage easement and the platted drainage and utility easement, should be approved.

IT IS, THEREFORE, BY THE CITY COUNCIL, on this 17th day of May, 2016, ordered that the above-described portions of the platted drainage and the platted drainage and utility easement are hereby vacated. IT IS FURTHER ORDERED that the City Clerk shall send this original Vacation Order to the Register of Deeds of Sedgwick County.

Jeff Longwell, Mayor

ATTEST:

Karen Sublett, City Clerk

Approved as to Form:

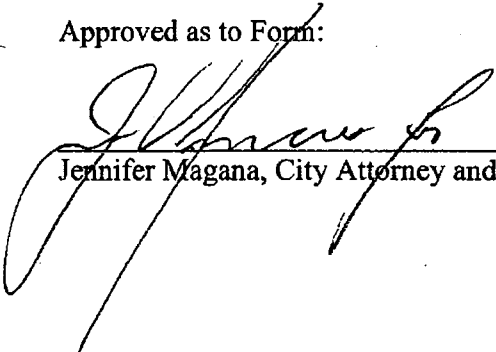

Jennifer Magana, City Attorney and Director of Law



Wichita-Sedgwick County Metropolitan Area Planning Department

May 18, 2016

Baughman Company, P.A.
Attn: Phil Meyer
315 Ellis
Wichita, KS 67211

Ref: VAC2016-00012 - Request to Vacate a Portions of Platted Drainage Easements on Property Generally Located Southeast of 29th Street North and Tyler Road on the South Side of the Meadow Park and Fossil Rim Streets' Bend (District V).

Dear Mr. Meyer:

At its regular meeting on Tuesday, May 17, 2016, the Wichita City Council considered the above-referenced request. The action of the City Council was to **APPROVE** subject to the recommendation by the MAPC.

If you have any questions about this matter, please call 268-4421.

Sincerely,

Bill Longhecker
Senior Planner

BL:klw

cc: Caroline M Hayes Revocable Trust, Will Hayes, 8213 W Meadow Park, Wichita KS 67205-3512