

10/21/2017

ave
vir
ing
Sec
as
the
per
our
fee
p.1
fee
the
sal
was
the
fee
hav
of
gen
ly
ang
the
sal
rig

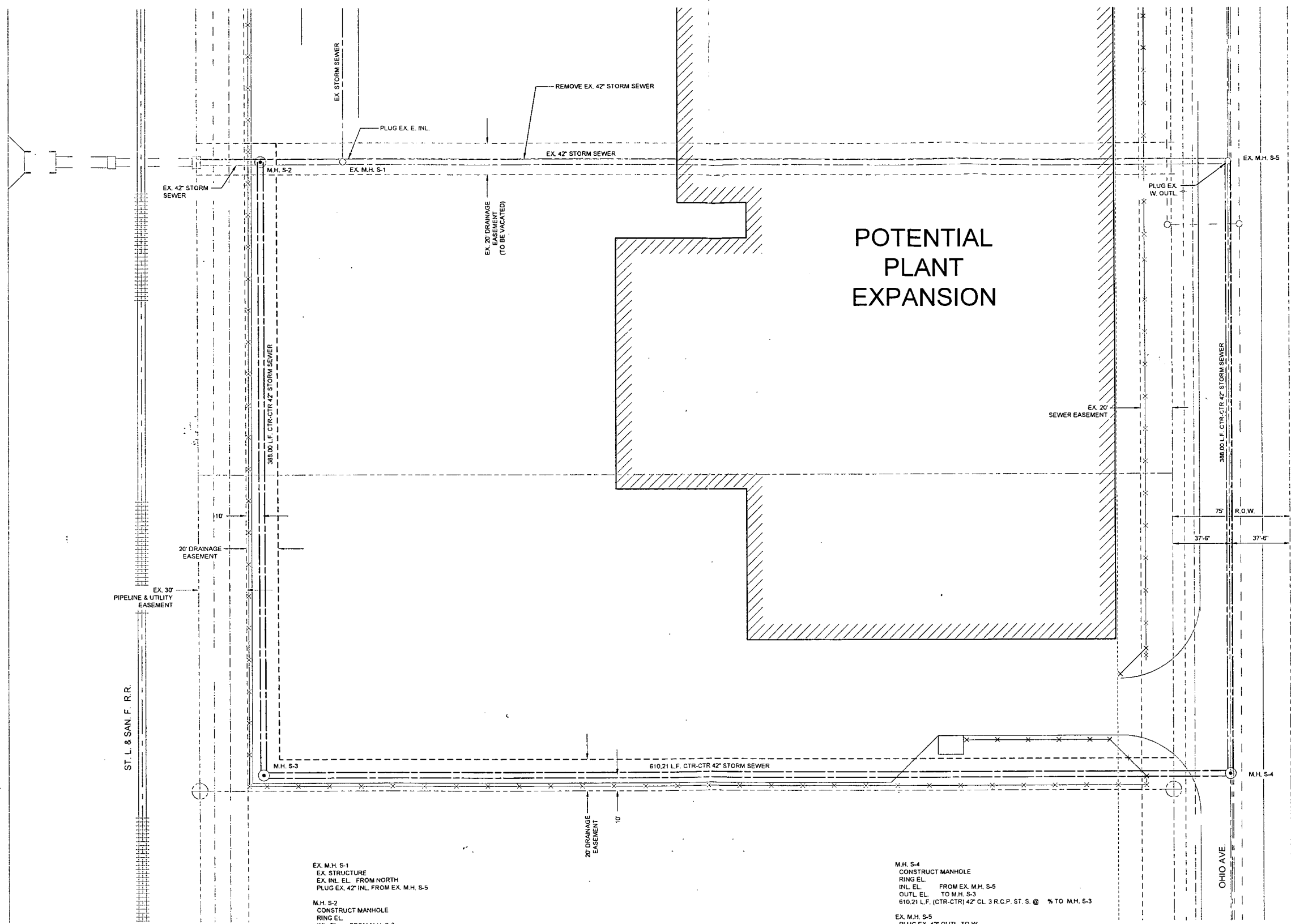

POTENTIAL
PLANT
EXPANSION

EX. M.H. S-1
EX. STRUCTURE
EX. INL. EL. FROM NORTH
PLUG EX. 42" INL. FROM EX. M.H. S-5

M.H. S-2
CONSTRUCT MANHOLE
RING EL.
INL. EL. FROM M.H. S-3
INL. EL. FROM EX. M.H. S-1
OUTL. EL. TO WEST

M.H. S-3
CONSTRUCT MANHOLE
RING EL.
INL. EL. FROM M.H. S-4
OUTL. EL. TO M.H. S-2
388.00 L.F. (CTR-CTR) 42" CL 3 R.C.P. ST. S. @ 1/4" TO M.H. S-2

M.H. S-4
CONSTRUCT MANHOLE
RING EL.
INL. EL. FROM EX. M.H. S-5
OUTL. EL. TO M.H. S-3
610.21 L.F. (CTR-CTR) 42" CL 3 R.C.P. ST. S. @ 1/4" TO M.H. S-3

EX. M.H. S-5
PLUG EX. 42" OUTL. TO W.
CONNECT TO EX. STRUCTURE
EX. INL. EL. FROM NORTH
OUTL. EL. TO M.H. S-4
388.00 L.F. (CTR-CTR) 42" CL 3 R.C.P. ST. S. @ 1/4" TO M.H. S-4

SITE PLAN
Scale: 1" = 30'

REV.	BY	DATE	DESCRIPTION	CHKD.

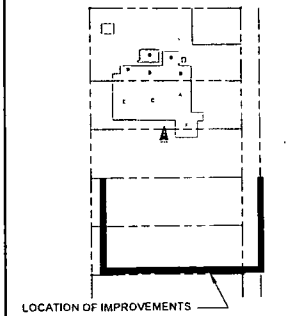

HORMEL FOODS CORPORATION, Corporate Office, Austin, MN 55912



CORPORATE ENGINEERING DIVISION, LLC

PROJECT
**POTENTIAL PLANT
EXPANSION**

PLANT **WICHITA, KS**

SHEET TITLE
**STORM SEWER
PLAN**

DR. SCB	PROJ. P. EICKHOF	SHEET NO.
SCALE: NOTED	JOB NO. NA	C01001
DATE: 4/27/17	FILENAME: SET W00C01001-PBCE	SHEET 1 OF 1