

BZA 7-61 - THE WESLEY HOSPITAL &
NURSE TRAINING SCHOOL REQUESTS
VARIANCE FOR ERECTION OF SIGN AT
550 NORTH HILLSIDE

BZA meeting - 7-25-61

RESOLUTION NO. 7-61

WHEREAS, THE WESLEY HOSPITAL AND NURSE TRAINING SCHOOL, 550 NORTH HILLSIDE, WICHITA, KANSAS, BY BOYER, HONDROS & DONALDSON, 340 SOUTH BROADWAY, WICHITA, KANSAS, HAVE REQUESTED A VARIANCE TO PERMIT THE ERECTION OF A SIGN OF GREATER SIZE THAN ALLOWED BY THE ZONING ORDINANCE, ON PROPERTY LEGALLY DESCRIBED AS:

LOTS 2, 4, AND 6, WILSON PLACE, IN THE CITY OF WICHITA, SEDGWICK COUNTY, KANSAS.

WHEREAS, PROPER NOTICE AS REQUIRED BY ORDINANCE AND BY THE RULES OF THE BOARD OF ZONING APPEALS HAS BEEN GIVEN; AND

WHEREAS, THE BOARD OF ZONING APPEALS DID, IN REGULAR MEETING CONSIDER SAID APPLICATION FOR VARIANCE ON AUGUST 22, 1961; AND

WHEREAS, THE BOARD OF ZONING APPEALS HAS DETERMINED THAT IT HAS JURISDICTION TO CONSIDER SAID REQUEST FOR VARIANCE UNDER THE PROVISIONS OF SECTION 2.12.590, CODE OF THE CITY OF WICHITA; AND

WHEREAS, THE PROPERTY IS ZONED "B", MULTIPLE FAMILY ZONING CLASSIFICATION, AND WOULD PERMIT A SIGN NO LARGER THAN 12 SQUARE FEET; AND

WHEREAS, AFTER DUE CONSIDERATION AND AFTER HEARING ARGUMENTS FROM THE ATTORNEY FOR THE APPLICANT; AND

WHEREAS, THE BOARD OF ZONING APPEALS HAS FOUND THAT THE VARIANCE DESIRED ARISES FROM SUCH CONDITION WHICH IS UNIQUE IN THE SAME ZONING DISTRICT INASMUCH AS THE PROPERTY INVOLVED IS A LARGE TRACT OF LAND DEVELOPED AS A SINGLE UNIT WITHOUT A PUBLIC STREET SYSTEM OR SIMILAR IDENTIFICATION, WHICH IS RARELY FOUND IN THE "B" ZONING DISTRICT; AND

WHEREAS, THE BOARD OF ZONING APPEALS HAS FOUND THAT THE GRANTING OF THE VARIANCE REQUESTED WOULD NOT ADVERSELY AFFECT THE RIGHTS OF ADJACENT PROPERTY OWNERS INASMUCH AS SUCH SIGN WILL BE IN HARMONY AND COMPATIBLE TO THE COMMERCIAL DEVELOPMENT TO THE WEST; AND FOR THE ADDITIONAL REASON THAT NO OPPOSITION HAS BEEN EXPRESSED BY ADJACENT PROPERTY OWNERS; AND

WHEREAS, THE BOARD OF ZONING APPEALS HAS FOUND THAT THE STRICT APPLICATION OF THE ENFORCEMENT PROVISIONS OF THE ZONING ORDINANCE WILL CONSTITUTE UNNECESSARY HARDSHIP UPON THE PROPERTY OWNER INASMUCH AS THE INABILITY OF THE GENERAL PUBLIC TO READILY LOCATE THE EMERGENCY ENTRANCE IMPEDES AND HINDERS THE PROPER OPERATION OF THE HOSPITAL; AND

WHEREAS, THE BOARD OF ZONING APPEALS HAS FOUND THAT THIS VARIANCE DESIRED WILL ENHANCE RATHER THAN ADVERSELY AFFECT THE PUBLIC HEALTH, SAFETY, MORALS, ORDER, CONVENIENCE, PROSPERITY OR GENERAL WELFARE; AND

WHEREAS, AS SHOWN ABOVE, EACH OF THE FOUR CONDITIONS REQUIRED BY SECTION 2.12.590.2 OF THE CITY CODE OF WICHITA TO BE PRESENT BEFORE A VARIANCE CAN BE GRANTED, HAS BEEN FOUND TO EXIST;

NOW THEREFORE BE IT RESOLVED BY THE BOARD OF ZONING APPEALS OF THE CITY OF WICHITA, KANSAS, THAT THIS REQUEST FOR A VARIANCE FROM THE STRICT ENFORCEMENT PROVISIONS OF THE ZONING ORDINANCE TO ERECT A SIGN OF GREATER SIZE THAN ALLOWED BY THE ZONING ORDINANCE ON PROPERTY LEGALLY DESCRIBED AS

LOTS 2, 4, AND 6, WILSON PLACE, IN THE CITY OF WICHITA, SEDGWICK COUNTY, KANSAS,

BE AND THE SAME IS HEREBY APPROVED, AND THE SUPERINTENDENT OF BUILDING INSPECTION IS HEREBY AUTHORIZED TO ISSUE A PERMIT FOR THE CONSTRUCTION OF A SIGN NOT TO EXCEED THE FOLLOWING SPECIFICATIONS AND DIMENSIONS:

OVERALL SIZE OF SIGN	LENGTH - 8'	10"
	WIDTH - 3'	4"
	DEPTH -	18"
SIZE OF SIGN FRAME	TOP -	2"
	BOTTOM -	2"
	ENDS -	6"

SIGN TO BE MOUNTED ON 4" STEEL PIPE SLEEVES

SIZE OF ILLUMINATED AREA (BOTH SIDES)	LENGTH	94"
	HEIGHT	2' 8"

THE DISTANCE BETWEEN THE BASE OF THE SIGN AND THE GROUND LEVEL TO BE 10 FEET, AND SUCH SIGN TO BE LOCATED ON THE NORTH SIDE OF THE EXISTING EMERGENCY ENTRANCE DRIVEWAY ENTERING THE HOSPITAL FROM HILLSIDE, AND NOT NEARER THE STREET RIGHT-OF-WAY THAN 15 FEET EAST OF THE EAST LINE OF HILLSIDE.

ADOPTED AT WICHITA, KANSAS, THIS 22ND DAY OF AUGUST, 1961.

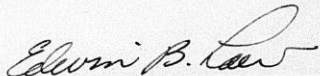
EDWIN B. LAW, VICE CHAIRMAN

ATTEST:

ROBERT A. LAKIN, SECRETARY

Mrs. Karzski

BZA CASE 7-61

CASE DESCRIPTION

THE APPLICANT, WESLEY HOSPITAL AND NURSES TRAINING SCHOOL DESIRES A VARIANCE FROM THE STRICT PROVISIONS OF THE ZONING ORDINANCE TO ALLOW THE ERECTION OF A SIGN GREATER IN SIZE THAN THAT ALLOWED BY THE ZONING ORDINANCE. THIS SIGN WOULD IDENTIFY THE EMERGENCY ENTRANCE OF WESLEY HOSPITAL AND WOULD BE LOCATED IN THE GENERAL VICINITY OF THE EXISTING SOUTH MAIN ENTRANCE. ACCORDING TO THE BUILDING INSPECTOR'S INTERPRETATION OF THE ZONING ORDINANCE, (SECTION 28.04.070.A.ii), CODE OF THE CITY OF WICHITA), THE APPLICANT IS ALLOWED TO ERECT A SIGN UP TO AND INCLUDING TWELVE (12) SQUARE FEET IN THE AREA. THE PROPOSED SIGN IS APPROXIMATELY 29 SQUARE FEET IN AREA.

EXISTING LAND USE

THE MAJOR AREA NORTH OF CENTRAL AND EAST OF HILLSIDE IS OWNED AND OCCUPIED BY THE APPLICANT. TO THE WEST ARE MIXED COMMERCIAL AND RESIDENTIAL USES.

JURISDICTION

THE BOARD HAS JURISDICTION (SECTION 2.12.590, WICHITA CITY CODE) TO GRANT VARIANCES FROM THE STRICT APPLICATION OF THE ENFORCEMENT PROVISIONS OF THE ZONING ORDINANCE, PROVIDED THAT THE BOARD HAS DETERMINED THAT ALL OF THE FOLLOWING CONDITIONS ARE PRESENT:

1. THAT THE VARIANCE DESIRED ARISES FROM SUCH CONDITION WHICH IS UNIQUE AND WHICH IS NOT ORDINARILY FOUND IN THE SAME ZONING DISTRICT;
2. THAT THE GRANTING OF THE PERMIT FOR THE VARIANCE WILL NOT ADVERSELY AFFECT THE RIGHTS OF ADJACENT PROPERTY OWNERS OR RESIDENTS;
3. THAT THE STRICT APPLICATION OF THE ENFORCEMENT PROVISIONS OF THE ZONING ORDINANCE WILL CONSTITUTE UNNECESSARY HARDSHIP UPON THE PROPERTY OWNER REPRESENTED IN THE APPEAL;
4. THAT THE VARIANCE DESIRED WILL NOT ADVERSELY AFFECT THE PUBLIC HEALTH, SAFETY, MORALS, ORDER, CONVENIENCE, PROSPERITY OR GENERAL WELFARE.

APPLICANT'S STATEMENT

A STATEMENT SUBMITTED BY THE APPLICANT IS INCLUDED AS AN ATTACHMENT TO THIS REPORT. THIS STATEMENT INDICATES THE APPLICANT'S COMMENTS CONCERNING THE REQUIREMENTS OF THE CITY ORDINANCE.

SECRETARY'S COMMENTS AND OPINION

THE FOLLOWING COMMENTS CONCERN THE FOUR CONDITIONS RELATED TO THIS CASE:

POINT 1

THE APPLICANT DOES NOT CLEARLY STATE IN WHAT MANNER SUCH "CONDITION.....IS UNIQUE".

IT IS THE SECRETARY'S FEELING THAT THE MATTER OF UNIQUENESS MUST BE ASSOCIATED WITH THE PHYSICAL CHARACTERISTICS OF THE LAND RATHER THAN THE USE OF THE LAND. THERE IS NOTHING PARTICULARLY UNUSUAL ABOUT THE TOPOGRAPHY OR THE LOCATION OF THIS LAND, BUT THERE IS UNIQUENESS SINCE THIS IS A LARGE CONSOLIDATED TRACT OF LAND WITHOUT A PUBLIC STREET SYSTEM OR SIMILAR IDENTIFICATION. LARGE TRACTS OF LAND OF THIS NATURE ARE NOT NORMALLY FOUND IN THE "B" ZONING CLASSIFICATION THROUGHOUT THE CITY.

POINT 2

IT IS THE OPINION OF THE SECRETARY THAT THE GRANTING OF THE VARIANCE WOULD NOT ADVERSELY AFFECT THE RIGHTS OF THE ADJACENT PROPERTY OWNERS BECAUSE:

1. MOST NEARBY RESIDENCES ARE LOCATED A CONSIDERABLE DISTANCE AWAY FROM THE LOCATION OF THE SIGN.
2. WITH ONE OR TWO EXCEPTIONS THE PROPERTY DIRECTLY TO THE WEST, ACROSS THE STREET, IS LARGELY DEVELOPED FOR COMMERCIAL ACTIVITY.

POINT 3:

THE APPLICANT DOES NOT SPECIFICALLY EXPLAIN THE MANNER IN WHICH FAILURE TO GRANT THE VARIANCE WOULD CREATE A HARDSHIP UPON THE APPLICANT.

IF THE VARIANCE IS NOT GRANTED, IT SEEMS APPARENT THAT THE PUBLIC MAY BE UNDULY INCONVENIENCED AND THUS SUFFER HARDSHIP. IT IS THE OPINION OF THE SECRETARY THAT THE APPLICANT WOULD ALSO SUFFER HARDSHIP IN THAT IF THE PUBLIC CANNOT ACCURATELY AND QUICKLY ASCERTAIN THE HOSPITAL EMERGENCY ENTRANCE, THEN THE HOSPITAL ITSELF CANNOT PROPERLY FUNCTION AND CARRY OUT ITS PURPOSES.

POINT 4

IT IS THE SECRETARY'S OPINION THAT THE LAST REQUIREMENT (THE VARIANCE WILL NOT ADVERSELY AFFECT THE GENERAL PUBLIC) IS MET, IN THAT NO DETERMINATION CAN BE MADE BY THE SECRETARY THAT EITHER THE HEALTH, SAFETY, MORALS, OR GENERAL WELFARE WOULD BE AFFECTED IF THIS SIGN WERE ERECTED.

IT IS THE SECRETARY'S OPINION THAT THIS APPLICATION SHOULD BE APPROVED BECAUSE ALL OF THE FOUR CONDITIONS CAN BE SATISFIED.

IT IS NOTED THAT THE ZONING ORDINANCE APPARENTLY DOES NOT STATE HEIGHT LIMITATIONS FOR SIGNS IN A "B" DISTRICT. IT IS RECOMMENDED THAT SINCE SOME TYPE OF HEIGHT LIMITATION MAY BE DESIRABLE, THIS MATTER BE REFERRED TO THE METROPOLITAN AREA PLANNING COMMISSION FOR CONSIDERATION.

STATEMENT
(UNDER III.D.)

THE WESLEY HOSPITAL AND NURSE TRAINING SCHOOL OWNS GENERALLY ALL OF THE PROPERTY SURROUNDED ON THE SOUTH BY CENTRAL, ON THE NORTH BY PINE, ON THE EAST BY RUTAN AND ON THE WEST BY HILLSIDE AVENUE. ALL OF SAID PROPERTY IS DEVELOPED FOR HOSPITAL PURPOSES. THE PROPOSED SIGN IS TO BE ERRECTED FACING NORTH AND SOUTH, EAST OF HILLSIDE AVENUE, GENERALLY TO BE LOCATED ON A LINE PARALLEL WITH THE EXTENDED SOUTH WALL OF THE MAIN HOSPITAL PROPERTY. THE PURPOSE OF THE SIGN IS TO NOTIFY THE PUBLIC OF THE EMERGENCY HOSPITAL ENTRANCE. HERETOFORE, THE HOSPITAL HAS RECOGNIZED A PROBLEM EXISTING BECAUSE THE GENERAL PUBLIC COULD NOT DETERMINE THE PROPER EMERGENCY ENTRANCE TO RECEIVE HOSPITAL SERVICES. THE SIGN IS FELT TO BE OF EXTREME NECESSITY IN THE PUBLIC INTEREST, AND THIS VARIANCE IS SOUGHT TO BE JUSTIFIED ON THAT BASIS.

THE APPLICABLE CODE PROVISION (SECTION 28.04.070.A.11) PURPORTEDLY LIMITS SUCH A SIGN TO TWELVE SQUARE FEET. IT IS BELIEVED THAT A PROPER SIGN TO BE EASILY SEEN BY THE GENERAL PUBLIC AND WHICH WILL SOLVE THE EXISTING PROBLEM SHOULD HAVE THE FOLLOWING DIMENSIONS:

OVERALL SIZE OF SIGN:	LENGTH -	8' 10"
	WIDTH -	3' 4"
	DEPTH -	18"
SIZE OF SIGN FRAME:	TOP -	2"
	BOTTOM -	2"
	ENDS -	6"

SIGN TO BE MOUNTED ON 4" STEEL PIPE SLEEVES

SIZE OF ILLUMINATED AREA (BOTH SIDES)	LENGTH -	94"
	HEIGHT -	2' 8"

(NOTE: THE APPLICANT ADVISES THAT THE DISTANCE BETWEEN THE BASE OF THE SIGN AND THE GROUND IS APPROXIMATELY 10 FEET).

A SKETCH OF THE PROPERTY SHOWING THE APPROXIMATE LOCATION OF THE SIGN IS ATTACHED.

IT IS REPRESENTED BY THE APPLICANT:

- (A) THAT THE VARIANCE DESIRED ARISES FROM SUCH CONDITION WHICH IS UNIQUE AND WHICH IS NOT ORDINARILY FOUND IN THE SAME ZONING DISTRICT;
- (B) THAT THE GRANTING OF THE PERMIT FOR THE VARIANCE WILL NOT ADVERSELY AFFECT THE RIGHTS OF ADJACENT PROPERTY OWNERS OR RESIDENTS;
- (C) THAT THE STRICT APPLICATIONS OF THE ENFORCEMENT PROVISIONS OF THE ZONING ORDINANCE WILL CONSTITUTE UNNECESSARY HARSHIP UPON THE PROPERTY OWNER REPRESENTED IN THE APPEAL;
- (D) THAT THE VARIANCE DESIRED WILL NOT ADVERSELY AFFECT THE PUBLIC HEALTH, SAFETY, MORALS, ORDER, CONVENIENCE, PROSPERITY OR GENERAL WELFARE.

ATTACHMENT A

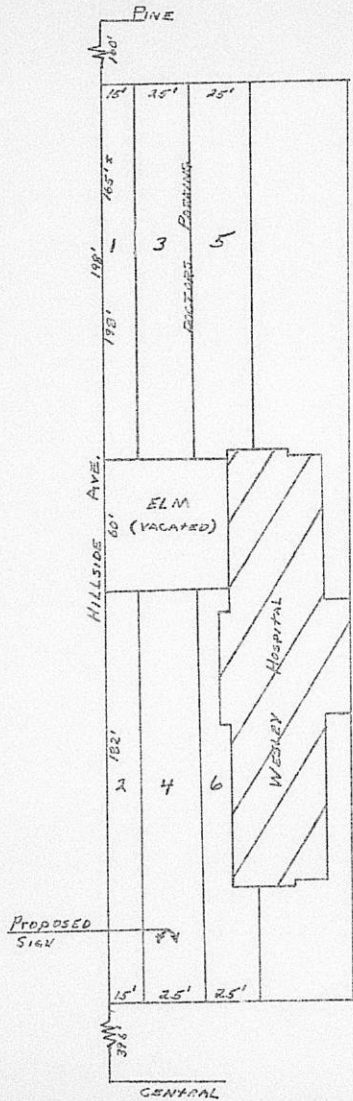

BZA 7-61

SEPTEMBER 6, 1961

THE WESLEY HOSPITAL AND NURSE TRAINING
SCHOOL
550 NORTH HILLSIDE
WICHITA, KANSAS

GENTLEMEN:

RE: BZA 7-61

ON AUGUST 23, 1961, WE ADVISED YOU THAT THE BOARD OF ZONING APPEALS HAD APPROVED YOUR REQUEST FOR VARIANCE TO PERMIT THE ERECTION OF A SIGN LARGER THAN THAT REQUIRED UNDER THE ZONING ORDINANCE ON PROPERTY LOCATED GENERALLY ON THE EAST SIDE OF HILLSIDE AND JUST NORTH OF CENTRAL. WE ALSO ADVISED THAT THE BOARD'S DECISION MIGHT BE APPEALED TO THE CITY COMMISSION ON OR BEFORE SEPTEMBER 1, 1961.

THE CITY CLERK HAS ADVISED THAT NO APPEAL WAS FILED ON OR BEFORE THE DATE INDICATED, AND THE DECISION OF THE BOARD OF ZONING APPEALS IS, THEREFORE, FINAL.

A COPY OF THE RESOLUTION SETTING FORTH THE ACTION OF THE BOARD IS ATTACHED FOR YOUR INFORMATION AND FILES.

VERY TRULY YOURS,

ROBERT A. LAKIN
SECRETARY

RALISER

ENCLOSURE - 1

CC: KENNETH P. STEWART
340 SOUTH BROADWAY

C. L. McCAIG
ASS'T BLDG. INSP. SUPT.

BOARD OF ZONING APPEALS

SEPTEMBER 6, 1961

C. L. McCAIG, Ass't BUILDING INSPECTION SUPT.

ROBERT A. LAKIN, SECRETARY

BZA 7-61

ATTACHED IS A CARBON COPY OF RESOLUTION No. 7-61
ADOPTED BY THE BOARD OF ZONING APPEALS ON AUGUST
22, 1961.

THE APPEAL PERIOD FOR THIS PARTICULAR CASE ENDED
ON SEPTEMBER 1, 1961, AND INASMUCH AS NO APPEAL
WAS FILED WITH THE CITY CLERK ON OR BEFORE THAT
DATE, THE BOARD'S DECISION IS FINAL.

ROBERT A. LAKIN
SECRETARY

RAL:BER

ATTACHMENT - 1

BOARD OF ZONING APPEALS

AUGUST 25, 1961

File

C. H. FUNK, CITY CLERK

ROBERT A. LAKIN, SECRETARY

BZA 7-61

ATTACHED IS ONE COPY OF THE RESOLUTION RELATED
TO THE ABOVE NUMBERED BOARD OF ZONING APPEALS
CASE.

THE BOARD OF ZONING APPEALS APPROVED THE APPLI-
CATION AT ITS REGULAR MEETING OF AUGUST 22,
1961. THE DECISION OF THE BOARD CAN BE APPEALED
TO THE CITY COMMISSION ON OR BEFORE SEPTEMBER 1,
1961.

ROBERT A. LAKIN
SECRETARY

RAL:BER

ATTACHMENT

AUGUST 23, 1961

THE WESLEY HOSPITAL AND NURSE TRAINING SCHOOL
550 NORTH HILLSIDE
WICHITA, KANSAS

GENTLEMEN:

Re: BZA 7-61

THIS IS TO ADVISE YOU THAT AT ITS REGULAR MEETING OF AUGUST 22, 1961, THE BOARD OF ZONING APPEALS OF THE CITY OF WICHITA CONSIDERED YOUR REQUEST FOR VARIANCE TO PERMIT THE ERECTION OF A SIGN LARGER THAN THAT REQUIRED UNDER THE ZONING ORDINANCE ON PROPERTY GENERALLY LOCATED ON THE EAST SIDE OF HILLSIDE AND JUST NORTH OF CENTRAL. THE BOARD HAS APPROVED YOUR REQUEST.

SECTION 2.12.610 OF THE CODE OF THE CITY OF WICHITA PROVIDES THAT THE DECISION OF THE BOARD OF ZONING APPEALS SHALL BE FINAL UNLESS IT IS APPEALED TO THE BOARD OF CITY COMMISSIONERS WITHIN TEN DAYS OF THE DATE OF THE BOARD'S ACTION. ACCORDINGLY, AN APPEAL COULD BE FILED IN THIS CASE ON OR BEFORE SEPTEMBER 1, 1961.

SUBSEQUENT TO THE EXPIRATION OF THE APPEAL PERIOD, YOU WILL BE ADVISED WHETHER OR NOT AN APPEAL HAS BEEN FILED. IF NO APPEAL HAS BEEN FILED ON OR BEFORE SEPTEMBER 1, 1961, THE DECISION OF THE BOARD WILL BE FINAL AND THE SUPERINTENDENT OF BUILDING INSPECTION WILL BE IN A POSITION TO ISSUE THE APPROPRIATE PERMIT.

VERY TRULY YOURS,

ROBERT A. LAKIN
SECRETARY

RAL:BER

CC: KENNETH P. STEWART
340 SOUTH BROADWAY

C. H. FUNK
CITY CLERK

BZA CASE 7-61 NOTICES MAILED AUGUST 3, 1961 TO THE FOLLOWING:

KENNETH P. STEWART
340 SOUTH BROADWAY

IRENE F. BENHAM
519 NORTH HILLSIDE

RICHARD L. BROWN
EMMA TWIETMEYER BROWN
720 NORTH VASSAR

ESTHER A. SNYDER
401 NORTH PERSHING

SOCONY VACUUM OIL COMPANY, INC.
300 NORTH BROADWAY

WESLEY HOSPITAL AND NURSES TRAINING SCHOOL
550 NORTH HILLSIDE

BOARD OF ZONING APPEALS
ROOM 402 CITY BUILDING ANNEX
104 SOUTH MAIN
WICHITA, KANSAS

AUGUST 3, 1961

NOTICE TO ADJOINING PROPERTY OWNERS

AN APPLICATION FOR A VARIANCE HAS BEEN FILED BY THE WESLEY HOSPITAL AND NURSE TRAINING SCHOOL, 550 NORTH HILLSIDE, WICHITA, KANSAS, BY BOYER, HONDROS & DONALDSON, 340 SOUTH BROADWAY, WICHITA, KANSAS, AS PROVIDED IN SECTION 2.12.590.2 OF THE CODE OF THE CITY OF WICHITA. THE APPLICANT DESIRES A VARIANCE TO ALLOW THE CONSTRUCTION OF A SIGN OF GREATER SIZE THAN PERMITTED UNDER THE ZONING ORDINANCE, SUCH SIGN TO BE LOCATED ON A TRACT DESCRIBED AS LOTS 2, 4, AND 6, WILSON PLACE, AT 550 NORTH HILLSIDE, WICHITA, KANSAS, AND GENERALLY LOCATED ON THE EAST SIDE OF HILLSIDE JUST NORTH OF CENTRAL.

THIS APPLICATION HAS BEEN ASSIGNED CASE No. BZA 7-61. A HEARING WILL BE HELD BY THE BOARD OF ZONING APPEALS ON TUESDAY, AUGUST 22, 1961, AT 1:30 P.M. IN ROOM 401 CITY BUILDING ANNEX, 104 SOUTH MAIN, WICHITA, KANSAS, AT WHICH TIME YOU MAY APPEAR, IF YOU SO DESIRE, EITHER IN PERSON OR BY AGENT OR ATTORNEY.



ROBERT A. LAKIN, SECRETARY
BOARD OF ZONING APPEALS

NOTE: THIS CASE WAS NOT HEARD ON JULY 25, 1961, DUE TO A LACK OF A QUORUM.

No. 731370

RECEIPT FOR CERTIFIED MAIL—20¢

SENT TO <i>Wesley Hospital</i>		POSTMARK OR DATE
STREET AND NO. <i>350 No. Hillside</i>		
CITY AND STATE <i>Wichita Kansas</i>		
If you want a return receipt, check which <input checked="" type="checkbox"/> 10¢ shows to whom and when delivered		If you want restricted delivery, check here <input type="checkbox"/> 50¢ fee
<input type="checkbox"/> 35¢ shows to whom, when, and address where delivered		
FEES ADDITIONAL TO 20¢ FEE P.O. Form 3800 Jul 1957 SEE OTHER SIDE		

P.O. Form 3811 Jan. 1958

POST OFFICE DEPARTMENT OFFICIAL BUSINESS		PENALTY FOR PRIVATE USE TO AVOID PAYMENT OF POSTAGE, \$300	
		POSTMARK OF POST OFFICE WICHITA, KANS. AUG 4 1961	
INSTRUCTIONS: Fill in items below and complete #1 on other side, when applicable. Moisten gummed ends and attach to back of article. Print on front of article RETURN RECEIPT REQUESTED.			
REGISTERED NO.	NAME OF SENDER <i>Board of Zoning Appeals</i>		
CERTIFIED NO. 731370	STREET AND NO. OR P.O. BOX <i>City Bldg Annex, 104 S. Main</i>		
INSURED NO.	CITY, ZONE AND STATE <i>Wichita Kansas</i>		
P.O. Form 3811 Jan. 1958 RETURN TO CSS-16-71948-4			

No. 731369

RECEIPT FOR CERTIFIED MAIL—20¢

SENT TO <i>Boyer Honduras & Donaldson</i>		POSTMARK OR DATE
STREET AND NO. <i>340 S. Broadway</i>		
CITY AND STATE <i>Wichita Kansas</i>		
If you want a return receipt, check which <input checked="" type="checkbox"/> 10¢ shows to whom and when delivered		If you want restricted delivery, check here <input type="checkbox"/> 50¢ fee
<input type="checkbox"/> 35¢ shows to whom, when, and address where delivered		
FEES ADDITIONAL TO 20¢ FEE P.O. Form 3800 Jul 1957 SEE OTHER SIDE		

P.O. Form 3811 Jan. 1958

POST OFFICE DEPARTMENT OFFICIAL BUSINESS		PENALTY FOR PRIVATE USE TO AVOID PAYMENT OF POSTAGE, \$300	
		POSTMARK OF DELIVERY OFFICE WICHITA, KANS. 4 1961	
INSTRUCTIONS: Fill in items below and complete #1 on other side, when applicable. Moisten gummed ends and attach to back of article. Print on front of article RETURN RECEIPT REQUESTED.			
REGISTERED NO.	NAME OF SENDER <i>Board of Zoning Appeals</i>		
CERTIFIED NO. 731369	STREET AND NO. OR P.O. BOX <i>City Bldg Annex, 104 S. Main</i>		
INSURED NO.	CITY, ZONE AND STATE <i>Wichita, Kansas</i>		
P.O. Form 3811 Jan. 1958 RETURN TO CSS-16-71948-4			

No. 731370

RECEIPT FOR CERTIFIED MAIL—20¢

SENT TO <i>Hesley Hospital</i>	POSTMARK OR DATE
STREET AND NO. <i>550 No. Hillside</i>	
CITY AND STATE <i>Wichita Kansas</i>	
<input checked="" type="checkbox"/> 10¢ shows to whom and when delivered	<input type="checkbox"/> 50¢ shows to whom, when, and address where delivered
If you want restricted delivery, check here <input type="checkbox"/> 50¢ fee	
FEES ADDITIONAL TO 20¢ FEE	
POD Form 3800 Jul 1957	SEE OTHER SIDE

#1-INSTRUCTIONS TO DELIVERING EMPLOYEE

Deliver ONLY to addressee Show address where delivered

(Additional charges required for these services)

RETURN RECEIPT
Received the numbered article described on other side.

SIGNATURE OR NAME OF ADDRESSEE (must always be filled in)
Hesley Hospital

SIGNATURE OF ADDRESSEE'S AGENT, IF ANY
J. K. Kibcock

DATE DELIVERED
AUG 4 1961

ADDRESS WHERE DELIVERED (only if requested in Reg. #3)

CS-18-71848-4 GPO

No. 731369

RECEIPT FOR CERTIFIED MAIL—20¢

SENT TO <i>Boyer, Hondros & Donaldson</i>	POSTMARK OR DATE
STREET AND NO. <i>340 S. Broadway</i>	
CITY AND STATE <i>Wichita Kansas</i>	
<input checked="" type="checkbox"/> 10¢ shows to whom and when delivered	<input type="checkbox"/> 50¢ shows to whom, when, and address where delivered
If you want restricted delivery, check here <input type="checkbox"/> 50¢ fee	
FEES ADDITIONAL TO 20¢ FEE	
POD Form 3800 Jul 1957	SEE OTHER SIDE

#1-INSTRUCTIONS TO DELIVERING EMPLOYEE

Deliver ONLY to addressee Show address where delivered

(Additional charges required for these services)

RETURN RECEIPT
Received the numbered article described on other side.

SIGNATURE OR NAME OF ADDRESSEE (must always be filled in)
Boyer, Hondros & Donaldson

SIGNATURE OF ADDRESSEE'S AGENT, IF ANY
Donaldson

DATE DELIVERED
4 Aug 61

ADDRESS WHERE DELIVERED (only if requested in Reg. #3)

RECEIVED
AUG 7 1961
METROPOLITAN PLANNING

CS-18-71848-4 GPO

AUGUST 3, 1961

CERTIFIED MAIL

BOYER HONDROS & DONALDSON
340 SOUTH BROADWAY
WICHITA, KANSAS

ATTENTION: KENNETH P. STEWART

DEAR MR. STEWART:

RE: BZA 7-61

YOUR APPLICATION FOR A VARIANCE UNDER PROVISIONS OF PARAGRAPH 2.12.590.2 OF THE CODE OF THE CITY OF WICHITA, AND FILED ON BEHALF OF THE WESLEY HOSPITAL AND NURSE TRAINING SCHOOL, 550 NORTH HILLSIDE, WICHITA, KANSAS, RELATING TO PROPERTY AT THAT ADDRESS AND LEGALLY DESCRIBED AS

LOTS 2, 4, AND 6, WILSON PLACE, WICHITA, KANSAS,

HAS BEEN GIVEN BOARD OF ZONING APPEALS CASE No. BZA 7-61.

ALL INQUIRIES AND REFERENCES SHOULD BE MADE TO THAT CASE NUMBER WHEN YOU SEEK INFORMATION FROM THE SECRETARY.

FURTHER, YOU ARE NOTIFIED THAT YOU MAY APPEAR BEFORE THE BOARD OF ZONING APPEALS FOR A HEARING OF YOUR CASE ON TUESDAY, AUGUST 22, 1961, AT 1:30 P.M. IN ROOM 401 CITY BUILDING ANNEX, 104 SOUTH MAIN, WICHITA, KANSAS.

THE MEETING OF JULY 25, 1961, FOR WHICH THIS CASE WAS ORIGINALLY SCHEDULED WAS NOT HELD INASMUCH AS A QUORUM OF THE MEMBERS OF THE BOARD WAS NOT PRESENT.

YOURS VERY TRULY,

ROBERT A. LAKIN
SECRETARY

RAL:BER
CC: WESLEY HOSPITAL AND
NURSES TRAINING SCHOOL
550 NORTH HILLSIDE
WICHITA, KANSAS

LAW OFFICES OF
BOYER, HONDROS & DONALDSON

WICHITA FEDERAL SAVINGS BUILDING

340 SOUTH BROADWAY

WICHITA 2, KANSAS

July 13, 1961

JOHN E. BOYER
GEORGE J. HONDROS
PAUL J. DONALDSON
HAROLD T. BECK
KENNETH P. STEWART
JAMES R. HANSON



Mr. Robert A. Lakin
Secretary
The City of Wichita
City Building Annex
Wichita, Kansas

Re: BZA 7-61
Application of Wesley Hospital
for Variance (Sign permit).

Dear Mr. Lakin:

Please be advised that it is anticipated by the Applicant herein that the proposed sign be installed on the hospital premises as indicated by the Application at a height whereby the distance between ground level and the base of the sign will be approximately ten (10) feet. It is thought that this height level is necessary to make the sign readily viewable by the general public.

Yours very truly,

BOYER, HONDROS & DONALDSON

By: *Kenneth P. Stewart*

KPS:jsb

BZA 7-61

NOTICES MAILED JULY 7, 1961

MEETING JULY 25, 1961

WESLEY HOSPITAL AND NURSES TRAINING SCHOOL
550 NORTH HILLSIDE

SOCONY VACUUM OIL COMPANY, INC.
300 NORTH BROADWAY

ESTHER A. SNYDER
401 NORTH PERSHING

RICHARD L. BROWN
EMMA TWIETMEYER BROWN
720 NORTH VASSAR

IRENE F. BENHAM
519 NORTH HILLSIDE

KENNETH P. STEWART
340 SOUTH BROADWAY

THOMAS J. LANNING, SECRETARY
DOWN AT LORING STREET

BOARD OF ZONING APPEALS
ROOM 402 CITY BUILDING ANNEX
104 SOUTH MAIN
WICHITA, KANSAS

JULY 7, 1961

NOTICE TO ADJOINING PROPERTY OWNERS

AN APPLICATION FOR A VARIANCE HAS BEEN FILED BY THE WESLEY HOSPITAL AND NURSE TRAINING SCHOOL, 550 NORTH HILLSIDE, WICHITA, KANSAS, BY BOYER, HONDROS & DONALDSON, 340 SOUTH BROADWAY, WICHITA, KANSAS, AS PROVIDED IN SECTION 2.12.590.2 OF THE CODE OF THE CITY OF WICHITA. THE APPLICANT DESIRES A VARIANCE TO ALLOW THE CONSTRUCTION OF A SIGN OF GREATER SIZE THAN PERMITTED UNDER THE ZONING ORDINANCE, SUCH SIGN TO BE LOCATED ON A TRACT DESCRIBED AS LOTS 2, 4, AND 6, WILSON PLACE, AT 550 NORTH HILLSIDE, WICHITA, KANSAS, AND GENERALLY LOCATED ON THE EAST SIDE OF HILLSIDE JUST NORTH OF CENTRAL.

THIS APPLICATION HAS BEEN ASSIGNED CASE No. BZA 7-61. A HEARING WILL BE HELD BY THE BOARD OF ZONING APPEALS ON TUESDAY, JULY 25, 1961, AT 1:30 P.M. IN ROOM 401 CITY BUILDING ANNEX, 104 SOUTH MAIN, WICHITA, KANSAS, AT WHICH TIME YOU MAY APPEAR, IF YOU SO DESIRE, EITHER IN PERSON OR BY AGENT OR ATTORNEY.

Robert A. Lakin
ROBERT A. LAKIN, SECRETARY
BOARD OF ZONING APPEALS

BOARD OF ZONING APPEALS
ROOM 402 CITY BUILDING ANNEX
104 SOUTH MAIN
WICHITA, KANSAS

JULY 7, 1961

NOTICE TO ADJOINING PROPERTY OWNERS

AN APPLICATION FOR A VARIANCE HAS BEEN FILED BY THE WESLEY HOSPITAL AND NURSE TRAINING SCHOOL, 550 NORTH HILLSIDE, WICHITA, KANSAS, BY BOYER, HONDROS & DONALDSON, 340 SOUTH BROADWAY, WICHITA, KANSAS, AS PROVIDED IN SECTION 2.12.590.2 OF THE CODE OF THE CITY OF WICHITA. THE APPLICANT DESIRES A VARIANCE TO ALLOW THE CONSTRUCTION OF A SIGN OF GREATER SIZE THAN PERMITTED UNDER THE ZONING ORDINANCE, SUCH SIGN TO BE LOCATED ON A TRACT DESCRIBED AS LOTS 2, 4, AND 6, WILSON PLACE, AT 550 NORTH HILLSIDE, WICHITA, KANSAS, AND GENERALLY LOCATED ON THE EAST SIDE OF HILLSIDE JUST NORTH OF CENTRAL.

THIS APPLICATION HAS BEEN ASSIGNED CASE No. BZA 7-61. A HEARING WILL BE HELD BY THE BOARD OF ZONING APPEALS ON TUESDAY, JULY 25, 1961, AT 1:30 P.M. IN ROOM 401 CITY BUILDING ANNEX, 104 SOUTH MAIN, WICHITA, KANSAS, AT WHICH TIME YOU MAY APPEAR, IF YOU SO DESIRE, EITHER IN PERSON OR BY AGENT OR ATTORNEY.

ROBERT A. LAKIN, SECRETARY
BOARD OF ZONING APPEALS

RECEIPT FOR CERTIFIED MAIL—20¢

No. 190764	SENT TO <i>Kenneth P. Stewart</i>	POSTMARK OR DATE
	STREET AND NO. <i>340 So Broadway</i>	
	CITY AND STATE <i>Wichita Kansas</i>	
If you want a return receipt, check which <input checked="" type="checkbox"/> 10¢ shows to whom and when delivered <input type="checkbox"/> 35¢ shows to whom, when, and address where delivered		If you want restricted delivery, check here <input type="checkbox"/> 50¢ fee
FEE ADDITIONAL TO 20¢ FEE POD Form 3800 Apr 1959 SEE OTHER SIDE		

POST OFFICE DEPARTMENT OFFICIAL BUSINESS	PENALTY FOR PRIVATE USE TO AVOID PAYMENT OF POSTAGE, \$300						
INSTRUCTIONS: Fill in items below and complete #1 on other side, when applicable. Moist gummed ends and attach to back of article. Print on front of article RETURN RECEIPT REQUESTED.							
3811 Jun. 1958 POD Form 3811	<table border="1"> <tr> <td>REGISTERED NO. <i>190764</i></td> <td>NAME OF SENDER <i>Board of Zoning Appeals</i></td> </tr> <tr> <td>CERTIFIED NO.</td> <td>STREET AND NO. OR P. O. BOX <i>104 So 403 City Bldg. Connel, main</i></td> </tr> <tr> <td>INSURED NO.</td> <td>CITY, ZONE AND STATE <i>Wichita Kansas</i></td> </tr> </table>	REGISTERED NO. <i>190764</i>	NAME OF SENDER <i>Board of Zoning Appeals</i>	CERTIFIED NO.	STREET AND NO. OR P. O. BOX <i>104 So 403 City Bldg. Connel, main</i>	INSURED NO.	CITY, ZONE AND STATE <i>Wichita Kansas</i>
REGISTERED NO. <i>190764</i>	NAME OF SENDER <i>Board of Zoning Appeals</i>						
CERTIFIED NO.	STREET AND NO. OR P. O. BOX <i>104 So 403 City Bldg. Connel, main</i>						
INSURED NO.	CITY, ZONE AND STATE <i>Wichita Kansas</i>						
CES-18-71548-4							

RECEIPT FOR CERTIFIED MAIL—20¢

No. 190765	SENT TO <i>Wesley Hospital & Nurses School</i>	POSTMARK OR DATE
	STREET AND NO. <i>550 N. Hillside</i>	
	CITY AND STATE <i>Wichita Kansas</i>	
If you want a return receipt, check which <input checked="" type="checkbox"/> 10¢ shows to whom and when delivered <input type="checkbox"/> 35¢ shows to whom, when, and address where delivered		If you want restricted delivery, check here <input type="checkbox"/> 50¢ fee
FEE ADDITIONAL TO 20¢ FEE POD Form 3800 Apr 1959 SEE OTHER SIDE		

POST OFFICE DEPARTMENT OFFICIAL BUSINESS	PENALTY FOR PRIVATE USE TO AVOID PAYMENT OF POSTAGE, \$300						
INSTRUCTIONS: Fill in items below and complete #1 on other side, when applicable. Moist gummed ends and attach to back of article. Print on front of article RETURN RECEIPT REQUESTED.							
3811 Jun. 1958 POD Form 3811	<table border="1"> <tr> <td>REGISTERED NO. <i>190765</i></td> <td>NAME OF SENDER <i>Board of Zoning Appeals</i></td> </tr> <tr> <td>CERTIFIED NO.</td> <td>STREET AND NO. OR P. O. BOX <i>104 So 403 City Bldg. Connel, main</i></td> </tr> <tr> <td>INSURED NO.</td> <td>CITY, ZONE AND STATE <i>Wichita, Kansas</i></td> </tr> </table>	REGISTERED NO. <i>190765</i>	NAME OF SENDER <i>Board of Zoning Appeals</i>	CERTIFIED NO.	STREET AND NO. OR P. O. BOX <i>104 So 403 City Bldg. Connel, main</i>	INSURED NO.	CITY, ZONE AND STATE <i>Wichita, Kansas</i>
REGISTERED NO. <i>190765</i>	NAME OF SENDER <i>Board of Zoning Appeals</i>						
CERTIFIED NO.	STREET AND NO. OR P. O. BOX <i>104 So 403 City Bldg. Connel, main</i>						
INSURED NO.	CITY, ZONE AND STATE <i>Wichita, Kansas</i>						
CES-18-71548-4							

No. 190764

RECEIPT FOR CERTIFIED MAIL—20¢

SENT TO <i>Kenneth P. Stewart</i>	POSTMARK OR DATE
STREET AND NO. <i>540 So Broadway</i>	
CITY AND STATE <i>Wichita Kans</i>	
<input checked="" type="checkbox"/> 10¢ shows to whom and when delivered	<input type="checkbox"/> 35¢ shows to whom, when, and address where delivered
If you want restricted delivery, check here <input type="checkbox"/> 50¢ fee	
FEES ADDITIONAL TO 20¢ FEE	
POD Form 3800 Apr 1950	
SEE OTHER SIDE	

#1-INSTRUCTIONS TO DELIVERING EMPLOYEE

Deliver ONLY to address Show address where delivered

(Additional charges required for these services)

RETURN RECEIPT

Received the numbered article described on other side.

SIGNATURE OR NAME OF ADDRESSEE (must always be filled in)

Kenneth P. Stewart

SIGNATURE OF ADDRESSEE'S AGENT, IF ANY

Mrs. U. G. Brown

DATE DELIVERED

7 July 1961

ADDRESS WHERE DELIVERED (only if requested in item #1)

CS-14-71545-4 GPO

No. 190765

RECEIPT FOR CERTIFIED MAIL—20¢

SENT TO <i>Wesley Hospital & Nurses School</i>	POSTMARK OR DATE
STREET AND NO. <i>550 N. Hillside</i>	
CITY AND STATE <i>Wichita Kansas</i>	
<input checked="" type="checkbox"/> 10¢ shows to whom and when delivered	<input type="checkbox"/> 35¢ shows to whom, when, and address where delivered
If you want restricted delivery, check here <input type="checkbox"/> 50¢ fee	
FEES ADDITIONAL TO 20¢ FEE	
POD Form 3800 Apr 1950	
SEE OTHER SIDE	

#1-INSTRUCTIONS TO DELIVERING EMPLOYEE

Deliver ONLY to address Show address where delivered

(Additional charges required for these services)

RETURN RECEIPT

Received the numbered article described on other side.

SIGNATURE OR NAME OF ADDRESSEE (must always be filled in)

Wesley Hospital

SIGNATURE OF ADDRESSEE'S AGENT, IF ANY

Garry Stenberg

DATE DELIVERED

JUL 7

ADDRESS WHERE DELIVERED (only if requested in item #1)



CS-14-71545-4 GPO

JULY 7, 1961

CERTIFIED MAIL

BOYER HONDROS & DONALDSON
340 SOUTH BROADWAY
WICHITA, KANSAS

ATTENTION: KENNETH P. STEWART

DEAR MR. STEWART:

RE: BZA 7-61

YOUR APPLICATION FOR A VARIANCE UNDER PROVISIONS OF PARAGRAPH 2.12.590.2 OF THE CODE OF THE CITY OF WICHITA, AND FILED ON BEHALF OF THE WESLEY HOSPITAL AND NURSE TRAINING SCHOOL, 550 NORTH HILLSIDE, WICHITA, KANSAS, AND RELATING TO PROPERTY AT THAT ADDRESS AND LEGALLY DESCRIBED AS

LOTS 2, 4, AND 6, WILSON PLACE, WICHITA, KANSAS,
HAS BEEN GIVEN BOARD OF ZONING APPEALS CASE No. BZA 7-61.

ALL INQUIRIES AND REFERENCES SHOULD BE MADE TO THAT CASE NUMBER WHEN YOU SEEK INFORMATION FROM THE SECRETARY.

FURTHER, YOU ARE NOTIFIED THAT YOU MAY APPEAR BEFORE THE BOARD OF ZONING APPEALS FOR A HEARING OF YOUR CASE ON TUESDAY, JULY 25, 1961, AT 1:30 P.M. IN ROOM 401 CITY BUILDING ANNEX, 104 SOUTH MAIN, WICHITA, KANSAS.

YOURS VERY TRULY,

ROBERT A. LAKIN
SECRETARY

RAL:BER

CC: THE WESLEY HOSPITAL AND NURSE TRAINING SCHOOL
550 NORTH HILLSIDE
WICHITA, KANSAS

APPLICATION FOR VARIANCE

I. NAME OF APPLICANT The Wesley Hospital and Nurse Training School
MAILING ADDRESS 550 North Hillside, Wichita, Kansas PHONE MU 2-1511
NAME OF AUTHORIZED AGENT Boyer, Hondros & Donaldson
MAILING ADDRESS 340 South Broadway, Wichita, Ks. PHONE HO 4-7321
RELATIONSHIP OF APPLICANT TO PROPERTY IS THAT OF Owner
(OWNER, TENANT, LESSEE, OTHER).

II. THE VARIANCE REQUESTED IS erection of a sign (a variance from Section 28.04.070 A.11)

FOR PROPERTY LOCATED AT 550 North Hillside
AND LEGALLY DESCRIBED AS LOT(S) 2, 4 and 6
BLOCK(S) _____, Wilson Place
ADDITION TO THE CITY OF WICHITA; AND WHICH IS PRESENTLY ZONED "B".
(GIVE METES AND BOUNDS DESCRIPTION BELOW IF APPROPRIATE):

III. THE APPLICANT HEREIN, OR HIS AUTHORIZED AGENT, HEREBY ACKNOWLEDGES:

- A. THAT HE HAS RECEIVED AN INSTRUCTION SHEET CONCERNING THE FILING AND HEARING OF THIS MATTER;
- B. THAT HE HAS BEEN ADVISED OF THE FEE REQUIREMENTS ESTABLISHED BY SECTION 2.12.580 OF THE CODE OF THE CITY OF WICHITA (ORDINANCE 24-606); AND THAT THE APPROPRIATE FEE IS HEREWITH TENDERED;
- C. THAT HE HAS BEEN ADVISED OF HIS RIGHT OF APPEAL OF THE DECISION OF THE BOARD OF CITY COMMISSIONERS WITHIN TEN (10) DAYS OF THAT DECISION;
- D. THAT A STATEMENT IS ATTACHED HERETO JUSTIFYING THIS REQUEST AS NOTED IN PARAGRAPH 3 OF THE INSTRUCTIONS AND IN SECTION 2.12.590.2 OF THE CODE OF THE CITY OF WICHITA.

The Wesley Hospital and Nurse Training School
APPLICANT

By: Kenneth P. Stewart
AUTHORIZED AGENT - Kenneth P. Stewart

OFFICE USE ONLY

RECEIVED IN OFFICE OF SECRETARY, BOARD OF ZONING APPEALS, _____
(A.M.-P.M.) _____, 19____, TOGETHER WITH APPROPRIATE
FEE OF \$30.00

SIGNED

CITY OF WICHITA
BUILDING INSPECTION DIVISION

To WESLEY HOSPITAL Owner Address 550 NORTH HILLSIDE
To KENNETH P. STEWART Applicant Address 340 SOUTH BROADWAY

Dear Sir:

Your application Dated JUNE 28, 1961

For a Permit for the ERECTION OF A SIGN
_____ at the premises designated as
550 NORTH HILLSIDE

Is hereby refused on this 29th day of JUNE, 1961.

Under Section 28.04.070 A-11 of the Zoning Ordinance.

For the reason that

THIS SIGN WOULD BE LARGER THAN THE 12 SQ. FT. AS PERMITTED BY THE ORDINANCE.
IT IS MY INTERPRETATION OF THE ORDINANCE THAT EVEN THOUGH THIS SIGN IS NOT
ASSOCIATED DIRECTLY WITH PROFESSIONAL OFFICES, IT IS THE INTENT OF THE
ORDINANCE THAT IT COME UNDER THE SAME REQUIREMENTS.

Respectfully,

Chief Building Inspector

NOTE: Any appeal from this refusal must be filed with the Board of Zoning Appeals (Room 304, City Hall) within ninety (90) days after the date of this refusal. For further information, take this notice to the Planning Department, Room 304, City Hall.

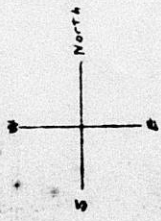
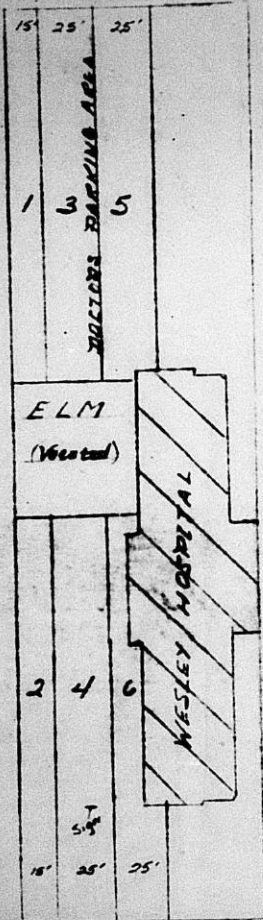

Scale 1" = 50' 0"

WESLEY

HOSPITAL

MEMOR

GENCY

Public

ENTRANCE AFTER 9:00 P.M.

'8-16

3-4

WESLEY HOSPITAL
EMERGENCY

Public ENTRANCE AFTER 9:00 P.M.

'8-16'

3-4'

ESLEY HOSPITAL
EMERGENCY

Public ENTRANCE AFTER 9:00 P.M.

8-101

OWNERSHIP LIST

Lot	Street	Addition	Property Owner
1		Wilson's 2nd Add.	Wesley Hospital and Nurses Training School 550 N. Hillside
2		"	"
3		"	"
4		"	"
5		"	"
6		"	"
7		"	"
8		"	"
9		"	"
10		"	"
11		"	"
12		"	"
13		"	"
14		"	"
15		"	"
16		"	"
17		"	"
18		"	"
19		"	"
20		"	"
21		"	"
22		"	"
24		"	"
89	Hillside Ave.	Resurvey of Buck's 2nd Addition	Lillian Preston Kessler Richard Watson Preston Lillian B. Preston Address unknown
91	"	"	"
93	"	"	"
95	"	"	"



Continued page 2

Lot	Street	Addition	Property Owner
97	Hillside Ave.	Resurvey of Buck's 2nd Addition	Socony Vacuum Oil Co., Inc. 300 N. Broadway
99	"	"	"
101	"	"	Esther A. Snyder 401 North Pershing
103	"	"	"
105	"	"	"
107	"	"	"
109	"	"	Richard L. Brown Emma Twietmeyer Brown 720 N. Vassar
111	"	"	"
1	"	Schuckman's Add.	"
N15' of 2	"	"	"
S10' of 2	"	"	Edna L. Anderson
3	"	"	"
4	"	"	"
5	"	"	Richard L. Brown Emma Brown 720 N. Vassar
6	"	"	"
7	"	"	"
8	"	"	Irene F. Benham 519 N. Hillside
9	"	"	"
N 24.44' of 10	"	"	"

Beginning at the Southwest corner of the
Southwest $\frac{1}{4}$ of Section 14-27-1E, thence,
North 396 ft., thence E. 330 ft., thence
South 396 ft., thence West 330 ft. to the
place of beginning

Wesley Hospital and Nurses
Training School
550 N. Hillside

LETTERS PRINTED
ERASE
OPTIONAL FORM NO. 10
MAY 1962 EDITION
GSA FPMR (41 CFR) 101-11.6

We, The Security Abstract and Title Company, Inc,
hereby certify the foregoing to be a true and correct list of property
owners within a 200 foot radius of Lots 2, 4 & 6, in Wilson Place
Addition to Wichita, Sedgwick County, Kansas, as shown by the deeds on
file in the Office of the Register of Deeds of Sedgwick County, Kansas,
on this 3rd day of July, 1960 at 7:00 A. M.

THE SECURITY ABSTRACT AND TITLE COMPANY, INC.

By



Vice President

Order No. 84523