

B.C.C./B. CO. C. \_\_\_\_\_

18.11.81  
18.11.81  
+ 7.30.81  
200  
1/4 Sec  
+ 200  
200  
200

Case No. BZA 50-80 - M.M.K., Inc.  
requests an exception to permit  
the establishment of an off-  
street parking lot on property  
zoned "A" Two-family Dwelling  
District and generally located  
approximately 125 feet north of

POSTED  
12-23-80  
JH

BZA  
50-80

# ACTION

COMMITTEE APPROVED DATE 12-23-80

M.A.P.C. \_\_\_\_\_

B.C.C./B. CO. C. \_\_\_\_\_

200 1/4 Sec 7-30-81  
Rear 7-30-81  
Shot 8-12-81  
Recorder 8-14-81

Case No. BZA 50-80 - M.M.K., Inc.  
requests an exception to permit  
the establishment of an off-  
street parking lot on property  
zoned "A" Two-family Dwelling  
District and generally located  
approximately 125 feet north of

Map No. 5648 B  
 Sec. 15  
 Twp. 27  
 Range 1E

BZA- 50-80  
 SCZ- \_\_\_\_\_  
 CU- \_\_\_\_\_  
 Filed \_\_\_\_\_

- AREA DATA:  
 1. Acres: \_\_\_\_\_ ( 100 ft. by 130 ft.)  
 2. Adjoining Zoning: E \_\_\_\_\_ S \_\_\_\_\_ W \_\_\_\_\_ N \_\_\_\_\_  
 3. Land Use: East SINGLE FAM South SINGLE FAM 1.5  
 West SINGLE FAM North SINGLE FAM  
 4. Sketch Plan Land Use is for: \_\_\_\_\_  
 5. Present Land Use if for: SINGLE FAM  
 6. Area (is) (is not) platted.

PHOTO DATA:  
 Taken by \_\_\_\_\_ Date \_\_\_\_\_ Time \_\_\_\_\_

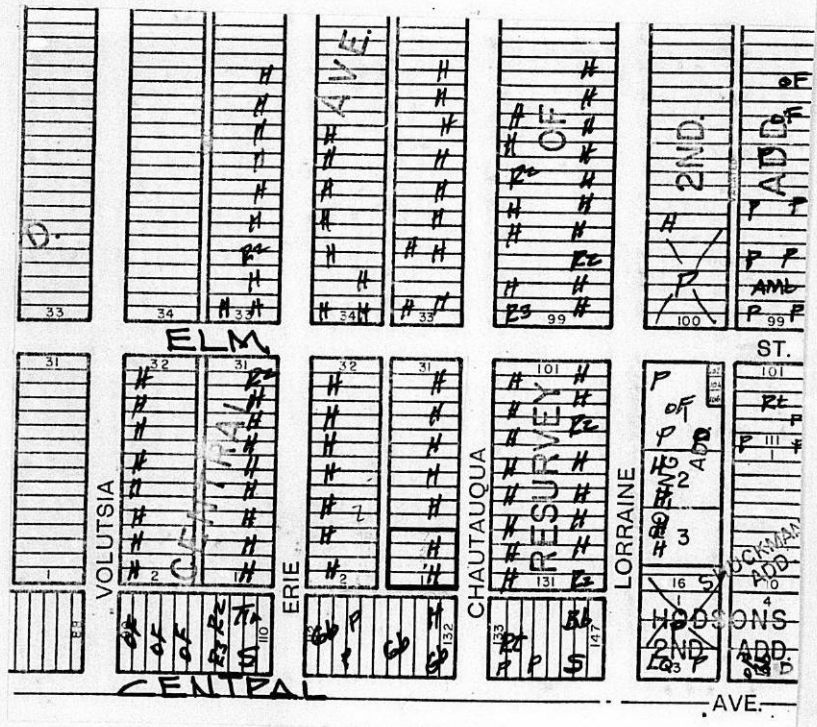

SPENCER, AN  
 LOS ANGELES COUNTY, CALIFORNIA, OR  
 ANDERSON, TULSA, OKLAHOMA, OR  
 U.S.A.  
 No. 2-153C  
**Spauld.**

July 1, 1981

Mr. Woodrow W. Goodvin  
Goodvin Church Builders, Inc.  
6200 East Central  
Wichita, Kansas 67208

Re: BZA 50-80

Dear Mr. Goodvin:

Attached hereto is a copy of Resolution BZA 50-80 authorizing the construction of an off-street parking lot in the "A" Two-family Dwelling District. Also enclosed is an approved copy of the landscape plan covering the 25 foot front yard adjacent to Chautauqua Street.

The City Commission approved the vacation of the alleys in the block bounded by Central, Chautauqua, Erie and Elm. You should take one more step in the vacation procedure by having the County Commission vacate title to that portion of the property.

If I can be of further assistance, please give me a call.

Sincerely,

Glen E. Lytle  
Special Assistant for Zoning

GEL:ead

Encls.

cc: M. M. E., Inc., 2916 East Central, Wichita  
Robert Feldner, Superintendent of Central Inspection (2)  
Don Gisick, City Clerk

RESOLUTION NO. BZA 50-80

WHEREAS, M.M.K., Inc., 2916 East Central, Wichita, Kansas requests an exception as provided in Section 2.12.590.C, Code of the City of Wichita, to establish an off-street parking lot on property zoned the "A" Two-family Dwelling District, and legally described as follows:

Lots 1, 3, 5 and 7 on Chautauqua Avenue in the Central Addition to the City of Wichita, Sedgwick County, Kansas. Generally located approximately 125 feet North of Central on the west side of the 500 block of North Chautauqua.

WHEREAS, proper notice as required by ordinance and by the rules of the Board of Zoning Appeals has been given; and

WHEREAS, the Board of Zoning Appeals did, at the meeting of December 23, 1980, consider said application; and

WHEREAS, the Board of Zoning Appeals has proper jurisdiction to consider said request for an exception under the provisions of Section 2.12.590.C, Code of the City of Wichita; and

WHEREAS, the Board of Zoning Appeals has authority to permit the establishment of an off-street parking lot on property zoned the "A" Two-family Dwelling District subject to the conditions outlined in Section 28.04.145, Code of the City of Wichita.

NOW, THEREFORE, BE IT RESOLVED by the Board of Zoning Appeals of the City of Wichita, that this application be approved to establish an off-street parking lot on property zoned the "A" Two-family Dwelling District and legally described as follows:

Lots 1, 3, 5 and 7 on Chautauqua Avenue in the Central Addition to the City of Wichita, Sedgwick County, Kansas. Generally located approximately 125 feet North of Central on the west side of the 500 block of North Chautauqua.

subject to the following conditions:

1. The parking area shall be used for passenger vehicles only, and in no case shall it be used for sales, repair work, storage, dismantling or servicing of any vehicles, equipment, materials or supplies.
2. Only such signs as are necessary for the proper operation of the parking lot shall be permitted and shall be limited in area as set forth in Section 28.04.139 of the code.
3. In no case shall a fee be charged for the parking spaces.
4. All parking areas, circulation aisles and driveways shall be surfaced with concrete, asphaltic concrete or asphalt, and shall be maintained in good condition and free of all weeds, dust, trash or other debris.
5. If lighting is provided, such lighting shall be installed so as to deflect or direct light away from the adjacent residential dwelling district.

6. A six to eight foot metal or wood screening fence shall be installed along the entire north and west property lines that are adjacent to the residential zoning district, however such fence shall be reduced in height to 3 feet in the 10 feet adjacent to Chautauqua.
7. The applicant shall submit a landscape plan for the 25 foot frontyard setback area that is adjacent to Chautauqua. The area shall be landscaped with grass and trees or low shrubs.
8. Prior to the release of the Resolution the alley shall be vacated or the applicant shall secure a minor street privilege for the use of the alley. Should the applicant fail to vacate the alley or secure a minor street privilege within six months from the date of the action of this Board, the action shall be rescinded and become null and void.
9. The applicant shall submit a drainage plan to the Department of Engineering for approval prior to the release of the resolution.
10. Upon the removal of the existing structure from the property with the intent to provide additional parking, the applicant shall submit a parking plan to the Secretary for approval.

ADOPTED AT WICHITA, KANSAS, this 23rd day of December, 1980.

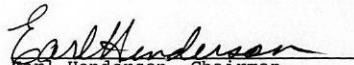
  
Earl Henderson, Chairman

ATTEST:

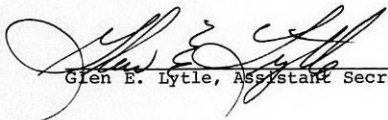
  
Glen E. Lytle, Assistant Secretary

June 24, 1981

Woodrow W. Goodvin  
Goodvin Church Builders, Inc.  
6200 East Central, Suite 100  
Wichita, Kansas 67208

Re: BZA 50-80

Dear Mr. Goodvin:

At the regular meeting of the Board of Zoning Appeals on June 23, 1981, your request for an extension of 60 days to complete the vacation of the alleys was granted. As soon as the vacation case is processed and completed, and we have received a landscape plan, we will release the Resolution authorizing the construction of the off-street parking as requested.

If I can be of further assistance, please let me know.

Glen E. Lytle  
Assistant Secretary

GEL:sad

cc: M.N.K., Inc., 2916 East Central, Wichita, Kansas  
Robert Feldner, Superintendent of Central Inspection (2)  
Don Giesick, City Clerk

# GOODVIN CHURCH BUILDERS, INC.

6200 East Central, Suite 100 / Wichita, Kansas 67208 / (316) 688-5781

RECEIVED

JUN 12 1981

METROPOLITAN PLANNING  
ROUTE  \_\_\_\_\_  
 \_\_\_\_\_

June 11, 1981

Glen E. Lytle  
Assistant Secretary  
Board of Zoning Appeals  
City Hall-Tenth Floor  
Wichita, Kansas 67202

RE: BZA 50-80  
Request for Extension  
of Time

Dear Mr. Lytle:

At the regular meeting of the Board of Zoning Appeals on December 23, 1980 the board approved our request subject to certain conditions. One of those conditions was that we would vacate the alleys or secure a minor street privilege within 6 months from date of action of the board.

At the regular meeting of the Metropolitan Area Planning Commission on May 21, 1981 the commission recommended that our application be approved subject to certain conditions. We are complying with those conditions. We are submitting copies of the vacation ordinance so this matter can be scheduled for hearing by the Board of City Commission.

We respectfully request 60 days additional time for the completion of meeting the requirements of vacating the alleys.

Very truly yours,



Woodrow W. Goodvin

WWG/mjs

**THE CITY OF WICHITA**

OFFICE OF CITIZEN PARTICIPATION

DATE December 22, 1980

TO Glen Lytle, Special Assistant for Zoning

FROM Bill Morris, CPO Administrative Aide

SUBJECT BZA 50-80: North of Central,  
on the west side of Chautauqua.

CPO Council "H" considered the captioned case on December 17th. The Council voted 6-0 to recommend approval of the proposed exception subject to the conditions outlined in the MAPD staff report.

The applicant and his agent were present at the meeting to describe the circumstances of the request. No residents were present to protest the case. Council "K" had initial concerns about screening, lighting, drainage and traffic flow at the site. However, the Council's concerns were resolved by the proposed conditions set forth by the BZA Secretariat.

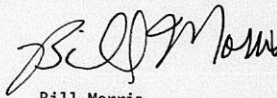

Bill Morris  
CPO Administrative Aide

BM:m1

Noted:

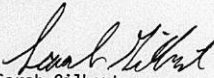

Sarah Gilbert  
Assistant CP Coordinator

**RECEIVED**

DEC 22 1980

METROPOLITAN PLANNING  
ROUTE  Lytle

WICHITA-SEDGWICK COUNTY

DATE

**METROPOLITAN AREA PLANNING DEPARTMENT**

April 30, 1981

**TO** Files

**FROM** Robert A. Lakin, Director of Planning

**SUBJECT** BZA 50-80 (V-1076) Vacation of the alleys bounded by Central, Erie, Chautauqua and Elm

In the above zoning appeals case, a condition for the use of the property was made that either a minor street privilege be obtained or the alleys vacated. Mr. Goodvin has secured the signatures of all the abutters to the above cited alleys with the exception of Lawrence P. Andra. Mr. Andra the owner of lots 10 and 12 Erie Street and Central Avenue Addition, has declined to participate in the application. It is Mr. Andra's view, that he does not want to be "involved" relative to the vacation case and more specifically, relative to potential liability that may be incurred by the approval of subject vacation.

The governing bodies and the Planning Commission have authorized the Director of Planning to be signatory on vacation cases to assist in their initiation in the event that there is a problem in securing the signature of owners. This authority has, basically, been used to provide an alternate to absentee owners or unlocated heirs, etc. It has been used, however, by me in the past to secure the satisfactory completion of a vacation case in a situation such as described above. Mr. Goodvin indicated to me in representing his clients M. M. K., Incorporated, that they would absorb any cost that may be incurred in the vacation case that might otherwise be assessed to or be an obligation of Mr. Andra. Such approval of any vacation case by the Planning Commission or the governing body should also be conditioned on this acceptance of liability. To assist in the vacation of these alleys it has been the City's policy to encourage, this application is hereby further authorized by me on behalf of the governing body of the City of Wichita and the Planning Commission, for the purposes of conducting and holding public hearings. It is recognized still, that the statutory controls prevail and that any abutter who appears may prevent the ultimate vacation of the alley. Such authorization as a participant in the application does not include the participation or acceptance in any way upon the City or the Planning Department of filing fees, relocation of utilities, and/or cost of proceedings.

  
Robert A. Lakin, Director of Planning

RAL:vn

December 24, 1980

Woodrow W. Goodvin, Jr.  
6200 East Central  
Wichita, Kansas

Re: BZA 50-80  
Request for Exception

Dear Mr. Goodvin:

At the regular meeting of the Board of Zoning Appeals on December 23, 1980, your request for an exception to permit the establishment of an off-street parking lot on property zoned the "A" Two-family Dwelling District was considered.

It was the action of the Board to approve your request subject to the following conditions:

1. The parking area shall be used for passenger vehicles only, and in no case shall it be used for sales, repair work, storage, dismantling or servicing of any vehicles, equipment, materials or supplies.
2. Only such signs as are necessary for the proper operation of the parking lot shall be permitted and shall be limited in area as set forth in Section 28.04.139 of the code.
3. In no case shall a fee be charged for the parking spaces.
4. All parking areas, circulation aisles and driveways shall be surfaced with concrete, asphaltic concrete or asphalt, and shall be maintained in good condition and free of all weeds, dust, trash or other debris.
5. If lighting is provided, such lighting shall be installed so as to deflect or direct light away from the adjacent residential dwelling district.
6. A six to eight foot metal or wood screening fence shall be installed along the entire north and west property lines that are adjacent to the residential zoning district, however such fence shall be reduced in height to 3 feet in the 10 feet adjacent to Chautauqua.

7. The applicant shall submit a landscape plan for the 25 foot frontyard setback area that is adjacent to Chautauqua. The area shall be landscaped with grass and trees or low shrubs.
8. Prior to the release of the Resolution the alley shall be vacated or the applicant shall secure a minor street privilege for the use of the alley. Should the applicant fail to vacate the alley or secure a minor street privilege within six months from the date of the action of this Board, the action shall be rescinded and become null and void.
9. The applicant shall submit a drainage plan to the Department of Engineering for approval prior to the release of the resolution.
10. Upon the removal of the existing structure from the property with the intent to provide additional parking, the applicant shall submit a parking plan to the Secretary for approval.

A Resolution setting forth the official action of the Board is being prepared and you will be mailed a copy as soon as you have complied with the conditions of approval.

If you have any questions, please call our office.

Sincerely yours,

Glen E. Lytle  
Assistant Secretary

GEL:sad

cc: Robert Feldner, Superintendent of Central Inspection (2)  
Don Gisick, City Clerk  
M.M.K., Inc., 2916 East Central, Wichita, Ks.

SECRETARY'S REPORT  
CASE NO. BZA 50-70

APPLICANT: M. M. K., Inc., 2916 East Central, Wichita, Kansas.

AGENT: Woodrow W. Goodvin, Jr., 6200 East Central, Wichita, Kansas.

REQUEST: Exception pursuant to Section 28.04.145, Code of the City of Wichita to permit the establishment of an off-street parking lot in a residential zoning district.

GENERAL LOCATION: On the west side of Chautauqua approximately 125 feet north of Central.

ZONING: Subject property is zoned "A" Two-family Dwelling District as are the properties to the north and west. Properties to the south and east are zoned "LC" Light Commercial.

LAND USE: Subject property is now occupied by a one-family dwelling. Property to the south, north and west are residential, and to the east developed commercial.

JURISDICTION:

The Board has jurisdiction to consider this request under the provisions outlined under Section 2.12.590.C, Code of the City of Wichita. The Board may grant the exception provided the conditions set out in Section 28.04.145 can be complied with.

COMMENTS BY THE SECRETARY:

The applicant is requesting an exception to permit the establishment of an off-street parking lot in the "A" Two-family Dwelling District to be used for additional parking and circulation for the applicant's offices located on the north side of Central. In accordance with the ordinance the parking area is within 600 feet of the use to which the parking is to be provided.

It has been the policy of the City to look with favor on the establishment of parking when the parking is for an existing use, that is adjacent to a major street that either has had the on-street parking removed, or in all probability may be removed at some point in time to provide for increased traffic flow. In this particular instance, on-street parking is now prohibited on Central.

The applicant is requesting the exception to improve the traffic flow into the parking area by making a one-way drive off of Central and providing an exit onto Chautauqua with the addition of 23 spaces on the proposed parking lot. It should be noted that the applicant intends to retain the existing house as a residence on property, but to convert a major portion of the rear yard and sideyard to parking.

It should also be noted that the applicant is proposing to use portions of the existing dedicated alley for parking and circulation driveways. Although neither the east-west or north-south alleys have ever been open, it will be necessary to vacate the alleys or to request the alleys to be opened and improved so that the parking improvements can be made.

RECOMMENDATION:

It is the opinion of the Secretary that the use is in accordance with the policy of the City to accommodate existing uses and that the exception be approved subject to the following conditions:

1. The parking area shall be used for passenger vehicles only, and in no case shall it be used for sales, repair work, storage, dismantling or servicing of any vehicles, equipment, materials or supplies.
2. Only such signs as are necessary for the proper operation of the parking lot shall be permitted and shall be limited in area as set forth in Section 28.04.139 of the code.
3. In no case shall a fee be charged for the parking spaces.
4. All parking areas, circulation aisles and driveways shall be surfaced with concrete, asphaltic concrete or asphalt, and shall be maintained in good condition and free of all weeds, dust, trash or other debris.
5. If lighting is provided, such lighting shall be installed so as to deflect or direct light away from the adjacent residential dwelling district.
6. A six to eight foot metal or wood screening fence shall be installed along the north and west property lines that are adjacent to the residential zoning district, however such fence shall be reduced in height to 3 feet in the 25 foot setback adjacent to Chautauqua.
7. The applicant shall submit a landscape plan for the 25 foot frontyard setback area that is adjacent to Chautauqua. The area shall be landscaped with grass and trees or low shrubs.
8. Prior to the release of the Resolution the alley shall be vacated. Should the applicant fail to vacate the alley within six months from the date of the action of this Board, the action shall be rescinded and become null and void.
9. Upon the removal of the existing structure from the property with the intent to provide additional parking, the applicant shall submit a parking plan to the Secretary for approval.

BZA CASE NO. 50-80

2 NOTICES SENT TO APPLICANT/AGENT

10 NOTICES SENT TO MAPC

1 NOTICES SENT TO CPO

26 NOTICES SENT TO ADJOINING PROPERTY OWNERS

39 TOTAL NOTICES SENT 12-3-80

BOARD OF ZONING APPEALS  
Tenth Floor - City Hall  
455 North Main, Wichita, Kansas 67202

December 3, 1980

NOTICE TO ADJOINING PROPERTY OWNERS:

CASE NO. BZA 50-80

An application has been filed by M. M. K., Inc., 2916 East Central, Wichita, Kansas, pursuant to Section 2.12.590.C, Code of the City of Wichita, requesting an exception to permit the establishment of an off-street parking lot on property zoned the "A" Two-family Dwelling District and legally described as follows:

Lots 1, 3, 5 and 7 on Chautauqua Avenue  
in the Central Addition to the City of  
Wichita, Sedgwick County, Kansas.  
Generally located approximately 125 feet  
North of Central on the west side of the  
500 block of North Chautauqua.

This application has been assigned case No. BZA 50-80, and will be considered by the Board of Zoning Appeals at its meeting on Tuesday, December 23, 1980, at 1:30 p.m., in the Board Room, First Floor, City Hall, 455 North Main, Wichita, Kansas, at which time you may appear if you so desire, either in person or by agent or attorney. If you have any questions about this application, please call 268-4421 and ask for Lynn Shirkey or Glen Lytle.

It should be noted that the Citizen Participation Organization Area Council may consider this case at its next meeting. Additional information about such a meeting may be obtained by calling the CPO Office, 268-4516.

Jack H. Galbraith  
Secretary

BOARD OF ZONING APPEALS

CASE NO. 50-80

CITY OF WICHITA, KANSAS

FILED \_\_\_\_\_

APPLICATION FOR EXCEPTION

I. Name of Applicant M. M. K., Inc.  
Mailing Address 2916 E. Central Phone 684-5243  
Name of Authorized Agent Goodvin Church Builders, Inc.  
Mailing Address 6200 E. Central, Suite 100 Phone 688-5781  
Relationship of applicant to property is that of Owner  
(Owner, Tenant, Lessee, Other)

II. Application is made for an exception as provided in Section 2.12.590.C, Code of the City of Wichita, Kansas, to permit the establishment of an off-street Parking Lot

on property zoned "A" Temp Family  
approximately 125 feet North of Center on the west side of the  
located 500 Block of N. Chautauqua  
and legally described as: Lots 1, 3, 5 and 7 on Chautauqua  
Ave. in the Central Addition to the City of Wichita.

\_\_\_\_\_, in the City of Wichita.

- III. The applicant herein, or his authorized agent, acknowledges:
- That he has received an instruction sheet concerning the filing and hearing of this matter;
  - That he has been advised of the fee requirements established by Section 2.12.580 of the Code of the City of Wichita (Ordinance No. 36-596); and that the appropriate fee is herewith tendered;
  - That all documents are attached hereto as noted in paragraphs 2, 3, and 4 of the instructions;
  - That he has been advised of his right to bring action in the District Court of Sedgwick County to appeal the decision of the Board.

Applicant M. M. K., Inc.

Authorized Agent Woodrow W. Goodvin, Jr.  
Woodrow W. Goodvin, Jr.

OFFICE USE ONLY: Received in Office of Secretary, Board of Zoning Appeals, 3:00 (a.m.-p.m.), November 3, 1980 together with appropriate fee of 200.00.

Signed H. Lytle

# GOODWIN & ASSOCIATES

PROFESSIONAL ASSOCIATION

Architects / 8200 East Central, Suite 100 / Wichita, Kansas 67208 / (316) 688-5781

The exception to the zoning regulations is being requested because of the need for additional off street parking at the Doctor's Office located at 2916 E. Central, which is adjacent to the property for which a exception is being requested. The area around this property has limited off street parking, and it is felt by granting this exception some parking traffic on Chautauqua will be eliminated thereby creating a safer environment on the street.

## OWNERSHIP LIST

LOT	STREET	ADDITION	PROPERTY OWNER
1 & 3	Chautauqua	Central Avenue	MMK/Inc. Address unknown <i>Def</i>
5 & 7	"	"	"
9 & 11	"	"	James M. Rhodenbaugh Patricia A. Rhodenbaugh 529 N. Chautauqua 67214
13 & 15	"	"	Karen A. Wilkins Perry B. Wright Address Unknown
17 & 19	"	"	<i>cont front</i> 423 1/2 E 15 337 N Belmont Vinson D. Krehbiel Address Unknown
21 & 23	"	"	Bernard R. Hoover Norma J. Hoover 545 N. Chautauqua 67214
W 50ft 25	"	"	Albert J. Spies Alvena M. Spies 316 S. Bluff 67218
25 exc W 50 ft.	"	"	Wayne H. Seward Lois G. Seward Address unknown
2 & 4	Erie	"	Merle H. Huyett Ida Margaret Huyett 516 N. Erie 67214
6 & 8	"	"	MMK/Inc. Address Unknown <i>Def</i>
10 & 12	"	"	Lawrence P. Andra 1566 West Lynn 67212
14 & 16	"	"	Dale M. Johnson Ellen M. Johnson Address Unknown
18 & 20	"	"	<i>2885 W. ind</i> 3501 Leonine 700 1/2 Hamlet Circle Otto R. Coburn Gladys R. Coburn 532 N. Erie 67214
22 & 24	"	"	Earnest M. Craghead Merwyn M. Craghead 544 N. Erie 67214
26	"	"	Joan Ferguson Jacqueline Mendenhall Donald Lee Mendenhall 1713 Nottingham Ln 67204

page 2

LOT	STREET	ADDITION	PROPERTY OWNER
1 & 3	Erie	Central Avenue	✓ Ira E. Kennedy (deceased) Elizabeth Kennedy 519 N. Erie 67214
5 & 7	"	"	✓ Lawrence W. Osborne Ella Mary Osborne 523 N. Erie 67214
9 & 11	"	"	✓ William S. Gross Dorothy G. Gross 527 N. Erie 67214
13 & 15	"	"	✓ Robert S. Collins Donna K. Collins 531 N. Erie 67214
110	Central	"	Returned 12-17-80 <i>don't own property</i> ✓ Eugene S. Mohney Mildred L. Brown Address Unknown <i>544 S. Erie</i>
112-114-116 & W 19ft 118	"	"	✓ Richard E. Stalcup Wilma E. Stalcup 5206 E. Gilbert 67218
E 6ft of 118 & all 120-122 & W 10ft of 124	"	"	✓ MMK/Inc. Address unknown
S 100ft of E 15 ft. of 124 & S 100 ft. of 126 & S 100ft. of W 10ft of 128	"	"	Same
E 15ft. of N 40ft of 124 & the N 40 ft of 126-128-130-132	"	"	✓ A. R. Pirtle 511 N. Chautauqua 67214
S 100ft of E 15ft. of 128 & S 100ft of 130 & 132	"	"	✓ Lavada May Irick 2924 E. Central 67214
W $\frac{1}{2}$ of 107	Chautauqua/ Lorraine	Resurvey of Bucks' Second	✓ H. N. Babcock 531 S. Yale 67218
W $\frac{1}{2}$ of 109 & 111	"	"	✓ J. Thomas Wells Ruth E. Wells 544 N. Chautauqua 67214
E $\frac{1}{2}$ of 111	"	"	✓ Claude A. Miller Jr. Address Unknown III <i>1056 N. Christine St.</i>
W $\frac{1}{2}$ of 113 & 115	"	"	✓ Ivan L. Wells Violet Louise Wells 530 N. Chautauqua 67214
E $\frac{1}{2}$ of 113 & 115	"	"	✓ Donald E. Evans 2447 Cardinal Dr. 67204
W $\frac{1}{2}$ of 117 & 119	"	"	✓ Ivan L. Wells Violet L. Wells 530 N. Chautauqua 67214

page 3

LOT	STREET	ADDITION	PROPERTY OWNER
E $\frac{1}{2}$ of 117 & 119	Chautauqua/ Lorraine	Resurvey of Bucks' Second	Ivan L. Wells Violet L. Wells 530 N. Chautauqua 67214
W $\frac{1}{2}$ of 121 & 123	"	"	Ivan L. Wells Violet Louise Wells 530 N. Chautauqua 67214
E $\frac{1}{2}$ of 121 & 123	"	"	"
W $\frac{1}{2}$ of 125 & 127	"	"	"
E $\frac{1}{2}$ 125 & 127	"	"	"
W $\frac{1}{2}$ of 129 & 131	"	"	Bernard R. Lickteig Mary Ann Lickteig Notice of Contract to Dae H. Chang Seunghi C. Chang Steven C. Cho d/b/a AhSoRestaurant 3002 E. Central 67214
133-135-137 & W 82ft. of Vac. alley on North	Central	"	Same
E $\frac{1}{2}$ 129 & 131	Chautauqua/ Lorraine	"	Ralph Hale Donna D. Hale 1441 N. Rock Rd. 67207
139-141	Central	"	Stella I. Simpson Address Unknown
N 80ft of 143 & 145	"	"	Lec A. Goseland 260 N. Rock Rd 67206
S 60ft of 143 & 145	"	"	Holiday Oil Co. Inc. Address Unknown

We hereby certify the foregoing to be a true and correct list of property owners in a 200 foot radius of Lots 1-3-5-7 on Chautauqua Avenue in Central Avenue Addition, as shown by the records in the office of the Register of Deeds of Sedgwick County, Kansas, this the 27th Day of October 1980, A. D. at 7:00 A.M.

Order No.  
293428

THE SECURITY ABSTRACT AND TITLE COMPANY INC.

By Mary Goss  
Vice President

FORM 29-1

PAYMENT NOTICE  
City of Wichita

Bldg.	Use of Str.	Code Bks	Copies
Elec	Elev. Insp.	Hse Moving	Lic.
Mech	Boiler Insp.	Pav. Cuts	Cert.
Plbg	Exam Fees	Sewer	Elev.
Signs	Plan Rev. (P.W.)	Cement	M.S.P.
	Planning		

DESCRIPTION AMOUNT

CITY BZA 250.00

NAME

ADDRESS

FUND

DUE DATE

COMMENTS

DATE

BY

WICHITA - SEDGWICK COUNTY

**W.S.C.**

BOARD OF ZONING APPEALS  
CITY HALL - TENTH FLOOR  
455 NORTH MAIN STREET  
WICHITA, KANSAS 67202



ADDRESS UNKNOWN

*[Handwritten signature]*

RETURNED TO CARRIER  
FOR UNDELIVERABLE

*resent to  
12-17-80*

~~Eugene S. Mohnet~~  
~~Mildred L. Brown~~  
401 North Knight  
Wichita, Kansas

*Avenue opened by mistake at  
this address try 3810 or 3828*

*E. Central*

*67214*

*Mrs Eugene Mohnet*

*[Handwritten initials]*

\*

This BZA. Case  
Has a Large Drawing  
On 35mm Microfilm

Roll # 2