

*Handing & Holding
 Simon of the BZA
 Harold Warner
 1-20-88*

SCHEME 'A' SITE PLAN
 1"=20'-0"

LEGAL

LOT 28: HILDES'S BIVESTIDE ADDITION
 TO BE REPLATTED AS:
 LOT 1: LAMAR FIRST ADDITION

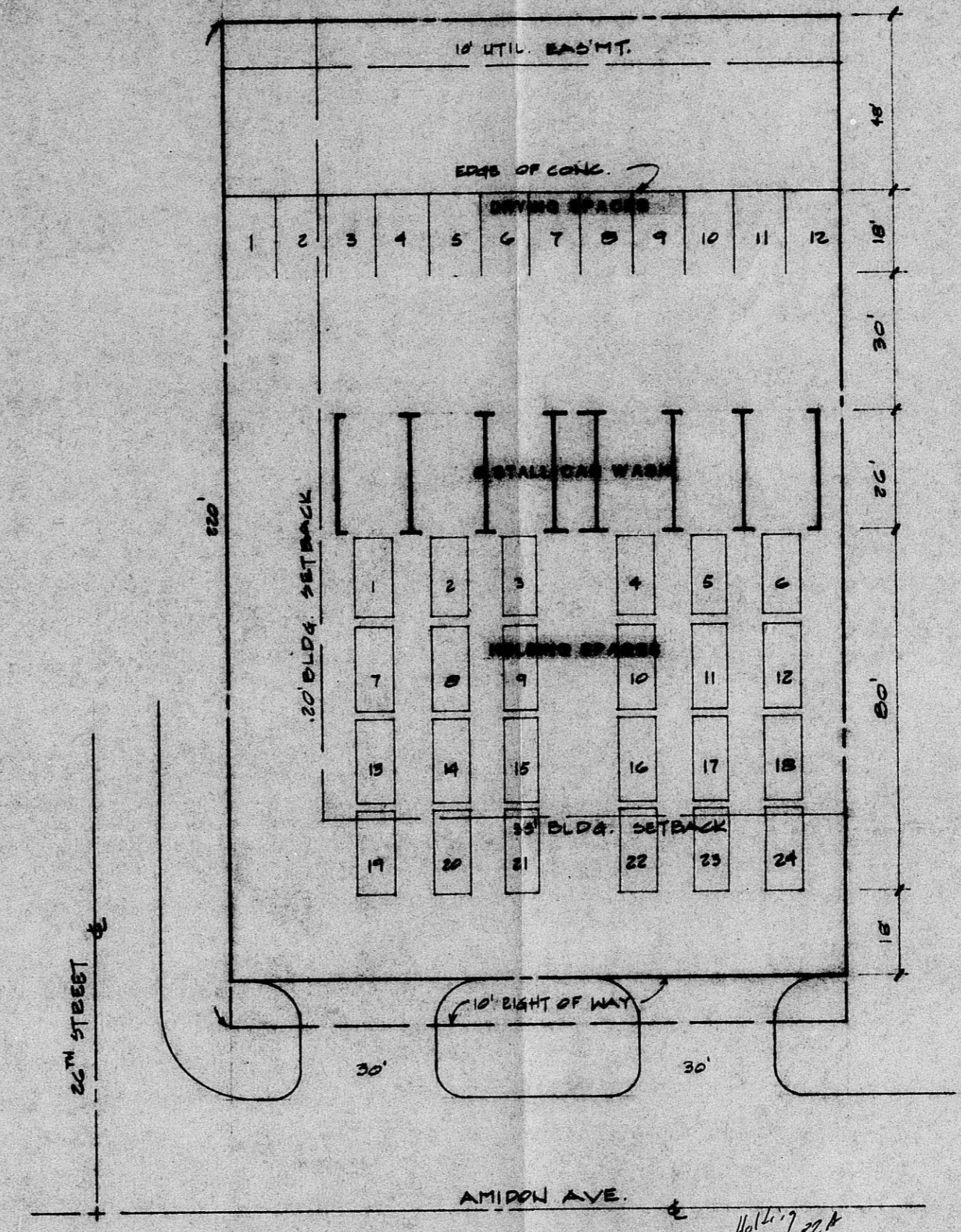

*Handing & Holding
 Simon of the BZA
 Harold Warner
 1-20-88*

SCHEME 'B' SITE PLAN
 1"=20'-0"

CONTINGENT UPON APPROVAL OF REPLAT
 WITH 2-ACCESS CONTROL OPENINGS

Superseded

CAR WASH
 FOR
 HAROLD WARNER

BZA 2-88

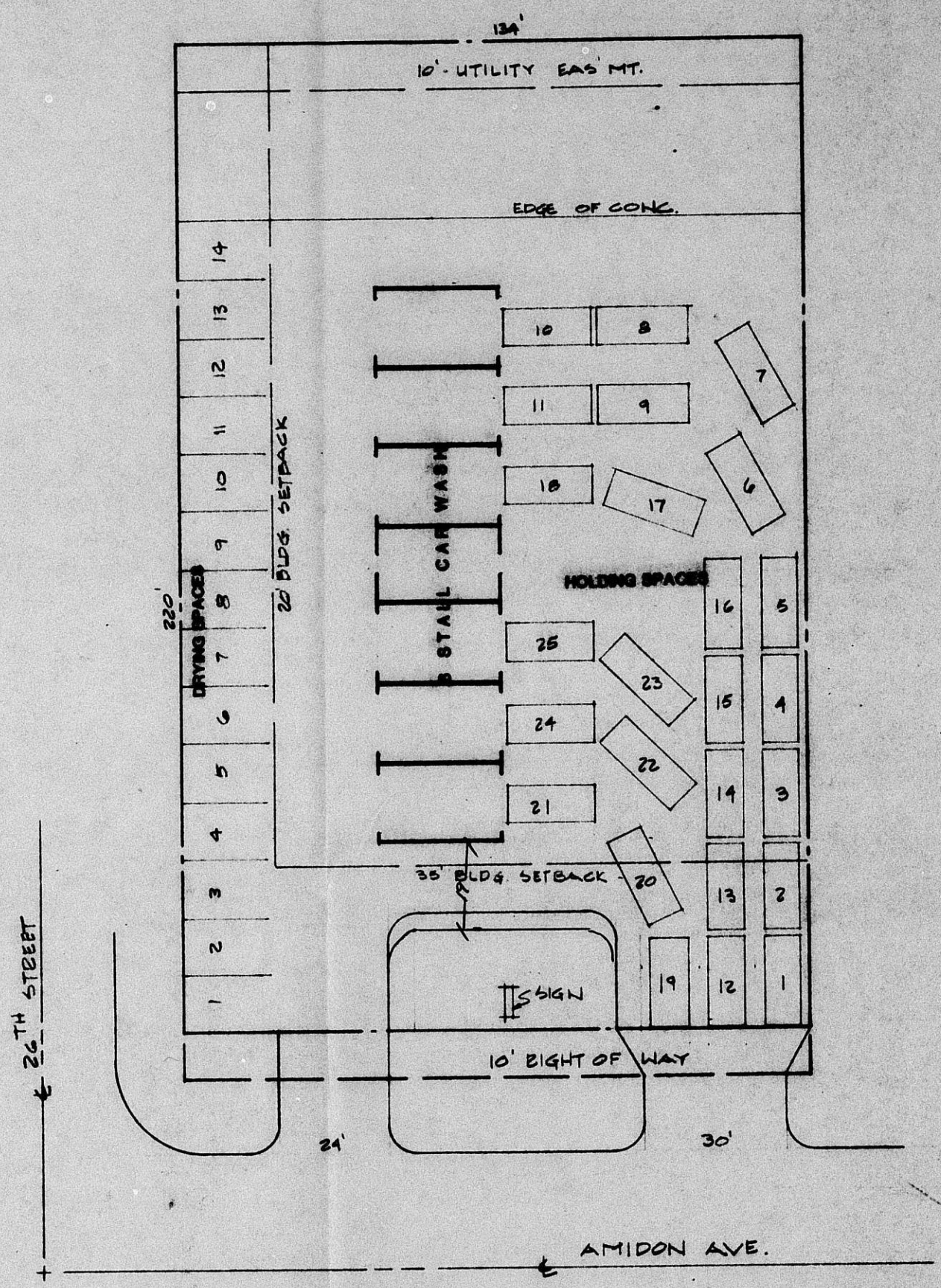

*Parking & Drive
OK for BZA
Ted Zelle
2-17-88*

SITE PLAN
1" = 20'-0"



LEGAL

LOT 20 GILDER'S RIVERSIDE ADDITION
TO BE REPLATTED AS:
LOT 1 LAMAR FIRST ADDITION

CAR WASH
FOR
MAROLD WARNER

BZA 2-88

MWD C-7