

**SHEET SCHEDULES**

**ARCHITECTURAL**

| NO.               | CONTENT   |
|-------------------|---|
| 1                 | EXISTING/NEW SITE PLAN                          |
| 1A                | PLANT/SCREEN ADDITION                           |
| 1B                | SEAL/CONCRETE ADDITION                          |
| 2                 | FLOOR PLAN                                      |
| 3                 | ROOM FINISH SCHEDULE/WALL CONDITIONS            |
| 4                 | DOOR SCHEDULES/DOOR DETAILS                     |
| 5                 | ELEVATIONS                                      |
| 6                 | 1/2" BUILDING SECTIONS                          |
| 7                 | 3/4" WALL SECTIONS                              |
| 8                 | 3/4" BUILDING SECTIONS (PENTHOUSE/COILING DUCT) |
| 9                 | 3/4" BUILDING SECTIONS (LOBBY/STAIR CASES)      |
| 10                | ROOF PLAN/EXTERIOR SITE DETAILS                 |
| 11                | INTERIOR ROOM ELEVATIONS                        |
| 12                | LOBBY MILLWORK/PA PARTITIONS                    |
| 13                | W.C. DETAILS/MANHOLE DETAILS                    |
| 14                | REFLECTED CEILING PLAN                          |
| 15                | LANDSCAPE PLAN                                  |
| 16                | LAWN IRRIGATION PLAN                            |
| <b>STRUCTURAL</b> |   |
| S1                | FOUNDATION PLAN - S-1 DETAILS                   |
| S2                | ROOF FRAMING PLAN                               |
| <b>MECHANICAL</b> |   |
| M1                | M-1 MECH. R.V. P.L.R. PLAN                      |
| M2                | M-2 PLUMBING P.L.R. PLAN - M-2 DETAIL SHEET     |
| M3                | M-3 HVAC P.L.R. PLAN - M-3 DETAIL SHEET         |
| M4                | M-4 MECH. CENTER                                |
| <b>ELECTRICAL</b> |   |
| E1                | E-1 ELECTRICAL P.L.R. PLAN                      |
| E2                | E-2 PARTIAL BLDG. PLAN/PANEL SCHEDULES          |

**BZA48**

**NEW SITE PLAN 1"=40'-0"**

GRADES TO FALL UNIFORMLY & RADIIALLY FROM 115.0 HIGH POINT (N 210 MARKING). EXISTING TREE LOCATIONS TO BE VERIFIED. TREE IN RED FOR OPERATIONS. TREE LOCATIONS & SHADES ARE APPROXIMATE.

**LEGENDS**

|   |   |
|---|---|
| <p><b>REFERENCES:</b></p> <p>SECTION NO. BUILDING SECTION</p> <p>SECTION NO. WALL SECTION</p> <p>SECTION NO. PARTIAL BLDG. SECTION</p> <p>SCHEDULE NO. DOOR REFERENCE</p> <p>WALL NUMBER REFERENCE</p> <p>DETAIL NO. REFERENCE</p> <p>FLYING REFERENCE</p> <p>RM. NO. REFERENCE</p> <p>REF. SYMBOL BY REFERENCE</p> | <p><b>BLDG. MATLS.</b></p> <p>CONC. MASS UNITS</p> <p>FACE BRICK</p> <p>PG-FASCAD</p> <p>CAST CONC.</p> <p>MTL STUD PARTITION</p> <p>GYP DO</p> <p>STPL</p> <p>ALUMINUM</p> <p>ROOF INSUL</p> <p>BATT INSUL</p> <p>PLYWOOD</p> <p>TOUGH FRAMING</p> |
|---|---|

REVISED

TOTAL PROJECT AREA = 76,800'²  
 BLDG. AREA = 23,800'²  
 FUTURE ADDITIONS = 4,000'²  
 PARKING AREA = 26,000'²  
 ASCEND, STG. = 7,000'²  
 RESTROOMS, ELEVATORS, STG. = 11,000'²  
 LANDSCAPE, BLDG. = 2,177'²  
 TOTAL OCCUPANTS = 1,157  
 TYPE 2 + CONSTRUCTION  
 \*SCALE = 1/8" = 24,000' x 250' = 78'

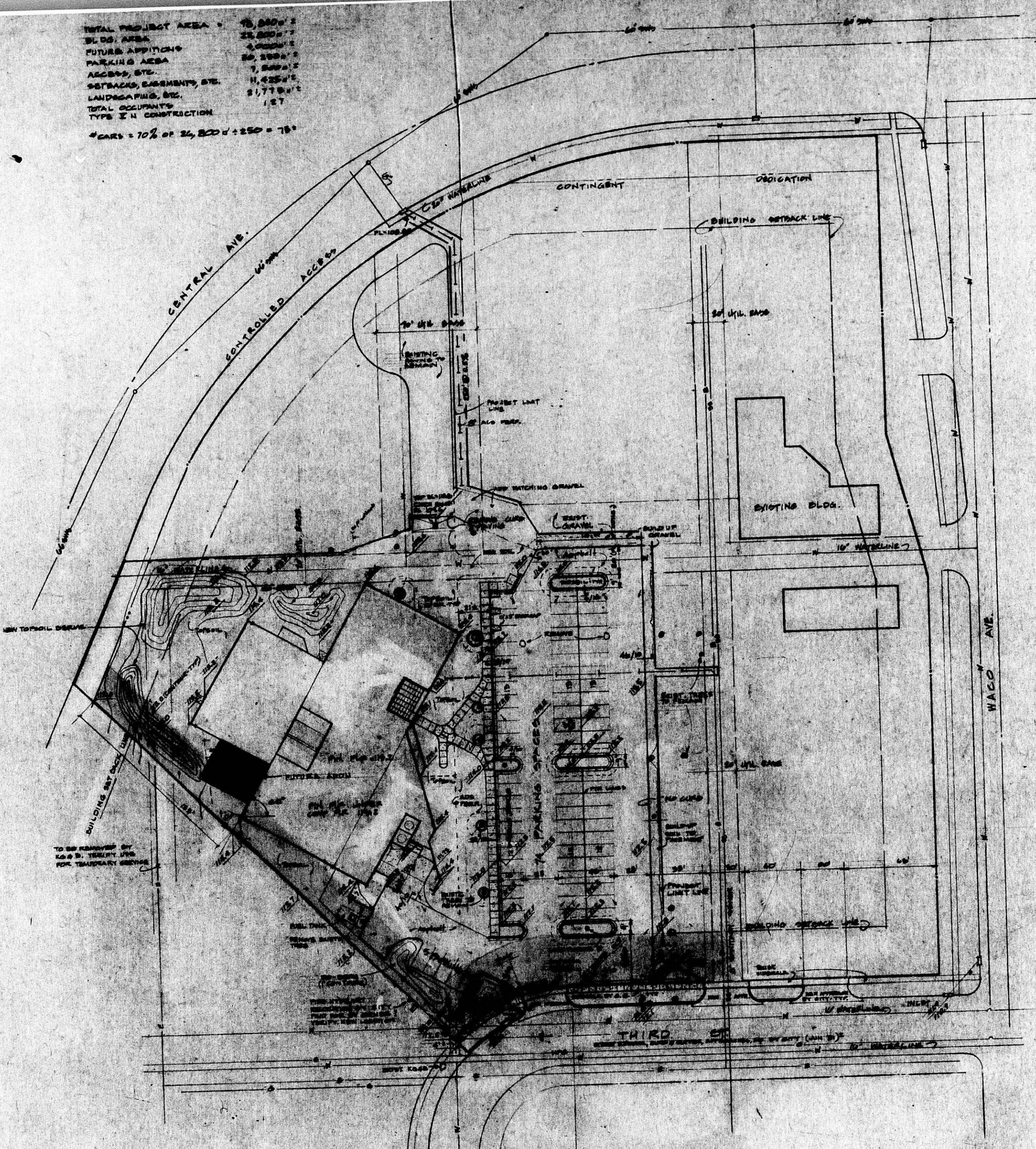

BZA 4-81

BZA 4-81

**SHEET SCHEDULE**

**ARCHITECTURAL**

| NO.               | CONTENT                               |
|-------------------|---------------------------------------|
| 1                 | EXISTING/NEW SITE PLAN                |
| 1A                | PLATTENBERGER ADDITION                |
| 2                 | GRADE PLAN/EMBANKMENT ADDITION        |
| 3                 | FLOOR PLAN                            |
| 4                 | ROOM FINISH SCHEDULE/WALL CONNECTIONS |
| 4A                | DOOR SCHEDULE/DOOR DETAILS            |
| 5                 | ELEVATIONS                            |
| 6                 | WALL SECTIONS                         |
| 7                 | WALL SECTIONS                         |
| 8                 | WALL SECTIONS (PARTIALS/COILING OVER) |
| 9                 | WALL SECTIONS (W/STY PLUMBING/GUAGES) |
| 10                | ROOF PLAN/EXTERIOR SITE DETAILS       |
| 11                | INTERIOR ROOM ELEVATIONS              |
| 12                | W/STY MILLWORK/PA PARTITIONS          |
| 13                | W/STY DETAILS/LANDMARK DETAILS        |
| 14                | REFLECTED CEILING PLAN                |
| 15                | LANDSCAPE PLAN                        |
| 16                | LAWN IRRIGATION PLAN                  |
| <b>STRUCTURAL</b> |                                       |
| S-1               | FOUNDATION PLAN - S-1 DETAILS         |
| S-2               | ROOF FRAMING PLAN                     |
| <b>MECHANICAL</b> |                                       |
| M-1               | M-1 MECH. PLAN                        |
| M-2               | M-2 MECH. PLAN                        |
| M-3               | M-3 MECH. PLAN                        |
| M-4               | M-4 MECH. PLAN                        |
| M-5               | M-5 MECH. PLAN                        |
| M-6               | M-6 MECH. PLAN                        |
| M-7               | M-7 MECH. PLAN                        |
| M-8               | M-8 MECH. PLAN                        |
| M-9               | M-9 MECH. PLAN                        |
| M-10              | M-10 MECH. PLAN                       |
| M-11              | M-11 MECH. PLAN                       |
| M-12              | M-12 MECH. PLAN                       |
| M-13              | M-13 MECH. PLAN                       |
| M-14              | M-14 MECH. PLAN                       |
| M-15              | M-15 MECH. PLAN                       |
| M-16              | M-16 MECH. PLAN                       |
| M-17              | M-17 MECH. PLAN                       |
| M-18              | M-18 MECH. PLAN                       |
| M-19              | M-19 MECH. PLAN                       |
| M-20              | M-20 MECH. PLAN                       |
| M-21              | M-21 MECH. PLAN                       |
| M-22              | M-22 MECH. PLAN                       |
| M-23              | M-23 MECH. PLAN                       |
| M-24              | M-24 MECH. PLAN                       |
| M-25              | M-25 MECH. PLAN                       |
| M-26              | M-26 MECH. PLAN                       |
| M-27              | M-27 MECH. PLAN                       |
| M-28              | M-28 MECH. PLAN                       |
| M-29              | M-29 MECH. PLAN                       |
| M-30              | M-30 MECH. PLAN                       |
| M-31              | M-31 MECH. PLAN                       |
| M-32              | M-32 MECH. PLAN                       |
| M-33              | M-33 MECH. PLAN                       |
| M-34              | M-34 MECH. PLAN                       |
| M-35              | M-35 MECH. PLAN                       |
| M-36              | M-36 MECH. PLAN                       |
| M-37              | M-37 MECH. PLAN                       |
| M-38              | M-38 MECH. PLAN                       |
| M-39              | M-39 MECH. PLAN                       |
| M-40              | M-40 MECH. PLAN                       |
| M-41              | M-41 MECH. PLAN                       |
| M-42              | M-42 MECH. PLAN                       |
| M-43              | M-43 MECH. PLAN                       |
| M-44              | M-44 MECH. PLAN                       |
| M-45              | M-45 MECH. PLAN                       |
| M-46              | M-46 MECH. PLAN                       |
| M-47              | M-47 MECH. PLAN                       |
| M-48              | M-48 MECH. PLAN                       |
| M-49              | M-49 MECH. PLAN                       |
| M-50              | M-50 MECH. PLAN                       |
| M-51              | M-51 MECH. PLAN                       |
| M-52              | M-52 MECH. PLAN                       |
| M-53              | M-53 MECH. PLAN                       |
| M-54              | M-54 MECH. PLAN                       |
| M-55              | M-55 MECH. PLAN                       |
| M-56              | M-56 MECH. PLAN                       |
| M-57              | M-57 MECH. PLAN                       |
| M-58              | M-58 MECH. PLAN                       |
| M-59              | M-59 MECH. PLAN                       |
| M-60              | M-60 MECH. PLAN                       |
| M-61              | M-61 MECH. PLAN                       |
| M-62              | M-62 MECH. PLAN                       |
| M-63              | M-63 MECH. PLAN                       |
| M-64              | M-64 MECH. PLAN                       |
| M-65              | M-65 MECH. PLAN                       |
| M-66              | M-66 MECH. PLAN                       |
| M-67              | M-67 MECH. PLAN                       |
| M-68              | M-68 MECH. PLAN                       |
| M-69              | M-69 MECH. PLAN                       |
| M-70              | M-70 MECH. PLAN                       |
| M-71              | M-71 MECH. PLAN                       |
| M-72              | M-72 MECH. PLAN                       |
| M-73              | M-73 MECH. PLAN                       |
| M-74              | M-74 MECH. PLAN                       |
| M-75              | M-75 MECH. PLAN                       |
| M-76              | M-76 MECH. PLAN                       |
| M-77              | M-77 MECH. PLAN                       |
| M-78              | M-78 MECH. PLAN                       |
| M-79              | M-79 MECH. PLAN                       |
| M-80              | M-80 MECH. PLAN                       |
| M-81              | M-81 MECH. PLAN                       |
| M-82              | M-82 MECH. PLAN                       |
| M-83              | M-83 MECH. PLAN                       |
| M-84              | M-84 MECH. PLAN                       |
| M-85              | M-85 MECH. PLAN                       |
| M-86              | M-86 MECH. PLAN                       |
| M-87              | M-87 MECH. PLAN                       |
| M-88              | M-88 MECH. PLAN                       |
| M-89              | M-89 MECH. PLAN                       |
| M-90              | M-90 MECH. PLAN                       |
| M-91              | M-91 MECH. PLAN                       |
| M-92              | M-92 MECH. PLAN                       |
| M-93              | M-93 MECH. PLAN                       |
| M-94              | M-94 MECH. PLAN                       |
| M-95              | M-95 MECH. PLAN                       |
| M-96              | M-96 MECH. PLAN                       |
| M-97              | M-97 MECH. PLAN                       |
| M-98              | M-98 MECH. PLAN                       |
| M-99              | M-99 MECH. PLAN                       |
| M-100             | M-100 MECH. PLAN                      |
| <b>ELECTRICAL</b> |                                       |
| E-1               | ELECTRICAL PLAN - E-1                 |
| E-2               | ELECTRICAL PLAN - E-2                 |
| E-3               | ELECTRICAL PLAN - E-3                 |
| E-4               | ELECTRICAL PLAN - E-4                 |
| E-5               | ELECTRICAL PLAN - E-5                 |
| E-6               | ELECTRICAL PLAN - E-6                 |
| E-7               | ELECTRICAL PLAN - E-7                 |
| E-8               | ELECTRICAL PLAN - E-8                 |
| E-9               | ELECTRICAL PLAN - E-9                 |
| E-10              | ELECTRICAL PLAN - E-10                |
| E-11              | ELECTRICAL PLAN - E-11                |
| E-12              | ELECTRICAL PLAN - E-12                |
| E-13              | ELECTRICAL PLAN - E-13                |
| E-14              | ELECTRICAL PLAN - E-14                |
| E-15              | ELECTRICAL PLAN - E-15                |
| E-16              | ELECTRICAL PLAN - E-16                |
| E-17              | ELECTRICAL PLAN - E-17                |
| E-18              | ELECTRICAL PLAN - E-18                |
| E-19              | ELECTRICAL PLAN - E-19                |
| E-20              | ELECTRICAL PLAN - E-20                |
| E-21              | ELECTRICAL PLAN - E-21                |
| E-22              | ELECTRICAL PLAN - E-22                |
| E-23              | ELECTRICAL PLAN - E-23                |
| E-24              | ELECTRICAL PLAN - E-24                |
| E-25              | ELECTRICAL PLAN - E-25                |
| E-26              | ELECTRICAL PLAN - E-26                |
| E-27              | ELECTRICAL PLAN - E-27                |
| E-28              | ELECTRICAL PLAN - E-28                |
| E-29              | ELECTRICAL PLAN - E-29                |
| E-30              | ELECTRICAL PLAN - E-30                |
| E-31              | ELECTRICAL PLAN - E-31                |
| E-32              | ELECTRICAL PLAN - E-32                |
| E-33              | ELECTRICAL PLAN - E-33                |
| E-34              | ELECTRICAL PLAN - E-34                |
| E-35              | ELECTRICAL PLAN - E-35                |
| E-36              | ELECTRICAL PLAN - E-36                |
| E-37              | ELECTRICAL PLAN - E-37                |
| E-38              | ELECTRICAL PLAN - E-38                |
| E-39              | ELECTRICAL PLAN - E-39                |
| E-40              | ELECTRICAL PLAN - E-40                |
| E-41              | ELECTRICAL PLAN - E-41                |
| E-42              | ELECTRICAL PLAN - E-42                |
| E-43              | ELECTRICAL PLAN - E-43                |
| E-44              | ELECTRICAL PLAN - E-44                |
| E-45              | ELECTRICAL PLAN - E-45                |
| E-46              | ELECTRICAL PLAN - E-46                |
| E-47              | ELECTRICAL PLAN - E-47                |
| E-48              | ELECTRICAL PLAN - E-48                |
| E-49              | ELECTRICAL PLAN - E-49                |
| E-50              | ELECTRICAL PLAN - E-50                |
| E-51              | ELECTRICAL PLAN - E-51                |
| E-52              | ELECTRICAL PLAN - E-52                |
| E-53              | ELECTRICAL PLAN - E-53                |
| E-54              | ELECTRICAL PLAN - E-54                |
| E-55              | ELECTRICAL PLAN - E-55                |
| E-56              | ELECTRICAL PLAN - E-56                |
| E-57              | ELECTRICAL PLAN - E-57                |
| E-58              | ELECTRICAL PLAN - E-58                |
| E-59              | ELECTRICAL PLAN - E-59                |
| E-60              | ELECTRICAL PLAN - E-60                |
| E-61              | ELECTRICAL PLAN - E-61                |
| E-62              | ELECTRICAL PLAN - E-62                |
| E-63              | ELECTRICAL PLAN - E-63                |
| E-64              | ELECTRICAL PLAN - E-64                |
| E-65              | ELECTRICAL PLAN - E-65                |
| E-66              | ELECTRICAL PLAN - E-66                |
| E-67              | ELECTRICAL PLAN - E-67                |
| E-68              | ELECTRICAL PLAN - E-68                |
| E-69              | ELECTRICAL PLAN - E-69                |
| E-70              | ELECTRICAL PLAN - E-70                |
| E-71              | ELECTRICAL PLAN - E-71                |
| E-72              | ELECTRICAL PLAN - E-72                |
| E-73              | ELECTRICAL PLAN - E-73                |
| E-74              | ELECTRICAL PLAN - E-74                |
| E-75              | ELECTRICAL PLAN - E-75                |
| E-76              | ELECTRICAL PLAN - E-76                |
| E-77              | ELECTRICAL PLAN - E-77                |
| E-78              | ELECTRICAL PLAN - E-78                |
| E-79              | ELECTRICAL PLAN - E-79                |
| E-80              | ELECTRICAL PLAN - E-80                |
| E-81              | ELECTRICAL PLAN - E-81                |
| E-82              | ELECTRICAL PLAN - E-82                |
| E-83              | ELECTRICAL PLAN - E-83                |
| E-84              | ELECTRICAL PLAN - E-84                |
| E-85              | ELECTRICAL PLAN - E-85                |
| E-86              | ELECTRICAL PLAN - E-86                |
| E-87              | ELECTRICAL PLAN - E-87                |
| E-88              | ELECTRICAL PLAN - E-88                |
| E-89              | ELECTRICAL PLAN - E-89                |
| E-90              | ELECTRICAL PLAN - E-90                |
| E-91              | ELECTRICAL PLAN - E-91                |
| E-92              | ELECTRICAL PLAN - E-92                |
| E-93              | ELECTRICAL PLAN - E-93                |
| E-94              | ELECTRICAL PLAN - E-94                |
| E-95              | ELECTRICAL PLAN - E-95                |
| E-96              | ELECTRICAL PLAN - E-96                |
| E-97              | ELECTRICAL PLAN - E-97                |
| E-98              | ELECTRICAL PLAN - E-98                |
| E-99              | ELECTRICAL PLAN - E-99                |
| E-100             | ELECTRICAL PLAN - E-100               |

**LEGENDS**

| REFERENCE | DESCRIPTION                      |
|-----------|----------------------------------|
| 1         | SECTION NO. BUILDING SECTION     |
| 2         | SECTION NO. WALL SECTION         |
| 3         | SECTION NO. PARTIAL BLDG SECTION |
| 4         | SCHEDULE NO. DOOR REFERENCE      |
| 5         | WALL NUMBER REFERENCE            |
| 6         | WALL NUMBER REFERENCE            |
| 7         | WALL NUMBER REFERENCE            |
| 8         | WALL NUMBER REFERENCE            |
| 9         | WALL NUMBER REFERENCE            |
| 10        | WALL NUMBER REFERENCE            |
| 11        | WALL NUMBER REFERENCE            |
| 12        | WALL NUMBER REFERENCE            |
| 13        | WALL NUMBER REFERENCE            |
| 14        | WALL NUMBER REFERENCE            |
| 15        | WALL NUMBER REFERENCE            |
| 16        | WALL NUMBER REFERENCE            |
| 17        | WALL NUMBER REFERENCE            |
| 18        | WALL NUMBER REFERENCE            |
| 19        | WALL NUMBER REFERENCE            |
| 20        | WALL NUMBER REFERENCE            |
| 21        | WALL NUMBER REFERENCE            |
| 22        | WALL NUMBER REFERENCE            |
| 23        | WALL NUMBER REFERENCE            |
| 24        | WALL NUMBER REFERENCE            |
| 25        | WALL NUMBER REFERENCE            |
| 26        | WALL NUMBER REFERENCE            |
| 27        | WALL NUMBER REFERENCE            |
| 28        | WALL NUMBER REFERENCE            |
| 29        | WALL NUMBER REFERENCE            |
| 30        | WALL NUMBER REFERENCE            |
| 31        | WALL NUMBER REFERENCE            |
| 32        | WALL NUMBER REFERENCE            |
| 33        | WALL NUMBER REFERENCE            |
| 34        | WALL NUMBER REFERENCE            |
| 35        | WALL NUMBER REFERENCE            |
| 36        | WALL NUMBER REFERENCE            |
| 37        | WALL NUMBER REFERENCE            |
| 38        | WALL NUMBER REFERENCE            |
| 39        | WALL NUMBER REFERENCE            |
| 40        | WALL NUMBER REFERENCE            |
| 41        | WALL NUMBER REFERENCE            |
| 42        | WALL NUMBER REFERENCE            |
| 43        | WALL NUMBER REFERENCE            |
| 44        | WALL NUMBER REFERENCE            |
| 45        | WALL NUMBER REFERENCE            |
| 46        | WALL NUMBER REFERENCE            |
| 47        | WALL NUMBER REFERENCE            |
| 48        | WALL NUMBER REFERENCE            |
| 49        | WALL NUMBER REFERENCE            |
| 50        | WALL NUMBER REFERENCE            |
| 51        | WALL NUMBER REFERENCE            |
| 52        | WALL NUMBER REFERENCE            |
| 53        | WALL NUMBER REFERENCE            |
| 54        | WALL NUMBER REFERENCE            |
| 55        | WALL NUMBER REFERENCE            |
| 56        | WALL NUMBER REFERENCE            |
| 57        | WALL NUMBER REFERENCE            |
| 58        | WALL NUMBER REFERENCE            |
| 59        | WALL NUMBER REFERENCE            |
| 60        | WALL NUMBER REFERENCE            |
| 61        | WALL NUMBER REFERENCE            |
| 62        | WALL NUMBER REFERENCE            |
| 63        | WALL NUMBER REFERENCE            |
| 64        | WALL NUMBER REFERENCE            |
| 65        | WALL NUMBER REFERENCE            |
| 66        | WALL NUMBER REFERENCE            |
| 67        | WALL NUMBER REFERENCE            |
| 68        | WALL NUMBER REFERENCE            |
| 69        | WALL NUMBER REFERENCE            |
| 70        | WALL NUMBER REFERENCE            |
| 71        | WALL NUMBER REFERENCE            |
| 72        | WALL NUMBER REFERENCE            |
| 73        | WALL NUMBER REFERENCE            |
| 74        | WALL NUMBER REFERENCE            |
| 75        | WALL NUMBER REFERENCE            |
| 76        | WALL NUMBER REFERENCE            |
| 77        | WALL NUMBER REFERENCE            |
| 78        | WALL NUMBER REFERENCE            |
| 79        | WALL NUMBER REFERENCE            |
| 80        | WALL NUMBER REFERENCE            |
| 81        | WALL NUMBER REFERENCE            |
| 82        | WALL NUMBER REFERENCE            |
| 83        | WALL NUMBER REFERENCE            |
| 84        | WALL NUMBER REFERENCE            |
| 85        | WALL NUMBER REFERENCE            |
| 86        | WALL NUMBER REFERENCE            |
| 87        | WALL NUMBER REFERENCE            |
| 88        | WALL NUMBER REFERENCE            |
| 89        | WALL NUMBER REFERENCE            |
| 90        | WALL NUMBER REFERENCE            |
| 91        | WALL NUMBER REFERENCE            |
| 92        | WALL NUMBER REFERENCE            |
| 93        | WALL NUMBER REFERENCE            |
| 94        | WALL NUMBER REFERENCE            |
| 95        | WALL NUMBER REFERENCE            |
| 96        | WALL NUMBER REFERENCE            |
| 97        | WALL NUMBER REFERENCE            |
| 98        | WALL NUMBER REFERENCE            |
| 99        | WALL NUMBER REFERENCE            |
| 100       | WALL NUMBER REFERENCE            |

**NEW SITE PLAN** 1"=40'-0"  
 GRADES TO FALL UNIFORMLY & RADIIALLY FROM 118.0 HIGH POINT (N. END PARKING).  
 EXISTING TREE LOCATIONS TO BE VERIFIED. TRIM AS REQ'D FOR OPERATIONS.  
 BUSH LOCATIONS & SHAPES ARE APPROXIMATE.

**BLDG. MATLS.**

|          |                     |
|----------|---------------------|
| [Symbol] | CONC. MASS UNITS    |
| [Symbol] | FACE BRICK          |
| [Symbol] | PC-FACED            |
| [Symbol] | CAST CONC.          |
| [Symbol] | MTL. STD. PARTITION |
| [Symbol] | STY. BR.            |
| [Symbol] | STYL.               |
| [Symbol] | ALUMINUM            |
| [Symbol] | ROOF INSUL.         |
| [Symbol] | STY. WEL.           |
| [Symbol] | PLYWOOD             |
| [Symbol] | TOUGH FRAMES        |