

BZA 12-70

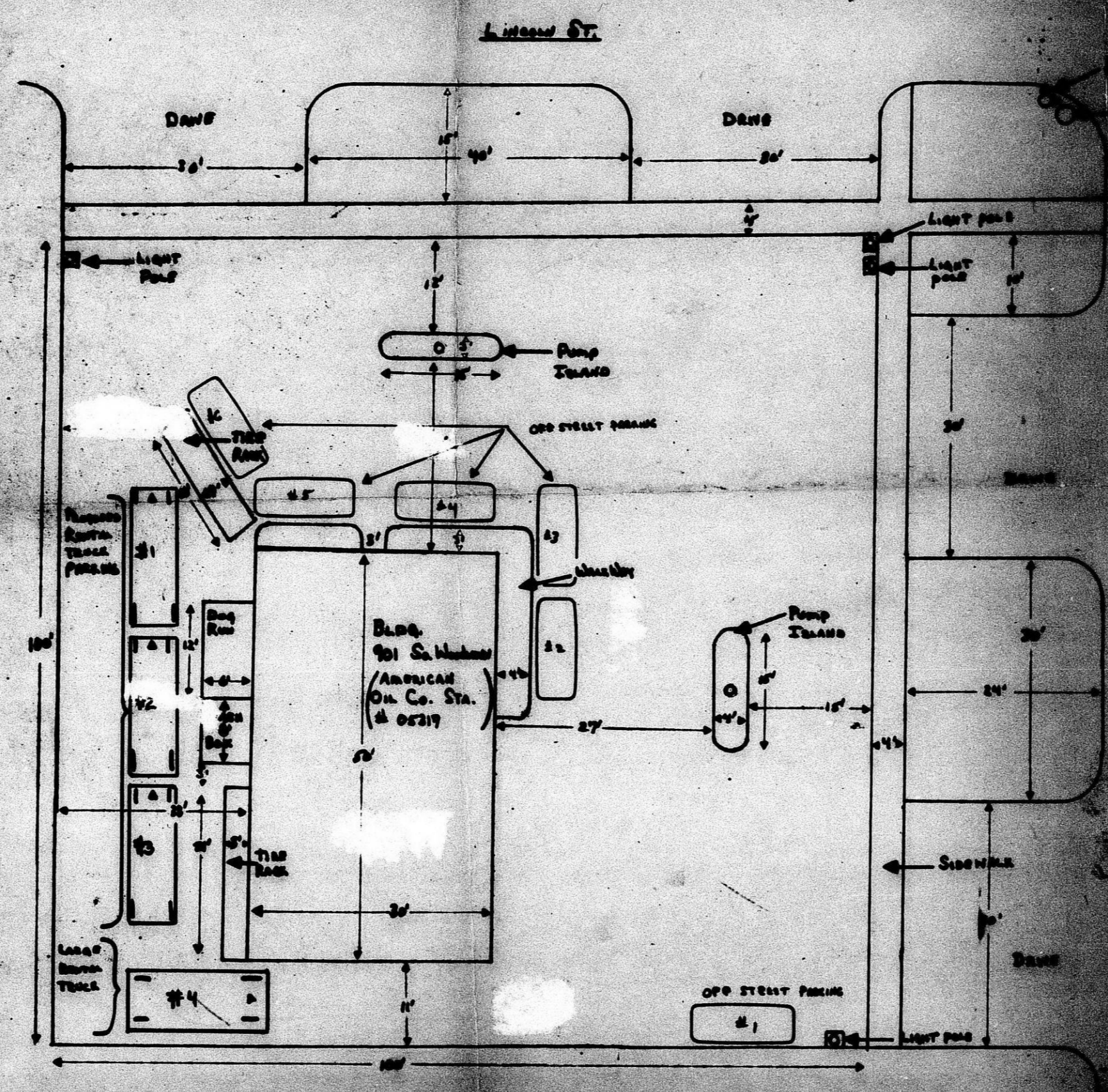

Drawn to Scale  
1" = 10'

Sgt. M.W. Claypool WARD  
4-7-70



TRAFFIC ENGINEERING DIVISION APPROVED  
 Date: 4-7-70  
 (A) Parking barriers shall be installed at all "lockdown" that are adjacent to public property so that vehicles will not obstruct public property and have a minimum length of 6 feet and a minimum cross section of 18 inches.  
 (B) Stalls shall be marked with 4" x 6" white paint.  
 (C) Proper cones and signs shall be installed on street property at the entrance and exit of the parking facility.

Subject to BZA Approval

APPROVED  
 CENTRAL INSPECTION DIVISION  
 CITY OF WACHTA  
 APR 22 1970

BZA 12-70

FILMED FROM THE BEST AVAILABLE COPY