

FILMED FROM THE BEST AVAILABLE COPY

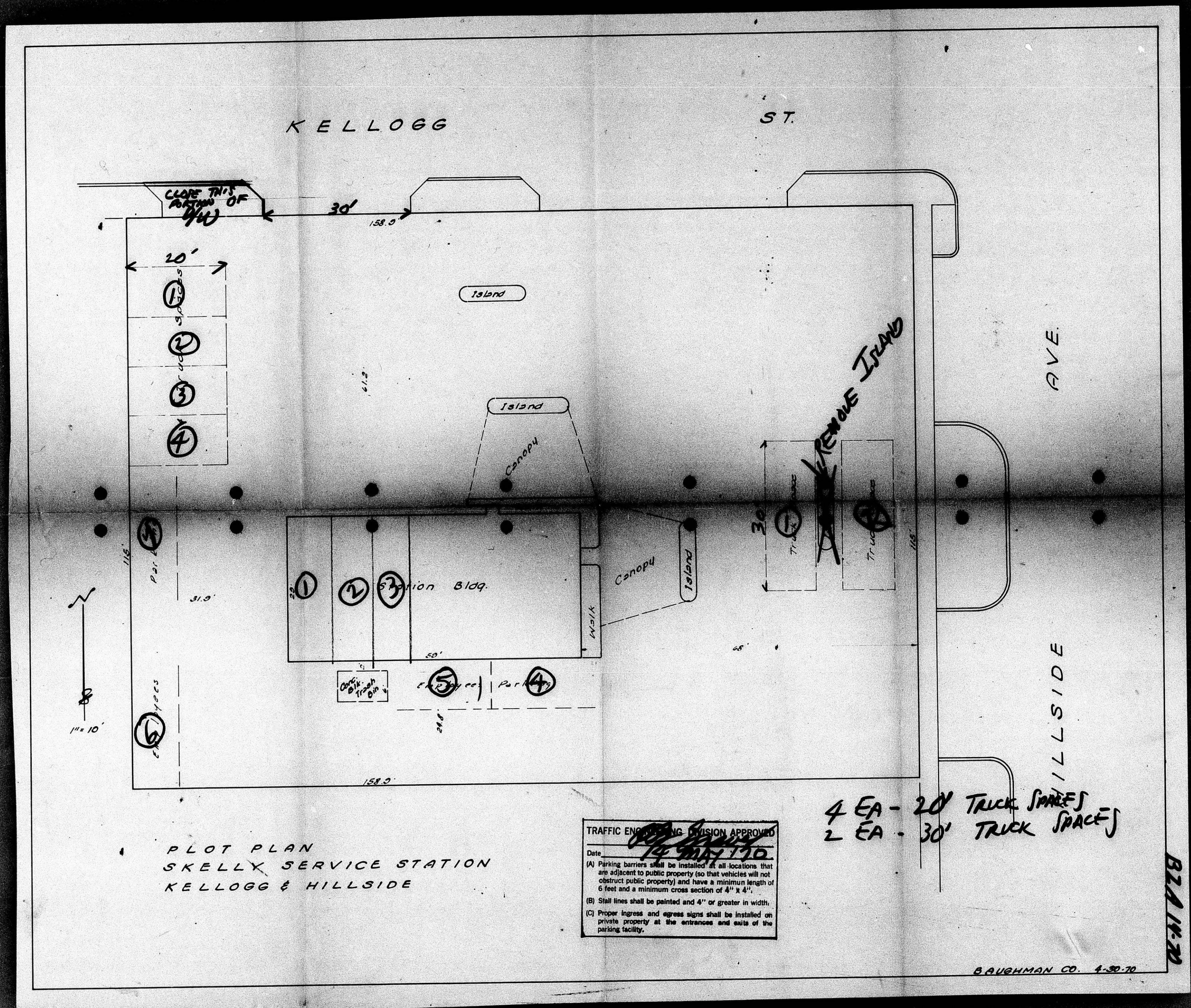

PLOT PLAN  
SKELLY SERVICE STATION  
KELLOGG & HILLSIDE

TRAFFIC ENGINEERING DIVISION APPROVED  
 Date: 12/21/70  
 (A) Parking barriers shall be installed at all locations that are adjacent to public property (so that vehicles will not obstruct public property) and have a minimum length of 6 feet and a minimum cross section of 4" x 4".  
 (B) Stall lines shall be painted and 4" or greater in width.  
 (C) Proper ingress and egress signs shall be installed on private property at the entrances and exits of the parking facility.

4 EA - 20' TRUCK SPACES  
 2 EA - 30' TRUCK SPACES

BAUGHMAN CO. 4-30-70

BZ/1/70

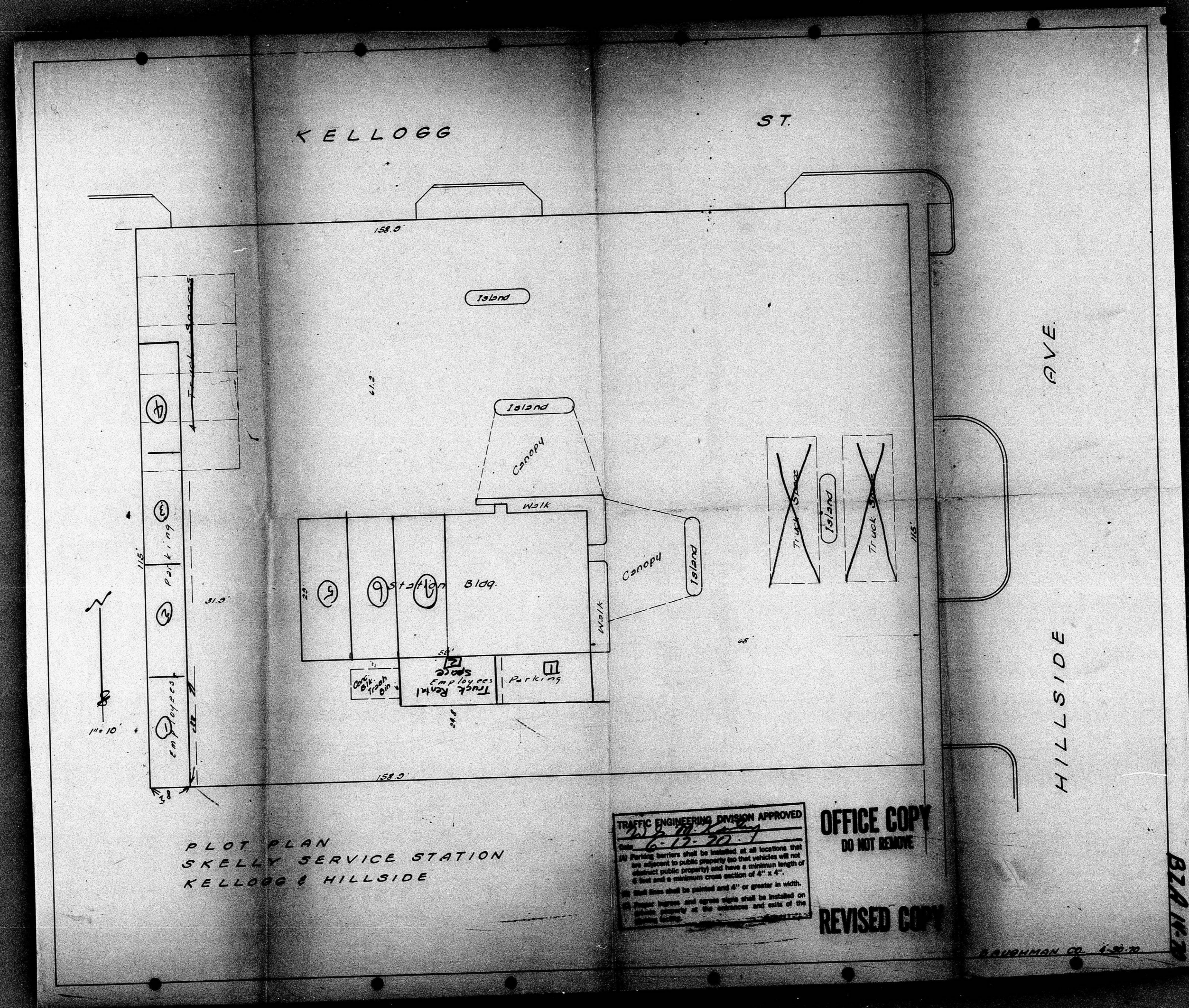

PLOT PLAN  
SKELLY SERVICE STATION  
KELLOGG & HILLSIDE

TRAFFIC ENGINEERING DIVISION APPROVED  
 6-12-57  
 1. Warning barriers shall be installed at all locations that are adjacent to public property (so that vehicles will not obstruct public property) and have a minimum length of 6 feet and a minimum cross section of 4" x 4".  
 2. Walk lines shall be painted and 4" or greater in width.  
 3. Stop, ahead, and cross signs shall be installed on public property at the entrance and exit of the service station.

OFFICE COPY  
DO NOT REMOVE

REVISED COPY

BAUGHMAN CO. 1-2-57

BZ-1-1-57