

LOCATION: 8330 E KELLOGG

BZA 14-75

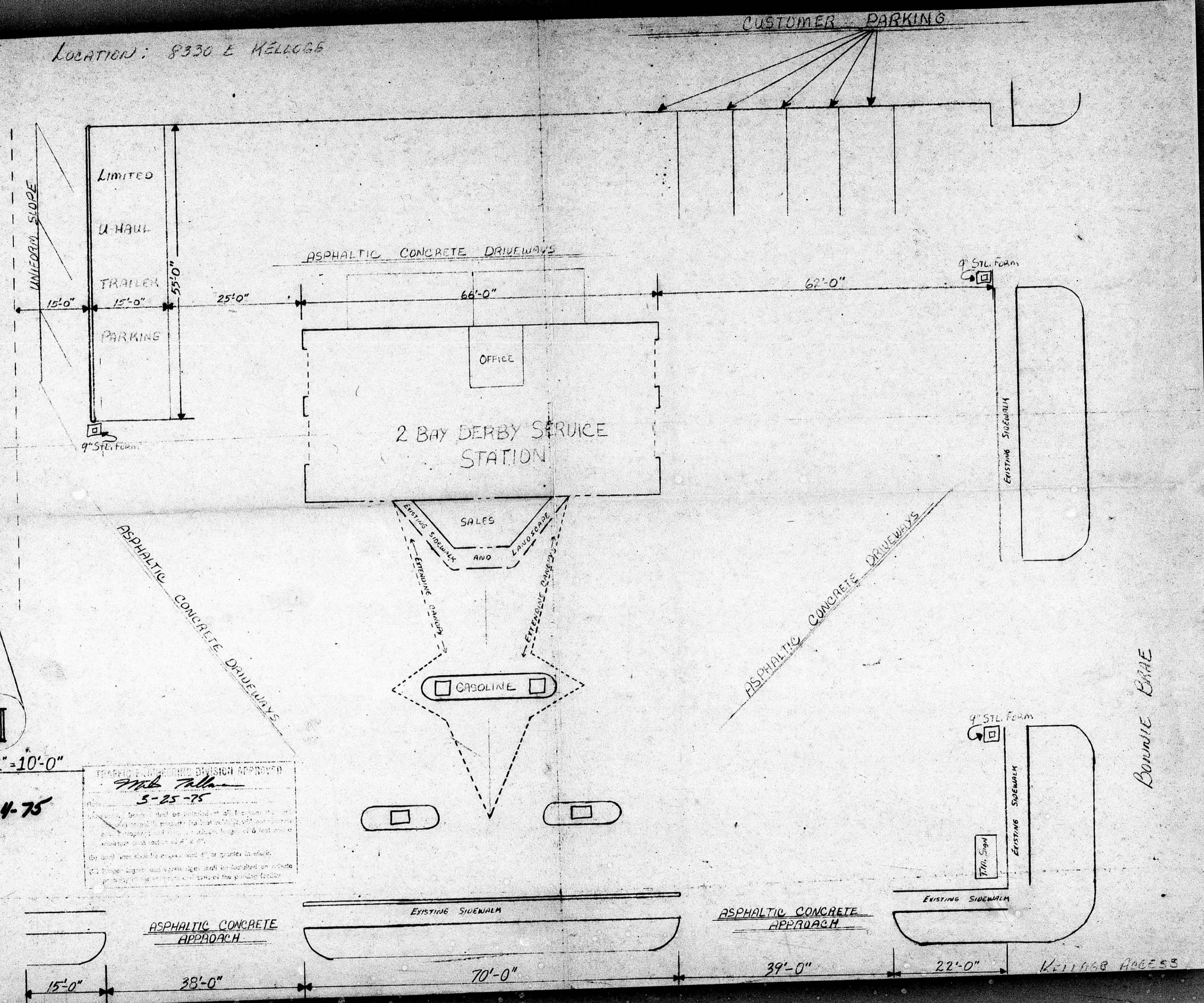

SCALE: 1"=10'-0"

BZA 14-75

PERMIT TO CONSTRUCT GRASS APPROVED

7/16/75

5-25-75

1. This permit is valid for the construction of the project as shown on the approved plans. Any change in the project must be approved by the City Engineer before construction begins.

2. The permit holder shall be responsible for obtaining all necessary permits from other agencies and for complying with all applicable laws, codes, and ordinances.

3. The permit holder shall be responsible for maintaining access to all adjacent properties at all times.

BLANK FROM THE

LOCATION: 8330 E HELLOGG

BZA 14-75

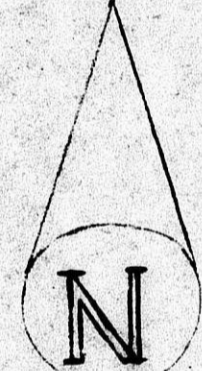
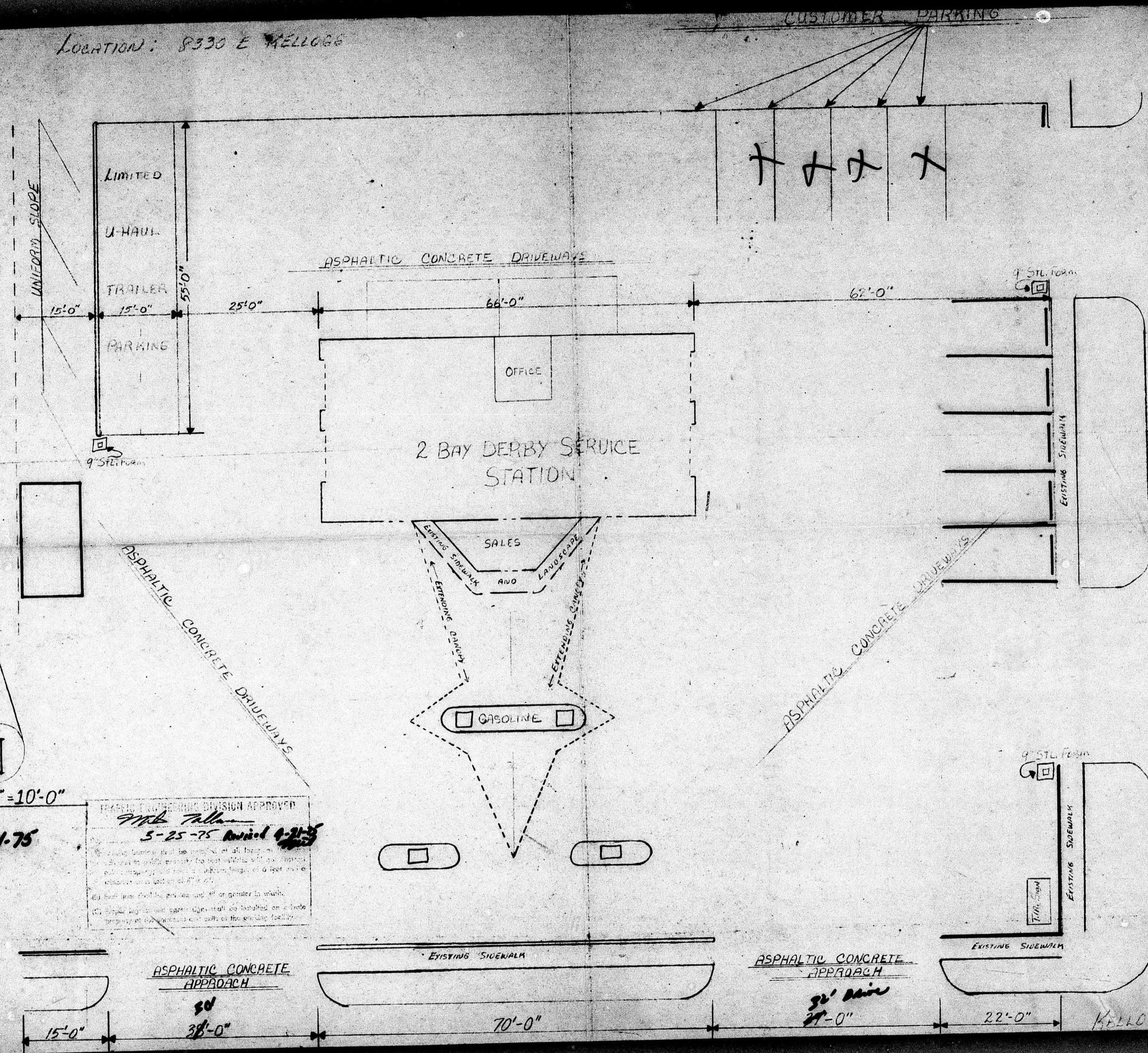

SCALE: 1" = 10'-0"
 BZA 14-75

PLANNING DIVISION APPROVED
 5-25-75
 5-25-75

BOUNCE DRIVE



LOCATION: 8330 E HELLOGA

BZA 14-75

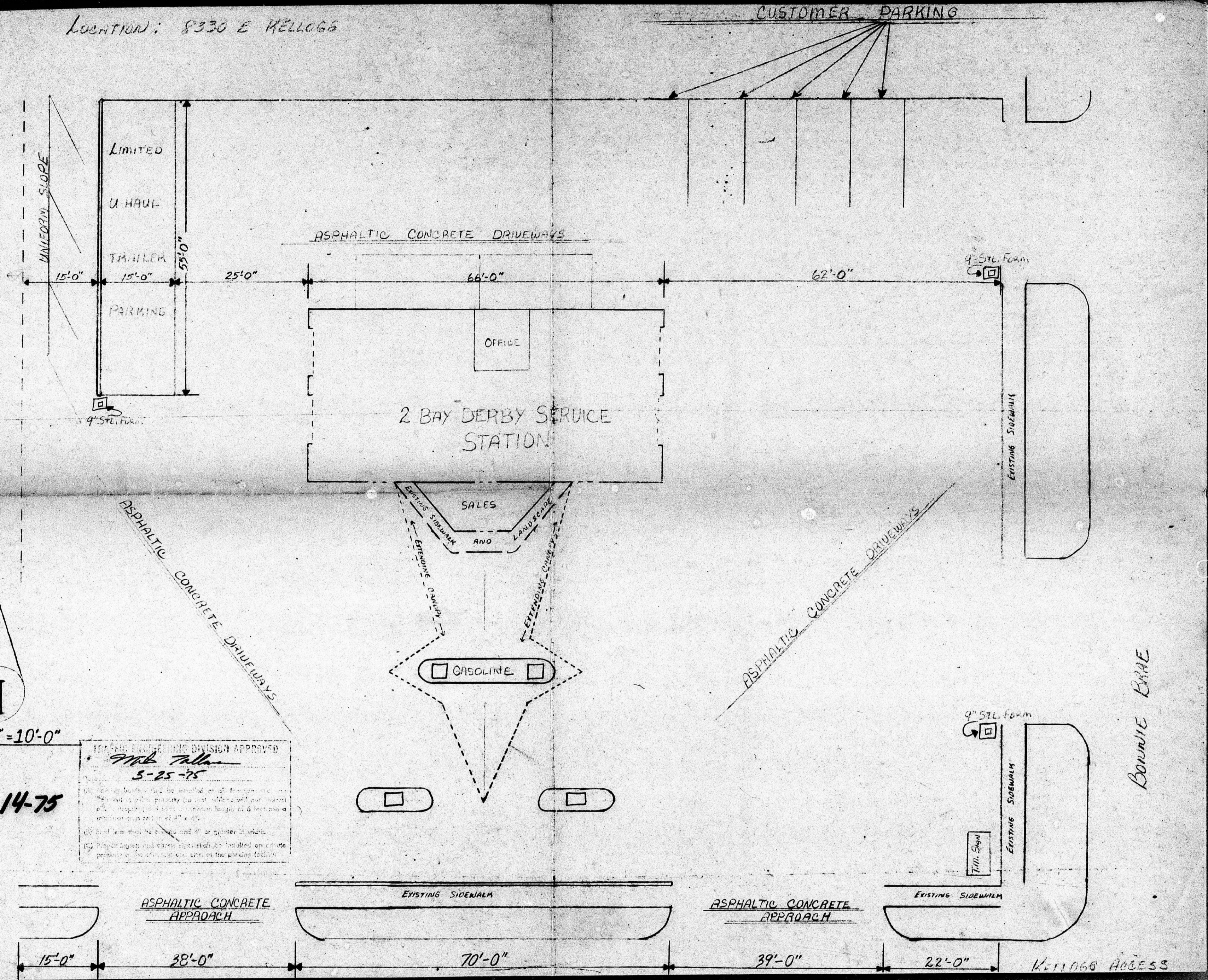

SCALE: 1"=10'-0"

BZA 14-75

PERMITS DIVISION APPROVED
 5-25-75

MADE FROM THE
 ORIGINAL PLAN