

SENECA SQUARE C.U.P. AMENDED

DP-16

E 1/4 Cor. Sec. G
Found iron in thimble

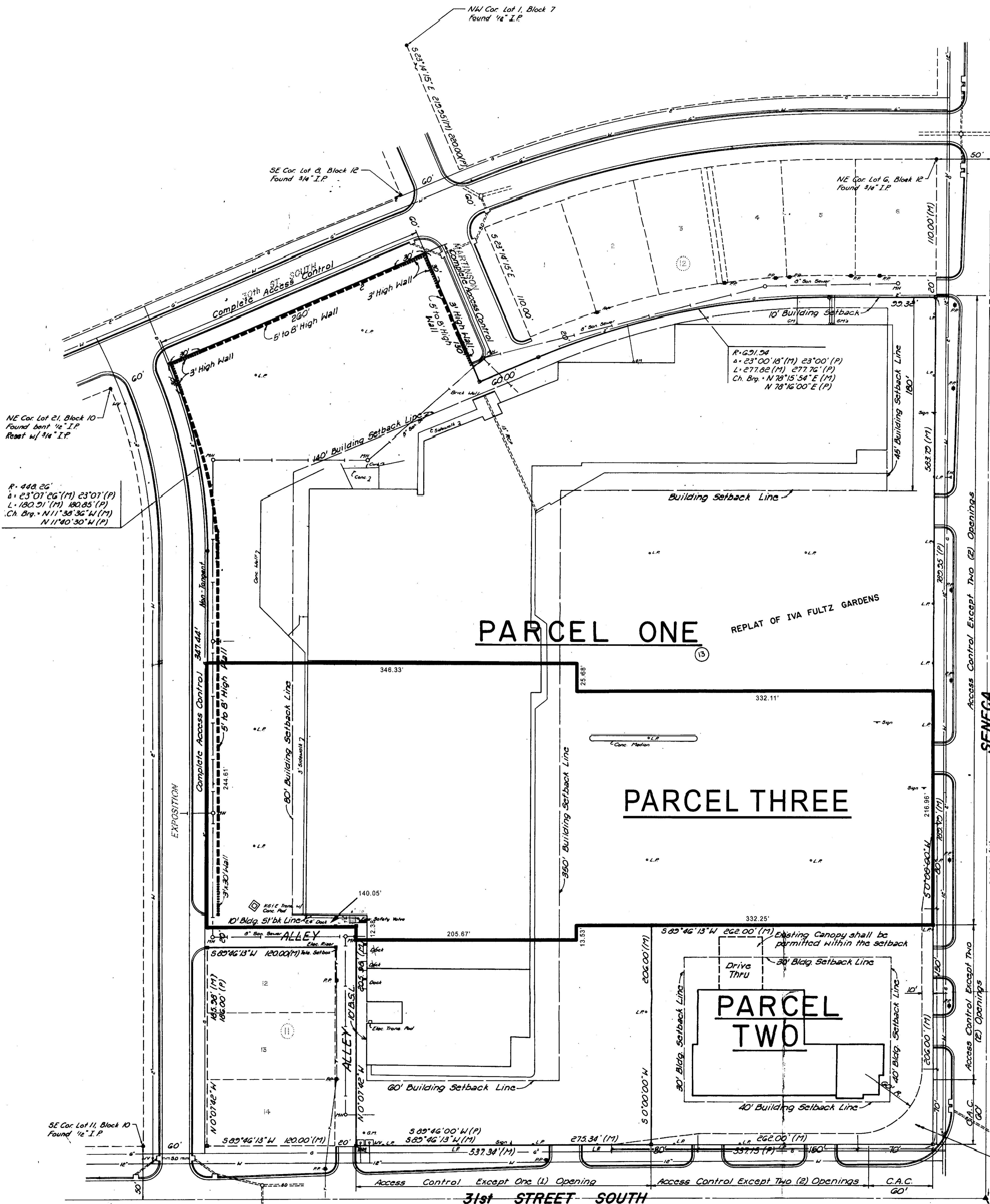

GENERAL PROVISIONS

TOTAL NET AREA: 11.5 ACRES

1. ACCESS CONTROL: ACCESS CONTROL SHALL BE AS NOTED ON THE PLAN.
2. ALL UTILITIES SHALL BE INSTALLED UNDERGROUND.
3. MINIMUM BUILDING SETBACKS SHALL BE AS NOTED ON THE PLAN; EXCEPT ONE (1) ENCLOSED LOADING DOCK MAY BE PERMITTED WITHIN THE BUILDING SETBACK ALONG THE WEST LINE OF PARCELS ONE AND THREE ADJACENT TO EXPOSITION STREET PROVIDED, HOWEVER, SAID LOADING DOCK WILL NOT BE PERMITTED CLOSER THAN 45 FEET TO EXPOSITION STREET. THE EXISTING CANOPY IN PARCEL TWO SHALL BE PERMITTED WITHIN THE BUILDING SETBACK AS SHOWN.
4. PARKING RATIO SHALL BE IN ACCORDANCE WITH SECTION 28.04.140 OF THE CODE OF THE CITY OF WICHITA. (SEE ADMINISTRATIVE ADJUSTMENT DATED 02/25/04)
5. ADVERTISING SIGNS SHALL BE IN ACCORDANCE WITH SECTION 28.04.139 OF THE CODE OF THE CITY OF WICHITA. NO BILLBOARD ADVERTISEMENT SHALL BE ALLOWED.
6. SCREENING: A SOLID OR SEMI-SOLID WALL AT LEAST FIVE (5) FEET, BUT NOT MORE THAN EIGHT (8) FEET HIGH, CONSTRUCTED OF BRICK, STONE, MASONRY, ARCHITECTURAL TILE OR OTHER SIMILAR MATERIAL SHALL BE CONSTRUCTED IN PARCELS ONE AND THREE ALONG THE EAST LINE OF EXPOSITION STREET, THE SOUTH LINE OF 30TH STREET SOUTH, AND THE WEST LINE OF MARTINSON STREET AS INDICATED ON THE PLAN. SAID WALL WILL BE REDUCED TO THREE (3) FEET IN HEIGHT, FOR SITE DISTANCE, AT THOSE LOCATIONS INDICATED ON THE PLAN.

SAID WALL SHALL BE CONSTRUCTED PRIOR TO OR AT THE TIME OF CONSTRUCTION OF THE LOADING DOCK OR ANY OTHER ALTERATIONS TO THE WEST SIDE OF THE SHOPPING CENTER BUILDING WHICH ADD TO THE REAR OR SERVICE NATURE OF THE BUILDING.
7. APPROPRIATE STREET TREES (AS APPROVED BY THE CITY FORESTER) SHALL BE PLANTED NO FARTHER APART THAN 50 FEET ON CENTER IN THE PUBLIC PARKING AREA BETWEEN THE CURB AND PROPERTY LINE ADJACENT TO THE PROPOSED WALL, AND SHALL BE MAINTAINED BY THE OWNERS OF PARCELS ONE AND THREE.
8. A FINANCIAL GUARANTEE FOR THE REQUIRED WALL AND STREET TREES SHALL BE MADE PRIOR TO THE ISSUANCE OF ANY OCCUPANCY PERMIT IF THEY HAVE NOT BEEN INSTALLED.

PARCEL DESCRIPTIONS

- PARCEL ONE:**
 PROPOSED USE: SHOPPING CENTER AND RELATED USES.
 NET AREA: 286,230 SQUARE FEET (6.57 ACRES).
 MAXIMUM BUILDING COVERAGE: 35% OR 100,180 SQUARE FEET.
 MAXIMUM GROSS FLOOR AREA: 40% OR 114,490 SQUARE FEET.
 MAXIMUM BUILDING HEIGHT: 35 FEET.
 MAXIMUM NUMBER OF BUILDINGS: ONE (1)
- PARCEL TWO:**
 PROPOSED USE: FINANCIAL, OFFICE, PERSONAL SERVICES AND RETAIL SALES AS PERMITTED BY THE ZONING DISTRICT.
 NET AREA: 53,972 SQUARE FEET (1.24 ACRES).
 MAXIMUM BUILDING COVERAGE: 30% OR 16,200 SQUARE FEET.
 MAXIMUM GROSS FLOOR AREA: 35% OR 18,900 SQUARE FEET.
 MAXIMUM BUILDING HEIGHT: 35 FEET.
 MAXIMUM NUMBER OF BUILDINGS: ONE (1)
- PARCEL THREE:**
 PROPOSED USE: SHOPPING CENTER AND RELATED USES.
 NET AREA: 159,036 SQUARE FEET (3.65 ACRES).
 MAXIMUM BUILDING COVERAGE: 35% OR 55,660 SQUARE FEET.
 MAXIMUM GROSS FLOOR AREA: 40% OR 63,610 SQUARE FEET.
 MAXIMUM BUILDING HEIGHT: 35 FEET.
 MAXIMUM NUMBER OF BUILDINGS: ONE (1)

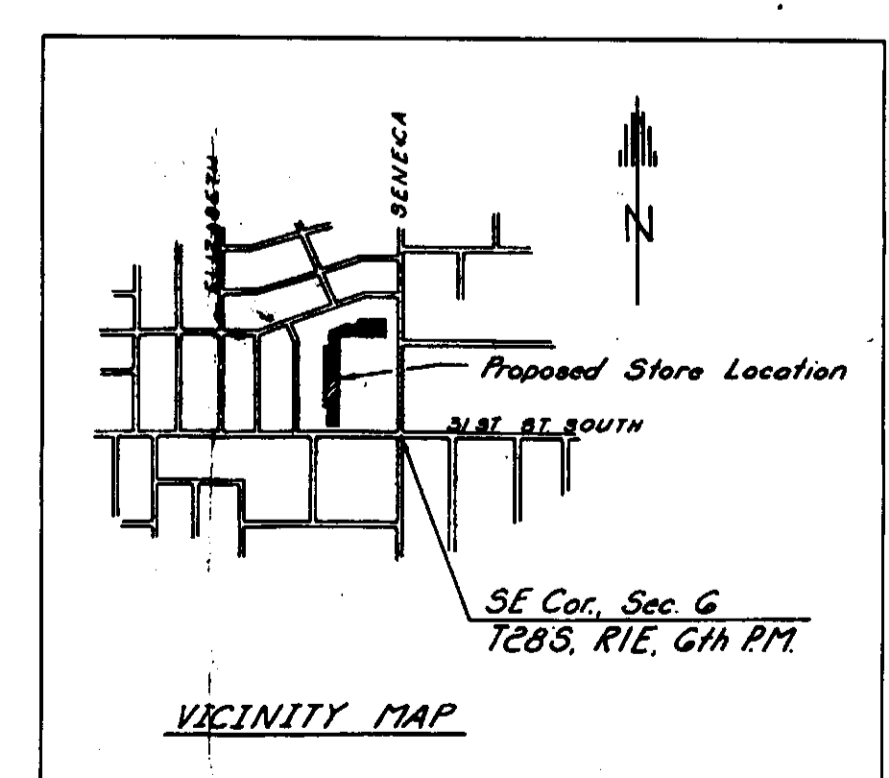

Scale: 1" = 40'

Contingent Dedication to become effective 2-28-1995.

DP-16
 Per AA 02-25-04, 11-30-10
APPROVED CUP
 MAPC 06-28-84 DM
 BCC 07-24-84 DM
 MAPD Copy 1 of 2

DP-16

SENECA SQUARE C.U.P.

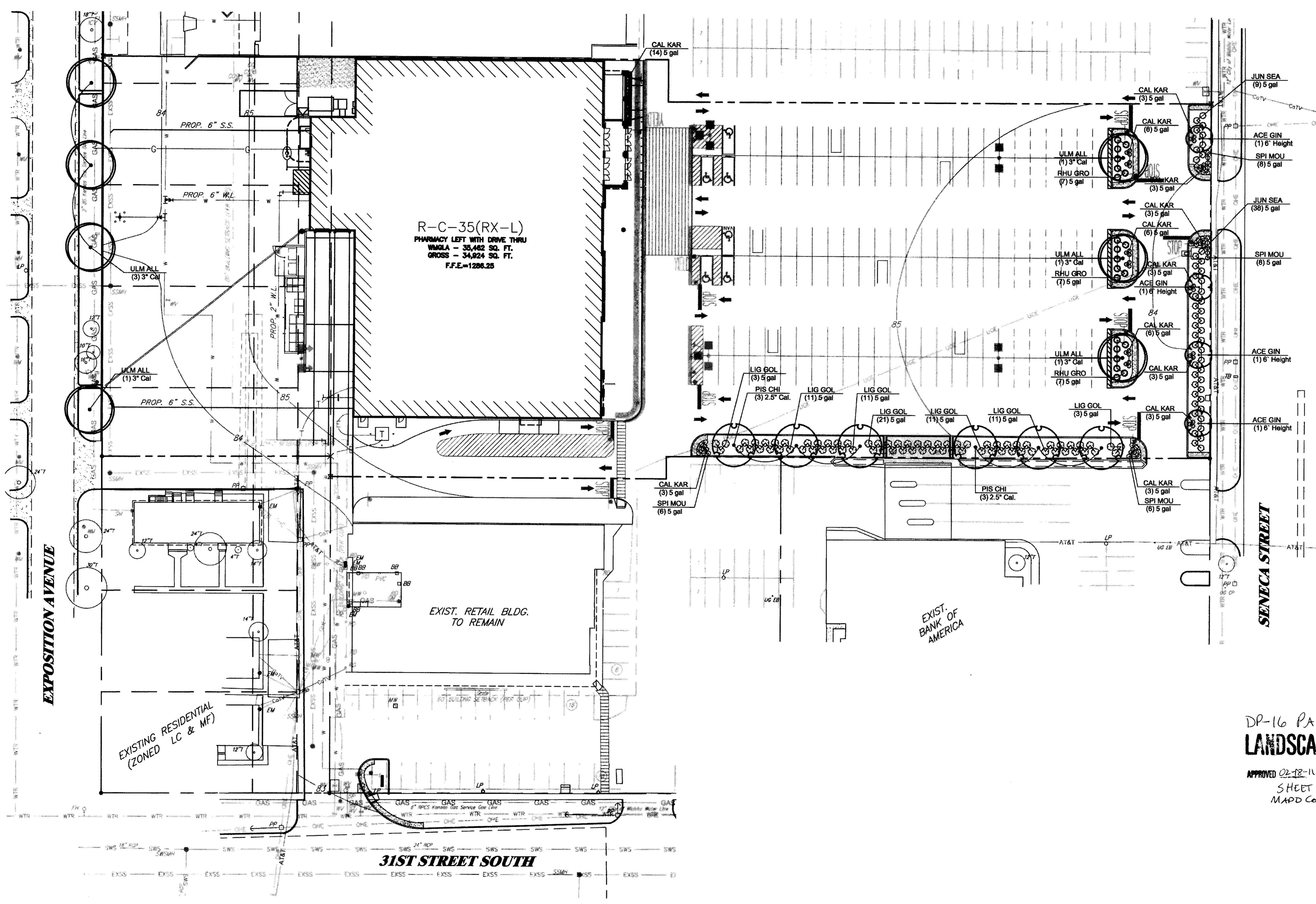

R-C-35(RX-L)
 PHARMACY LEFT WITH DRIVE THRU
 WINGLA - 35,462 SQ. FT.
 GROSS - 34,924 SQ. FT.
 F.F.E.=1286.25

EXIST. RETAIL BLDG.
 TO REMAIN

EXISTING RESIDENTIAL
 (ZONED LC & MF)

31ST STREET SOUTH

A LANDSCAPE PLANTING PLAN
 1"=30'-0"



LAW/KINGDON ARCHITECTURE
 ENGINEERING PLANNING INTERIORS LANDSCAPES
 500 W. 10TH ST. SUITE 200
 WICHITA, KS 67202
 Phone (617) 282-2220 Fax (617) 282-2225
 Copyright © 2008

STIPULATION FOR REUSE
 THIS DRAWING WAS PREPARED FOR A SPECIFIC PROJECT AND SITE. IT IS NOT TO BE REPRODUCED OR COPIED IN ANY MANNER WITHOUT THE WRITTEN CONSENT OF LAW/KINGDON ARCHITECTURE. ANY REUSE OF THIS DRAWING FOR ANY OTHER PROJECT WITHOUT THE WRITTEN CONSENT OF LAW/KINGDON ARCHITECTURE IS STRICTLY PROHIBITED AND WILL BE CONSIDERED AN INFRINGEMENT OF THE LAW.

CONSULTANTS

WALMART MARKET
 WICHITA, KS
 STORE NO. 5991-00
 JOB NUMBER: 4965.00 PROTO:

ISSUE BLOCK

CHECKED BY: JIB
 DRAWN BY: WAW
 FILE NAME:
 PROTO CYCLE:
 DOCUMENT DATE: 01-20-11

DP-16 PARCEL 3
LANDSCAPE PLAN

APPROVED 02-18-11 BY DS
 SHEET 1 of 3
 MAPP Copy 1 of 2

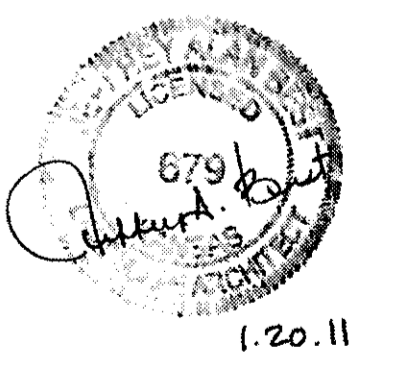

SHEET TITLE:
Landscape Planting Plan

SHEET:
LP1

PLANTING NOTES

GENERAL

- THE CONTRACTOR IS RESPONSIBLE FOR OBTAINING A COPY OF THE PROJECT SPECIFICATIONS PRIOR TO BIDDING. THE PROJECT SPECIFICATIONS ARE A PART OF THESE PLANS AND SHALL BE CONSULTED BY THE IRRIGATION CONTRACTOR. THE CONTRACTOR IS RESPONSIBLE FOR IMPLEMENTING WORK AS SPECIFIED IN THE PROJECT SPECIFICATIONS AND ON THE PLANS.
- PRIOR TO BEGINNING ANY WORK ON THE SITE, THE CONTRACTOR SHALL CONTACT THE OFFICE OF THE OWNER AND THE LANDSCAPE ARCHITECT FOR SPECIFIC INSTRUCTIONS RELEVANT TO THE SEQUENCING OF WORK.
- LANDSCAPE CONTRACTOR SHALL PROVIDE LABOR, MATERIALS AND SERVICE NECESSARY TO FURNISH AND INSTALL MATERIALS AS SPECIFIED HEREIN AND AS SHOWN ON THE PLANS.
- THE CONTRACTOR SHALL REFER TO SPECIFICATION SECTION 02900 FOR ADDITIONAL REQUIREMENTS AND RELATED TO PLANTING AND LANDSCAPING. THE CONTRACTOR WILL BE EXPECTED TO FOLLOW ALL THE REQUIREMENTS CALLED FOR IN THE SPECIFICATIONS. ANY DISCREPANCIES BETWEEN THE DRAWINGS AND SPECIFICATIONS SHALL BE BROUGHT TO THE ATTENTION OF THE LANDSCAPE ARCHITECT.
- QUANTITIES OF MATERIALS SHOWN ON THE PLANTING PLAN TAKE PRECEDENCE OVER QUANTITIES SHOWN ON THE PLANT MATERIAL SCHEDULE. LANDSCAPE CONTRACTOR SHALL BE RESPONSIBLE FOR VERIFYING ALL QUANTITIES ON THE PLAN.
- REPORT DISCREPANCIES IN THE PLANTING PLAN TO THE LANDSCAPE ARCHITECT, PRIOR TO PURCHASE OF MATERIALS OR STARTING CONSTRUCTION.
- NO MATERIAL SUBSTITUTIONS SHALL BE MADE WITHOUT LANDSCAPE ARCHITECT'S WRITTEN APPROVAL. ALTERNATE MATERIALS OF SIMILAR SIZE AND CHARACTER MAY BE CONSIDERED IF SPECIFIED PLANT MATERIALS CANNOT BE OBTAINED. LANDSCAPE ARCHITECT RESERVES THE RIGHT TO REVISE PLANT LIST AS DEEMED NECESSARY.
- PLANT SUBSTITUTIONS WILL ONLY BE ALLOWED UNDER THE FOLLOWING CONDITIONS: LANDSCAPE CONTRACTOR SHALL SUBMIT A WRITTEN SUBSTITUTION REQUEST TO THE LANDSCAPE ARCHITECT STATING WHAT PLANTS TO BE SUBSTITUTED AND THE REQUESTED SUBSTITUTION PLANT ALONG WITH EXPLANATION OF SUBSTITUTION REQUEST. NO SUBSTITUTION SHALL CONSTITUTE AN INCREASE IN COST FROM THE ORIGINAL CONTRACT AMOUNT. ANY PLANT SUBSTITUTIONS NOT APPROVED SHALL BE REPLACED BY THE LANDSCAPE CONTRACTOR AT THE TIME OF INSPECTION.
- ALL MATERIALS ARE SUBJECT TO THE APPROVAL OF THE LANDSCAPE ARCHITECT BEFORE, DURING AND AFTER INSTALLATION.
- PRIOR TO CONSTRUCTION, THE CONTRACTOR SHALL BE RESPONSIBLE FOR LOCATING ALL UNDERGROUND UTILITIES AND SHALL AVOID DAMAGE TO ALL UTILITIES DURING THE COURSE OF WORK. LOCATIONS OF EXISTING BURIED UTILITY LINES SHOWN ON THE PLANS ARE BASED UPON THE BEST AVAILABLE INFORMATION AND ARE TO BE CONSIDERED APPROXIMATE. IT SHALL BE THE RESPONSIBILITY OF THE CONTRACTOR 1) TO VERIFY THE LOCATIONS OF UTILITY LINES ADJACENT TO THE WORK AREA 2) TO PROTECT ALL UTILITY LINES DURING THE CONSTRUCTION PERIOD 3) TO REPAIR ANY AND ALL DAMAGE TO UTILITIES, STRUCTURES, SITE APPURTENANCES, ETC. WHICH OCCUR AS A RESULT OF CONSTRUCTION.

PLANTING PREPARATION

- ALL LANDSCAPED AREAS ARE TO RECEIVE A MINIMUM OF 4" OF TOPSOIL. TOPSOIL SHALL BE A FRIABLE LOAM WITH GOOD STRUCTURE. SOLUBLE SALTS SHALL NOT EXCEED 500ppm AND ORGANIC MATTER SHALL BE NO LESS THAN 3%. THE pH SHALL RANGE BETWEEN 5.5 AND 7.4.
- THE OWNER SHALL HAVE TOPSOIL TESTED BY A CERTIFIED TESTING LABORATORY AND OBTAIN RECOMMENDATIONS FOR SOIL AMENDMENT TYPE(S) AND QUANTITIES. RECOMMENDATIONS SHALL BE SPECIFIC TO THE TOPSOIL OF THIS REPORT TO THE LANDSCAPE ARCHITECT FOR THEIR RECORDS. THE LANDSCAPE CONTRACTOR SHALL BE EXPECTED TO AMEND SOILS PER THE RECOMMENDATIONS AND SPECIFICATIONS.
- BACKFILL: FOR PLANT EXCAVATIONS TO BE CLEAN NATURAL TOPSOIL MIXED WITH AMENDMENTS AT THE RATIOS SPECIFIED BY A CERTIFIED TOPSOIL ANALYSIS.
- PARKING LOT ISLANDS SHALL BE EXCAVATED TO A DEPTH OF 24" AND BACKFILLED WITH APPROVED TOPSOIL AND REQUIRED AMENDMENTS.
- RAISED PLANTERS SHALL BE EXCAVATED TO A MINIMUM 12" BELOW FINISH GRADE OF ADJACENT SIDEWALK, SUBDRAINAGE SYSTEM INSTALLED AND BACKFILLED WITH APPROVED PLANTING SOIL MIX.
- CONTRACTOR SHALL REFER TO SPECIFICATION SECTION 02900 FOR INSTRUCTIONS RELATED TO THE PRESENCE OF UNSUITABLE SUBSOILS AND TOPSOILS.

PLANTING MATERIALS

- REFER TO WALMART SPECIFICATIONS FOR INFORMATION NEEDED FOR IMPLEMENTATION OF PLANTING PLANS.
- PLANT MATERIAL SHALL BE WELL-FORMED AND DEVELOPED IN GOOD CONDITION, HEALTHY, VIGOROUS AND FREE OF PESTS AND DISEASE.
- PLANTS SHALL COMPLY IN ALL APPLICABLE RESPECTS WITH ACCEPTABLE STANDARDS AS SET FORTH IN THE AMERICAN ASSOCIATION OF NURSERYMAN'S "AMERICAN STANDARD OF NURSERY STOCK" THESE STANDARDS SHALL REPRESENT THE GUIDELINE SPECIFICATIONS ONLY AND SHALL CONSTITUTE THE MINIMUM QUALITY REQUIREMENTS FOR PLANT MATERIALS.
- ALL TREES SHALL HAVE STRAIGHT TRUNKS (FOR SINGLE STEM SPECIES) AND FULL CROWN AND MEET ALL REQUIREMENTS SPECIFIED. ALL TREES MUST BE GUYED OR STAKED AS SHOWN IN THE DETAILS.
- PLANT MATERIAL SELECTION: TREES SHALL BE TAGGED BY THE LANDSCAPE ARCHITECT AT THE TREE GROWER NURSERY PRIOR TO PURCHASE AND DELIVERY TO SITE FOR ALL OTHER PLANT MATERIAL SELECTIONS REFER TO SECTION 02900 OF THE SPECIFICATIONS FOR INSTRUCTIONS.
- AFTER BEING DUG AT THE NURSERY SOURCE, ALL TREES IN LEAF SHALL BE ACCLIMATED FOR TWO (2) WEEKS UNDER A MIST SYSTEM PRIOR TO INSTALLATION.
- PLANT LOCATIONS AND QUANTITIES SHOWN ARE APPROXIMATE. ADJUST PLANT LOCATIONS AS NECESSARY TO AVOID CONFLICTS. CONTRACTOR SHALL BE RESPONSIBLE FOR COMPLETE COVERAGE OF ALL PLANTING BEDS AT SPACING INDICATED ON THE PLANS.
- CONTRACTOR SHALL BE RESPONSIBLE FOR THE DELIVERY SCHEDULE AND PROTECTION BETWEEN DELIVERY AND PLANTING PER SPECIFICATIONS TO MAINTAIN HEALTHY PLANT CONDITIONS.
- PLANT MATERIALS SHALL BE PROTECTED FROM THE DRYING ACTION OF THE SUN AND WIND AFTER BEING DUG, WHILE BEING TRANSPORTED, AND WHILE AWAITING PLANTING. BALLS OF PLANTS WHICH CANNOT BE PLANTED IMMEDIATELY SHALL BE PROTECTED FROM DRYING ACTION BY COVERING THEM WITH MOIST MULCH. PERIODICALLY, APPLY WATER TO MULCH-COVERED BALLS TO KEEP MOIST. IF PLANTING SHOULD OCCUR DURING GROWING SEASON, APPLY ANTI-DESSICANT TO LEAVES BEFORE TRANSPORT TO REDUCE LIKELIHOOD OF WINDBURN. REAPPLY ANTI-DESSICANT AFTER PLANTING PLANTING TO REDUCE TRANSPIRATION.
- ALL PLANT MATERIAL SHALL BE CONTAINER GROWN OR BALLED AND BURLAPPED AS INDICATED IN THE PLANT SCHEDULE. PLANTS DESIGNATED CONTAINER GROWN SHALL HAVE BEEN GROWN IN POTS, CANS OR BOXES FOR FOR A MINIMUM OF SIX MONTHS AND A MAXIMUM OF TWO YEARS. THESE PLANTS SHALL BE REMOVED FROM CONTAINERS BEFORE PLANTING. PLANTS THAT APPEAR ROOT-BOUND SHALL BE REJECTED.
- ANY PLANT MATERIAL WHICH IS DISEASED, DISTRESSED, DEAD, OR REJECTED (PRIOR TO SUBSTANTIAL COMPLETION) SHALL BE PROMPTLY REMOVED FROM THE SITE AND REPLACED WITH MATERIAL OF THE SAME SPECIES, QUANTITY AND SIZE AND MEETING ALL PLANT LIST SPECIFICATIONS.
- ALL PLANTING AREAS SHALL BE COMPLETELY MULCHED AS SPECIFIED. PLACE 4" OF MULCH IN ALL SHRUB BEDS, PLACE 4" OF MULCH IN ALL TREE SAUCERS. PLANTING BEDS ARE TO BE COMPLETELY COVERED WITH A HARDWOOD MULCH FROM A LOCAL SOURCE HARVESTED IN A SUSTAINABLE MANNER.
- PLANTING BEDS RECEIVING MULCH ARE TO BE FREE OF WEEDS AND GRASS. TREAT BEDS WITH A PRE-EMERGENT HERBICIDE PRIOR TO PLANTING AND MULCH PLACEMENT. APPLY IN ACCORDANCE WITH STANDARD TRADE PRACTICE.
- CONTRACTOR SHALL INSTALL AN 18" WIDE MUGH STRIP BEHIND ALL CONCRETE CURBS.
- WHERE TURF GRASS WILL BE ESTABLISHED ADJACENT TO CONCRETE CURBS, EITHER A 16" OR 24" (DEPENDING UPON AVAILABILITY) WIDE SOD STRIP IS REQUIRED.

RELATED ITEMS

- THE CONTRACTOR SHALL USE A 4.1oz WOVEN POLYPROPYLENE, NEEDLE-PUNCHED FABRIC WEED BARRIER IN SHRUB BEDS. OVERLAP EDGES A MINIMUM OF 6". SECURE EDGES IN GROUND. INSTALL IN ALL LANDSCAPED ISLANDS.
- ALL PLANTING BEDS SHALL BE SEPERATED FROM TURF AREAS WITH STEEL EDGING. EDGING SHALL BE 1/2" X 4" INTERLOCKING STEEL EDGING WITH METAL STAKES SUFFICIENT TO HOLD EDGING IN PLACE. EDGING SHALL NOT EXTEND ABOVE ANY ADJACENT SIDEWALKS.

LAWNS AND SEEDING

- THIS PLAN IS TO BE IMPLEMENTED COOPERATIVELY WITH THE SWPP PLAN, AS NEEDED, TO MAXIMIZE THE EFFECTIVENESS OF THE SWPP PLAN FOR THIS SITE.
- THE CONTRACTOR IS ENCOURAGED TO COMPLETE TEMPORARY OR PERMANENT SEEDING OR SODDING IN STAGES FOR SOIL STABILIZATION AS AREAS ARE COMPLETED AFTER GRADING OPERATIONS.
- THIS PLAN DOES NOT PRESENT ANY TEMPORARY STABILIZATION REQUIRED AS PART OF THE SWPP PLAN.
- SOD TYPE:
FESCUE SOD SHALL BE A LOCALLY AVAILABLE PREMIUM FESCUE BLEND. CONTRACTOR IS RESPONSIBLE FOR INSTALLATION AND ESTABLISHMENT OF THE SOD TO THE LIMITS INDICATED ON THE PLANS. SOD SHALL COMPLY WITH THE REQUIREMENTS IN SECTION 02900 OF THE SPECIFICATIONS. ROLL SOD FOR A SMOOTH AND CONSISTENT FINAL LAWN.
- SEED TYPE:
PERMANENT LAWN SEEDING - PREMIUM FESCUE BLEND RATE: 10lbs/1000 SF (NEW LAWNS)
TEMPORARY LAWN SEEDING - ANNUAL RYEGRASS RATE: 3lbs/1000 SF

INSPECTIONS/MAINTENANCE AND CLEAN-UP

- THE CONTRACTOR SHALL BE RESPONSIBLE FOR FULLY MAINTAINING (INCLUDING BUT NOT LIMITED TO: WATERING, SPRAYING, MULCHING, FERTILIZING, ETC.) ALL OF THE PLANT MATERIALS AND LAWN FOR THE PERIOD OF TIME INDICATED IN THE SPECIFICATION SECTION 02900.
- THE CONTRACTOR SHALL COMPLETELY GUARANTEE ALL PLANT MATERIAL FOR A PERIOD DEFINED IN THE 02900 SPECIFICATION. THE CONTRACTOR SHALL PROMPTLY MAKE ALL REPLACEMENTS DURING THE NORMAL PLANTING SEASON.
- REMOVE ALL RUBBISH, EQUIPMENT AND MATERIAL AND LEAVE THE AREA IN A NEAT, CLEAN CONDITION EACH DAY. MAINTAIN PAVED AREAS UTILIZED FOR HAULING EQUIPMENT AND MATERIALS BY OTHER TRADES IN A CLEAN AND UNOBSTRUCTED CONDITION AT ALL TIMES.
- REMOVE SOIL OR DIRT THAT ACCUMULATED DURING OR AS A RESULT OF PLANTING OPERATIONS EACH DAY.
- LIMIT AMOUNT OF PRUNING TO A MINIMUM NECESSARY TO REMOVE DEAD OR INJURED TWIGS AND BRANCHES. PRUNE IN SUCH A MANNER AS NOT TO CHANGE NATURAL HABIT OR SHAPE OF PLANT. MAKE CUTS FLUSH, LEAVING NO STUBS. CENTRAL LEADERS SHALL NOT BE REMOVED.
- LANDSCAPE CONTRACTOR TO REMOVE TREE STAKES, GUYS, AND ALL DEAD WOOD ON TREES AND SHRUBS ONE YEAR AFTER PROVISIONAL ACCEPTANCE.
- PROVIDE NOTIFICATIONS TO THE OWNERS CIVIL ENGINEERING CONSULTANT (CEC) FOR MEETING AND EVENT NOTIFICATIONS FOR THE FOLLOWING:
PRE-WORK MEETING
PLANT MATERIAL SELECTION MEETING AT GROWER
PLANTING OPERATIONS
ISLAND INSPECTION
TREE TRANSPLANTING (IF APPLICABLE)
SUBSTANTIAL COMPLETION INSPECTION
FINAL INSPECTION
WARRANTY INSPECTION

* Note: Refer to SEED/SOD SCHEDULE for erosion control coordination.

TREE PROTECTION/PRESERVATION/TRANSPLANTING NOTES

- THIS PROJECT SITE CONTAINS EXISTING TREES THAT ARE TO BE RETAINED. THE CONTRACTOR SHALL CONTACT THE OFFICE OF THE LANDSCAPE ARCHITECT TO SCHEDULE AN ON-SITE MEETING TO FLAG TREES TO REMAIN AND THE EXTENT OF ANY TREE PRUNING TO BE DONE TO TREES TO REMAIN.
- THE LANDSCAPE CONTRACTOR IS TO COORDINATE WITH THE GENERAL CONTRACTOR FIVE DAYS BEFORE ANY WORK BEGINS TO SET UP A PROTECTION ZONE AROUND ALL TREES TO REMAIN IN PLACE. STAKES AND A FLAGGED BARRIER ARE TO BE SET UP ON THE OUTSIDE OF THE SAFETY ZONES ARE TO BE REMOVED ONLY UPON APPROVAL OF COMPLETION.
- EXISTING TREES THAT ARE WITHIN AREAS OF GRADING OPERATIONS WORK SHALL BE DONE PER SPECIFICATION SECTION 02900.
- TREES THAT ARE INDICATED (IF ANY) TO BE TRANSPLANTED SHALL BE DONE PER SPECIFICATION SECTION 02900 BY A CONTRACTOR WITH AN ESTABLISHED RECORD OF SUCCESSFUL TREE TRANSPLANTING AND A CERTIFIED ARBORIST ON STAFF.

LANDSCAPE ORDINANCE CALCULATIONS.

LANDSCAPED STREETYARD REQUIRED:

31st Street Frontage: 216 LF
Average Lot Depth: 678 LF
216 x 20 = 4,320 SF Required (9 Overstory Trees)

LANDSCAPED STREETYARD PROVIDED:

6,560 SF Streetyard
4 Ornamental Trees (2 Overstory)
7 Overstory Trees

PARKING LOT SCREENING:

Continuous 36" Tall Shrub Hedge

PARKING LOT REQUIRED TREES:

One (1) Tree / 20 Parking Stalls
148 Parking Stalls / 20 = 8 Trees Required
(1/2 of required trees must occur in Interior Islands)
(1/2 required streetyard trees may be used to satisfy parking lot tree requirement - 4 trees)

PARKING LOT TREES PROVIDED:

4 Overstory Trees
Total Parking Lot Trees Provided: 4 Trees + 1/2 streetyard trees required (located in Interior Islands)

RESIDENTIAL BUFFER (CUP DP 16 REQUIREMENTS):

Per CUP DP 16 a screening wall is required between the parcel and Exposition Ave which is existing. Per CUP DP 16 street trees are to be planted between the screening wall and Exposition Ave at 50 centers as part of the original construction. Four (4) new trees are proposed to satisfy the intent of this provision.

ALERT TO CONTRACTOR

ALL WM GENERAL CONTRACTING WORK TO BE COMPLETED (EARTHWORK, FINAL UTILITIES AND FINAL GRADING) BY THE MILESTONE DATE IN THE PROJECT DOCUMENTS. OUTLOT AREAS TO BE KEPT FREE OF JOB TRAILERS AND STORAGE AFTER THE CONTRACT MILESTONE DATE FOR THE OUTLOT. WM GENERAL CONTRACTOR TO PROVIDE CLEAR ACCESS FOR OUTLOT CONTRACTOR TO THE SPECIFIC PARCEL AT ALL TIMES AFTER MILESTONE DATE. PURCHASER OF OUTLOT TO PROVIDE PERMIT DOCUMENTS AND SWPPP REQUIRED BY STATE/LOCAL REQUIREMENTS FOR SPECIFIC OUTLOT.

UTILITY LOCATES

CONTRACTOR SHALL CONTACT 811 FOR LOCATION OF ALL UTILITIES, AT LEAST 72 HOURS PRIOR TO BEGINNING CONSTRUCTION.

CONTACT KANSAS ONE-CALL A MINIMUM 2 WORKING DAYS PRIOR TO WORK AT 1-800-344-7233 (WICHITA: 687-2470)

CITY OF WICHITA PUBLIC UTILITY LOCATE SHALL BE CONTACTED A MINIMUM 2 DAYS PRIOR TO WORK AT 316-268-4260.

DP-16 PARCEL 3
LANDSCAPE PLAN

APPROVED 02-18-11 BY RD
SHEETS 2 of 3
MAP COPY 1 of 2

PLANT SCHEDULE

TREES	QTY	BOTANICAL NAME	COMMON NAME	SIZE	REMARKS
ACE GIN	4	Acer glabrala 'Flame'	Flame Amur Maple	6' Height	CLUMP FORM
PIS CHI	6	Pistacia chinensis	Chinese Pistache	2.5" Cal.	
ULM ALL	7	Ulmus parvifolia 'Allee'	Allee Lacebark Elm	3" Cal	

SHRUBS	QTY	BOTANICAL NAME	COMMON NAME	CONT	REMARKS
CAL KAR	56	Calamagrostis x acutiflora 'Karl Foerster'	Feather Reed Grass	5 gal	
JUN SEA	47	Juniperus x pfitzeriana 'Sea Green'	Sea Green Juniper	5 gal	
LIG GOL	71	Ligustrum vicaryi	Golden Privet	5 gal	
RHU GRO	21	Rhus aromatica 'Gro-Low'	Gro-Low Fragrant Sumac	5 gal	
SPI MOU	28	Spiraea x bumalda 'Goldmound'	Gold Mound Spirea	5 gal	



STIPULATION FOR REUSE
THIS DRAWING WAS PREPARED FOR USE ON A SPECIFIC SITE AT A SPECIFIC DATE AND TIME, AND IT IS NOT TO BE REUSED FOR ANY OTHER PROJECT WITHOUT THE WRITTEN PERMISSION OF THE ARCHITECT. ANY REUSE OF THIS DRAWING FOR ANY OTHER PROJECT IS NOT AUTHORIZED AND MAY BE CONTRARY TO THE LAW.

CONSULTANTS

WALMART MARKET
WICHITA, KS
STORE NO. 5991-00
JOB NUMBER: 4866.00 | PHOTO:

ISSUE BLOCK

CHECKED BY: JB
DRAWN BY: WAW
FILE NAME:
PROTO CYCLE:
DOCUMENT DATE: 01-20-11

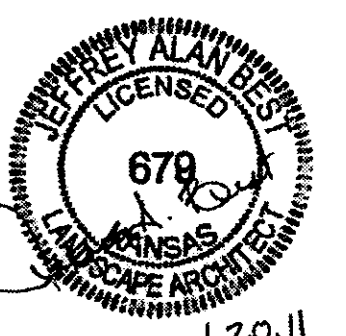

SHEET TITLE:
Landscape Planting Notes

SHEET:
LP2

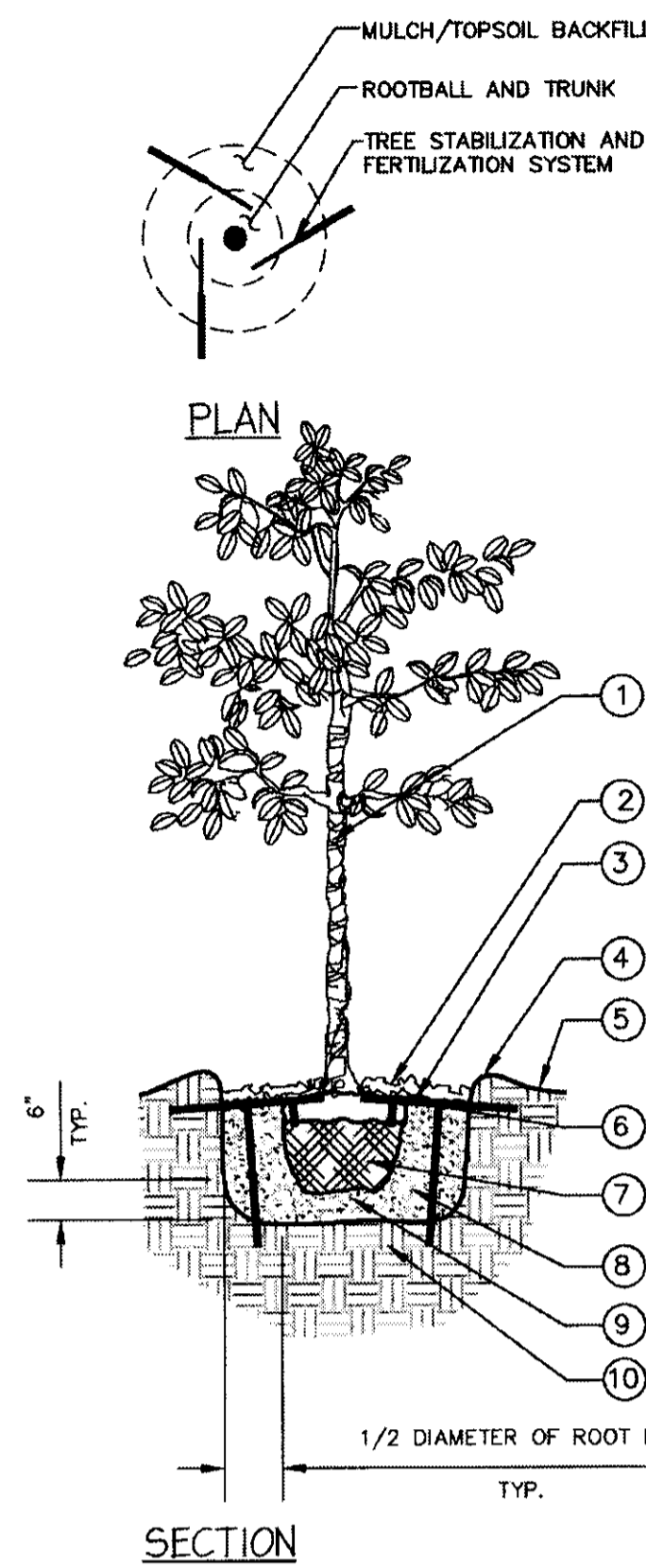

- TREE WRAP
- 4" MINIMUM OF HARDWOOD BARK MULCH COMPACTED OR AS SPECIFIED.
- STAKE SIZE SHALL BE ONE SIZE HIGHER THAN REQUIRED FOR SIZE OF TREE. REFER TO SITEWORK SPECIFICATIONS FOR APPROVED MATERIALS AND INSTALLATION REQUIREMENTS.
- 3" HIGH SOIL BERM TO HOLD WATER.
- FINISHED GRADE (SEE GRADING PLAN)
- TOP OF ROOTBALL MIN. 1" ABOVE FINISHED GRADE
- B & B OR CONTAINERIZED (SEE SPECIFICATIONS FOR ROOT BALL REQUIREMENTS).
- PREPARED PLANTING SOIL AS SPECIFIED.
- ROOTBALLS GREATER THAN 24" DIAMETER SHALL BE PLACED ON MOUND OF UNDISTURBED SOIL TO PREVENT SETTLING ROOTBALLS SMALLER THAN 24" IN DIA. MAY SIT ON COMPACTED EARTH.
- UNDISTURBED SUBSOIL

NOTES:

- FINAL TREE STAKING DETAILS AND PLACEMENT TO BE APPROVED BY OWNER.
- REMOVE BURLAP, WIRE AND STRAPS (ANYTHING THAT COULD GIRDLING TREE OR RESTRICT ROOT GROWTH) ON UPPER 1/3 OF ROOTBALL.
- SEE LANDSCAPE NOTES FOR THE TYPE OF MULCH MATERIAL TO USE.
- PRUNE TREE AS DIRECTED BY LANDSCAPE ARCHITECT.
- BRANCHING HEIGHT TO A.A.N. STANDARDS.

1 LARGE TREE PLANTING - 14' OR GREATER

NTS

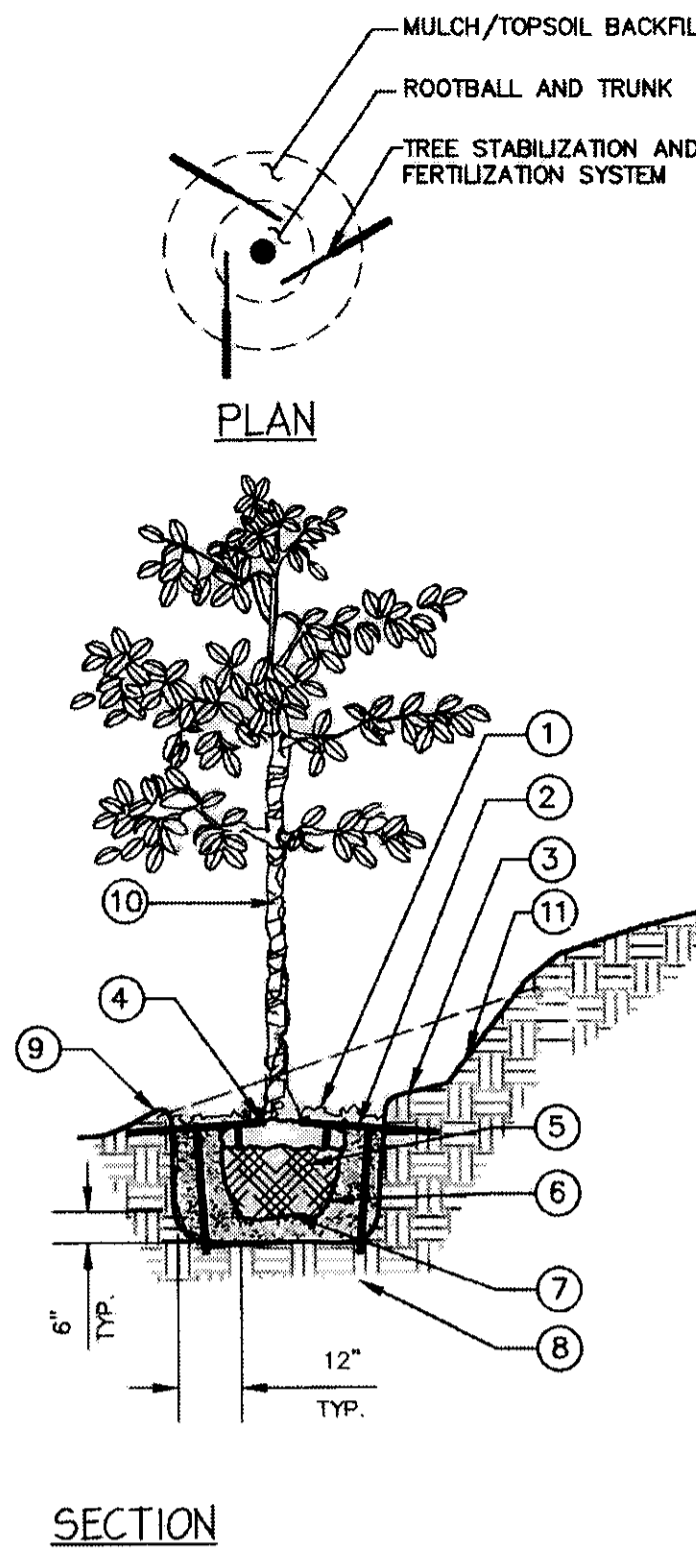

- 4" MINIMUM OF HARDWOOD BARK MULCH COMPACTED OR AS SPECIFIED.
- STAKE SIZE SHALL BE ONE SIZE HIGHER THAN REQUIRED FOR SIZE OF TREE. REFER TO SITEWORK SPECIFICATIONS FOR APPROVED MATERIALS AND INSTALLATION REQUIREMENTS.
- 4" MINIMUM OF TOPSOIL TO BRING TO FINISHED GRADE (SEE GRADING PLAN).
- TOP OF ROOTBALL MIN. 1" ABOVE FINISHED GRADE
- B&B OR CONTAINERIZED (SEE SPECIFICATIONS FOR ROOT BALL REQUIREMENTS).
- PREPARE PLANTING SOIL AS SPECIFIED.
- ROOTBALLS GREATER THAN 24" DIAMETER SHALL BE PLACED ON MOUND OF UNDISTURBED SOIL TO PREVENT SETTLING ROOTBALLS SMALLER THAN 24" IN DIA. MAY SIT ON COMPACTED EARTH.
- UNDISTURBED SUBSOIL
- 3" HIGH SOIL BERM TO HOLD WATER.
- TREE WRAP
- CUT BACK SLOPE TO PROVIDE A FLAT SURFACE FOR PLANTING.

NOTES:

- FINAL TREE STAKING DETAILS AND PLACEMENT TO BE APPROVED BY OWNER.
- REMOVE BURLAP, WIRE AND STRAPS (ANYTHING THAT COULD GIRDLING TREE OR RESTRICT ROOT GROWTH) ON UPPER 1/3 OF ROOTBALL.
- SEE LANDSCAPE NOTES FOR THE TYPE OF MULCH MATERIAL TO USE.
- PRUNE TREE AS DIRECTED BY LANDSCAPE ARCHITECT.
- BRANCHING HEIGHT TO A.A.N. STANDARDS.

3 TREE PLANTING ON SLOPE

NTS

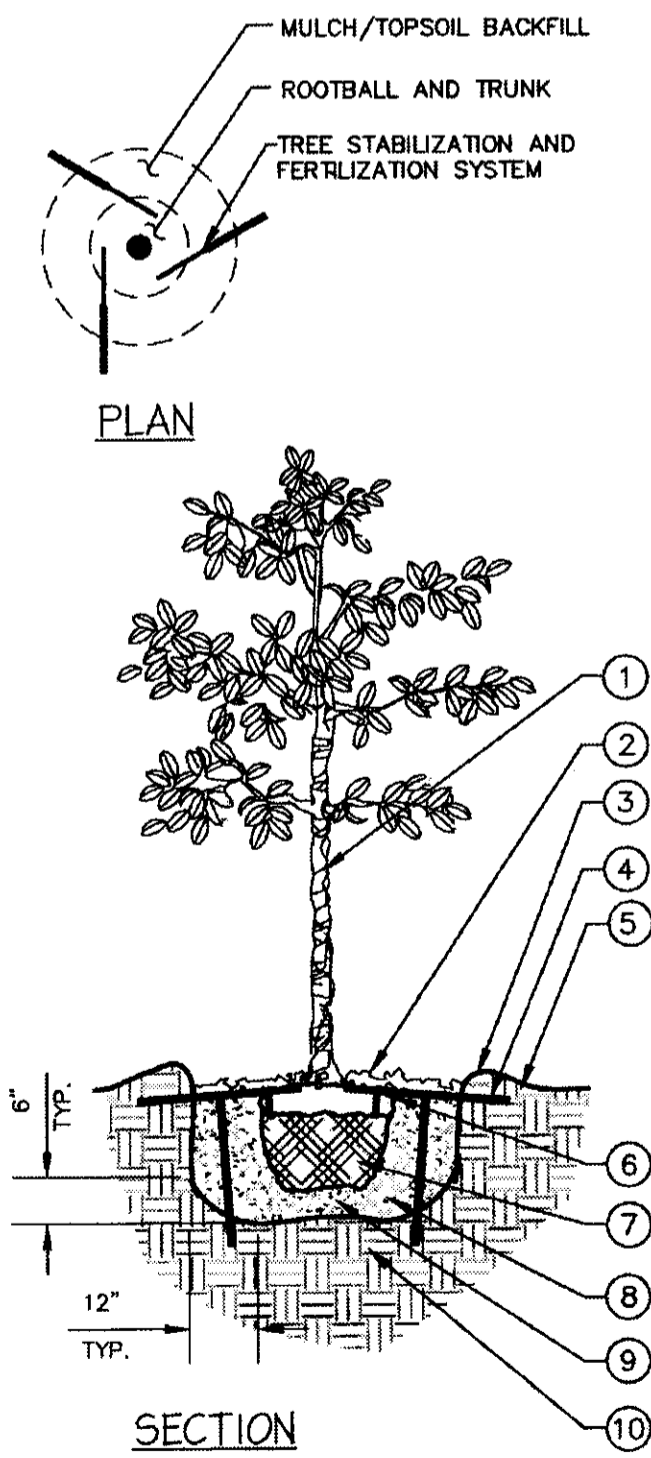

- TREE WRAP
- 4" MINIMUM OF HARDWOOD BARK MULCH COMPACTED OR AS SPECIFIED.
- 3" HIGH SOIL BERM TO HOLD WATER.
- STAKE SIZE SHALL BE ONE SIZE HIGHER THAN REQUIRED FOR SIZE OF TREE. REFER TO SITEWORK SPECIFICATIONS FOR APPROVED MATERIALS AND INSTALLATION REQUIREMENTS.
- FINISHED GRADE (SEE GRADING PLAN)
- TOP OF ROOTBALL MIN. 1" ABOVE FINISHED GRADE
- B & B OR CONTAINERIZED (SEE SPECIFICATIONS FOR ROOT BALL REQUIREMENTS).
- PREPARED PLANTING SOIL AS SPECIFIED.
- ROOTBALLS GREATER THAN 24" DIAMETER SHALL BE PLACED ON MOUND OF UNDISTURBED SOIL TO PREVENT SETTLING ROOTBALLS SMALLER THAN 24" IN DIA. MAY SIT ON COMPACTED EARTH.
- UNDISTURBED SUBSOIL

NOTES:

- FINAL TREE STAKING DETAILS AND PLACEMENT TO BE APPROVED BY OWNER.
- REMOVE BURLAP, WIRE AND STRAPS (ANYTHING THAT COULD GIRDLING TREE OR RESTRICT ROOT GROWTH) ON UPPER 1/3 OF ROOTBALL.
- SEE LANDSCAPE NOTES FOR THE TYPE OF MULCH MATERIAL TO USE.
- PRUNE TREE AS DIRECTED BY LANDSCAPE ARCHITECT.
- BRANCHING HEIGHT TO A.A.N. STANDARDS.

2 SMALL TREE PLANTING - 14' OR LESS

NTS

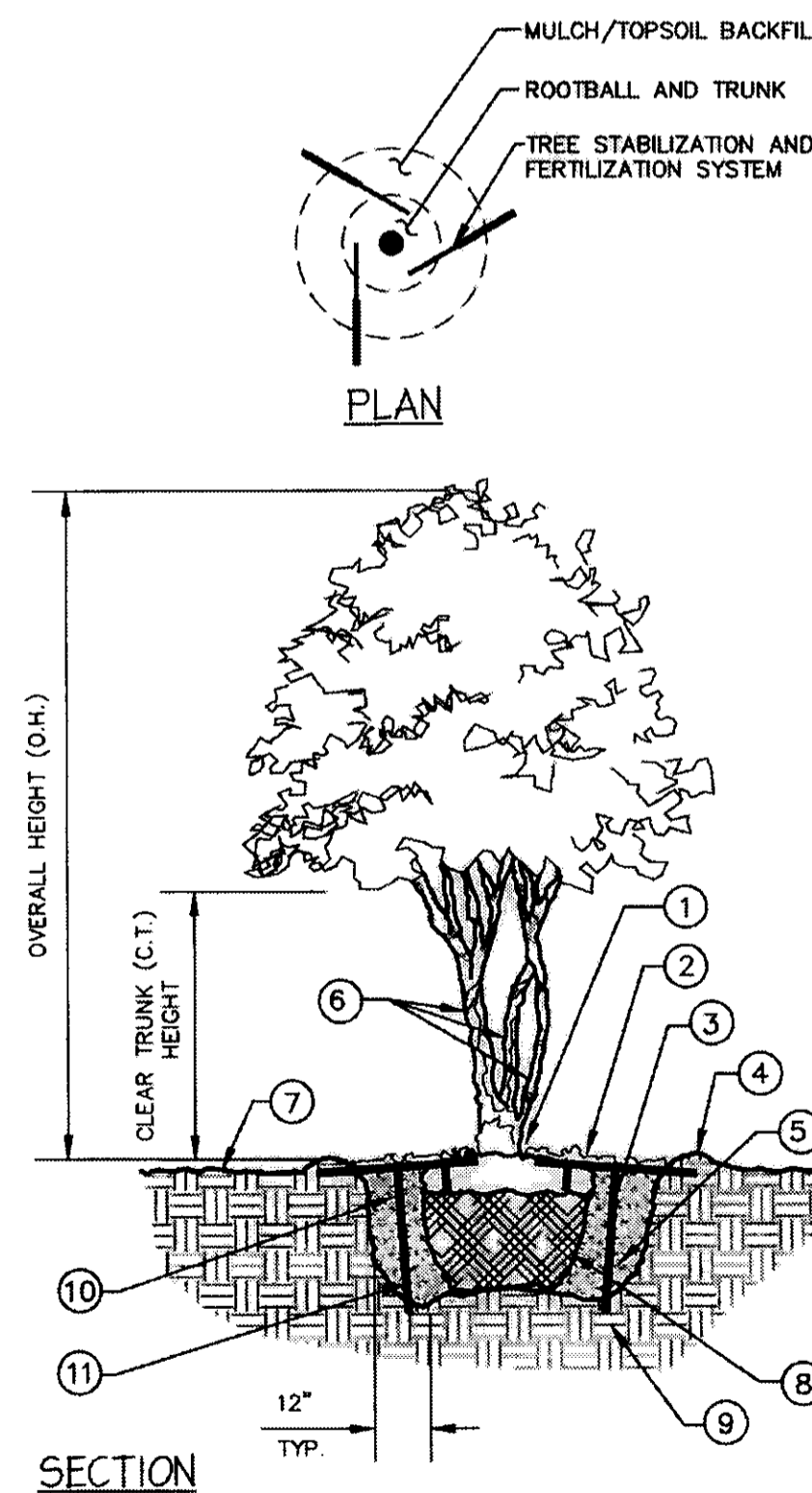

- BASE OF TREE SHALL BE PLANTED SLIGHTLY ABOVE (1" MIN.) ADJACENT FINISH GRADE. REMOVE ALL TWINE & STRAPS & CUT BURLAP FROM TOP 1/3 OF ROOTBALL. NO SYNTHETIC BURLAP WILL BE ACCEPTED.
- 4" SHREDDED HARDWOOD BARK MULCH OR APPROVED EQUAL
- DIAMETER OF TREE PIT TO BE TWICE THE DIAMETER OF ROOTBALL--ROUND SIDES OF TREE PIT.
- 3" HIGH SOIL BERM TO HOLD WATER.
- TOPSOIL MIX BACKFILL
- TREE WRAP
- 4" MIN. OF TOPSOIL TO BRING TO FINISHED GRADE (SEE GRADING PLAN)
- ROOTBALLS GREATER THAN 24" DIAMETER SHALL BE PLACED ON MOUND OF UNDISTURBED SOIL TO PREVENT SETTLING ROOTBALLS SMALLER THAN 24" IN DIA. MAY SIT ON COMPACTED EARTH.
- UNDISTURBED SUBSOIL
- PREPARE PLANTING SOIL AS SPECIFIED.
- STAKE SIZE SHALL BE ONE SIZE HIGHER THAN REQUIRED FOR SIZE OF TREE. REFER TO SITEWORK SPECIFICATIONS FOR APPROVED MATERIALS AND INSTALLATION REQUIREMENTS.

NOTES:

- FINAL TREE STAKING DETAILS AND PLACEMENT TO BE APPROVED BY OWNER.
- SET TREE AT ORIGINAL DEPTH. REMOVE BURLAP, WIRE AND STRAPS (ANYTHING THAT COULD GIRDLING TREE OR RESTRICT ROOT GROWTH) ON UPPER 1/3 OF ROOTBALL.
- SEE LANDSCAPE NOTES FOR THE TYPE OF MULCH MATERIAL TO USE.
- PRUNE TREE AS DIRECTED BY LANDSCAPE ARCHITECT
- BRANCHING HEIGHT TO A.A.N. STANDARDS

4 MULTI-TRUNK TREE PLANTING

NTS

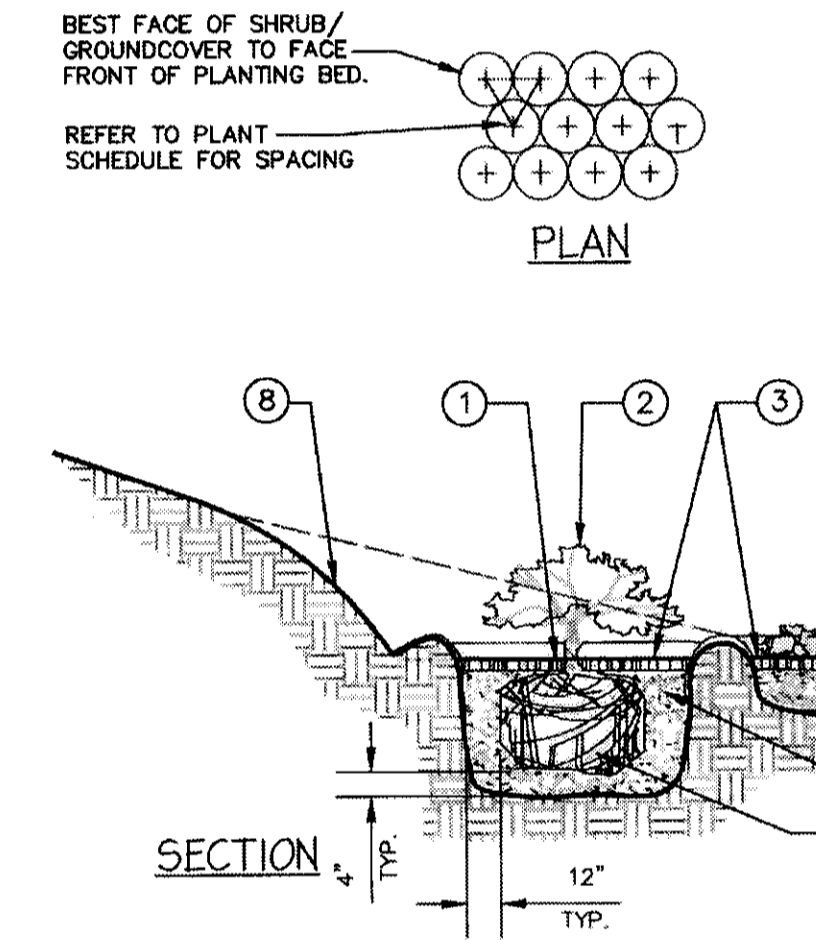

5 SHRUB/GROUNDCOVER PLANTING

NTS

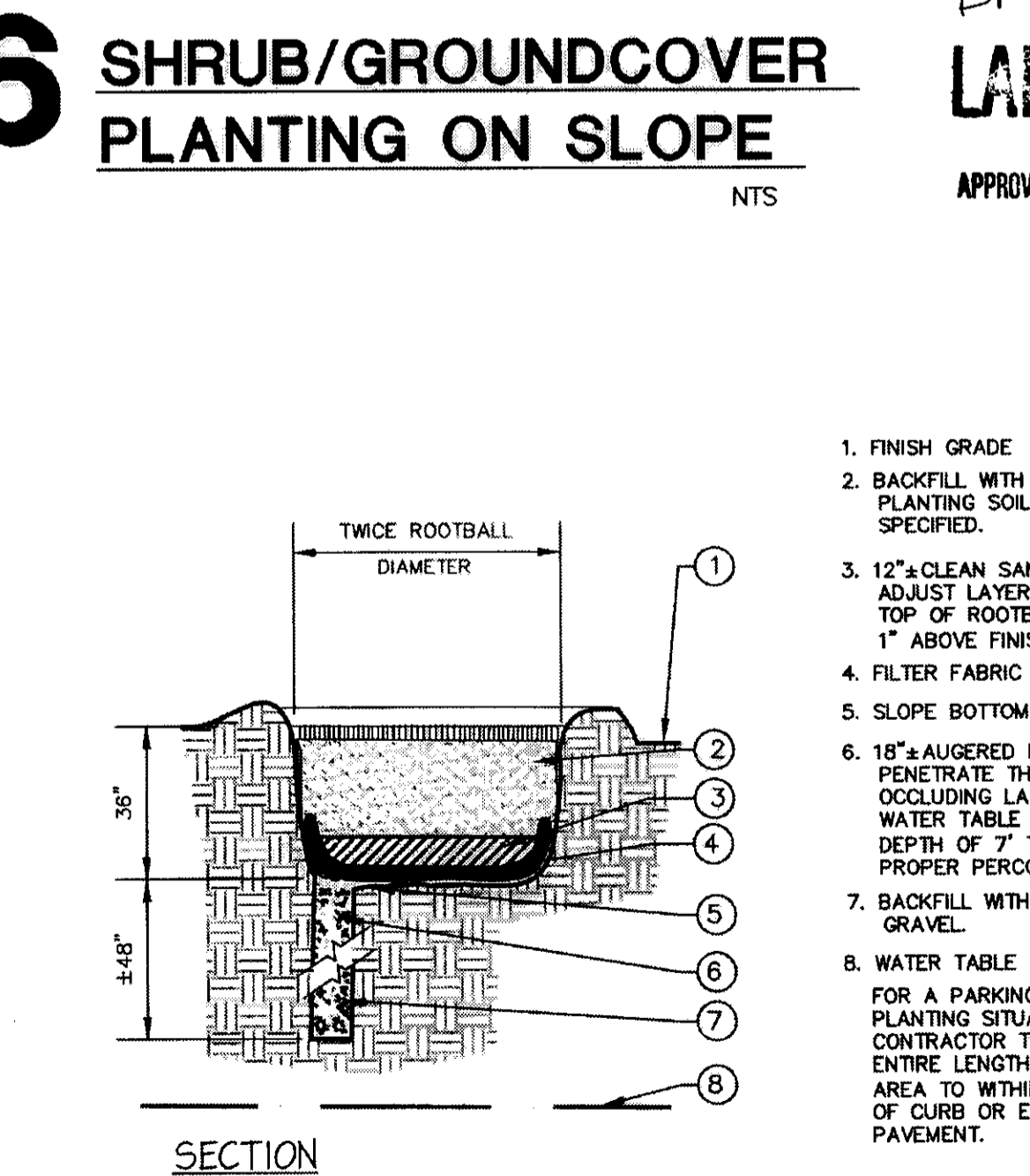

6 SHRUB/GROUNDCOVER PLANTING ON SLOPE

NTS

- FINISH GRADE
- BACKFILL WITH PREPARED PLANTING SOIL MIX AS SPECIFIED.
- 12"± CLEAN SAND, COMPACTED. ADJUST LAYER THICKNESS SO TOP OF ROOTBALL IS AT EAST 1" ABOVE FINISHED GRADE.
- FILTER FABRIC
- SLOPE BOTTOM TO DRAIN
- 18"± AUGERED HOLE PENETRATE THROUGH OCCCLUDING LAYER TO WATER TABLE OR TO A DEPTH OF 7' TO ASSURE PROPER PERCOLATION.
- BACKFILL WITH 1/2" - 3/4" GRAVEL.
- WATER TABLE FOR A PARKING ISLAND PLANTING SITUATION, CONTRACTOR TO BACKFILL ENTIRE LENGTH OF PLANTING AREA TO WITHIN 6" OF BACK OF CURB OR EDGE OF PAVEMENT.

7 POOR DRAINAGE CONDITION

NTS

LAW/KINGDON ARCHITECTURE
ENGINEERING PLANNING INTERIOR LANDSCAPES
3000 W. 10th St., Suite 100
Wichita, KS 67202
Phone (316) 262-2222 Fax (316) 262-2222
Copyright © 2008

STIPULATION FOR REUSE
THIS DRAWING WAS PREPARED FOR THE PROJECT AND SITE SPECIFICALLY. IT IS NOT TO BE REUSED FOR ANY OTHER PROJECT OR SITE. ANY REUSE OF THIS DRAWING FOR ANY OTHER PROJECT OR SITE WITHOUT THE WRITTEN PERMISSION OF LAW/KINGDON ARCHITECTURE IS PROHIBITED. THE USER OF THIS DRAWING FOR ANY OTHER PROJECT OR SITE IS NOT TO BE HELD RESPONSIBLE FOR ANY REUSE OF THIS DRAWING FOR ANY OTHER PROJECT OR SITE WITHOUT THE WRITTEN PERMISSION OF LAW/KINGDON ARCHITECTURE.

CONSULTANTS

WALMART
MARKET
WICHITA, KS
STORE NO. 5991-00
JOB NUMBER: 4966.00 | PROJ. NO. 5991-00

ISSUE BLOCK

CHECKED BY: JB
DRAWN BY: WAW
FILE NAME:
PROTO CYCLE:
DOCUMENT DATE: 01-20-11

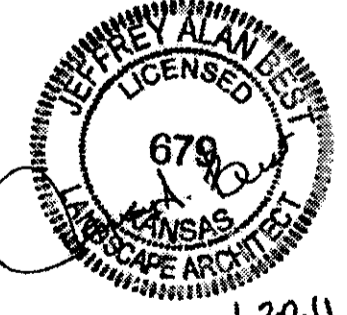

SHEET TITLE:
Landscape Planting Details

SHEET:
LP3

DP-16 PARCEL 3
LANDSCAPE PLAN
APPROVED 02-18-11 BY DG
SHEET 3 of 3
MAPDCopy 1 of 2