

E1 s/w 4
52

10-10-74

Map No. K-8-C
Sec. 13
Twp. 28S
Range 1E

DATA SHEET
(ZONING & CONDITIONAL USE)

Z- _____
SCZ- _____
CU- 163
Filed 9-10-74

APPLICATION DATA: From _____ to _____
1. Applicant: Sherwood Construction Company, Inc.
Address: 4421 E. Harry 67209 Phone 943-0211
2. Agent: Roger Sherwood
Address: 516 Century Plaza Bldg. 67202 Phone 267-2819
3. General Location: Northeast corner of Oliver and 47th St. South Address _____
4. Proposed Use: borrow area for fill dirt on canal route highway

AREA DATA:
1. Acres: 46 (1292 ft. by 1849 ft.)
2. Adjoining Zoning: E E S E W E N E
3. Land Use: East McKinnel Air Base South UNDEVELOPED
West SINGLE FAMI North BOEING CO.
4. Sketch Plan Land Use is for: _____
5. Present Land Use is for: SINGLE FAMI?
6. Area ~~xxx~~ (is not) platted.

PHOTO DATA:
Taken by B Date 9-26-74 Time 2:45

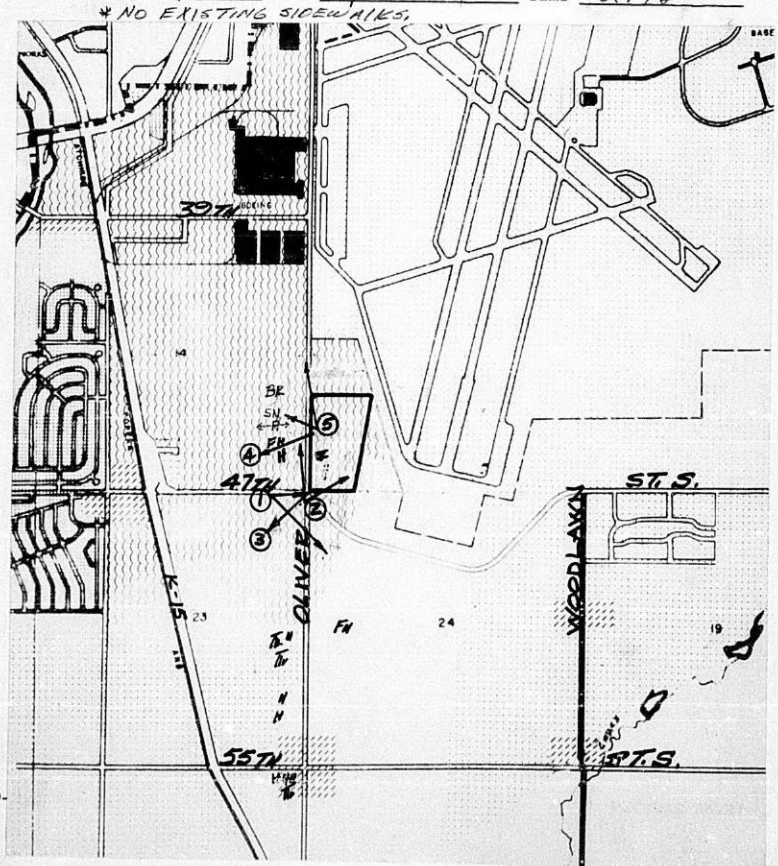

T9-

() Published in The Wichita Beacon on 12.5, 1974.

R E S O L U T I O N

CASE NO. CU-163

A RESOLUTION PERMITTING A CONDITIONAL USE TO
PERMIT AN EARTH BORROW OPERATION

ON CERTAIN LANDS LOCATED WITHIN THE UNINCORPORATED TERRITORY LYING WITHIN THREE MILES OF EITHER THE CITY OF WICHITA, THE CITY OF HAYSVILLE, THE CITY OF DERBY, THE CITY OF MULVANE, THE CITY OF VALLEY CENTER, THE CITY OF GODDARD, AND THAT PORTION OF THE AREA WITHIN THREE MILES OF THE CITY OF CHENEY AS ESTABLISHED BY THE BOARD OF COUNTY COMMISSIONERS ON OCTOBER 3, 1973, ALL IN SEDGWICK COUNTY, KANSAS, UNDER THE AUTHORITY GRANTED BY SECTION 9.A.4.a. AND SECTION 11.E OF THE ZONING RESOLUTION ADOPTED BY THE BOARD OF COUNTY COMMISSIONERS OF SEDGWICK COUNTY, KANSAS, ON MARCH 3, 1958, AND SUBSEQUENT AMENDMENTS THERETO.

BE IT RESOLVED BY THE BOARD OF COMMISSIONERS OF SEDGWICK COUNTY, KANSAS:

SECTION I. That after receiving a recommendation from Wichita-Sedgwick County Metropolitan Area Planning Commission and after said Planning Commission has given proper notice and held a public hearing as provided by law, and under authority granted by Section 9.A.4.a. and Section 11.E. of the Zoning Resolution, as amended, a Conditional Use Permit to allow an earth borrow operation is hereby approved on the lands legally described as follows:

SW/4 of Section 13, Township 28, Range 1 East, except road and except 93.94 acre irregular tract off east side and except the north 20 acres. Generally located at the northeast corner of Oliver and 47th Street South,

SUBJECT TO THE FOLLOWING:

1. The final grade, once the extraction operation is completed, shall be in conformance with the site grading plan submitted with the application and dated September 6, 1974.
2. No area shall remain without cover for more than 90 days after excavation and all exposed areas shall be seeded to either temporary or permanent vegetative cover in order to help prevent erosion. The applicant shall consult with the Soil Conservation Service relative to the type of vegetation that is necessary to prevent erosion.
3. Subject property shall be platted prior to the issuance of any zoning or building permits, except those necessary for the soil extraction operation.
4. Once the extraction operation has ceased, final grading shall be completed and no foreign matter such as rubbish, construction equipment, etc., shall remain on the property.
5. That the Conditional Use permit is authorized only until December 31, 1977, and that subject project must be completed by that date; and any violation of the conditions of approval shall declare the conditional use permit null and void.

SECTION II. That upon the taking effect of this Resolution, the notation of such Conditional Use approval shall be entered in the Official zoning atlas on file in the Office of the County Zoning Administrator and in the Office of the Wichita-Sedgwick County Metropolitan Area Planning Department.

SECTION III. That this Resolution shall take effect and be in force from and after its adoption and publication in the Official County Paper.

PASSED AND ADOPTED at Sedgwick County, Kansas, this 6th day of November, 1974.



Tom Scott
Tom Scott, Chairman

Elmer Peters
Elmer Peters, Commissioner

Earl E. Rush
Earl Rush, Commissioner

ATTEST:

Marie Warden
Marie Warden, County Clerk
Chermaine McDonald - Deputy

(SEAL)

Approved as to form by:

Jack Turner
Jack Turner
County Counselor

*

This CU file

Has a Large Drawing

On 35mm Microfilm.

Roll # 1

*