

D-0343 - Dedication from McEwen Es-
tates, Inc., for Farmview Lane west
of Gouverneur Road in an area south
of the St. Louis & San Francisco RR

Posted
4-13-67

ACTION

DATE

S/D COMMITTEE Accept 4-20-67

M.A.P.C. Accept 4-27-67

B.C.C./~~B.C.C.~~ Accepted 5-16-67

Closed 5-16-67

DEDICATION REPORT AND PROGRESS

MAP No. 5949
 SEC. No. 7
 TWP. No. 27S
 RANGE 2E

CASE No. D -0343

I. OFFER TO DEDICATE: Farmview Lane
 GENERALLY LOCATED: west of Gouverneur Road in an area south of
St. Louis & San Francisco Railroad

LEGALLY DESCRIBED AS:

Beginning at the point of intersection of the east line of McEwen 9th Addition and the north line of Farmview Lane; thence east parallel to the S line of the St. Louis-San Francisco RR to the W line of Gouverneur Rd; thence S 60 feet; thence W parallel to the S line of said RR to the E line of said Addition; thence Nly along said E line to the point of beginning.

DEDICATED BY: McEwen Estates, Inc.
 AGENT: John D. McEwen, Vice President
 ADDRESS: 700 East Central 67202 PHONE AM 4-8504
 PURPOSE OF DEDICATION:

Street Right-of-way

II. SKETCH.

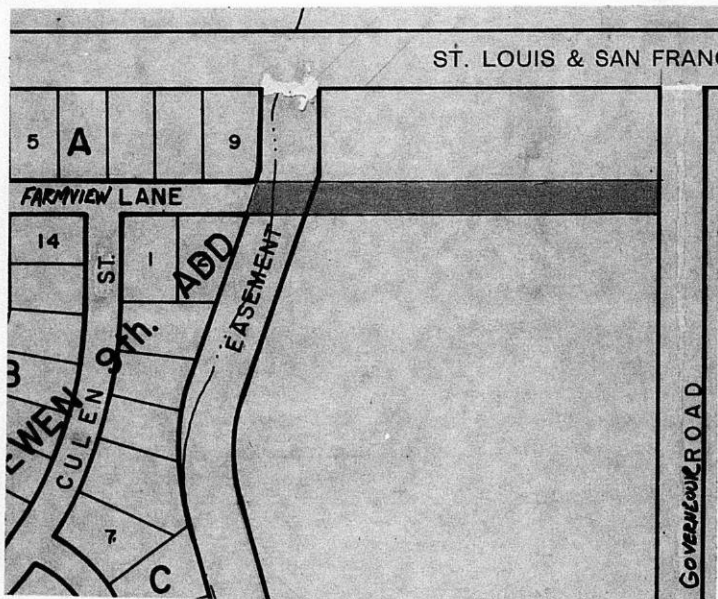

III. FILED 4-11-67 B.C.C. ACTION 5-16-67 Accepted
 POSTED TO ATLAS 4-13-67
 S/D COMM. ACTION 4-20-67 Accept PLACED ON RECORD _____
 M.A.P.C. ACTION 4-27-67 Accept CITY CLERKS No. _____

Dedication of: Farmview Lane

MAPC Case No. D-0343

Approved by MAPC: 4-27-67

Dedicated by: McEwen Estates, Inc.

General Location: West of Gouverneur Road in an area south of St. Louis
& San Francisco Railroad

Reason for Acceptance: To provide public right-of-way from existing
Farmview Lane as platted in McEwen 9th Addition, to Gouverneur Road.

City Manager's Recommendation: Accept the Dedication and instruct
the City Clerk to file with the Register of Deeds.

April 28, 1967

Mr. John D. McEwen
McEwen Estates, Inc.
700 East Central
Wichita, Kansas 67202

Subject: D-0343 - Dedication for Farmview Lane
lying west of Gouverneur Road in an area south
of the St. Louis & San Francisco Railroad

Dear Mr. McEwen:

At its regular meeting on April 27, 1967, the Metropolitan Area Planning Commission considered the above-captioned offer of dedication. The action of the Planning Commission was to recommend that this dedication be accepted.

This matter will be forwarded to the Board of City Commissioners for their consideration at 9:00 a.m., Tuesday, May 9, 1967, in Room 201, City Building, 204 South Main.

If you have any questions concerning this matter, please call.

Sincerely,

Jack H. Galbraith
Senior Planner

JHG:bgs

April 21, 1967

Mr. John D. McEwen
McEwen Estates, Inc.
700 East Central
Wichita, Kansas 67202

Subject: D-0343 - Dedication for street
right-of-way generally located west of
Gouverneur Road in an area south of St.
Louis & San Francisco Railroad.

Dear Mr. McEwen:

This is to advise you that the Subdivision Committee of the Metropolitan Area Planning Commission, at its regular meeting on April 20, 1967, considered the above-captioned offer of dedication. The action of the Subdivision Committee was to recommend that this dedication be accepted.

The recommendation of the Subdivision Committee that this dedication be accepted will be forwarded to the Metropolitan Area Planning Commission for their consideration at their next regular meeting on April 27, 1967.

Very truly yours,

Jack H. Galbraith
Senior Planner

JHG:JDG:sa

DEDICATION

KNOW ALL MEN BY THESE PRESENTS:

That for and in consideration of the sum of One Dollar (\$1.00) and other good and valuable considerations, the receipt of which is hereby acknowledged, the undersigned, McEWEN ESTATES, INC.

being the owner of the following described real estate in Sedgwick County, Kansas, to wit:

Beginning at the point of intersection of the east line of McEwen 9th Addition and the north line of Farmview Lane; thence east parallel to the south line of the St. Louis-San Francisco Railroad to the west line of Gouverneur Road; thence south sixty (60) feet; thence west parallel to the south line of said Railroad to the east line of said Addition; thence northerly along said east line to the point of beginning.

MICROFILMED
FROM THE BEST
AVAILABLE COPY

do hereby dedicate the above described real estate to the public for street purposes.

Executed this 3rd day of April, 19 67.



Secretary

McEwen Estates, Inc.

Vice Pres

STATE OF KANSAS)
SEDGWICK COUNTY) SS

BE IT REMEMBERED, that on this 3rd day of April, 19 67, before me a Notary Public in and for the said County and State came

John D. McEwen, Vice President of McEwen Estates, Inc. and Owen

C. McEwen, Secretary of McEwen Estates, Inc.

to me personally known to be the same persons who executed the foregoing instrument and duly acknowledged the execution of the same.

IN WITNESS WHEREOF, I have hereunto subscribed my name and affixed my seal, the day and year last above written.



Notary Public

Commission expires Sept. 12, 1968.