

5/10 COMMITTEE

M.A.P.C. *No hearing necessary*

B.C.C. ~~15-60-C~~ *Accepted 11-28-67*

*Closed 11-28-67*

D-0380 - Dedication from Berean Fellowship, Inc. of 20' additional half-street R/W for the N $\frac{1}{2}$  of Maple, west of Evergreen Lane

DEDICATION REPORT AND PROGRESS

MAP No. 4947  
 Sec. No. 21  
 TWP. No. 27S  
 RANGE 1W

CASE No. D - 0380

I. OFFER TO DEDICATE: 20' additional half-street R/W for N<sup>1</sup>/<sub>2</sub> of Maple  
 GENERALLY LOCATED: just west of Evergreen Lane

LEGALLY DESCRIBED AS:

The south 20 feet of Lot 32, in Evergreen Place, an Addition to Wichita, Sedgwick County, Kansas, except the west 159.5 feet thereof.

346 South Meadowhaven 67209

DEDICATED BY: Berean Fellowship, Inc. by Pete Tovey, President  
 AGENT: Brian G. Grace  
 ADDRESS: 830 First National Bank Bldg. 67202 PHONE AM 4-1376  
 PURPOSE OF DEDICATION:

Required in connection with Z-0925 - Zone change from "AA" to "B"

II. SKETCH.

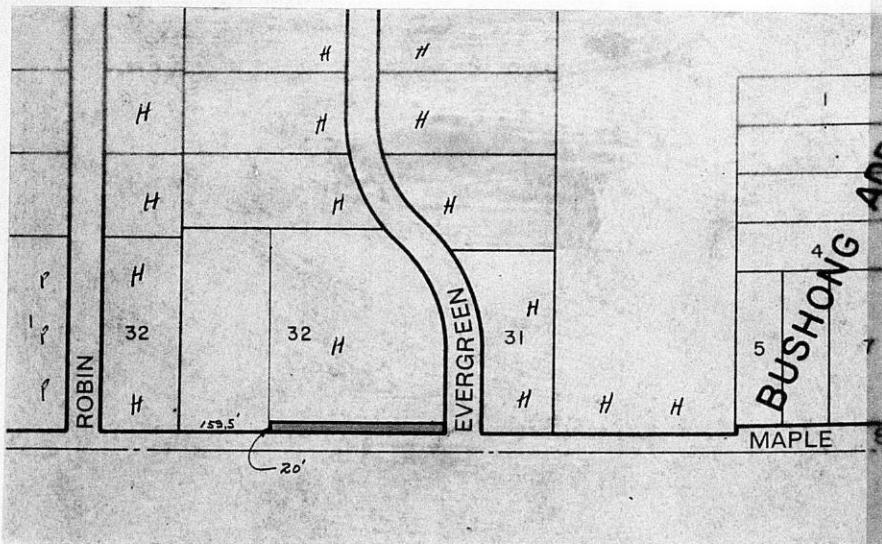

III. FILED 11-15-67  
 POSTED TO ATLAS 11-20-67  
 S/D COMM. ACTION No hearing necessary  
 M.A.P.C. ACTION No hearing necessary  
 B.C.C. ACTION 11-28-67 Accepted  
 PLACED ON RECORD \_\_\_\_\_  
 CITY CLERKS No. \_\_\_\_\_

Dedication of: 20' additional half-street  
R/W N $\frac{1}{2}$  of Maple

MAPC Case No. D-0380

Dedicated by: Berean Fellowship, Inc.

Approved by MAPC: N/A

General Location: N $\frac{1}{2}$  of Maple just west of Everegreen Lane

Reason for Acceptance: Required in connection with Z-0925

City Manager's Recommendation: Accept the Dedication and instruct  
the City Clerk to file with the Register of Deeds.

