

D-0387 - Clear Lakes, Inc.
dedicates sewer easements in area
South of 21st & West of Amidon

1-11-68
1-11-68
1-11-68

539A

ACTION

DATE

S/D COMMITTEE Accept 1-11-68

M.A.P.C. Accept 1-25-68

~~B.C.C.B. COFC~~ accept 2-6-68

closed 2-6-68

DEDICATION REPORT AND PROGRESS

MAP No. 5349
 SEC. No. 7
 TWP. No. 27
 RANGE 1E

CASE No. D - 0387

I. OFFER TO DEDICATE: Sewer easements
 GENERALLY LOCATED: Area South of 21st St. and West of Amidon

LEGALLY DESCRIBED AS:

The south sixteen (16) feet of the north sixty-six (66) feet of the Northwest Quarter of Section 7, Township 27, South, Range 1, East of the 6th P. M., except the east one thousand four hundred ninety-eight and two hundredths (1498.02) feet. *and* THE NORTH EIGHT (8) FEET OF THE WEST THIRTY (30) FEET OF LOT 2, MARINA LAKE ADDITION.

DEDICATED BY: Clear Lakes, Inc.
 AGENT: Don E. Satterthwaite and Mearle D. Mason
 ADDRESS: 810 West Douglas 67203 PHONE AM 5-3247
 PURPOSE OF DEDICATION: Sewer Easements

ASSOCIATED CASES: S/D 67-59 Marina Lake Addition
 S/D 67-110 Marina Lake Second Addition

II. SKETCH.

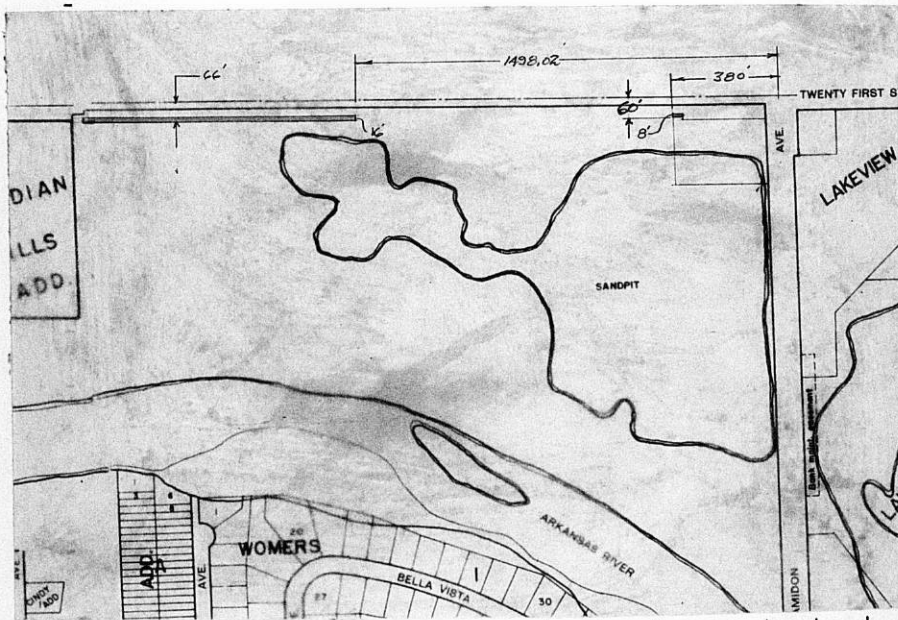

III. FILED 1-10-68
 POSTED TO ATLAS 1-16-68
 S/D COMM. ACTION 1-18-68
 M.A.P.C. ACTION 1-25-68 *Accept*

B.C.C. ACTION 2-6-68
 PLACED ON RECORD _____
 CITY CLERKS No. _____

Dedication of: *sewer easements*

MAPC Case No. *D-0387*

Dedicated by: *Clear Lakes, Inc.*

Approved by MAPC: *1-25-68*

General Location: *in an area south of
21st Street and west of Amidon*

Reason for Acceptance:

*Submitted in connection with the platting and
associated improvements of Marina Lake
First & Second Additions.*

City Manager's Recommendation: Accept the Dedication and instruct the
City Clerk to file with the Register of Deeds.

January 29, 1968

Mr. Don E. Satterthwaite
Union National Building
Wichita, Kansas 67202

Subject: D-0386 - Dedication of Street Right-of-Way; and D-0387 - Dedication of Sewer Easements; in an area south of 21st Street and west of Amidon

Dear Mr. Satterthwaite:

At its regular meeting on January 25, 1968, the Metropolitan Area Planning Commission considered the above-captioned offers of dedication. The action of the Planning Commission was to recommend that these dedications be accepted.

This matter will be forwarded to the Board of City Commissioners for its consideration at its regular meeting at 9:00 a.m., Tuesday, February 6, 1968, in Room 201, City Building, 204 South Main Street.

If you have any questions concerning this matter, please call.

Sincerely,

Jack H. Galbraith
Senior Planner

JHG:js

cc: Mr. Mearle D. Mason
810 W. Douglas
Wichita, Kansas 67203

EASEMENT

THIS EASEMENT made this 26th day of November, 1962,
 by and between _____
Clear Lakes, Inc.
 of the first part and the City of Wichita of the second part.

WITNESSETH: That the said first party, in consideration of the sum of One Dollar (\$1.00) and other valuable consideration, the receipt whereof is hereby acknowledged, do hereby grant and convey unto the said second party a perpetual right-of-way and easement for the purpose of constructing, maintaining, and repairing sewer pipes and a sewer system according to the plans and specifications now on file in the office of the City Engineer of the City of Wichita, Kansas, over, along and under the following described real estate situated in Sedgwick County, Kansas, to wit:

The south sixteen (16) feet of the north sixty-six (66) feet of the Northwest Quarter of Section 7, Township 27, South, Range 1, East of the 6th P. M., except the east one thousand four hundred ninety-eight and two hundredths (1498.02) feet.

And said second party is hereby granted the right to enter upon said premises at any time for the purpose of constructing, operating, maintaining, and repairing such sewer and sewer system.

IN WITNESS WHEREOF: The said first party y ha^s signed these presents the day and year first written.

Clear Lakes, Inc.

Don E. Satterthwaite
 Don E. Satterthwaite, Pres.
Mearle D. Mason
 Mearle D. Mason, Secretary.

STATE OF KANSAS)
 SEDGWICK COUNTY) SS

Personally appeared before me a notary public in and for the County and State aforesaid Don E. Satterthwaite and Mearle D. Mason

to me personally known to be the same person^s who executed the foregoing instrument of writing and said person^s duly acknowledged the execution



at Wichita, Kansas, this 26th day of November, 1962.

Carol F. Ellis
 Notary Public

EASEMENT

THIS EASEMENT made this 30th day of December, 1967,by and between Clear Lakes, Inc.

of the first part and the City of Wichita of the second part.

WITNESSETH: That the said first party, in consideration of the sum of One Dollar (\$1.00) and other valuable consideration, the receipt whereof is hereby acknowledged, do hereby grant and convey unto the said second party a perpetual right-of-way and easement for the purpose of constructing, maintaining, and repairing sewer pipes and a sewer system according to the plans and specifications now on file in the office of the City Engineer of the City of Wichita, Kansas, over, along and under the following described real estate situated in Sedgwick County, Kansas, to wit:

The north eight (8) feet of the west thirty (30) feet of Lot 2, Marina Lake Addition.

And said second party is hereby granted the right to enter upon said premises at any time for the purpose of constructing, operating, maintaining, and repairing such sewer and sewer system.

IN WITNESS WHEREOF: The said first party has signed these presents the day and year first written.

Clear Lakes, Inc.

Don E. Satterthwaite, Pres.
Don E. Satterthwaite, Pres.

Mearle D. Mason, Sec.
Mearle D. Mason, Sec.

STATE OF KANSAS)
SEDGWICK COUNTY) SS

Personally appeared before me a notary public in and for the County and State aforesaid Don E. Satterthwaite and Mearle D. Mason

to me personally known to be the same person who executed the foregoing instrument of writing and said person duly acknowledged the execution

at Wichita, Kansas, this 30th day of December, 1967.



Carol F. Ellis
Notary Public
Carol F. Ellis