

D-0447 - Phil Ruffin requests
DEDICATION of alley on the north
side of Harry Street in an area
between Seneca and Dodge Streets

POSTED
8-3-70

ACTION

	DATE
sb COMMITTEE	<u>Accept</u> <u>9-3-70</u>
M.A.P.C.	<u>Accept</u> <u>9-10-70</u>
B.C.C.	<u>Accept</u> <u>9-22-70</u>

15

DEDICATION REPORT AND PROGRESS
CASE No. D - 0447

MAP No. 5346
SEC. No. 30
TWP. No. 27
RANGE 1E

I. OFFER TO DEDICATE: Alley
GENERALLY LOCATED: On the north side of Harry Street in an area between Seneca and Dodge Streets

LEGALLY DESCRIBED AS:
The east 6 feet of Lot ~~43~~ 44, Block G, East University Addition, Wichita, Sedgwick County, Kansas

DEDICATED BY: Phil Ruffin
AGENT: James Guy
ADDRESS: 725 Sutton Place PHONE FO3-2261
PURPOSE OF DEDICATION:
To comply with BZA 19-70

II. SKETCH.

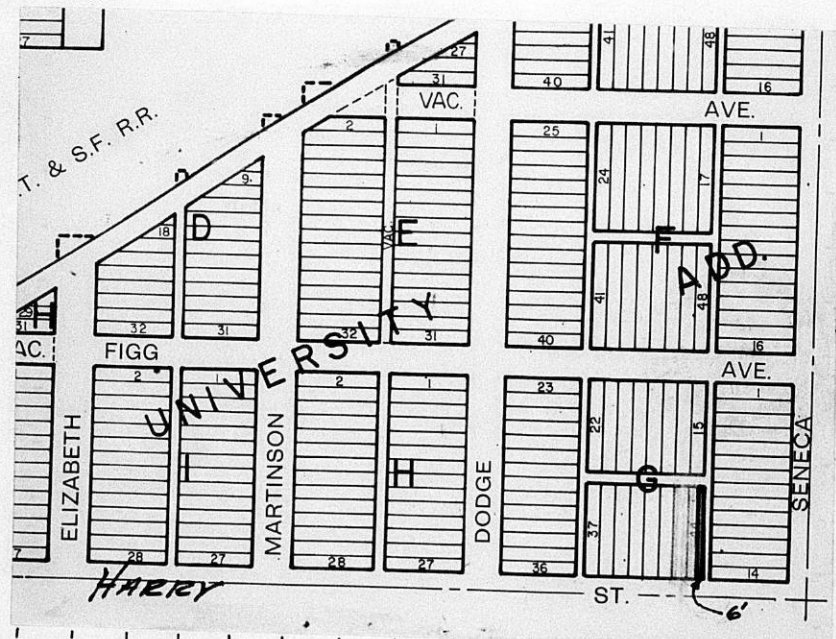

III. FILED 7-31-70
POSTED TO ATLAS 8-3-70
S/D COMM. ACTION 7-3-70 Accept
M.A.P.C. ACTION 9-10-70 Accept
B.C.C. ACTION 9-22-70 Accept
PLACED ON RECORD _____
CITY CLERKS No. _____

MAPC CASE NO. D-0447 Dedication of alley

Dedicated by: Phil G. and Lynne Ruffin

Generally North side of Harry Street in an
area between Seneca and Dodge Streets

This dedication is given for the following reason:

To comply with BZA Case 19-70

ACTION: Accept the dedication and instruct the City Clerk to
file with the Register of Deeds.

T9-325

September 4, 1970

Mr. & Mrs. Phil G. Ruffin
& Attorney James Guy
725 Sutton Place
Wichita, Kansas 67202

Subject: D-0447 - Dedication of
alley on north side of Harry in
an area between Seneca and Dodge
Streets.

Dear Mr. & Mrs. Ruffin:

At the regular meeting of the Subdivision Committee of the Metropolitan Area Planning Commission, September 3, 1970, the above captioned dedication request was considered. The action of the Committee was to recommend that this dedication be accepted.

This matter will be forwarded to the Metropolitan Area Planning Commission for its consideration at its regular meeting at 1:30 p.m., Thursday, September 10, 1970, in Room 401, City Building Annex, 104 South Main Street.

If you have any questions concerning this matter, please call.

Very truly yours,

Curtis L. Newby
Planning Analyst

CLN:rme

cc: James Guy, Attorney at Law
725 Sutton Place, 67202

KZA 14-70

DEDICATION

KNOW ALL MEN BY THESE PRESENTS:

That for and in consideration of the sum of One Dollar (\$1.00) and other good and valuable considerations, the receipt of which is hereby acknowledged, the undersigned, _____

Phil G. Ruffin and Lynne Ruffin, his wife

being the owners of the following described real estate in Sedgwick County, Kansas, to wit:

The East six (6) feet of Lot 44, Block G, East University Addition, Wichita, Sedgwick County, Kansas.

do _____ hereby dedicate the above described real estate to the public for _____ purposes.

Executed this 17th day of August 1970.

Phil G. Ruffin
Lynne Ruffin

STATE OF KANSAS)
SEDGWICK COUNTY) ss

BE IT REMEMBERED, that on this 17th day of August, 1970,
came Phil G. Ruffin and Lynne Ruffin

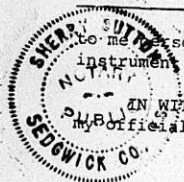

to me personally known to be the same persons who executed the foregoing instrument, and duly acknowledged the execution of the same.

IN WITNESS WHEREOF, I have hereunto subscribed my name and affixed my official seal, the day and year last above written.

Submitted to the Wichita-Sedgwick County Metropolitan Area Planning Commission and the Board of Commissioners of the City of Wichita, Kansas, and approved by said Board of Commissioners of the City of Wichita, Kansas,

this _____

City Clerk

Sherry Sutton
Notary Public

My Commission Expires: Jan 19, 1974