

D-0492 - Grace L. Shaffer Dedicate  
Street row on the W side of Rock  
Rd. in area between 39th & 47th  
St. South

for file  
2/9/72

ACTION

DATE

no leaving necessary

no leaving necessary

\*

B.C.C./P.O. accept 2-15-72

\* required by MAPC as condition of  
approval on CU-135

5942  
MAP No. K-9-A  
SEC. No. NE 1/4 18  
TWP. No. 28 S  
RANGE " 2 E

DEDICATION REPORT AND PROGRESS  
CASE No. D - 0492

I. OFFER TO DEDICATE: Street right-of-way  
GENERALLY LOCATED: On the west side of Rock Road in an area between  
39th and 47th Street South

LEGALLY DESCRIBED AS:

The east 60 feet of the east half of the northeast quarter of Section 18, Township 28 South, Range 2 East, except the north 712 feet and except the south 500 feet of the east 400 feet thereof, Sedgwick County, Kansas

DEDICATED BY: Grace L. Shaffer  
AGENT: Joe R. Betzen, et. al.  
ADDRESS: 4205 South Rock Road 67210 PHONE \_\_\_\_\_  
PURPOSE OF DEDICATION: \_\_\_\_\_

\* Condition of approval of Case No. CU-135

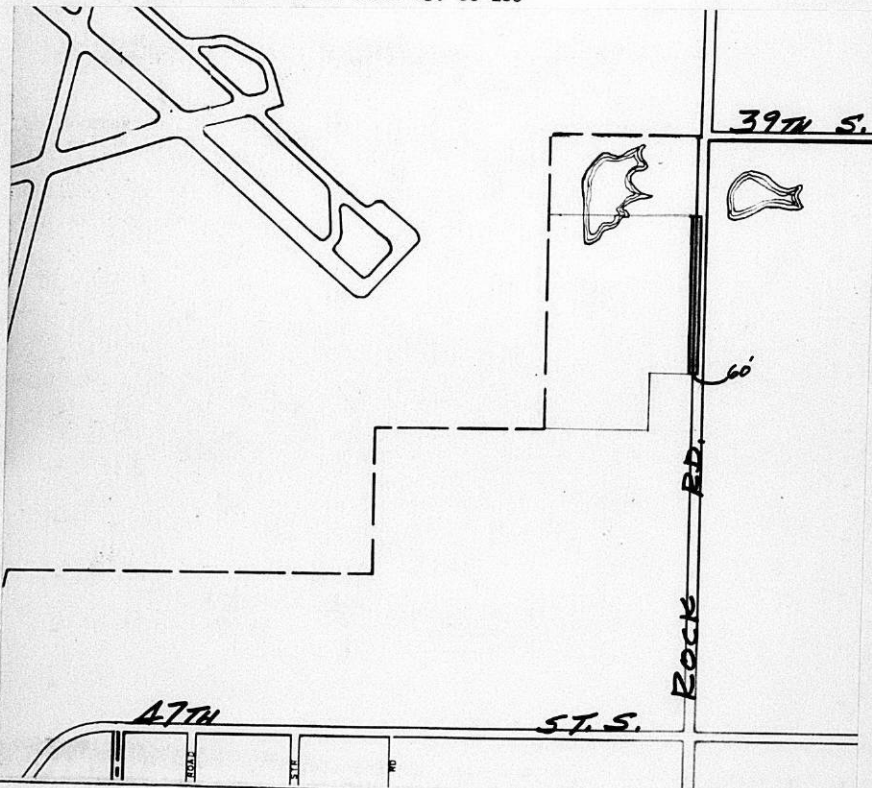

III. FILED 2-4-72 B.C.C. ACTION 2-15-72 accept  
POSTED TO ATLAS 2-9-72 S/D COMM. ACTION no hearing necessary PLACED ON RECORD \_\_\_\_\_  
M.A.P.C. ACTION no hearing necessary CITY CLERKS No. \_\_\_\_\_  
\* (SEE ABOVE)

MAPC CASE NO. D-0492    Dedication of    Street    Right-of-way

Dedicated by:    Grace L. Shaffer, Joseph R. Betzen and Ernest L. Nutsch

Generally    West side of Rock Road in an area  
                  between 39th and 47th Street South

This dedication is given for the following reason:

                  Condition of Approval of Case No. CU-135

**ACTION:**        Accept the dedication and instruct the City Clerk to  
                  file with the Register of Deeds.

T9-325

DEDICATION

KNOW ALL MEN BY THESE PRESENTS:

That for and in consideration of the sum of One Dollar (\$1.00) and other good and valuable considerations, the receipt of which is hereby acknowledged, the undersigned, Grace L. Shaffer

being the owner of the following described real estate in Sedgwick County, Kansas, to wit:

The east 60 feet of the east half of the Northeast quarter of Section 18, Township 28 South, Range 2 East, except the north 712 feet and except the south 500 feet of the east 400 feet thereof, Sedgwick County, Kansas.

do hereby dedicate the above described real estate to the public for \_\_\_\_\_ street purposes.

Executed this 3rd day of February 19 72.

Grace L. Shaffer

Joseph R. Betzen  
Ernest L. Nustock

STATE OF KANSAS )  
SEDGWICK COUNTY ) ss

BE IT REMEMBERED, that on this 3rd day of February, 1972,

came Grace L. Shaffer

to me personally known to be the same person who executed the foregoing instrument and duly acknowledged the execution of the same.

IN WITNESS WHEREOF, I have hereunto subscribed my name and affixed my official seal, the day and year last above written.

Submitted to the Wichita-Sedgwick County Metropolitan Area Planning Commission and the Board of Commissioners of the City of Wichita, Kansas, and approved by said Board of Commissioners of the City of Wichita, Kansas,

this \_\_\_\_\_

City Clerk

Alice M. Smith  
Notary Public  
Alice M. Smith

My Commission Expires: June 9, 1975

