

D-0617 - James Rich dedicates for
street right-of-way for west side
of Jackson East in an area so.
of Central.

POSTED
12-11-74

ACTION

DATE

NA

COMMITTEE

NA

M.A.P.C.

12-17-74

B.C.C. / ~~RECEIVED~~

Accepted

MAP No. 6247
 SEC. No. 22
 TWP. No. 27S
 RANGE 2E

DEDICATION REPORT AND PROGRESS

CASE No. D - 0617

I. OFFER TO DEDICATE: street right of way
 GENERALLY LOCATED: West side of Jackson East in an area south of Central

LEGALLY DESCRIBED AS:

The east 15 feet of the south 194 feet, Lot 9, Gilders Gardens, Sedgwick County, Kansas

DEDICATED BY: James and Patricia Rich
 AGENT: none
 ADDRESS: _____ PHONE _____
 PURPOSE OF DEDICATION: _____

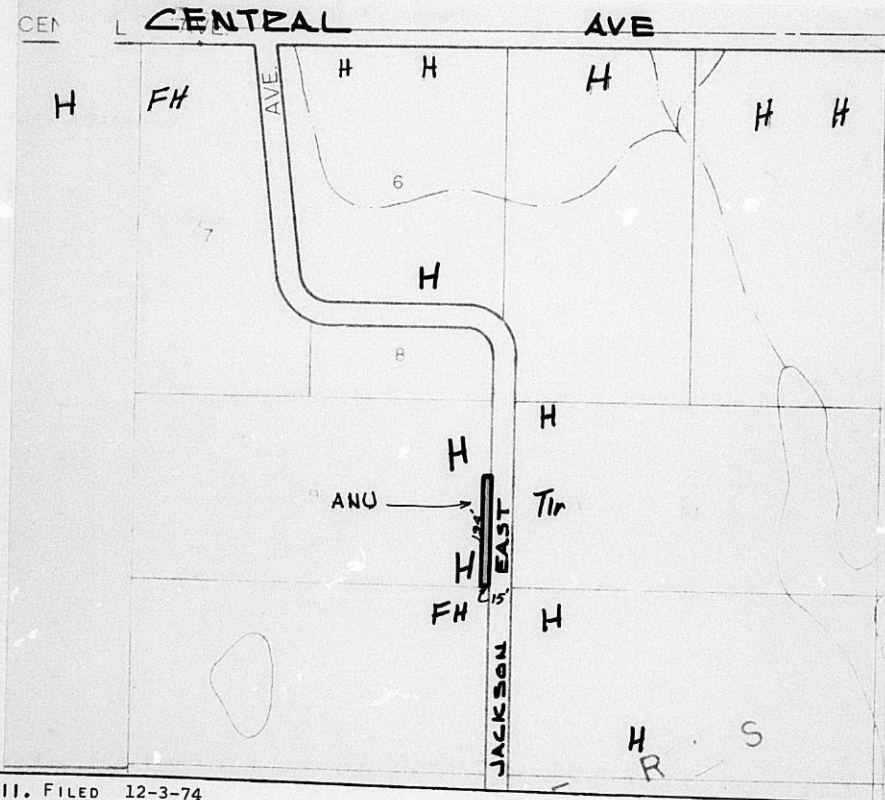

III. FILED 12-3-74
 POSTED TO ATLAS _____
 S/D COMM. ACTION _____
 M.A.P.C. ACTION _____

B.C.C. ACTION 12-17-74 Accepted
 PLACED ON RECORD _____
 CITY CLERKS No. _____

DEDICATION

KNOW ALL MEN BY THESE PRESENTS:

That for and in consideration of the sum of One Dollar (\$1.00) and other good and valuable considerations, the receipt of which is hereby acknowledged, the undersigned, James W. Rich and Patricia Sharon

being the owners of the following described real estate in Sedgwick County, Kansas, to wit:

The east 15 feet of the south 194 ft., Lot 9, Gilders Garsens, Sedgwick County, Kansas.

do hereby dedicate the above described real estate to the public for street right-of-way purposes.

Executed this _____ day of _____ 19 ____.

James W. Rich _____
Patricia Sharon Rich _____

STATE OF KANSAS)
SEDGWICK COUNTY) ss

BE IT REMEMBERED, that on this 2 day of December 1974,
came _____ James W. Rich and Patricia Sharon

to me personally known to be the same person who executed the foregoing instrument and duly acknowledged the execution of the same.

IN WITNESS WHEREOF, I have hereunto subscribed my name and affixed my official seal, the day and year last above written.

Submitted to the Wichita-Sedgwick County Metropolitan Area Planning Commission and the Board of Commissioners of the City of Wichita, Kansas, and approved by said Board of Commissioners of the City of Wichita, Kansas,

this _____,

City Clerk

Samuel E. Trummel
Notary Public

My Commission Expires: _____

SAMUEL E. TRUMMEL
STATE NOTARY PUBLIC
SEDGWICK COUNTY, KANSAS
MY COMM. EXP. SEPT. 16, 1978

MAPC CASE NO. D-0617 Dedication of street right-of-way

Dedicated by: James W. and Patricia Sharon Rich

Generally West side of Jackson East in an
 area south of Central

This dedication is given for the following reason:
for street right-of-way required as a condition
of approval of a Conditional Use application

ACTION: Accept the dedication and instruct the City Clerk to
 file with the Register of Deeds.

T9-325

DEDICATION

KNOW ALL MEN BY THESE PRESENTS:

That for and in consideration of the sum of One Dollar (\$1.00) and other good and valuable considerations, the receipt of which is hereby acknowledged, the undersigned, James W. Rich and Patricia Sharon

being the owners of the following described real estate in Sedgwick County, Kansas, to wit:

The east 15 feet of the south 194 ft., Lot 9, Gilders Garsens, Sedgwick County, Kansas.

do hereby dedicate the above described real estate to the public for street right-of-way purposes.

Executed this _____ day of _____ 19 ____.

James W. Rich
Patricia Sharon Rich

STATE OF KANSAS)
SEDGWICK COUNTY) ss

BE IT REMEMBERED, that on this 2 day of December 1974, came James W. Rich and Patricia Sharon

to me personally known to be the same person who executed the foregoing instrument and duly acknowledged the execution of the same.

IN WITNESS WHEREOF, I have hereunto subscribed my name and affixed my official seal, the day and year last above written.

Submitted to the Wichita-Sedgwick County Metropolitan Area Planning Commission and the Board of Commissioners of the City of Wichita, Kansas, and approved by said Board of Commissioners of the City of Wichita, Kansas,

this _____,

City Clerk

Samuel E. Trummel
Notary Public

My Commission Expires: _____

SAMUEL E. TRUMMEL
STATE NOTARY PUBLIC
SEDGWICK COUNTY, KANSAS
MY COMM. EXP. SEPT. 16, 1978