

D-0648 - White & Lambert Inv. Inc., A Kansas Corporation, requests an easement on the West side of Sheridan and North of May.

*Porter
8-29-75*

ACTION

	COMMITTEE	DATE
S/D	<u>Accepted</u>	<u>9-4-75</u>
	<u>M.A.P.C.</u>	<u>9-11-75</u>
	<u>B.C.C./B.C.C.</u>	<u>9-30-75</u>

DEDICATION REPORT AND PROGRESS

MAP No. 5245
SEC. No. 36
TWP. No. 27S
RANGE 1W

CASE No. D - 0648

I. OFFER TO DEDICATE: Easement
GENERALLY LOCATED: west side of Sheridan and north of May.

LEGALLY DESCRIBED AS:

DEDICATED BY: White and Lambert Investments, Inc. a Kansas Corporation
AGENT: _____
ADDRESS: _____ PHONE _____
PURPOSE OF DEDICATION: _____

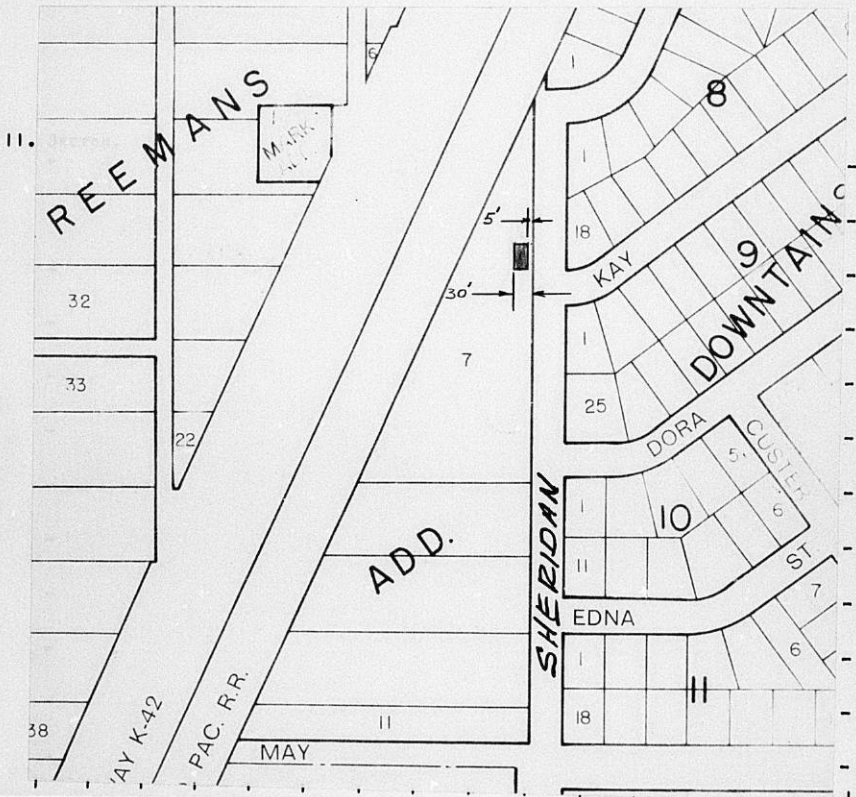

III. FILED 8-25-75
POSTED TO ATLAS 8-29-75
S/D COMM. ACTION 9-4-75 accept
M.A.P.C. ACTION 9-11-75 accepted

B.C.C. ACTION 9/30/75 accepted
PLACED ON RECORD _____
CITY CLERKS No. _____

MAPC CASE NO. D-0648 Dedication of easement

Dedicated by: White and Lambert Investments, Inc.

Generally located on the west side of Sheridan and north of May

This dedication is given for the following reason:

-REQUIREMENT OF LOT SPLIT APPROVAL

ACTION: Accept the dedication and instruct the City Clerk to file with the Register of Deeds.

T9-325

September 5, 1975

White and Lambert Investments, Inc.
c/o Walter W. White
1144 South Broadway
Wichita, Kansas 67211

Re: D-0648 - vacation of an
easement on the west side
of Sheridan and north of
May.

Gentlemen:

This is to advise you that on September 4, 1975, the Subdivision Committee of the Metropolitan Area Planning Commission, recommended that your easement dedication be accepted. Representatives from Kansas Gas & Electric Company at the meeting requested that you contact their office relative to the location of their utility poles which may need to be relocated.

Your dedication case will be considered by the Planning Commission at their meeting, Thursday, September 11, 1975, at 1:30 p.m., Room 401, City Building Annex, 104 South Main.

If you have any questions concerning this matter, please call.

Sincerely,

Curtis L. Newby
Junior Planner

CLN:rme

cc: Robert Blevins, Kansas Gas & Electric
Estimating Dept., P. O. Box 208, 67201

George Wilton, Superintendent, Public Works Maintenance

Newby

EASEMENT

THIS EASEMENT made this 1st day of August, 19 75,
by and between White and Lambert Investments, Inc., a Kansas Corporation
of the first part and the City of Wichita, of the second part.

WITNESSETH: That the said first part y, in consideration of the sum of One Dollar (\$1.00) and other valuable consideration, the receipt whereof is hereby acknowledged, do hereby grant and convey unto the said second party a perpetual right-of-way and easement for the purpose of constructing, maintaining, and repairing sewer and all other public utilities, over, along and under the following described real estate situated in Sedgwick County, Kansas, to wit:

The west 25 feet of the east 30 feet of the north 45 feet of the south 419.34 feet of Lot 7, Freeman's Addition to Wichita, Kansas.

And said second party is hereby granted the right to enter upon said premises at any time for the purpose of constructing, operating, maintaining, and repairing such sewer and all other public utilities.

IN WITNESS WHEREOF: The said first part y ha s signed these presents the day and year first written.

WHITE AND LAMBERT INVESTMENTS, INC.

Walter W. White
Walter W. White President

Isador R. Lambert Sec
Isador R. Lambert Secretary



STATE OF KANSAS)
SEDGWICK COUNTY) SS

Personally appeared before me a notary public in and for the County and State aforesaid Walter W. White, President of White and Lambert Investments, Inc. to me personally known to be the same person who executed the foregoing instrument of writing and said person duly acknowledged the execution thereof.

Dated at Wichita, Kansas, this 1st day of August, 19 75.



Helen I. Connell
Notary Public
Helen I. Connell

(My Commission expires November 20, 1977)

New by

EASEMENT

THIS EASEMENT made this 1st day of August, 1975,
by and between White and Lambert Investments, Inc., a Kansas Corporation
of the first part and the City of Wichita, of the second part.

WITNESSETH: That the said first part y, in consideration of the sum of One Dollar (\$1.00) and other valuable consideration, the receipt whereof is hereby acknowledged, do hereby grant and convey unto the said second party a perpetual right-of-way and easement for the purpose of constructing, maintaining, and repairing sewer and all other public utilities, over, along and under the following described real estate situated in Sedgwick County, Kansas, to wit:

The west 25 feet of the east 30 feet of the north 45 feet of the south 419.34 feet of Lot 7, Freeman's Addition to Wichita, Kansas.

And said second party is hereby granted the right to enter upon said premises at any time for the purpose of constructing, operating, maintaining, and repairing such sewer and all other public utilities.

IN WITNESS WHEREOF: The said first part y ha s signed these presents the day and year first written.

WHITE AND LAMBERT INVESTMENTS, INC.

Walter W. White

Walter W. White President

Isador R. Lambert Sec

Isador R. Lambert Secretary



STATE OF KANSAS)
SEDGWICK COUNTY) SS

Personally appeared before me a notary public in and for the County and State aforesaid Walter W. White, President of White and Lambert Investments, Inc. to me personally known to be the same person who executed the foregoing instrument of writing and said person duly acknowledged the execution thereof.

Dated at Wichita, Kansas, this 1st day of August, 1975.



(My Commission expires November 20, 1977)

Helen I. Connell
Notary Public
Helen I. Connell