

D-0784 - Cerebral Palsy Research  
Foundation dedicates street r-o-w  
on Battin, south of Shadybrook

*Posted  
9-9-77*

**ACTION**

DATE

COMMITTEE \_\_\_\_\_

M.A.P.C. \_\_\_\_\_

B.C.C./B. CO. C. *Accepted* *9-13-77*

DEDICATION REPORT AND PROGRESS

MAP No. 5849  
 SEC. No. 12  
 TWP. No. 27  
 RANGE 1E

CASE No. D - 0784

I. OFFER TO DEDICATE: Street r-o-w  
 GENERALLY LOCATED: on Battin, south of Shadybrook  
 LEGALLY DESCRIBED AS: \_\_\_\_\_

DEDICATED BY: Cerebral Palsy Research Foundation  
 AGENT: \_\_\_\_\_  
 ADDRESS: \_\_\_\_\_ PHONE \_\_\_\_\_  
 PURPOSE OF DEDICATION: \_\_\_\_\_

*Associated with V-0827*

II. SKETCH.

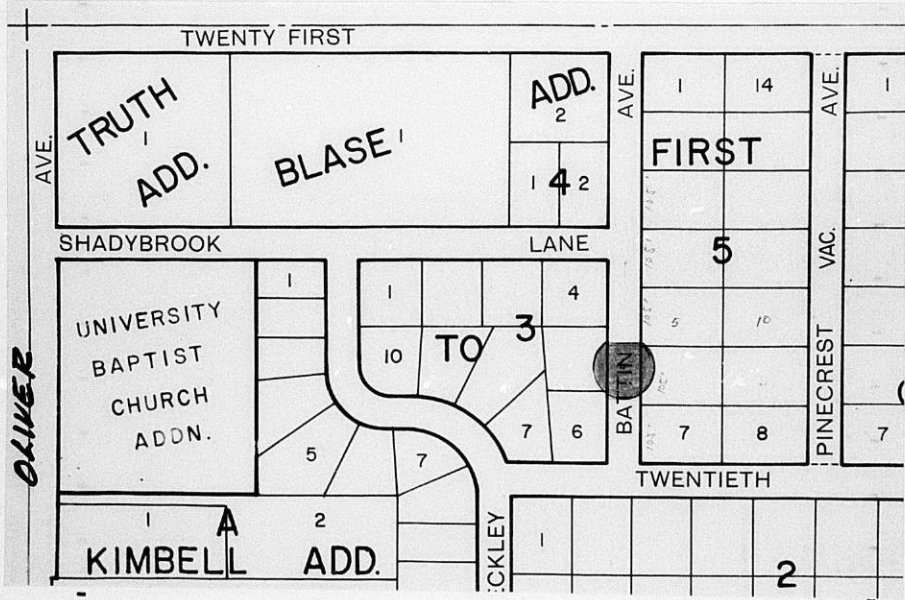

III. FILED 8-31-77  
 POSTED TO ATLAS \_\_\_\_\_  
 S/D COMM. ACTION \_\_\_\_\_  
 M.A.P.C. ACTION \_\_\_\_\_

B.P.C. ACTION 9-13-77 *Completed*  
 PLACED ON RECORD \_\_\_\_\_  
 CITY CLERK'S No. \_\_\_\_\_

5849  
12  
32  
15

DEDICATION

D-0784

KNOW ALL MEN BY THESE PRESENTS:

That for and in consideration of the sum of One Dollar (\$1.00) and other good and valuable considerations, the receipt of which is hereby acknowledged, the undersigned, CEREBRAL PALSY RESEARCH FOUNDATION OF KANSAS, INC.

being the owner of the following described real estate in Sedgwick County, Kansas, to wit:

A 50-foot Cul-de-Sac on that portion of vacated Battin Avenue between Blocks 3 and 5 as platted in First Addition to Crestview Heights, Wichita, Kansas, and whose radius point is located at the centerline of Battin Avenue 40 feet south of the west extension of the south line of Lots 5 and 10, Block 5 in said First Addition to Crestview Heights.

See attached sketch.

*generally located on Battin, South of Shadybrook*

do es hereby dedicate the above described real estate to the public for street purposes.

Executed this 31st day of August 19 77.

CEREBRAL PALSY RESEARCH FOUNDATION OF KANSAS, INC.

Daniel M. Carney President  
Patrick J. Regan Secretary

STATE OF KANSAS )  
SEDGWICK COUNTY ) ss

BE IT REMEMBERED, that on this 31st day of August, 1977, came DANIEL M. CARNEY AND PATRICK J. REGAN

to me personally known to be the same persons who executed the foregoing instrument and duly acknowledged the execution of the same.

IN WITNESS WHEREOF, I have hereunto subscribed my name and affixed my official seal, the day and year last above written.

Submitted to the Wichita-Sedgwick County Metropolitan Area Planning Commission and the Board of Commissioners of the City of Wichita, Kansas, and approved by said Board of Commissioners of the City of Wichita, Kansas,

this \_\_\_\_\_  
\_\_\_\_\_  
City Clerk

Lucille M. Owen  
Notary Public

My Commission Expires: 1/22/81



