

D-0919- Dick R. Matthes & Raymond
C. Trimble dedicate street r-o-w
on the South side of Douglas, in
an area between Circle Drive
and Clifton.

1
RECEIVED
10-8-79

ACTION

COMMITTEE _____ DATE _____

M.A.P.C. _____

B.C.C./B.C.C.C. Receipt 10-23-79

MAP No. 5747
SEC. No. 23
TWP. No. 27
RANGE 1E

DEDICATION REPORT AND PROGRESS

CASE No. D - 0919

(ASSOCIATED CASE: Z-2182)

I. OFFER TO DEDICATE: street r-o-w
GENERALLY LOCATED: South side of Douglas, in an area between Circle Drive and Clifton
LEGALLY DESCRIBED AS: _____

DEDICATED BY: Dick R. Matthes and Raymond C. Trimble
AGENT: _____
ADDRESS: _____ PHONE _____
PURPOSE OF DEDICATION: _____

II. SKETCH.

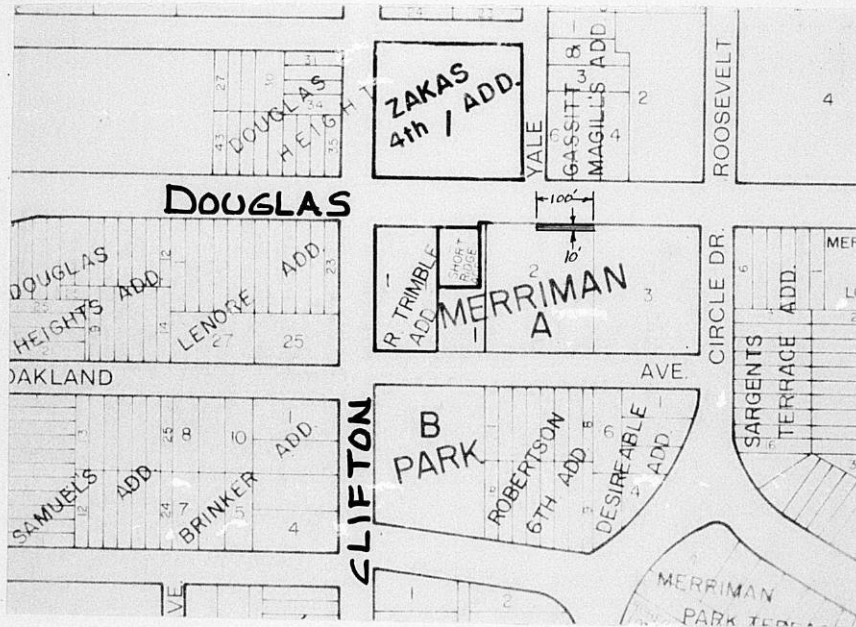

FILED 10-5-79
POSTED TO ATLAS _____
S/D COMM. ACTION _____
M.A.P.C. ACTION _____

B.C.C. ACTION 10-23-79 *Ampt*
PLACED ON RECORD _____
CITY CLERKS No. _____

5747
23
27
1E

D E D I C A T I O N

D-0919

(assn. 2-2182)

KNOW ALL MEN BY THESE PRESENTS:

That for and in consideration of the sum of One Dollar (\$1.00) and other good and valuable considerations, the receipt of which is hereby

acknowledged, the undersigned, DICK R. MATTHES and RAYMOND C. TRIMBLE

being the owners of the following described real estate in Sedgwick County, Kansas, to wit:

The north 10 feet of the east 100 feet of Lot 2, Block A, Merriman Park Addition, Wichita, Sedgwick County, Kansas.

do hereby dedicate the above described real estate to the public for street purposes.

Executed this 1st day of October 19 79.

Raymond C. Trimble
Dick R. Matthes

STATE OF KANSAS)
SEDGWICK COUNTY)^{ss}

BE IT REMEMBERED, that on this 1st day of OCTOBER 1979,

came DICK R. MATTHES and RAYMOND C. TRIMBLE

to me personally known to be the same persons who executed the foregoing instrument and duly acknowledged the execution of the same.

IN WITNESS WHEREOF, I have hereunto subscribed my name and affixed my official seal, the day and year last above written.

Submitted to the Wichita-Sedgwick County Metropolitan Area Planning Commission and the Board of Commissioners of the City of Wichita, Kansas, and approved by said Board of Commissioners of the City of Wichita, Kansas,
this _____,

City Clerk

Gayle M. Rowler
Notary Public

My Commission Expires: 8/23/82