

D-0991 - Donald R. Mayer, Etux -
Dedicate Street R-O-W - generally
located on the west side of Hill-
side, in an area between Gilbert
and Morris.

ACTION

DATE

COMMITTEE _____

M.A.P.C. _____

R.C.C./B.C.C. Accepted 1-13-81

POSTED
1-12-81
[Signature]

DEDICATION REPORT AND PROGRESS

MAP No. 5646A
 SEC. No. 22
 TWP. No. 27
 RANGE 1E

CASE No. D - 0991

ASSOCIATED CASE NO. Z-2287

I. OFFER TO DEDICATE: Street r-o-w
 GENERALLY LOCATED: on the west side of Hillside, in an area between
Gilbert and Morris

LEGALLY DESCRIBED AS:

DEDICATED BY: Donald R. & Frances L. Mayer, 233 N Hillside, 67214 681-3479

AGENT: _____ PHONE _____

ADDRESS: _____

PURPOSE OF DEDICATION:

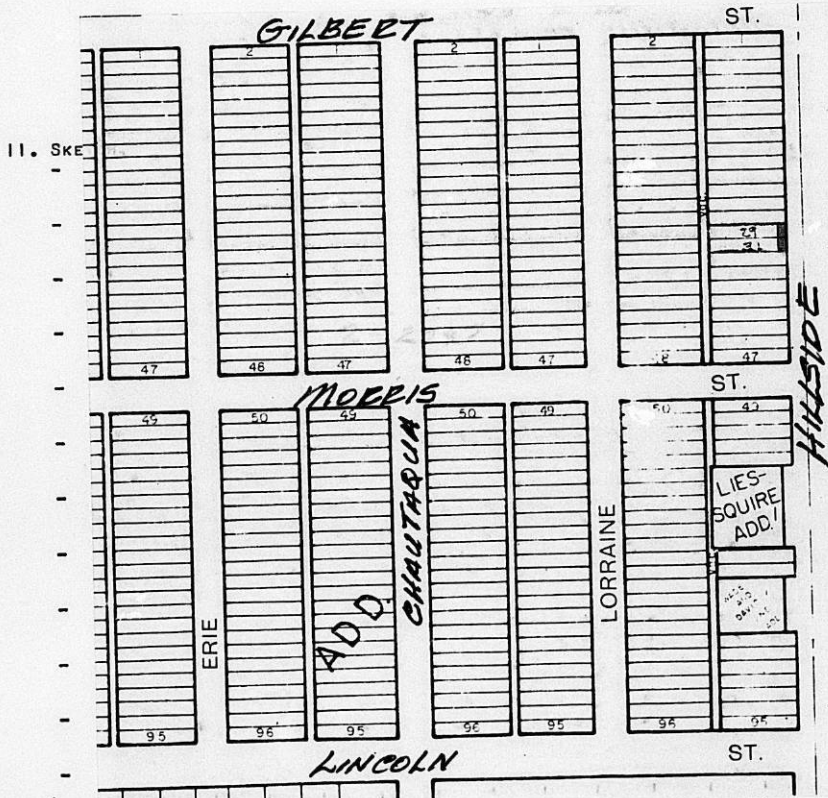

III. FILED 1-7-81
 POSTED TO ATLAS _____
 S/D COMM. ACTION _____
 M.A.P.C. ACTION _____

B.C.C. ACTION 1-13-81 *Accepted*
 PLACED ON RECORD _____
 CITY CLERKS No. _____

January 7, 1981

Donald C. Gisick, City Clerk

Jack H. Galbraith, Chief Planner

Z-2287 - Zone change "A" to "BB" - Generally located on the west side of Hillside, in an area between Gilbert and Morris.

On November 18, 1980, the Board of City Commissioners considered and approved the above captioned case, subject to the dedication of 20 feet of street right-of-way for Hillside, with instructions to the Planning Department to forward the ordinance for first reading at such time as the dedication was forwarded.

Attached is the dedication (Case No. D-0991) of street right-of-way which should be placed on the Clerk's Agenda for consideration by the Board of City Commissioners on their meeting of January 13, 1981. Also attached is the appropriate ordinance for the zone change which should be placed on that same agenda.

If you have any questions, please call.

Jack H. Galbraith
Chief Planner

JHG:GLS:el

Attachments

5646A
22
27
1E

DEDICATION

D0991
(assess 2-22-87)

KNOW ALL MEN BY THESE PRESENTS:

That for and in consideration of the sum of One Dollar (\$1.00) and other good and valuable considerations, the receipt of which is hereby acknowledged, the undersigned, Donald R. Mayer and Frances L. Mayer

being the owner of the following described real estate in Sedgwick County, Kansas, to wit:

East 20 feet of Lots 29 and 31, on Hillside Avenue, in Second Sunny-Side Addition to the City of Wichita, Sedgwick County, Kansas.

do hereby dedicate the above described real estate to the public for street purposes.

Executed this 2nd day of January 19 81.

Donald R. Mayer, DD
Donald R. Mayer

Frances L. Mayer
Frances L. Mayer

STATE OF KANSAS)
SEDGWICK COUNTY) ss

BE IT REMEMBERED, that on this 2nd day of January, 1981,
came Donald R. Mayer and Frances L. Mayer, husband and wife

to me personally known to be the same person s who executed the foregoing instrument and duly acknowledged the execution of the same.

IN WITNESS WHEREOF, I have hereunto subscribed my name and affixed my official seal, the day and year last above written.

Submitted to the Wichita-Sedgwick County Metropolitan Area Planning Commission and the Board of Commissioners of the City of Wichita, Kansas, and approved by said Board of Commissioners of the City of Wichita, Kansas,
this _____,

City Clerk

Prata M. Staben
Notary Public

My Commission Expires: 3-15-83

Letitia M. Staben
Notary Public
Sedgwick County, Kansas
My Commission Expires 3-15-83