

D-1470 - HCA Health Services of Kansas, Inc. grants additional right-of-way for Murdock, between Hillside and Lorraine.

Posted 9-15-87
KCL ✓

ENB

ACTION

DATE

COMMITTEE

M.A.P.C.

~~H.C.C.~~

8-25-87

accepted

DEDICATION REPORT AND PROGRESS

MAP NO. 5648 B
SEC. NO.
TWP. NO.
RANGE

CASE NO.: D-1470

ASSOCIATED CASE: Z-2857

1. OFFER TO DEDICATE: Additional right-of-way.
GENERALLY LOCATED: Between Hillside and Lorraine.
LEGALLY DESCRIBED AS:

The north five feet of Lot 50 on Lorraine Avenue in resurvey of Buck's 2nd Addition to Wichita, except the west 86.5 feet thereof.

DEDICATED BY: HCA Health Services of Kansas, Inc.

PURPOSE OF DEDICATION:

II. SKETCH.

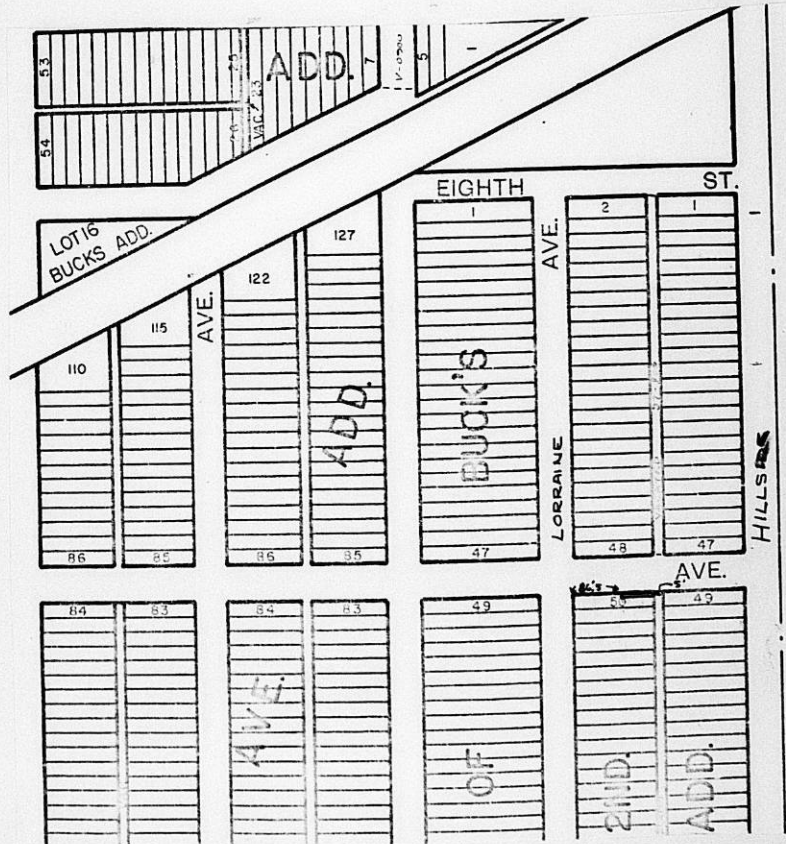

III. FILED _____ 7/31/87 _____
POSTED TO ATLAS _____
S/D COMM. ACTION _____
M.A.P.C. ACTION _____

B.C.C. ACTION _____
PLACED ON RECORD _____
CITY CLERKS NO. _____

Assoc. w/ Z-2857
Map 5648B
WCC accepted 8-25-87

DEDICATION

Add'l v.o.w. for
Murlock between
Hollide & Lorraine

1470

KNOW ALL MEN BY THESE PRESENTS:

That for and in consideration of the sum of One Dollar (\$1.00) and other good and valuable considerations, the receipt of which is hereby acknowledged, the undersigned, HCA Health Services of Kansas Inc.

being the owner of the following described real estate in Sedgwick County, Kansas, to wit:

The north five feet of Lot 50 on Lorraine Avenue in Resurvey of Buck's 2nd Addition to Wichita, except the west 86.5 feet thereof.

do hereby dedicate the above-described real estate to the public for street purposes.

Executed this 31st day of July, 1987.

Joseph L. DiLorenzo
Joseph L. DiLorenzo, President
HCA Health Services of Kansas, Inc.

STATE OF TENNESSEE
DAVIDSON COUNTY, SS

BE IT REMEMBERED, that on this 31 day of July, 1987,

came Mr. Joseph L. DiLorenzo, President, HCA Health Services of Kansas, Inc.

to me personally known to be the same person who executed the foregoing instrument and duly acknowledged the execution of the same.

IN WITNESS WHEREOF, I have hereunto subscribed my name and affixed my official seal, the day and year last above-written.

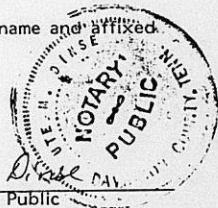

My Commission Expires: March 8, 1989

Submitted to the Wichita-Sedgwick County Metropolitan Area Planning Commission and the City Council of the City of Wichita, Kansas, and approved by said City Council of the City of Wichita, Kansas,
this _____,

City Clerk