

D-1033 - Earl G. Powell, Etux
dedicate a storm sewer easement
on the east side of St. Francis, in
an area south of Pawnee.

POSTED
7-24-81

ACTION

DATE 7-23-81
S/D COMMITTEE Sperrin
M.A.P.C. accept 7-30-81
B.C.C./B.-CO. C. Approved 8-11-81

DEDICATION REPORT AND PROGRESS

MAP No. 5544D
 SEC. No. 4
 TWP. No. 28
 RANGE 1E

CASE No. D - 1033

ASSOCIATED CASE NO. _____

I. OFFER TO DEDICATE: Storm sewer easement
 GENERALLY LOCATED: on the east side of St. Francis, in an area south of Pawnee

LEGALLY DESCRIBED AS: _____

DEDICATED BY: Earl G. & Evelyn Powell

AGENT: _____

ADDRESS: _____ PHONE _____

PURPOSE OF DEDICATION: _____

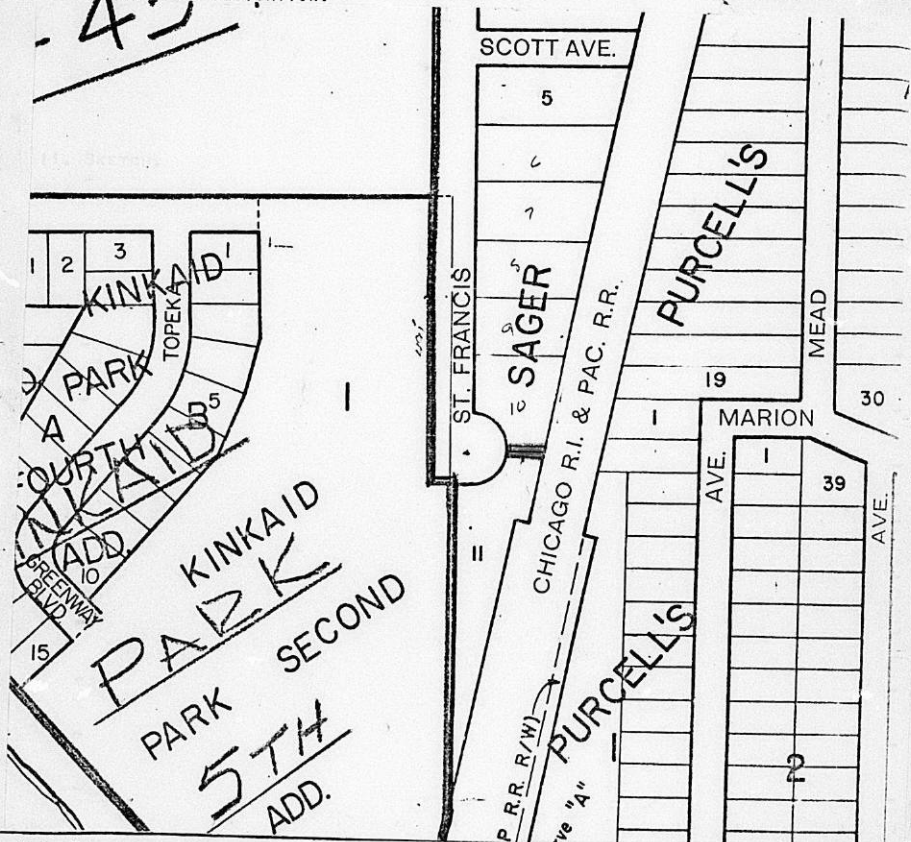

III. FILED 7-17-81
 POSTED TO ATLAS accept
 S/D COMM. ACTION 7-23-81 accept
 M.A.P.C. ACTION 7-30-81 accept

B.C.C. ACTION 8-11-81 Approved
 PLACED ON RECORD _____
 CITY CLERKS No. _____

MAPC CASE NO. D-1033 Dedication of storm sewer easement

Dedicated by: Earl G. and Evelyn Powell

Generally located on the east side of St. Francis in an area south of
Pawnee.

This dedication is given for the following reason:
needed for installation of storm sewer

ACTION: Accept the dedication and instruct the City Clerk to
file with the Register of Deeds.

BILL RECORDING FEE TO: 472-76-245-80244-000-000-001

472-76-245-80244-000-000-001

FORM KB-017

STORM SEWER
EASEMENT

D-1033

THIS EASEMENT made this 19 day of June, 1981,
by and between Earl G. and Evelyn Powell
of the first part and the City of Wichita of the second part.

WITNESSETH: That the said first party, in consideration of the sum of One Dollar (\$1.00) and other valuable consideration, the receipt whereof is hereby acknowledged, do hereby grant and convey unto the said second party a perpetual right-of-way and easement for the purpose of constructing, maintaining, and repairing sewer pipes and a sewer system, over, along and under the following described real estate situated in Sedgwick County, Kansas, to wit:

A strip of land 20.0' in width being 10.0' on either side of the lot line common to Lots 10 and 11 in Sager Addition to Wichita, Sedgwick County, Kansas.

And said second party is hereby granted the right to enter upon said promises at any time for the purpose of constructing, operating, maintaining, and repairing such sewer and sewer system.

IN WITNESS WHEREOF: The said first party has signed these presents the day and year first written.

Earl G. Powell
Earl G. Powell
Evelyn Powell
Evelyn Powell

STATE OF KANSAS)
SEDGWICK COUNTY) SS

Personally appeared before me a notary public in and for the County and State aforesaid Sedgwick County, Kansas Earl G. Powell & Evelyn Powell to me personally known to be the same person S who executed the foregoing instrument of writing and said person S duly acknowledged the execution thereof.

Dated at Wichita, Kansas, this 19 day of June, 1981.

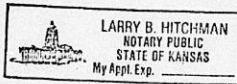

Larry B. Hitchman
Notary Public

My Commission Expires Dec 24, 1984

THE CITY OF WICHITA

OFFICE OF ENGINEERING

DATE JULY 16, 1981

TO LOUISE OLIVAREZ, CURRENT PLANS - PLANNING DEPARTMENT

FROM STEVE LACKEY, PAVEMENT DESIGN ENGINEER

SUBJECT PERMANENT DRAINAGE EASEMENT

ST. FRANCIS FROM THE NORTH
LINE OF KINKAID PARK FIFTH
ADDITION TO AND INCLUDING
CUL-DE-SAC

#472 76 245 80244 000 000 001

Attached is Permanent Drainage Easement between Earl G. & Evelyn Powell and the City of Wichita. After your review, please forward to the City Clerk's Office to be filed and recorded.

Steve Lackey
Steve Lackey, P.E.
Pavement Design Engineer

SL/dla

Attachment

5/10 7-23 ACC 2-11

RECEIVED

JUL 16 1981

METROPOLITAN PLANNING
ROUTE *Planning*