

D-1037 - Larry Schneider grants  
additional utility easement, gen-  
erally located on the east side  
of Boyd, in an area north of Elm.

45 05 15  
12-1037

8-10-81

*Post*  
*18-15-81*

# ACTION

DATE

8-22-81

accept

S/D COMMITTEE

8-27-81

accept

M.A.P.C.

9-8-81

Accepted

B.C.C./B.C.U.C.

45 0515  
17-1037

DEDICATION REPORT AND PROGRESS

MAP No. 5048  
 SEC. No. 15  
 TWP. No. 27  
 RANGE 1W

CASE No. D - 1037

ASSOCIATED CASE NO. L/S-0515

I. OFFER TO DEDICATE: Additional Utility Easement  
 GENERALLY LOCATED: On the east side of Boyd, in an area north of Elm.

LEGALLY DESCRIBED AS:

DEDICATED BY: Larry Schneider  
 AGENT: \_\_\_\_\_  
 ADDRESS: \_\_\_\_\_ PHONE \_\_\_\_\_  
 PURPOSE OF DEDICATION: \_\_\_\_\_

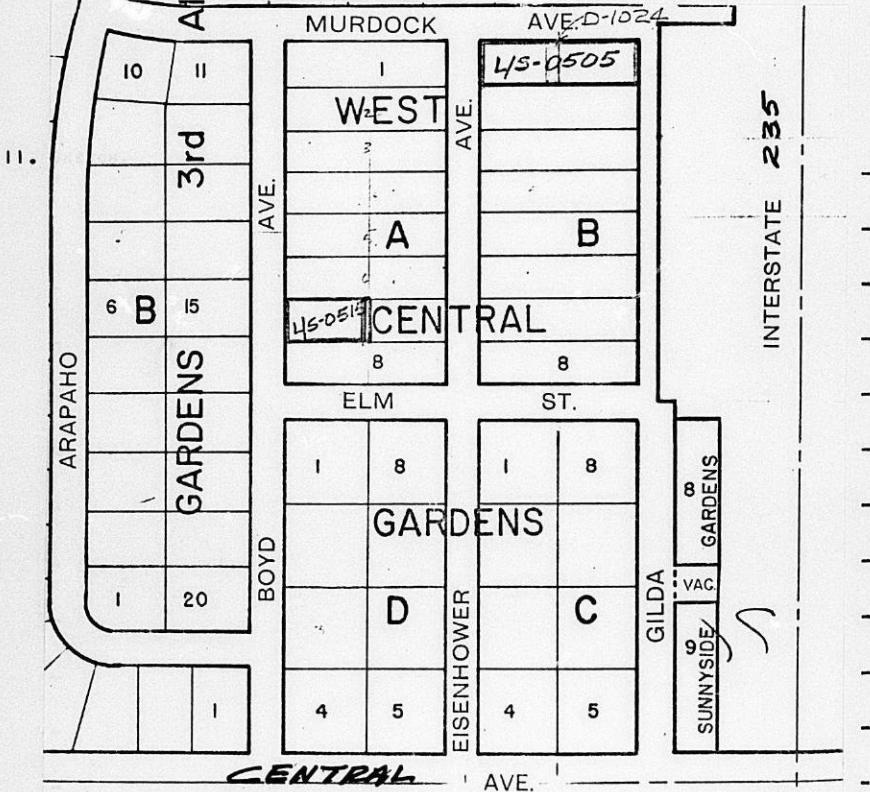

III. FILED 8-10-81  
 POSTED TO ATLAS \_\_\_\_\_  
 S/D COMM. ACTION 8-20-81 accept  
 M.A.P.C. ACTION 8-27-81 accept

B.C.C. ACTION 9-8-81 Accepted  
 PLACED ON RECORD \_\_\_\_\_  
 CITY CLERKS No. \_\_\_\_\_

COSTS TO BE PAID BY: Larry Schneider  
3501 W. Fairhaven  
Wichita, Ks. ~~67211~~

MAPC CASE NO. D-1037      Dedication of utility easement

Dedicated by: Larry D. Schneider

Generally located: on the east side of Boyd in an area north of Elm.

This dedication is given for the following reason:  
lot split requirement

**ACTION:**            Accept the dedication and instruct the City Clerk to  
file with the Register of Deeds.

**BILL RECORDING FEE TO:** Larry Schneider  
**Address:**            3501 W. Fairhaven  
Wichita, Kansas 67217

5048  
15  
27  
1W

EASEMENT

D-10 37

THIS EASEMENT made this 25th day of June,

19 81, by and between SCHNEIDER INVESTMENT CORPORATION, Larry D. Schneider, President,  
of the first part and the City of Wichita, of the second part.

WITNESSETH: That the said first party, in consideration of the sum of One Dollar (\$1.00) and other valuable consideration, the receipt whereof is hereby acknowledged, does hereby grant and convey unto the said second party a perpetual right-of-way and easement for the purpose of constructing, maintaining, and repairing sewer and all other public utilities, over, along and under the following described real estate situated in Sedgwick County, Kansas, to wit:

the West 2 feet of the East 10 Feet of the West 1/4 of Lot 7, Block A, WEST CENTRAL GARDENS, Sedgwick County, Kansas.

And said second party is hereby granted the right to enter upon said premises at any time for the purpose of constructing, operating, maintaining, and repairing such sewer and all other public utilities.

IN WITNESS WHEREOF: The said first party has signed these presents the day and year first written.

SCHNEIDER INVESTMENT CORPORATION

Larry D. Schneider, President  
LARRY D. SCHNEIDER

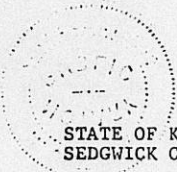

STATE OF KANSAS)  
SEDGWICK COUNTY) SS

Be it remembered that on this 4th day of August, 1981, before me, a notary public in and for said County and State, came Larry D. Schneider to me personally known to be the same person(s) who executed the foregoing instrument of writing and duly acknowledged the execution of same. In testimony whereof I have hereunto set my hand and affixed my notarial seal the day and year above written.



M. J. Edwards  
Notary Public

Commission expires: Jan. 28, 1985