

D-1070 - Beverly J. Davis grants
additional utility easement on
Lot 16, WEST RIDGE ACRES - Gener-
ally located between Westridge
Drive and Joann.

21
22

ACTION

POSTED
4-6-82

S/D COMMITTEE Receipt DATE 4-15-82
M.A.P.C. Receipt 4-22-82
R.C.C./B-GO-C. Receipt 5-4-82

D-1
add
Lot
all
Dr

DEDICATION REPORT AND PROGRESS

MAP No. 5248C
 SEC. No. 13
 TWP. No. 27S
 RANGE 1W

CASE No. D - 1070

ASSOCIATED CASE NO. L/S-0545

I. OFFER TO DEDICATE: Additional Utility Easement on Lot 16, WEST RIDGE ACRES
 GENERALLY LOCATED: Between Westridge Drive and Joann.

LEGALLY DESCRIBED AS:

DEDICATED BY: Beverly J. Davis, 752 Westridge, Wichita 67203
 AGENT: _____ PHONE _____
 ADDRESS: _____
 PURPOSE OF DEDICATION: _____

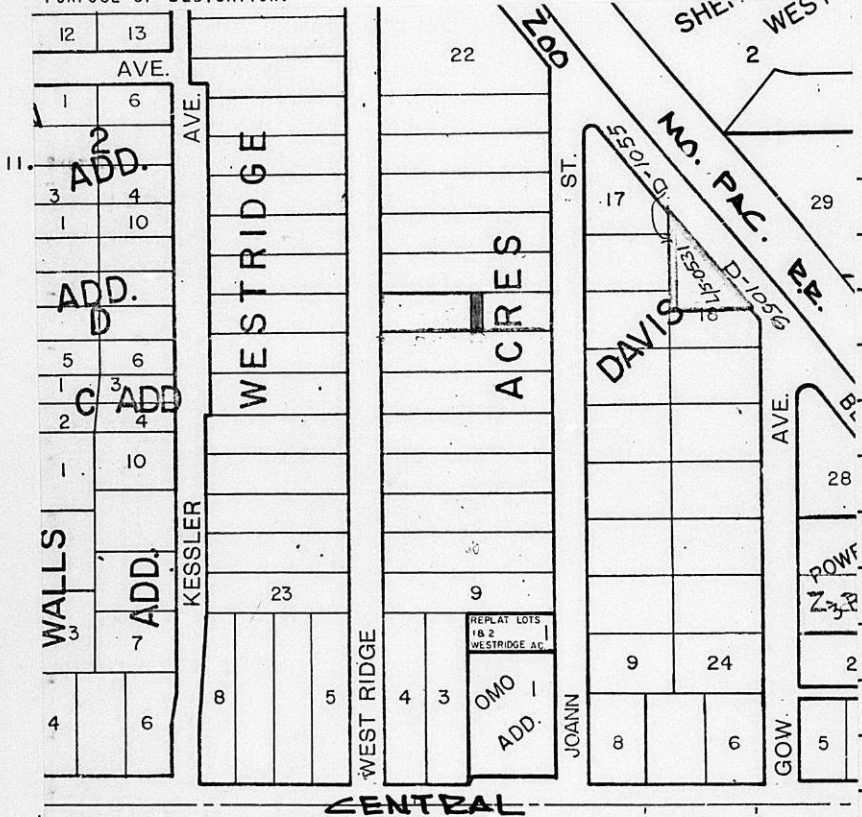

III. FILED 3-31-82
 POSTED TO ATLAS _____
 S/D COMM. ACTION 4-15-82 accept
 M.A.P.C. ACTION 4-22-82 accept

B.C.C. ACTION 5-4-82 accept
 PLACED ON RECORD _____
 CITY CLERKS No. _____

Bill recording to: Applicant
 752 Westridge, Wichita 67203

MAPC CASE NO. D-1070 Dedication of utility easement

Dedicated by: Beverly J. Davis

Generally located between Westridge and Joann in an area north of Central

This dedication is given for the following reason:
lot split requirement

ACTION: Accept the dedication and instruct the City Clerk to
file with the Register of Deeds.

BILL RECORDING FEE TO: Beverly J. Davis
752 Westridge
Wichita, Ks. 67203

EASEMENT

D-1070

THIS EASEMENT made this 30th day of March,
1982, by and between Beverly J. Davis
of the first part and the City of Wichita, of the second part.

WITNESSETH: That the said first party, in consideration of the sum of One Dollar (\$1.00) and other valuable consideration, the receipt whereof is hereby acknowledged, does hereby grant and convey unto the said second party a perpetual right-of-way and easement for the purpose of constructing, maintaining, and repairing sewer and all other public utilities, over, along and under the following described real estate situated in Sedgwick County, Kansas, to wit:

The East 22 feet of the West 172 feet of Lot 16,
"WEST RIDGE ACRES", Sedgwick County, Kansas.

And said second party is hereby granted the right to enter upon said premises at any time for the purpose of constructing, operating, maintaining, and repairing such sewer and all other public utilities.

IN WITNESS WHEREOF: The said first party has signed these presents the day and year first written.

Beverly J. Davis
Beverly J. Davis

STATE OF KANSAS)
SEDGWICK COUNTY) SS

Be it remembered that on this 31st day of 1982, before me, a notary public in and for said County and State, came Beverly J. Davis to me personally known to be the same person(s) who executed the foregoing instrument of writing and duly acknowledged the execution of same. In testimony whereof I have hereunto set my hand and affixed my notarial seal the day and year above written.

SEAL

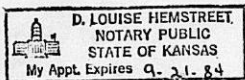

D. Louise Hemstreet
Notary Public

My Commission expires: September 21, 1984