

ACTION

SD COMMITTEE accept DATE 9-16-82
M.A.P.C. accept 9-23-82
B.C.C./B. GO. C. accept 10-5-82

Foster
9-9-82

D-1084 - Edward T. Neville, et al
grant additional utility easements
Generally located west of Wood-
chuck, in an area south of Redbarn.

DEDICATION REPORT AND PROGRESS

MAP No. 4948
SEC. No. 16
TWP. No. 27S
RANGE 1W

CASE No. D - 1084

ASSOCIATED CASE NO. L/S-0547

I. OFFER TO DEDICATE: additional utility easement
GENERALLY LOCATED: West of Woodchuck, in an area south of Redbarn.

LEGALLY DESCRIBED AS:

DEDICATED BY: Edward T. Neville, et al
AGENT: _____
ADDRESS: _____ PHONE _____
PURPOSE OF DEDICATION:

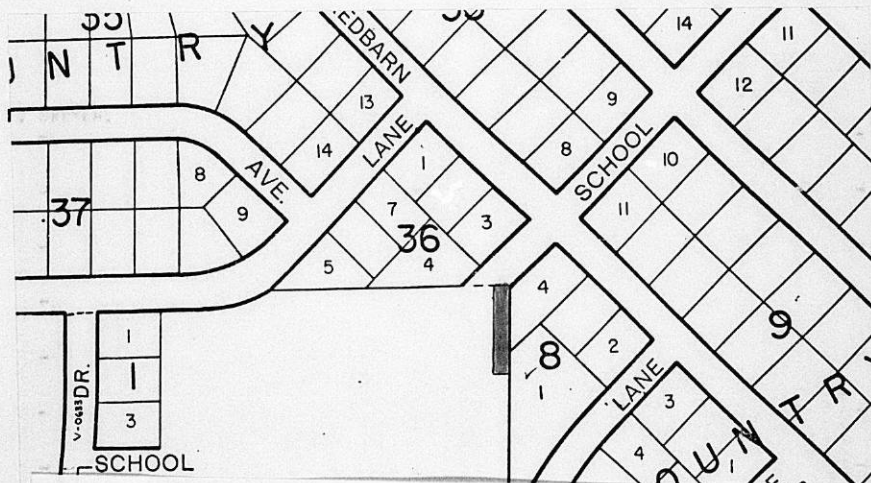

III. FILED 9-3-82
POSTED TO ATLAS _____
S/D COMM. ACTION 9-16-82 accept
M.A.P.C. ACTION 9-23-82 accept

B.C.C. ACTION 10-5-82 accept
PLACED ON RECORD _____
CITY CLERKS No. _____

Bill Recording to: Comfort Homes, Inc.
839 N. Mt. Carmel
Wichita, Kansas 67203

DEDICATION REPORT AND PROGRESS

MAP No. 4948
SEC. No. 16
TWP. No. 27S
RANGE 1W

CASE No. D - 1084

ASSOCIATED CASE NO. L/S-0547

1. OFFER TO DEDICATE: additional utility easement
GENERALLY LOCATED: West of Woodchuck, in an area south of Redbarn.

LEGALLY DESCRIBED AS:

DEDICATED BY: Edward T. Neville, et al
AGENT: _____ PHONE _____
ADDRESS: _____
PURPOSE OF DEDICATION:



4948
16
275
105

Duplicate

EASEMENT

D-1084
assn 4/5-0547

THIS EASEMENT made this 25th day of August, 1982,
by and between Edward T. Neville & Rita A. Neville, Trustees for Gregory Alan
Neville and Alvin Leon Neville
of the first part and the City of Wichita, of the second part.

WITNESSETH: That the said first part ies, in consideration of the sum of One Dollar (\$1.00) and other valuable consideration, the receipt whereof is hereby acknowledged, do hereby grant and convey unto the said second party a perpetual right of way and easement for the purpose of constructing, maintaining, and repairing sewer and all other public utilities, over, along and under the following described real estate situated in Sedgwick County, Kansas, to wit:

The east 25 feet of the north 155 feet of the S $\frac{1}{4}$ of the SW $\frac{1}{4}$ of Section 16, Township 27-S, Range 1 West of the 6th P.M., Sedgwick County, Kansas.

And said second party is hereby granted the right to enter upon said premises at any time for the purpose of constructing, operating, maintaining, and repairing such sewer and all other public utilities.

IN WITNESS WHEREOF: The said first parties have signed these presents the day and year first written.

Edward T. Neville
Edward T. Neville
Rita A. Neville
Rita A. Neville

STATE OF KANSAS)
SEDGWICK COUNTY) SS

Personally appeared before me a notary public in and for the County and State aforesaid Edward T. Neville & Rita A. Neville, Trustees for Gregory Alan
Neville and Alvin Leon Neville

to me personally known to be the same persons who executed the foregoing instrument of writing and said persons duly acknowledged the execution thereof.

Dated at Wichita, Kansas, this 25th day of August, 1982.

Mark A. Savoy
Notary Public

(My Commission expires 12 May 1984)

