

D-1086 - John E. Breising, Etux grants additional street r-o-w for Arkansas St. Generally located on the east side of Arkansas, in an area south of 26th St. North.

Porter
9-16-82

ACTION

	DATE
S/C COMMITTEE	<u>9-30-82</u>
M.A.P.C.	<u>10-7-82</u>
B.C.C./B-GO-C.	<u>10-19-82</u>

accept

accept

accept

MAP No. 5450
 SEC. No. 5
 TWP. No. 27
 RANGE 1E

DEDICATION REPORT AND PROGRESS

CASE No. D - 1086

ASSOCIATED CASE NO. L/S-0553

I. OFFER TO DEDICATE: Additional (street r-o-w) for Arkansas Street.
 GENERALLY LOCATED: on the east side of Arkansas, in an area south of 26th St. North.

LEGALLY DESCRIBED AS:

DEDICATED BY: John E. Breising, Etux.
 AGENT: _____
 ADDRESS: 2648 N. Arkansas PHONE 67204
 PURPOSE OF DEDICATION: _____

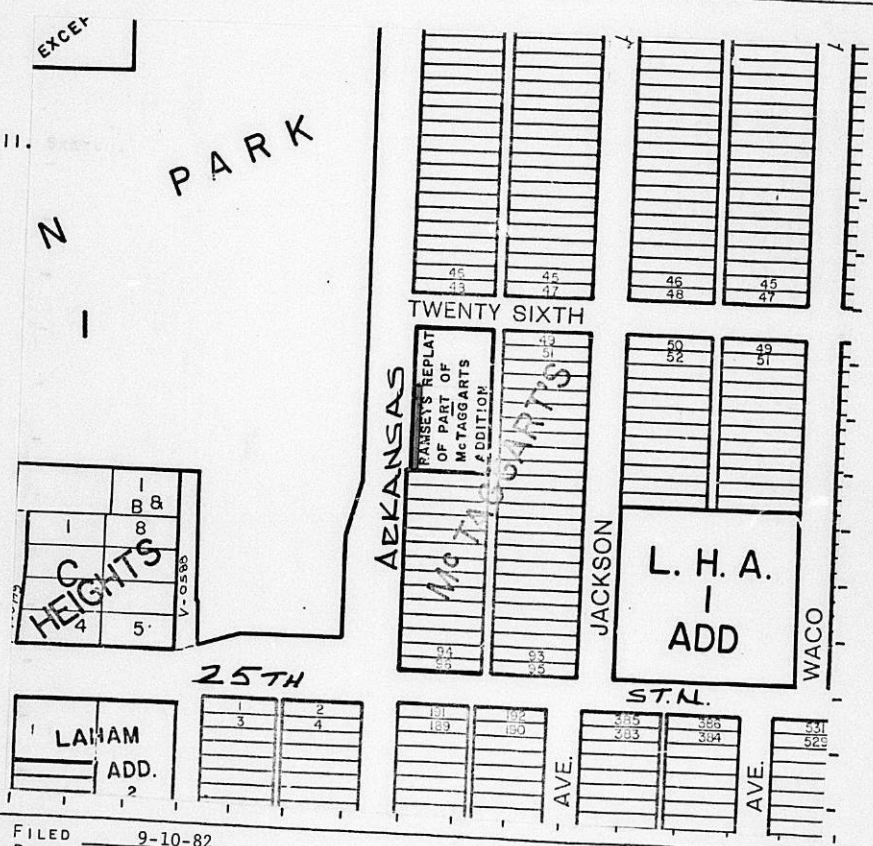

III. FILED 9-10-82
 POSTED TO ATLAS _____
 S/D COMM. ACTION 9-30-82 accept
 M.A.P.C. ACTION 10-7-82 accept
 B.C.C. ACTION 10-19-82 accept
 PLACED ON RECORD _____
 CITY CLERKS No. _____

5450
5
27
16

DEDICATION

Copy

KNOW ALL MEN BY THESE PRESENTS:

D-1086
acc. 45-0553

That for and in consideration of the sum of One Dollar (\$1.00) and other good and valuable considerations, the receipt of which is hereby

acknowledged, the undersigned, John E. Breising and

Betty G. Breising

being the owners of the following described real estate in Sedgwick County, Kansas, to wit:

The West ten (10) feet of the South one hundred fifty (150) feet of Lot 1, Ramsey's Replat of Part of McTaggart's Addition to Wichita, Sedgwick County, Kansas.

do hereby dedicate the above described real estate to the public for _____ street _____ purposes.

Executed this 30th day of August 1982.

✓ John E. Breising
John E. Breising

✓ Betty G. Breising
Betty G. Breising

STATE OF KANSAS)
SEDGWICK COUNTY) ss

BE IT REMEMBERED, that on this 30th day of August 1982,

came John E. Breising and Betty G. Breising

to me personally known to be the same persons who executed the foregoing instrument and duly acknowledged the execution of the same.

IN WITNESS WHEREOF, I have hereunto subscribed my name and affixed my official seal, the day and year last above written.

Submitted to the Wichita-Sedgwick County Metropolitan Area Planning Commission and the Board of Commissioners of the City of Wichita, Kansas, and approved by said Board of Commissioners of the City of Wichita, Kansas,
this _____,

City Clerk

Bobbi Smith Wascko
Notary Public

My Commission Expires: _____

