

D-1122 - Lyle Investments, Inc.
grants partial dedication of
Abutter's rights - generally
located on the south side of
Central, in an area west of
Hillcrest.

POSTED
5-2-83

ACTION

DATE

COMMITTEE _____

M.A.P.C. _____

B.C.C.#B-60-G- *Clayton* 5-3-83

MAP No. 5847A
 SEC. No. _____
 TWP. No. _____
 RANGE _____

DEDICATION REPORT AND PROGRESS

CASE No. D - 1122

ASSOCIATED CASE NO. Z-2493

1. OFFER TO DEDICATE: Partial Dedication of Abutter's rights
 GENERALLY LOCATED: on the south side of Central, in an area west of Hillcrest.

LEGALLY DESCRIBED AS: _____

DEDICATED BY: Lyle Investments, Inc.
 AGENT: _____
 ADDRESS: _____ PHONE _____
 PURPOSE OF DEDICATION: _____

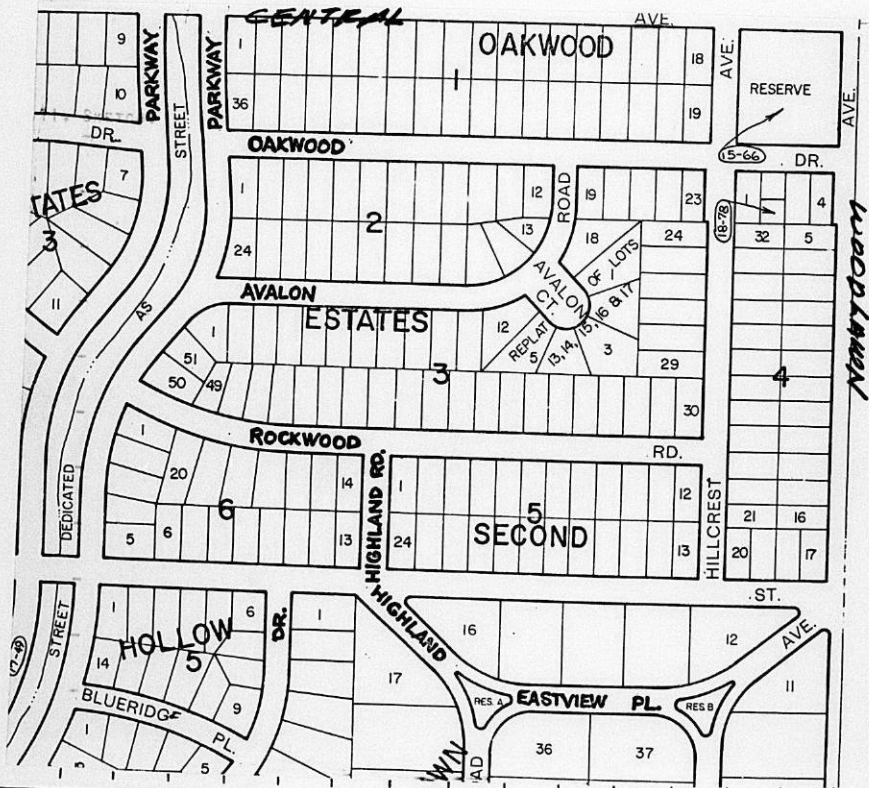

III. FILED 4-22-83
 POSTED TO ATLAS _____
 S/D COMM. ACTION _____
 M.A.P.C. ACTION _____

B.C.C. ACTION 5-3-83 *Accepted*
 PLACED ON RECORD _____
 CITY CLERKS No. _____

5847A

D-1122

PARTIAL DEDICATION OF ABUTTER'S RIGHTS *book 2-2493*

KNOW ALL MEN BY THESE PRESENTS:

That for and in consideration of the sum of One Dollar (\$1.00) and other good and valuable considerations, the receipt of which is hereby acknowledged, the undersigned Lyle Investments, Inc.

_____ being the owner of the following described real estate in Sedgwick County, Kansas, to-wit:

Lot 16, Block 1, Oakwood Estates Second, an Addition to Wichita, Sedgwick County, Kansas.

do hereby transfer and convey to the City of Wichita, Kansas, all abutter's rights of access, ingress and egress to said property from

or to Central over and across the north line of the above described

property; to have and to hold the same forever; provided, however, that said property shall have access to Central

at one location. It being understood that this conveyance is a covenant running with the land and pro-

hibits all subsequent owners thereof and all members of the public from entering upon said property from Central,

except at the one permitted location.

Executed this 21st day of April, 19 83.

Lyle Investments, Inc.

By: *[Signature]*
Jeff Lyle, President

State of Kansas) ss.
Sedgwick County)

BE IT REMEMBERED, that on this 21st day of April, 19 83, before me a notary public in and for the said County and State, came Jeff Lyle, President, Lyle Investments, Inc., to me personally known to be the same person who executed the foregoing instrument and duly acknowledged the execution of the same.

IN WITNESS WHEREOF, I have hereunto subscribed my name and affixed my official seal, the day and year last above written.

[Signature]
Notary Public



Commission Expires: _____

FOULSTON, SIEFKIN, POWERS & EBERHARDT

LAW OFFICES

A PARTNERSHIP INCLUDING A PROFESSIONAL ASSOCIATION

700 FOURTH FINANCIAL CENTER
BROADWAY AT DOUGLAS

WICHITA, KANSAS 67202

(316) 267-6371

COUNSEL
GEORGE S. POWERS

ROBERT C. FOULSTON (1888-1947) GEORGE SIEFKIN (1888-1884)

GARY L. AYERS
MARK S. AYERS
VAUGHN BURKHOLDER
LINDA K. COMSTABLE
TERRY C. CUPPS
NICHOLAS S. DALY
ELORIS C. FLENTJE
JAY F. FOWLER
STEVEN J. FRANZ
CHRISTOPHER M. HURST

STEPHEN M. KEEWICK
GARY E. KNIGHT
RICHARD C. MORRIS
JOHN J. MURPHY
LARRY S. RAPP
E. DOUGLAS REAGAN
TERESA J. ROLL
BUBAN L. SMITH
NOLA TERESCO FOULSTON
WYATT H. WRIGHT

JOHN F. EBERHARDT
ROBERT C. FOULSTON, P. A.
ROBERT M. FARWIDGE
ROBERT H. SIEFKIN
RICHARD C. HARRIS
ERALD B. HATSEY
ROBERT L. HOWARD
CHARLES J. WOODWIN
MIKEL L. STOUT
BENJAMIN C. LANGEL
JERRY G. ELLIOTT
WILLIAM H. DYE
PHILLIP S. FRICK

STANLEY S. ANDEEL
FREDERICK L. HAAG
RICHARD D. EYI
DARRELL L. WARTA
WILLIAM R. BARNHORN
HARVEY R. SORSENEN
CHRISTOPHER P. CHRISTIAN
MICHAEL RIM MOORE
JAMES H. ARMSTRONG
MARY KATHLEEN BARCOCK
CHARLES F. EPPLANDT
JAMES O. OLIVER

April 21, 1983

Mr. Jack Galbraith
Chief Planner
Metropolitan Area Planning
Commission
City Hall-Tenth Floor
455 North Main Street
Wichita, Kansas 67202

Re: Z-2493-"A" to "BB"-south side of Central
in an area west of Hillcrest

Dear Jack:

Pursuant to your letter of April 8, 1983, I am enclosing herewith the executed copies of the Partial Dedication of Abbuter's Rights and Dedication, all as provided for in your letter. These documents are executed by Lyle Investments, Inc. which corporation was one of the applicants and will become sole owner of the property when we close on May 5, 1983. Accordingly I think the documents as executed will take care of the dedications as required. Should you have any questions please let me know.

Very truly yours,

Phillip S. Frick

of FOULSTON, SIEFKIN, POWERS & EBERHARDT

PSF:klc
Enclosures
c.c. Jeff Lyle