

D-1136 - William L. Oliver, Jr.  
grants a utility easement. Generally  
located south of 39th Street  
North and east of Bayberry Circle

POSTED 6/2/83  
KX

ACTION

	DATE
S/D COMMITTEE	<u>accept</u> 6-23-83
M.A.P.C.	<u>accept</u> 6-30-83
B.C.C./B.G.C.	<u>accept</u> 7-12-83

4

POSTED 6-28-83  
KX

D-11  
gran  
ally  
Nort

MAP No. 5952C  
SEC. No. \_\_\_\_\_  
TWP. No. \_\_\_\_\_  
RANGE \_\_\_\_\_

DEDICATION REPORT AND PROGRESS

CASE No. D - 1136

ASSOCIATED CASE NO. \_\_\_\_\_

I. OFFER TO DEDICATE: Grants a utility easement  
GENERALLY LOCATED: south of 39th Street North and east of Bayberry Circle.

LEGALLY DESCRIBED AS: \_\_\_\_\_

DEDICATED BY: William L. Oliver, Jr.  
AGENT: \_\_\_\_\_  
ADDRESS: \_\_\_\_\_  
PURPOSE OF DEDICATION: \_\_\_\_\_ PHONE \_\_\_\_\_

II. SKETCH.

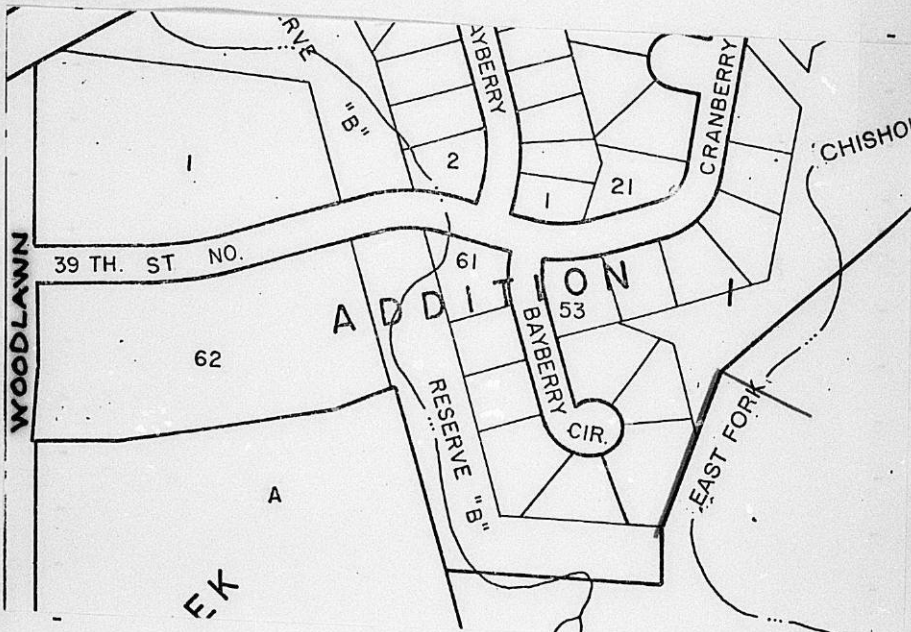

III. FILED 6-13-83  
POSTED TO ATLAS  
S/D COMM. ACTION 6-23-83 accept  
M.A.P.C. ACTION 6-30-83 accept

B.C.C. ACTION 7-12-83 accept  
PLACED ON RECORD \_\_\_\_\_  
CITY CLERKS No. \_\_\_\_\_

MAPC CASE NO. D-1136      Dedication of      utility easement

Dedicated by:      William L. Oliver, Jr..

Generally located south of 39th Street North and east of  
Bayberry Circle

This dedication is given for the following reason:

construction of Lateral 3, Main 9, sanitary sewer No. 23.

**ACTION:** Accept the dedication and instruct the City Clerk  
to file the document with the Register of Deeds.

**BILL RECORDING FEE TO:** Project #468-76-245-81259-000-000-001

EASEMENT

THIS EASEMENT made this 12<sup>th</sup> day of May, 1983  
by and between William L. Oliver, Jr. of the first  
part and City of Wichita of the second  
part.

WITNESSETH; that the said first party, in consideration of the sum of One Dollar (\$1.00) and other valuable consideration, the receipt whereof is hereby acknowledged, do hereby grant and convey unto the said second party a perpetual right of way and easement for the purpose of constructing, maintaining and repairing their utilities, over, along and under the following described real estate situated in Sedgwick County, Kansas, to wit:

A 20' utility easement in the southwest quarter of Section 30, Township 26 south, Range 2 east of the 6th P.M. near the southeast line of Northbrook, an addition to Wichita, Sedgwick County, Kansas, with the centerline being described as follows:

Commencing at the southeast corner of Lot 56, Block 1 of said addition; thence southwesterly along the southeast line of said lot extended bearing S 20° 23' 00" W, 10.00 feet to the point of beginning; thence N 20° 23' 00" E, 305.00 feet; thence S 64° 14' 04" E, 190.00 feet to the point of termination.

And said second party is hereby granted the right to enter upon said premises at any time for the purpose of constructing, operating, maintaining and repairing their utilities, including the right to open and excavate in any streets or ways that may be constructed on the surface of said easements, provided that upon completion of the necessities of grantee's operations the surface of such easements shall be restored as nearly as possible to its original condition.

IN WITNESS WHEREOF: The said first party has signed these presents the day and year first written.

X William L. Oliver, Jr.  
William L. Oliver, Jr.

STATE OF KANSAS  
ss:  
SEDGWICK COUNTY

Personally appeared before me a notary public in and for the County and State

aforsaid came William L. Oliver, Jr. to me personally known to be the same person who executed the foregoing instrument of writing and said person duly acknowledged the execution thereof.

Dated at Wichita this 12<sup>th</sup> day of May, 1983.

Ellen B. Lay  
Notary Public

My Appointment Expires: 6/17/86

THE CITY OF WICHITA

OFFICE OF ENGINEERING DEPARTMENT

DATE JUNE 9, 1983

TO LOUISE OLIVAREZ, CURRENT PLANS - PLANNING DEPARTMENT  
FROM LARRY D. HENRY, R/W & ESTIMATING ENGINEER

SUBJECT UTILITY EASEMENT  
LATERAL 3, MAIN 9, SANITARY  
SEWER NO. 23 (east of  
Woodlawn, north of 37th  
Street North)  
#468-76-245-81259-000-001

Attached please find subject instrument for placement on the Subdivision Committee Agenda for consideration at the earliest possible date. Upon approval by the City Commission, please have the City Clerk file for recording with the Register of Deeds. Any recording charges may be charged directly to Project No. 468-76-245-81259-000-001.

I would appreciate receiving a copy of the recorded instrument from the Clerk for our files.

*Larry D. Henry*  
Larry D. Henry, P.E.  
R/W & Estimating Engineer

/dla

Attachments

cc: Twila Nelson, City Clerk's Office

**RECEIVED**

JUN 10 1983  
METROPOLITAN PLANNING  
ROUTE  Luise  
 \_\_\_\_\_