

ACTION

	DATE
S/D COMMITTEE	<u>accept</u> 7-7-83
M.A.P.C.	<u>accept</u> 7-14-83
B.C.C./B.C.C.	<u>accept</u> 7-26-83

A

POSTED 6-23-83
RE

D-1138 - U.S.D. 259 Dedicates
additional right-of-way for
Rushwood, in an area south of
32nd St. North.

DEDICATION REPORT AND PROGRESS

MAP No. 5951C
SEC. No. 31
TWP. No. 26S
RANGE No. 2E

CASE No. D - 1138

ASSOCIATED CASE NO. _____

I. OFFER TO DEDICATE: additional right-of-way for Rushwood
GENERALLY LOCATED: in an area south of 32nd St. North.

LEGALLY DESCRIBED AS:

DEDICATED BY: U.S.D. 259

ADDRESS: 428 S. Broadway PHONE _____

PURPOSE OF DEDICATION: *To provide public r.o.w. for sidewalk. (A 3rd lane to be used for vehicular pick-ups and drop-offs will take up most of the usual 15-foot "parking" area.)*

II. SKETCH.

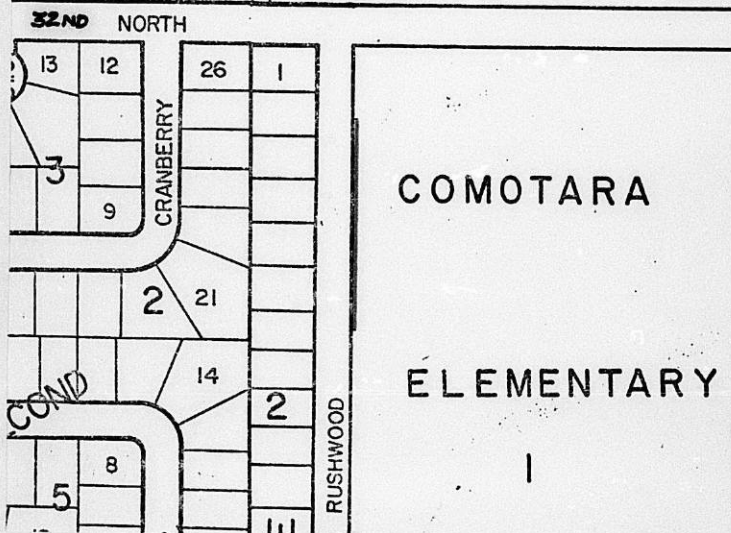

III. FILED 6-17-83
POSTED TO ATLAS
S/D COMM. ACTION 7-1-83 *accept*
M.A.P.C. ACTION 7-14-83 *accept*

B.C.C. ACTION 7-26-83 *Accept*
PLACED ON RECORD
CITY CLERKS No. _____

MAPC CASE NO. D-1138 Dedication of street right-of-way
for Rushwood
Dedicated by: U.S.D. 259

Generally located on the east side of Rushwood in an
area south of 32nd Street North

This dedication is given for the following reason:

To provide public right-of-way for a sidewalk

ACTION: Accept the dedication and instruct the City Clerk
to file the document with the Register of Deeds.

BILL RECORDING FEE TO:

U.S.D. 259
428 S. Broadway
Wichita, Kansas 67203

Map: 6951c
3/6/86

D E D I C A T I O N

D1138

KNOW ALL MEN BY THESE PRESENTS:

That for and in consideration of the sum of One Dollar (\$1.00) and other good and valuable considerations, the receipt of which is hereby acknowledged, the undersigned, Wichita Public Schools, USD 259

being the owner of the following described real estate in Sedgwick County, Kansas, to wit:

Beginning at a point located on west property line 129.00' south of northwest property corner of Lot 1, Comotara Elementary School Addition to Wichita, Sedgwick County, Kansas, southerly 370.00' along west property line, then easterly 5.00', then northerly 370.00' in a line parallel to the west property line, then westerly 5.00' to the point of beginning.

do hereby dedicate the above described real estate to the public for public street right-of-way purposes.

Executed this 6th day of June 19 83.

Unified School District No. 259

Attest: Martin Hartley
Martin Hartley, Clerk

Joyce Focht
Joyce Focht, President
Board of Education

STATE OF KANSAS)
SEDGWICK COUNTY) ss

BE IT REMEMBERED, that on this 6th day of June, 1983,
came Joyce Focht, President, and Martin Hartley, Clerk of the Board of
Education, Unified School District No. 259, Wichita, Sedgwick Co., Kansas.

to me personally known to be the same persons who executed the foregoing instrument and duly acknowledged the execution of the same.

IN WITNESS WHEREOF, I have hereunto subscribed my name and affixed my official seal, the day and year last above written.

Submitted to the Wichita-Sedgwick County Metropolitan Area Planning Commission and the Board of Commissioners of the City of Wichita, Kansas, and approved by said Board of Commissioners of the City of Wichita, Kansas,

this _____,

City Clerk

L. Julie Carrier
Notary Public

My Commission Expires: Jan. 18/86



THE CITY OF WICHITA

OFFICE OF ENGINEERING

DATE JUNE 15, 1983

TO LOUISE OLIVAREZ, CURRENT PLANS - PLANNING DEPARTMENT

FROM LARRY D. HENRY, R/W & ESTIMATING ENGINEER

SUBJECT DEDICATIONS

Attached please find two dedications for placement on the Subdivision Committee Agenda for consideration at the earliest possible date. Upon approval by the City Commission, please have the City Clerk file for recording with the Register of Deeds.

I would appreciate receiving a copy of the recorded instrument from the Clerk for our files.

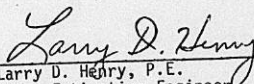
Larry D. Henry, P.E.
R/W & Estimating Engineer

/dla

Attachments

cc: Twila Nelson, City Clerk's Office

RECEIVED
JUN 16 1983
METROPOLITAN PLANNING
ROUTE _____
