

D-1158 - Amsden Lumber Co. Grants  
"complete access control". General  
ly located at the southeast corner  
of Merton Ave. & St. Clair.

## ACTION

	DATE
S/D COMMITTEE	<u>9-29-83</u>
M.A.P.C.	<u>10-6-83</u>
B.C.C./B. CO.C.	<u>10-18-83</u>

POSTED 9-14-83  
KE

MAP No. 5345D  
SEC. No. 31  
TWP. No. 27  
RANGE No. 1E

DEDICATION REPORT AND PROGRESS  
CASE No. D - 1158  
ASSOCIATED CASE NO. L/S-0584

I. OFFER TO DEDICATE: Grants "Complete Access Control"  
GENERALLY LOCATED: at the southeast corner of Merton Avenue & St. Clair.

LEGALLY DESCRIBED AS: \_\_\_\_\_

DEDICATED BY: Amsden Lumber Co. <sup>etal</sup> P O Box 13239, 307 Maple, 67213  
ADDRESS: \_\_\_\_\_ PHONE \_\_\_\_\_  
PURPOSE OF DEDICATION: \_\_\_\_\_

II. SKETCH.

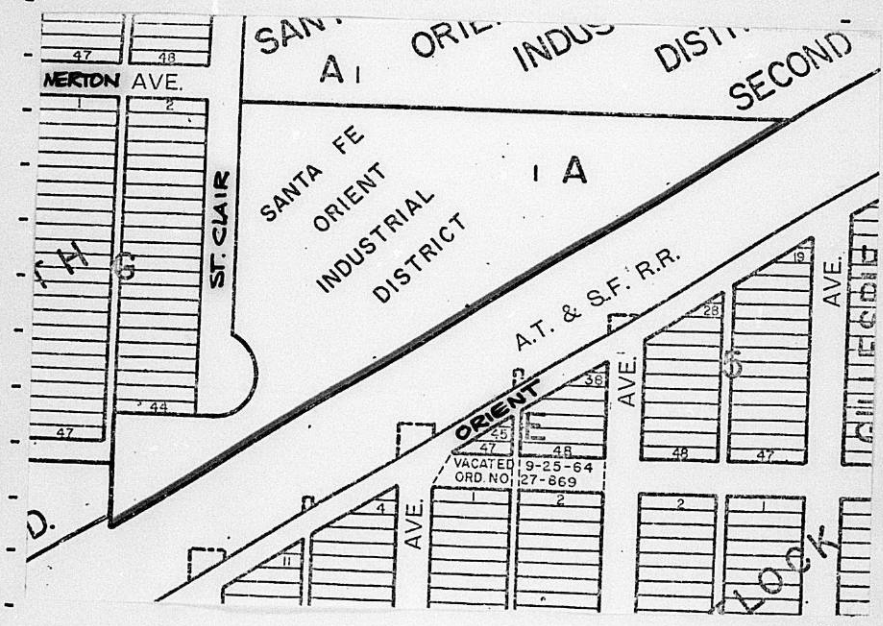

III. FILED 9-6-83  
POSTED TO ATLAS \_\_\_\_\_  
S/D COMM. ACTION 9-29-83 accept  
M.A.P.C. ACTION 10-6-83 accept  
BILL RECORDING COSTS TO: Amsden Lumber Co., P.O. Box 13239, 307 Maple, 67213  
T9-312  
Rev. 12/82

B.C.C. ACTION 10-18-83 fast  
PLACED ON RECORD \_\_\_\_\_  
CITY CLERKS No. \_\_\_\_\_

MAPC CASE NO. D-1158      Dedication of complete access control

Dedicated by: Amsden Lumber Company, et. al.

Generally located on the westerly side of Orient Boulevard in  
an area south of Harry

This dedication is given for the following reason:

Requirement of lot split approval

**ACTION:** Accept the dedication and instruct the City Clerk  
to file the document with the Register of Deeds.

**BILL RECORDING FEE TO:** Amsden Lumber Company  
P.O. Box 13239  
Wichita, Ks. 67213

JOHN TODD & ASSOCIATES

REAL ESTATE  
805 SOUTH MAIN, SUITE 103  
WICHITA, KANSAS 67213

(316) 262-3681

September 16, 1983

Mr. Forrest L. Nagley, Junior Planner  
METROPOLITAN AREA PLANNING COMMISSION  
City Hall--10th Floor  
455 North Main St.  
Wichita, Kansas 67202

Re: L/S-0584

Dear Mr. Nagley:

Enclosed are the instruments from Amsden Lumber Co., and Mr. & Mrs. Seibel dedicating "complete access control" to Orient Boulevard across the south line of subject lot.

This should complete the requirements for the lot split as outlined in your letter of August 29, 1983.

Sincerely,

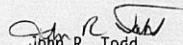
  
John R. Todd  
Broker

RECEIVED

SEP 19 1983

METROPOLITAN PLANNING

ROUTE

COMPLETE DEDICATION OF ABUTTER'S RIGHTS

KNOW ALL MEN BY THESE PRESENTS:

That for and in consideration of the sum of One Dollar (\$1.00) and other good and valuable considerations, the receipt of which is hereby acknowledged, the undersigned Gerald Seibel and Loretta Seibel, husband and wife being the owner<sub>s</sub> of the following

described real estate in Sedgwick County, Kansas, to-wit: Part of Lot 1, Block A, Santa Fe Orient Industrial District to Wichita, Sedgwick County, Kansas, described as beginning at the southwest corner of said Lot 1; thence north along the west line of said Lot 1, 198.20 feet to a corner of said Lot 1; thence east along the lot line of said Lot 1, 167.01 feet to the P.C. of a curve to the left, having a radius of 75 feet; thence northeasterly along said curve 61.56 feet through a central angle of 47°01'41"; thence south parallel with the east line of St. Clair Avenue, 79.24 feet more or less to the south line of said Lot 1; thence southwesterly 264 feet to the place of beginning.

do hereby transfer and convey to the City of Wichita, Kansas, all abutter's rights of access, ingress and egress to said property from or to Orient Boulevard over and across the south line of the above described property; to have and to hold the same forever. It being understood that this conveyance is a covenant running with the land and prohibits all subsequent owners thereof and all members of the public from entering upon said property from Orient Boulevard.

Executed this 14th day of September, 1983.

Gerald Seibel  
Gerald Seibel

Loretta Seibel  
Loretta Seibel

State of Kansas) ss.  
Sedgwick County)

BE IT REMEMBERED, that on this 14th day of September, 1983, before me a notary public in and for the said County and State, came Gerald Seibel and Loretta Seibel to me personally known to be the same person who executed the foregoing instrument and duly acknowledged the execution of the same.

IN WITNESS WHEREOF, I have hereunto subscribed my name and affixed my official seal, the day and year last above written.

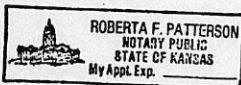

Roberta F. Patterson  
Notary Public

My Commission Expires: May 26, 1986



5345 D

31  
27  
12

COMPLETE DEDICATION OF ABUTTER'S RIGHTS

D-1158

KNOW ALL MEN BY THESE PRESENTS:

That for and in consideration of the sum of One Dollar (\$1.00) and other good and valuable considerations, the receipt of which is hereby acknowledged, the undersigned AMSDEN LUMBER CO., INC.

\_\_\_\_\_ being the owner of the following described real estate in Sedgwick County, Kansas, to-wit:

Lot 1, Block A, Santa Fe Orient Industrial District, Wichita, Sedgwick County, Kansas.

do hereby transfer and convey to the City of Wichita, Kansas, all abutter's rights of access, ingress and egress to said property from or to Orient Boulevard over and across the south line of the above described property; to have and to hold the same forever. It being understood that this conveyance is a covenant running with the land and prohibits all subsequent owners thereof and all members of the public from entering upon said property from Orient Boulevard.

Executed this 6th day of September, 1983.

Warner Bullcock  
Amsden Lumber Co., Inc.

Warner Bullcock, President and General Manager

*Supersede  
Amsden will let part of  
selling the west part of  
prior to recording  
of this section*

State of Kansas) ss.  
Sedgwick County)

BE IT REMEMBERED, that on this 16<sup>th</sup> day of September, 1983, before me a notary public in and for the said County and State, came Warner J. Bullcock to me personally known to be the same person who executed the foregoing instrument and duly acknowledged the execution of the same.

IN WITNESS WHEREOF, I have hereunto subscribed my name and affixed my official seal, the day and year last above written.

Valerie Kitchener  
Notary Public



Commission Expires:

5-12-87