

D-1172 - City of Wichita dedicates
R-O-W for Murdock realignment.
Generally located north of existing
Murdock, between Wabash and
Mathewson.

W.C. C. *Wright* — 1-3-84

D-1172 - City of Wichita dedicates
R-O-W for Murdock realignment.
Generally located north of exist-
ing Murdock, between Wabash and
Mathewson.

B.C.C./B-00-C-1281

11-23-83
POSTED 11-29-83 KE

PK

ACTION

	COMMITTEE	DATE
SP	<u>accept</u>	<u>12-8-83</u>
	<u>accept</u>	<u>12-15-83</u>
	<u>accept</u>	<u>1-3-84</u>

December 27, 1983

Board of City Commissioners (through E. H. Denton,
City Manager)

Robert A. Lakin, Director of Planning

Dedication from City-owned properties of right-of-way for
realigned Murdock.

The City Engineer's office, in conjunction with staff from Industrial Development, prepared legal descriptions of right-of-way needed for the realigned Murdock project as it crosses City-owned land. The Subdivision Committee and Planning Commission reviewed the street dedication and recommended acceptance. The dedication document requires the notarized signatures of the Mayor and City Clerk prior to recording.

Attached are copies of a map illustrating the right-of-way described in the dedication document. The missing pieces in the alignment have previously been dedicated by Geo. C. Christopher & Son, Inc. This dedication is scheduled for the City Commission Planning Agenda of January 3, 1984. The recommended action is:

Authorize the Mayor to sign the dedication of street right-of-way for realigned Murdock and instruct the City Clerk to file the dedication with the Register of Deeds.

Robert A. Lakin
Director of Planning

RAL:LO:bh

Attach.

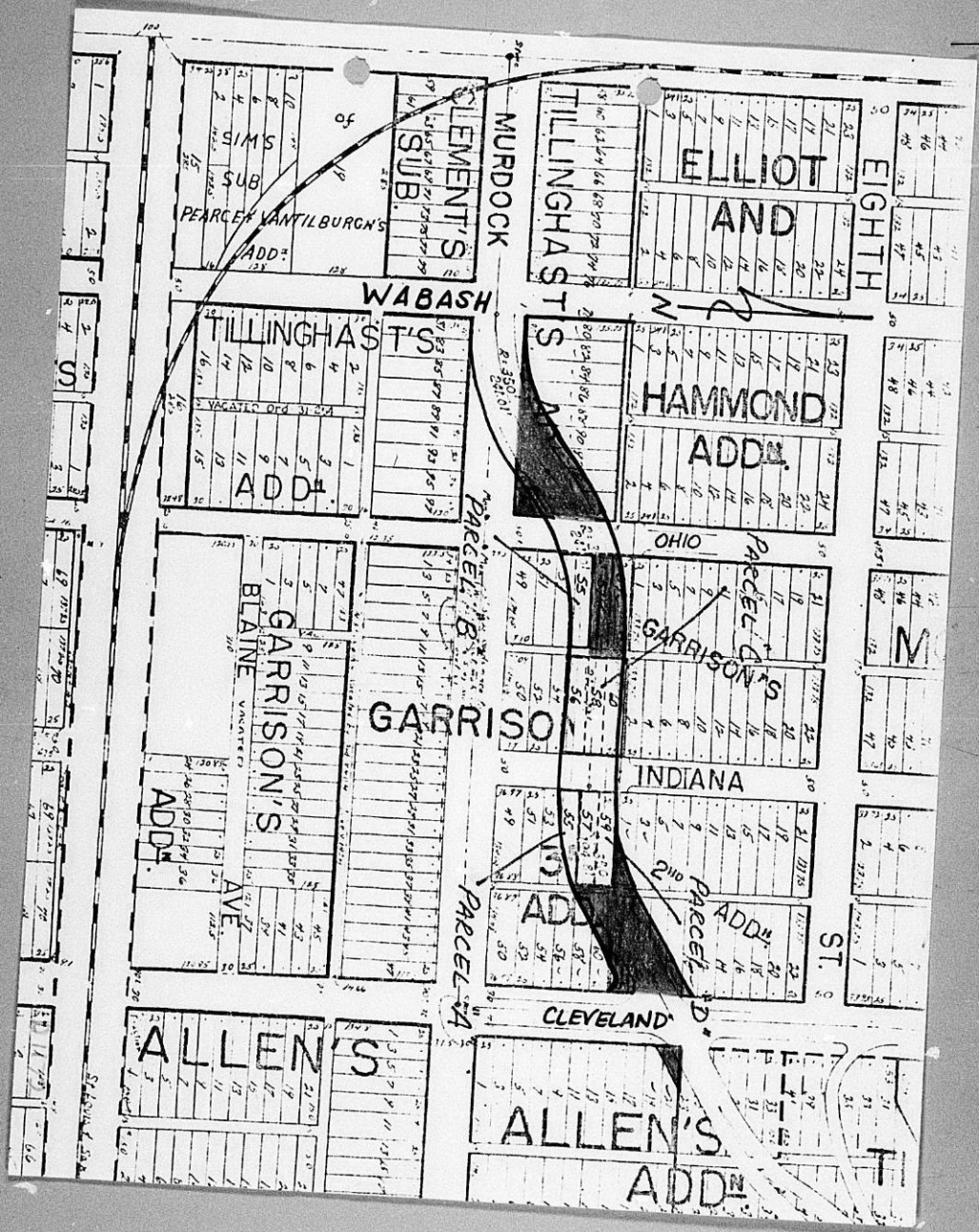

ELLIOT AND
TILLINGHAST'S
MURDOCK
CLEMMENT'S
SUB
PEARCE VANTILBURG'S
ADDⁿ

ELLIOT AND
EIGHTH
ADDⁿ

WABASH
TILLINGHAST'S
VACATED DEC 31 1904
ADDⁿ

TILLINGHAST'S
HAMMOND
ADDⁿ

BLAINE
GARRISON'S
AVE.
ADDⁿ

OHIO
GARRISON'S
INDIANA
ADDⁿ

ALLEN'S
ADDⁿ

CLEVELAND
ALLEN'S
ADDⁿ

EIGHTH

ADDⁿ

N

ST.

T

THE CITY OF WICHITA
OFFICE OF Contracts Administration

DATE November 14, 1983

D-1172

TO Louise Olivarez, Senior Planner
FROM Steven L. Potucek, Real Property Manager



SUBJECT Murdock Realignment

As we discussed and pursuant to your request, I asked Larry Henry to provide descriptions of land which should be dedicated for the realigned Murdock Ave. between Wabash Ave. and Cleveland Ave. These descriptions are those across lands previously acquired by the City in the Murdock realignment project.

Attached please find a completed Dedication form which form will be processed through the Planning Commission and subsequently to the City Commission for execution and acceptance. As you recall, we discussed this matter and it was agreed that presentation to the City Commission on one occasion with recommendation as to acceptance by the Planning Commission would be administratively acceptable inasmuch as the City will be executing the dedication.

Thank you for your attention to this matter and please contact me when the dedication has been processed through the Planning Commission.

Steven L. Potucek
Real Property Manager

SLP/abv
Att.

DEDICATION

COPY

KNOW ALL MEN BY THESE PRESENTS:

That for and in consideration of the sum of One Dollar (\$1.00) and other good and valuable considerations, the receipt of which is hereby acknowledged, the undersigned, The City of Wichita, Kansas, a municipal corporation, by its Mayor Margalee Wright

being the owner of the following described real estate in Sedgwick County, Kansas, to wit:

That part of the East one (1) foot of Lot 78, and even numbered Lots 80 thru 96 inclusive, Tillinghast's Addition to the City of Wichita, Sedgwick County, Kansas, lying within lines parallel with and forty (40) feet either side of the following described line:

Beginning at a point on the centerline of Oak Street (now Murdock Avenue) as platted in Tillinghast's Addition to the City of Wichita, Sedgwick County, Kansas, said point being three hundred fifty-nine (359) feet East of the West Line of the Southwest Quarter of Section 16, Township 27 South, Range 1 East of the 6th P.M., Sedgwick County, Kansas; thence on a curve to the left deflecting North-easterly from said centerline, said curve having a radius of three hundred fifty (350) feet and a central angle of thirty-nine degrees, twenty-seven minutes, twelve seconds (39° 27' 12") for a distance of two hundred forty-one and one hundredths (241.01) feet to the P.R.C. of a curve to the right having a radius of three hundred fifty (350) feet and a central angle of thirty-nine degrees, twenty-seven minutes, twelve seconds (39° 27' 12"); thence along said curve for a distance of two hundred forty-one and one hundredths (241.01) feet to the P.T. of said curve; thence East along the tangent of said curve for a distance of two hundred twelve and forty-nine hundredths (212.49) feet to the P.C. of a curve to the left having a radius of three hundred fifty (350) feet and a central angle of thirty-one degrees, fifty-three minutes, twenty-seven seconds (31° 53' 27"); thence along said curve for a distance of one hundred ninety-four and eighty-one hundredths (194.81) feet to the P.T. of said curve; thence Northeasterly on the tangent line of said curve to the centerline of Cleveland Avenue, and

1/10" within 40' south and 40' north of l. Since s. part of lots 78-96 are also being dedicated, this legal could be for both if it said "1/10" s. of n.l. ..."

Can City dedicate alley for street?

the 2 phrases in parentheses should be removed

All of Lot 57, ^{in Ohio} and ten (10) foot alley adjacent on the East and that part of Lot 59, Garrison's 3rd Addition, Wichita, Sedgwick County, Kansas, (and ten (10) foot alley adjacent on the East) lying South of a line parallel with and forty (40) feet Northerly of the following described line:

Beginning at a point on the centerline of Oak Street (now Murdock Avenue) as platted in Tillinghast's Addition to the City of Wichita, Sedgwick County, Kansas, said point being three hundred fifty-nine (359) feet East of the West Line of the Southwest Quarter of Section 16, Township 27 South, Range 1 East of the 6th P.M., Sedgwick County, Kansas; thence on a curve to the left deflecting North-easterly from said centerline, said curve having a radius of three hundred fifty (350) feet and a central angle of thirty-nine degrees, twenty-seven minutes, twelve seconds (39° 27' 12") for a distance of two hundred forty-one and one hundredths (241.01) feet to the P.R.C. of a curve to the right having a radius of three hundred fifty (350) feet and a central angle of thirty-nine degrees, twenty-seven minutes, twelve seconds (39° 27' 12"); thence along said curve for a distance of two hundred forty-one and one hundredths (241.01) feet to the P.T. of said curve; thence East along the tangent of said curve for a distance of two hundred twelve and forty-nine hundredths (212.49) feet to the P.C. of a curve to the left having a radius of three hundred fifty (350) feet and a central angle of thirty-one degrees, fifty-three minutes, twenty-seven seconds (31° 53' 27"); thence along said curve for a distance of one hundred ninety-four and eighty-one hundredths (194.81) feet to the P.T. of said curve; thence Northeasterly on the tangent line of said curve to the centerline of Cleveland Avenue, and

1/10" s. of n.l.

That part of Lots 1 and 3 on Cherry (now Indiana Avenue) and ten (10) foot alley adjacent on the East, Garrison's 2nd Addition to Wichita, Sedgwick County, Kansas, lying South of a line parallel to and forty (40) feet Northerly of the following described line:

with

Can City Dedicate alley for street?

Beginning at a point on the centerline of Oak Street (now Murdock Avenue) as platted in Tillinghast's Addition to the City of Wichita, Sedgwick County, Kansas, said point being three hundred fifty-nine (359) feet East of the West Line of the Southwest Quarter of Section 16, Township 27 South, Range 1 East of the 6th P.M., Sedgwick County, Kansas; thence on a curve to the left deflecting North-easterly from said centerline, said curve having a radius of three hundred fifty (350) feet and a central angle of thirty-nine degrees, twenty-seven minutes, twelve seconds ($39^{\circ} 27' 12''$) for a distance of two hundred forty-one and one hundredths (241.01) feet to the P.R.C. of a curve to the right having a radius of three hundred fifty (350) feet and a central angle of thirty-nine degrees, twenty-seven minutes, twelve seconds ($39^{\circ} 27' 12''$); thence along said curve for a distance of two hundred forty-one and one hundredths (241.01) feet to the P.T. of said curve; thence East along the tangent of said curve for a distance of two hundred twelve and forty-nine hundredths (212.49) feet to the P.C. of a curve to the left having a radius of three hundred fifty (350) feet and a central angle of thirty-one degrees, fifty-three minutes, twenty-seven seconds ($31^{\circ} 53' 27''$); thence along said curve for a distance of one hundred ninety-four and eighty-one hundredths (194.81) feet to the P.T. of said curve; thence Northeasterly on the tangent line of said curve to the centerline of Cleveland Avenue, and

2,

lying S. of n.l.

That part of even numbered Lots 56 thru 60 on Cleveland and ten (10) foot alley adjacent on the West, Garrison's 3rd Addition to Wichita, Sedgwick County, Kansas, lying North of a line lying parallel to and forty (40) feet Southerly of the following described line:

Can City Dedicate alley for street?

with

Beginning at a point on the centerline of Oak Street (now Murdock Avenue) as platted in Tillinghast's Addition to the City of Wichita, Sedgwick County, Kansas, said point being three hundred fifty-nine (359) feet East of the West Line of the Southwest Quarter of Section 16, Township 27 South, Range 1 East of the 6th P.M., Sedgwick County, Kansas; thence on a curve to the left deflecting North-easterly from said centerline, said curve having a radius of three hundred fifty (350) feet and a central angle of thirty-nine degrees, twenty-seven minutes, twelve seconds ($39^{\circ} 27' 12''$) for a distance of two hundred forty-one and one hundredths (241.01) feet to the P.R.C. of a curve to the right having a radius of three hundred fifty (350) feet and a central angle of thirty-nine degrees, twenty-seven minutes, twelve seconds ($39^{\circ} 27' 12''$); thence along said curve for a distance of two hundred forty-one and one hundredths (241.01) feet to the P.T. of said curve; thence East along the tangent of said curve for a distance of two hundred twelve and forty-nine hundredths (212.49) feet to the P.C. of a curve to the left having a radius of three hundred fifty (350) feet and a central angle of thirty-one degrees, fifty-three minutes, twenty-seven seconds ($31^{\circ} 53' 27''$); thence along said curve for a distance of one hundred ninety-four and eighty-one hundredths (194.81) feet to the P.T. of said curve; thence Northeasterly on the tangent line of said curve to the centerline of Cleveland Avenue, and

4,

lying n. of s.l.

That part of even numbered lots 2 thru 10 inclusive and ten (10) foot alley adjacent on the West, on Cleveland, Garrison's 2nd Addition to Wichita, Sedgwick County, Kansas lying North of the following described line:

s.l. { Commencing at a point on the West Line of the Southeast Quarter of Section 16, Township 27 South, Range 1 East of the 6th P.M., Sedgwick County, Kansas, said point being forty (40) feet South of the center line of Oak Street (now Murdock Avenue) as platted in Tillinghast's Addition to the City of Wichita, Sedgwick County, Kansas; thence East along a line parallel with the center line of Oak Street (now Murdock Avenue) for a distance of three hundred fifty-nine (359) feet to the P.C. of a curve to the left, said curve having a radius of three hundred ninety (390) feet, a central angle of thirty-nine degrees, twenty-seven minutes, twelve seconds ($39^{\circ} 27' 12''$) and an arc length of two hundred sixty-eight and fifty-five hundredths (268.55) feet; thence deflecting Northeasterly along said curve to its intersection with the North Line of odd Lots 81 through 97, inclusive, on Oak Street (now Murdock Avenue) in Tillinghast's Addition to the City of Wichita, Sedgwick County, Kansas, for a point of beginning.

Then continuing along said curve to the left to the P.T. of said curve, said point also being the P.R.C. of a curve to the right, said curve having a radius of three hundred ten (310) feet, more or less; thence along said curve for a distance of two hundred thirteen and forty-six hundredths (213.46) feet, more or less, to a line lying parallel with and one hundred nineteen and five tenths (119.5) feet North of the center line of Oak Street (now Murdock Avenue) as platted in Garrison's Third Addition to Wichita, Kansas; thence East parallel with said centerline to the East Line of Indiana Avenue as platted in Garrison's Third Addition to Wichita, Kansas; thence Northeasterly along a curve to the left, said curve having a radius of three hundred ninety (390) feet, for a distance of two hundred seventeen and seven hundredths (217.07) feet; thence along the tangent of said curve for a distance of twenty-five (25) feet; thence along a curve to the right, said curve having a radius of thirty-six (36) feet, to the West Line of Cleveland Avenue as platted in Garrison's Third Addition to Wichita, Kansas.

and South of a line parallel with and forty (40) feet North of the following described line:

Beginning at a point on the centerline of Oak Street (now Murdock Avenue) as platted in Tillinghast's Addition to the City of Wichita, Sedgwick County, Kansas, said point being three hundred fifty-nine (359) feet East of the West Line of the Southwest Quarter of Section 16, Township 27 South, Range 1 East of the 6th P.M., Sedgwick County, Kansas; thence on a curve to the left deflecting Northeasterly from said centerline, said curve having a radius of three hundred fifty (350) feet and a central angle of thirty-nine degrees, twenty-seven minutes, twelve seconds ($39^{\circ} 27' 12''$) for a distance of two hundred forty-one and one hundredths (241.01) feet to the P.R.C.

c.l. { of a curve to the right having a radius of three hundred fifty (350) feet and a central angle of thirty-nine degrees, twenty-seven minutes, twelve seconds ($39^{\circ} 27' 12''$); thence along said curve for a distance of two hundred forty-one and one hundredths (241.01) feet to the P.T. of said curve; thence East along the tangent of said curve for a distance of two hundred twelve and forty-nine hundredths (212.49) feet to the P.C. of a curve to the left having a radius of three hundred fifty (350) feet and a central angle of thirty-one degrees, fifty-three minutes, twenty-seven seconds ($31^{\circ} 53' 27''$); thence along said curve for a distance of one hundred ninety-four and eighty-one hundredths (194.81) feet to the P.T. of said curve; thence Northeasterly on the tangent line of said curve to the centerline of Cleveland Avenue, and

*original lots
140' x 2 1/2
Cleveland
originally
50'*

A portion of Lots 19 and 21, Allen's Addition to Wichita, Kansas, and vacated street right-of-way adjacent on the West, more fully described as follows:

Beginning at a point on the North Line of Lot 21, Allen's Addition to Wichita, Kansas, said point being fifty-five (55) feet East of the Northwest Corner of said lot; thence West along said North Line and said line extended for a distance of sixty-five (65) feet to the West Line of vacated street right-of-way; thence South parallel to the West Line of said Lot 21 and the West Line of Lot 19 of said Addition for a distance of thirty-nine (39) feet; thence Northeasterly to the point of beginning, and

That part of Lots 94 and 96, Tillinghast's Addition to the City of Wichita, Sedgwick County, Kansas, lying southerly of the following described line:

Commencing at a point on the west line of the Southeast Quarter of Section 16, Township 27 South, Range 1 East of the 6th P.M., Sedgwick County, Kansas, said point being forty (40) feet South of the centerline of Oak Street (now Murdock Avenue) as platted in Tillinghast's Addition to the City of Wichita, Sedgwick County, Kansas; thence East along a line parallel with the centerline of Oak Street (now Murdock Avenue) for a distance of three hundred fifty-nine (359) feet to the P.C. of a curve to the left, said curve having a radius of three hundred ninety (390) feet, a central angle of 39° 27' 12", and an arc length of two hundred sixty-eight and fifty-five hundredths (268.55) feet; thence deflecting Northeasterly along said curve to its intersection with the north line of odd Lots 81 through 97, inclusive, on Oak Street (now Murdock Avenue) in Tillinghast's Addition to the City of Wichita, Sedgwick County, Kansas, for a point of beginning.

Thence continuing along said curve to the left to the P.T. of said curve, said point also being the P.R.C. of a curve to the right, said curve having a radius of three hundred ten (310) feet, more or less; thence along said curve for a distance of two hundred thirteen and forty-six hundredths (213.46) feet, more or less, to a line lying parallel with and one hundred nineteen and five tenths (119.5) feet North of the centerline of Oak Street (now Murdock Avenue) as platted in Garrison's Third Addition to Wichita, Kansas; thence East parallel with said centerline to the east line of Indiana Avenue as platted in Garrison's Third Addition to Wichita, Kansas; thence Northeasterly along a curve to the left, said curve having a radius of three hundred ninety (390) feet, for a distance of two hundred seventeen and seven hundredths (217.07) feet; thence along the tangent of said curve for a distance of twenty-five (25) feet; thence along a curve to the right, said curve having a radius of thirty-six (36) feet, to the west line of Cleveland Avenue as platted in Garrison's Third Addition to Wichita, Kansas.

this being dedicated for the new Chas. Murdock intersection

140' s. of s. 1.

do es hereby dedicate the above described real estate to the public for
street _____ purposes.

Executed this _____ day of _____ 19 ____.

ATTEST:
Donald C. Gisick, City Clerk

Margalee Wright, Mayor
City of Wichita, Kansas

STATE OF KANSAS)
SEDGWICK COUNTY) ss

BE IT REMEMBERED, that on this _____ day of _____,

came _____

to me personally known to be the same person _____ who executed the foregoing
instrument and duly acknowledged the execution of the same.

IN WITNESS WHEREOF, I have hereunto subscribed my name and affixed
my official seal, the day and year last above written.

Submitted to the Wichita-Sedgwick
County Metropolitan Area Planning
Commission and the Board of Com-
missioners of the City of Wichita,
Kansas, and approved by said Board
of Commissioners of the City of
Wichita, Kansas,

this _____,

City Clerk

Notary Public

My Commission Expires: _____

WICHITA-SEDGWICK COUNTY

METROPOLITAN AREA PLANNING DEPARTMENT

DATE
December 27, 1983

TO Board of City Commissioners (through E. H. Denton,
City Manager)

FROM Robert A. Lakin, Director of Planning

SUBJECT Dedication from City-owned properties of right-of-way for
realigned Murdock. (D-1172)

The City Engineer's office, in conjunction with staff from Industrial Development, prepared legal descriptions of right-of-way needed for the realigned Murdock project as it crosses City-owned land. The Subdivision Committee and Planning Commission reviewed the street dedication and recommended acceptance. The dedication document requires the notarized signatures of the Mayor and City Clerk prior to recording.

Attached are copies of a map illustrating the right-of-way described in the dedication document. The missing pieces in the alignment have previously been dedicated by Geo. C. Christopher & Son, Inc. This dedication is scheduled for the City Commission Planning Agenda of January 3, 1984. The recommended action is:

Authorize the Mayor to sign the dedication of street right-of-way for realigned Murdock and instruct the City Clerk to file the dedication with the Register of Deeds.

Robert A. Lakin
Robert A. Lakin
Director of Planning

RAL:LO:bh

Attach.